

FOR KCC USE:

PERMIT EXTENSION

FORM C-1 7/79
FORM MUST BE TYPED
FORM MUST BE SIGNED
ALL BLANKS MUST BE FILLED

EFFECTIVE DATE: 9-24-97

DISTRICT #
SEAT... Yes... No

State of Kansas
NOTICE OF INTENTION TO DRILL

Must be approved by the K.C.C. five (5) days prior to commencing well

Expected Spud Date 7 15 96
month day year

Spot
NW.. NW.. NW Sec .. 32 Twp 19.. S, Rg 21.. X East
West

OPERATOR: License # 4767
Name: Ritchie Exploration, Inc.
Address: 125 N. Market, Suite 1000
City/State/Zip: Wichita, Kansas 67202
Contact Person: Lisa Thimmesch / JULIE STOUT
Phone: (316) 267-4375 691-9500

..... 330..... feet from South North line of Section
..... 330..... feet from East West line of Section
IS SECTION X REGULAR IRREGULAR?

(NOTE: Locate well on the Section Plat on Reverse Side)

CONTRACTOR: License #: unknown
Name: ADVISE ON ACO-1

County: Ness
Lease Name: Erb Well #: 1
Field Name: Schaben

Is this a Prorated/Spaced Field? X yes no
Target Formation(s): Mississippian

* Nearest lease or unit boundary: 330'

Well Drilled For: Well Class: Type Equipment:
X Oil Enh Rec X Infield X Mud Rotary
Gas Storage Pool Ext. Air Rotary
OWWO Disposal Wildcat Cable
Seismic: # of Holes Other

Ground Surface Elevation: 2265 est. feet MSL
Water well within one-quarter mile: yes X no

Public water supply well within one mile: yes X no
Depth to bottom of fresh water: 280

Depth to bottom of usable water: 700
Surface Pipe by Alternate: 1 X 2

Length of Surface Pipe Planned to be set: 300 MIN.
Length of Conductor pipe required: none

Projected Total Depth: 4450
Formation at Total Depth: Mississippian

Water Source for Drilling Operations:
well farm pond X other

If OWWO: old well information as follows:
Operator:
Well Name:
Comp. Date: Old Total Depth

DWR Permit #:
Will Cores Be Taken? yes X no
If yes, proposed zone:

Directional, Deviated or Horizontal wellbore? yes X no
If yes, true vertical depth:
Bottom Hole Location:

* W.L.E. DOCKET No. 194453-C
(C-21,952)

AFFIDAVIT

The undersigned hereby affirms that the drilling, completion and eventual plugging of this well will comply with K.S.A. 55-101, et. seq.

It is agreed that the following minimum requirements will be met:

- 1. Notify the appropriate district office prior to spudding of well;
- 2. A copy of the approved notice of intent to drill shall be posted on each drilling rig;
- 3. The minimum amount of surface pipe as specified below shall be set by circulating cement to the top; in all cases surface pipe shall be set through all unconsolidated materials plus a minimum of 20 feet into the underlying formation;
- 4. If the well is dry hole, an agreement between the operator and the district office on plug length and placement is necessary prior to plugging;
- 5. The appropriate district office will be notified before well is either plugged or production casing is cemented in;
- 6. IF AN ALTERNATE II COMPLETION, PRODUCTION PIPE SHALL BE CEMENTED FROM BELOW ANY USABLE WATER TO SURFACE WITHIN 120 DAYS OF SPUD DATE. IN ALL CASES, NOTIFY DISTRICT OFFICE PRIOR TO ANY CEMENTING.

I hereby certify that the statements made herein are true and to the best of my knowledge and belief.
Date: 6-11-96 Signature of Operator or Agent: [Signature] Title: Geologist

FOR KCC USE:
API # 15- 135-240360000
Conductor pipe required NONE feet
Minimum surface pipe required 300 feet per Alt. X(2)
Approved by: JK 9-19-97/EXT 12-18-97 JK
This authorization expires: 2-9-98-9-19-98
(This authorization void if drilling not started within 6 months of effective date.)
Spud date: Agent:

Rocid
12-18-97

REMEMBER TO:

- File Drill Pit Application (form GDP-1) with Intent to Drill;
- File Completion Form ACO-1 within 120 days of spud date;
- File acreage attribution plat according to field proration orders;
- Notify appropriate district office 48 hours prior to workover or re-entry;
- Submit plugging report (CP-4) after plugging is completed;
- Obtain written approval before disposing or injecting salt water.

Mail to: Conservation Division, 200 Colorado Derby Building, 202 W. First St., Wichita, Kansas. 67202-1286.

12/18/97

IN ALL CASES PLOT THE INTENDED WELL ON THE PLAT BELOW

PLAT OF ACREAGE ATTRIBUTABLE TO A WELL IN A PRORATED OR SPACED FIELD

If the intended well is in a prorated or spaced field, please fully complete this side of the form. If the intended well is in a prorated or spaced field complete the plat below showing that the well will be properly located in relationship to other wells producing from the common source of supply. Please show all the wells within 1 mile of the boundaries of the proposed acreage attribution unit for gas wells and within 1/2 mile of the boundaries of the proposed acreage attribution unit for oil wells.

API NO. 15- _____
 OPERATOR Ritchie Exploration, Inc.
 LEASE Erb
 WELL NUMBER 1
 FIELD Schaben

LOCATION OF WELL: COUNTY Ness
330 feet from south (north) line of section
330 feet from east (west) line of section
 SECTION 32 TWP 19 RG 21 W

NUMBER OF ACRES ATTRIBUTABLE TO WELL 40
 QTR/QTR/QTR OF ACREAGE _____ NW _____ NW

IS SECTION x REGULAR or _____ IRREGULAR
IF SECTION IS IRREGULAR, LOCATE WELL FROM NEAREST CORNER BOUNDARY.

Section corner used: _____ NE _____ NW _____ SE _____ SW
PLAT

(Show location of the well and shade attributable acreage for prorated or spaced wells.)
 (Show footage to the nearest lease or unit boundary line.)

see attached plat

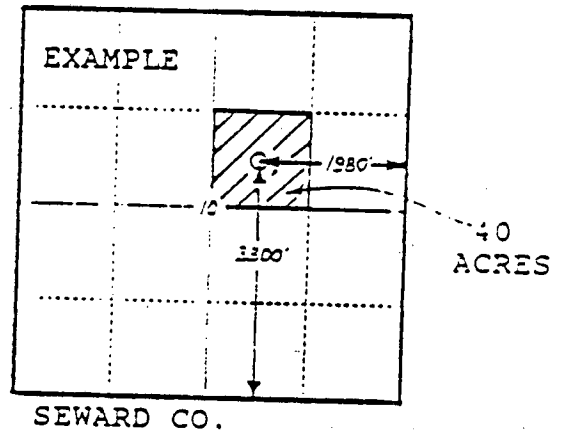
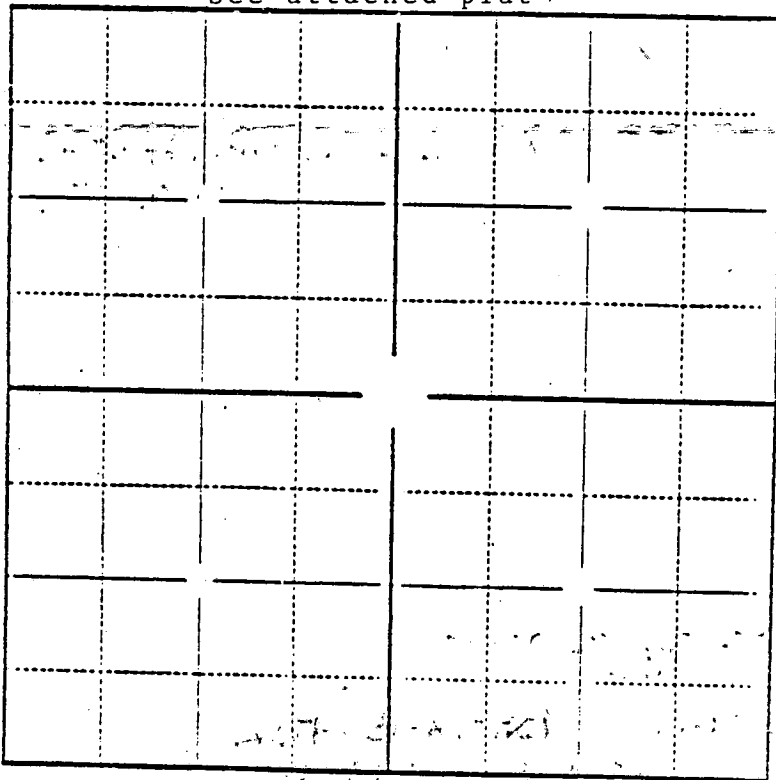

In plotting the proposed location of the well, you must show:

- 1) The manner in which you are using the depicted plat by identifying section lines, i.e. 1 section, 1 section with 8 surrounding sections, 4 sections, etc.;
- 2) the distance of the proposed drilling location from the section's south/north and east/west lines; and
- 3) the distance to the nearest lease or unit boundary line.



RITCHIE

EXPLORATION, INC.
Wichita, Kansas

December 16, 1997

RECEIVED
DEC 17 7 13 AM

Mr. Jeff Klock
Kansas Corporation Commission
130 S. Market, Suite 2078
Wichita, Kansas 67202-3802

Re: Intention to Drill Extensions

Dear Mr. Klock:

Ritchie Exploration, Inc. would like to extend our drilling intents on the following wells for six months.

1. #4 Borger "A-P"
API #15-135-240350000
1300' FNL & 2240' FWL
Section 25-19S-22W
Ness County, Kansas
2. #7 Moore "D-P"
API #15-135-240340000
1340' FNL & 1340' FWL
Section 30-19S-21W
Ness County, Kansas
3. #8 Moore "D-P"
API #15-135-240330000
1340' FNL & 400' FWL
Section 30-19S-21W
Ness County, Kansas
4. #1 Erb
API #15-135-240360000
NW NW NW
Section 32-19S-21W
Ness County, Kansas

Please call if you have any questions.

Sincerely,

Robert A. Mathiesen
Geologist

P.O. Box 783188
Wichita, Kansas 67278-3188

(316) 691-9500
Fax (316) 691-9550
ritchieexp@feist.com

8100 E. 22nd St. N., Bldg. 700
Wichita, Kansas 67226-2328