



KANSAS CORPORATION COMMISSION 1085934  
OIL & GAS CONSERVATION DIVISION

Form ACO-4  
Form must be typed  
March 2009

APPLICATION FOR COMMINGLING OF PRODUCTION (K.A.R. 82-3-123) OR FLUIDS (K.A.R. 82-3-123a) *Commingling ID #* **CO061215**

OPERATOR: License # 4767  
Name: Ritchie Exploration, Inc.  
Address 1: 8100 E 22ND ST N # 700  
Address 2: BOX 783188  
City: WICHITA State: KS Zip: 67278 + 3188  
Contact Person: John Niernberger  
Phone: (316) 691-9500

API No. 15 - 15-063-21836-00-00  
Spot Description: \_\_\_\_\_  
NE SE SE SW Sec. 30 Twp. 13 S. R. 31  East  West  
520 Feet from  North /  South Line of Section  
2350 Feet from  East /  West Line of Section  
County: Gove  
Lease Name: Joseph 30CD Well #: 1

1. Name and upper and lower limit of each production interval to be commingled:  
Formation: Johnson (Perfs): 4521 - 4524  
Formation: LKC/H (Perfs): 4121 - 4124  
Formation: \_\_\_\_\_ (Perfs): \_\_\_\_\_  
Formation: \_\_\_\_\_ (Perfs): \_\_\_\_\_  
Formation: \_\_\_\_\_ (Perfs): \_\_\_\_\_

2. Estimated amount of fluid production to be commingled from each interval:  
Formation: Johnson BOPD: 16.20 MCFPD: 0 BWPD: 5.40  
Formation: LKC/H BOPD: 10.80 MCFPD: 0 BWPD: 3.60  
Formation: \_\_\_\_\_ BOPD: \_\_\_\_\_ MCFPD: \_\_\_\_\_ BWPD: \_\_\_\_\_  
Formation: \_\_\_\_\_ BOPD: \_\_\_\_\_ MCFPD: \_\_\_\_\_ BWPD: \_\_\_\_\_  
Formation: \_\_\_\_\_ BOPD: \_\_\_\_\_ MCFPD: \_\_\_\_\_ BWPD: \_\_\_\_\_

3. Plat map showing the location of the subject well, all other wells on the subject lease, and all wells on offsetting leases within a 1/2 mile radius of the subject well, and for each well the names and addresses of the lessee of record or operator.

4. Signed certificate showing service of the application and affidavit of publication as required in K.A.R. 82-3-135a.

**For Commingling of PRODUCTION ONLY, include the following:**

- 5. Wireline log of subject well. Previously Filed with ACO-1:  Yes  No
- 6. Complete Form ACO-1 (*Well Completion form*) for the subject well.

**For Commingling of FLUIDS ONLY, include the following:**

- 7. Well construction diagram of subject well.
- 8. Any available water chemistry data demonstrating the compatibility of the fluids to be commingled.

**AFFIDAVIT:** I am the affiant and hereby certify that to the best of my current information, knowledge and personal belief, this request for commingling is true and proper and I have no information or knowledge, which is inconsistent with the information supplied in this application.

Submitted Electronically

<b>KCC Office Use Only</b>	
<input type="checkbox"/> Denied	<input checked="" type="checkbox"/> Approved
15-Day Periods Ends: <u>7/5/2012</u>	
Approved By: <u>Rick Hestermann</u>	Date: <u>07/10/2012</u>

*Protests may be filed by any party having a valid interest in the application. Protests must be in writing and comply with K.A.R. 82-3-135b and must be filed within 15 days of publication of the notice of application.*

R 32 W

R 31 W

T  
13  
S

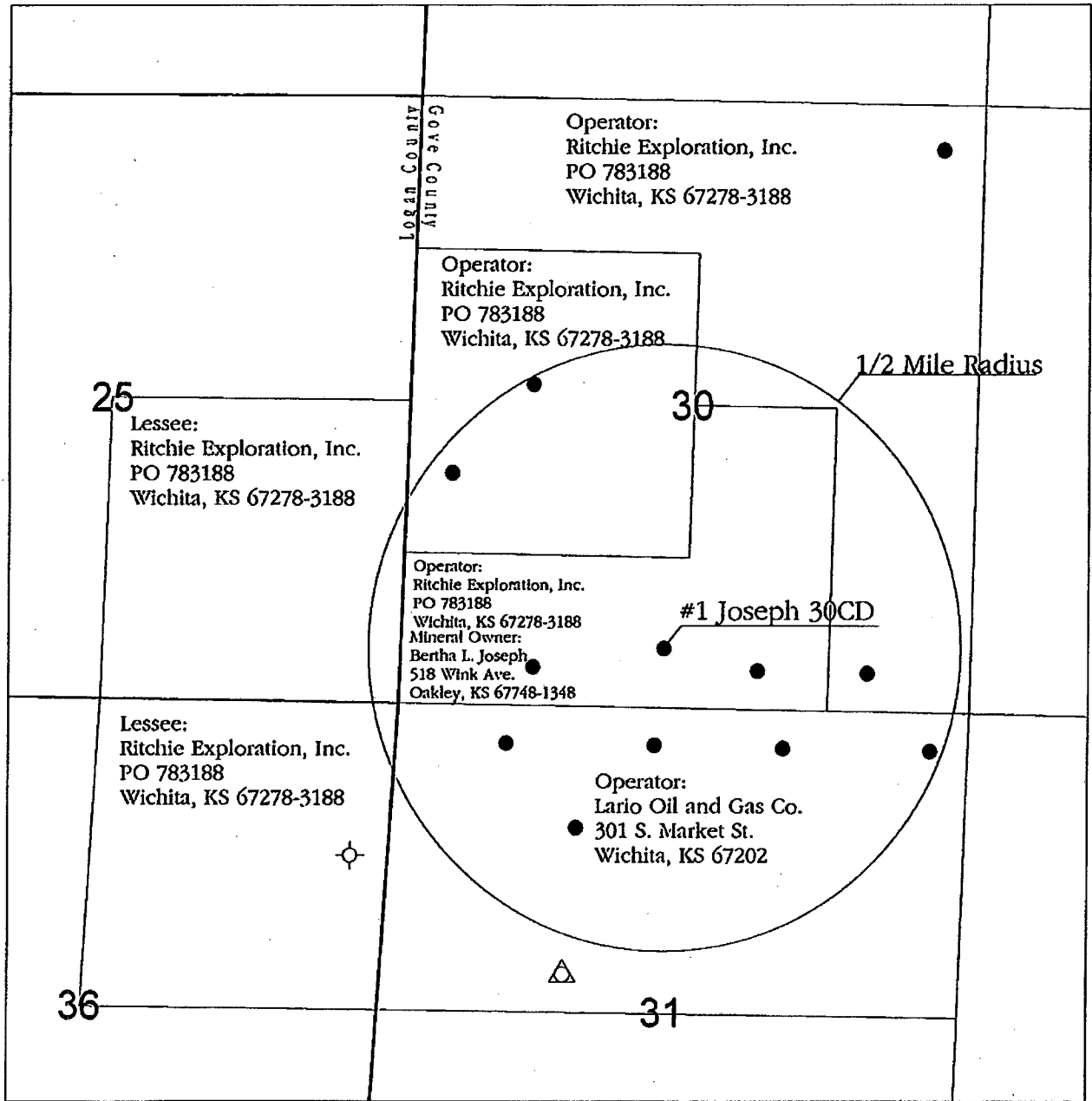

Legend

- Oil Well
- ⊕ Dry and Abandoned Well
- △ Service Well



**RITCHIE**  
EXPLORATION, INC.  
Wichita, Kansas

**Application for  
Commingling of  
Production or Fluids**

**Applicant Well: #1 Joseph 30CD**  
All Wells on Offsetting Leases Within 1/2 Mile Radius  
Name and Address of Lessee of Record or Operator

Gove / Logan County, Kansas

Prepared By: Justin Clegg	Scale: 1 : 17,000	Date: June 6, 2012
------------------------------	----------------------	-----------------------

# APPLICATION FOR COMMINGLING OF PRODUCTION OR FLUIDS

**Operator, Lessee or Unleased Mineral Owner  
within a ½ mile radius of Ritchie Exploration, Inc.'s**

**#1 Joseph 30CD  
520' FSL & 2350' FWL  
Section 30-13S-31W  
Gove Co., KS**

**Logan County, Kansas  
Township 13 South, Range 32 West**

Sec. 25:	SE/4	Ritchie Exploration, Inc.	Lessee
Sec. 36:	NE/4	Ritchie Exploration, Inc.	Lessee

**Gove County, Kansas  
Township 13 South, Range 31 West**

Sec. 30:	NE/4, E/2SE/4, E/2N/2NW/4, & Lot 1 of the NW/4	Ritchie Exploration, Inc.	Operator: #1 Joseph, #2 Joseph
	S/2NW/4, N/2SW/4	Ritchie Exploration, Inc.	Operator: #1 Stieben 30BC, #2 Stieben 30BC
	W/2SE/4, S/2SW/4	Ritchie Exploration, Inc.	Operator: #1 Joseph 30CD, #2 Joseph 30CD, #3 Joseph 30CD
		Bertha L. Joseph 518 Wink Ave. Oakley, KS 67748-1348	Mineral Owner
Sec. 31:	N/2	Lario Oil & Gas Co. 301 S. Market St. Wichita, KS 67202	Operator: Knapp #1-31, Knapp #2-31, Knapp #3-31, Knapp #4-31, Knapp #5-31, Knapp #6-31

**AFFIDAVIT**

STATE OF KANSAS        )  
                                  - SS.  
County of Sedgwick     )

John Niernberger, of lawful age, being first duly sworn, deposeth and saith: That he is Production Manager of Ritchie Exploration, County of Sedgwick, State of Kansas, and that notice was given to all lessee of record or operator within ½ mile radius of the Joseph 30CD #1 well located in the County of Gove (see attached plat map). This notice included a letter and a copy of the Commingle Application (ACO-4). All notices were mailed on June 14, 2012.

made as aforesaid on the 14<sup>th</sup> of

**June A.D. 2012**

\_\_\_\_\_  
And affiant further says that he has personal knowledge of the statements above set forth and that they are true.

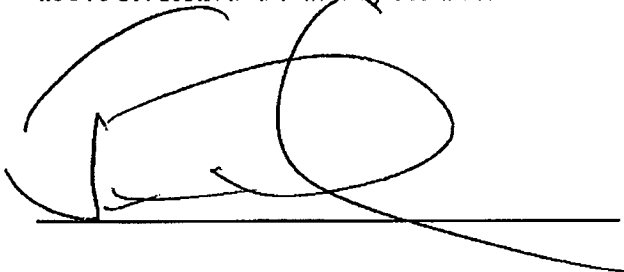

Subscribed and sworn to before me this

**14<sup>th</sup> day of June 2012**

**KAREN HOPPER  
NOTARY PUBLIC-STATE OF KANSAS  
MY APPT. EXPIRES 3-8-15**

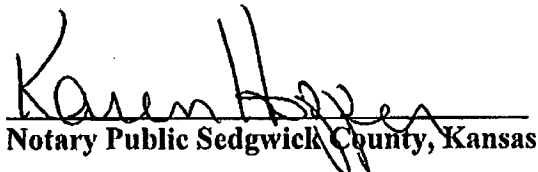

Notary Public Sedgwick County, Kansas

**AFFIDAVIT**

STATE OF KANSAS \  
- SS.  
County of Sedgwick /

Mark Fletchall, of lawful age, being first duly sworn, deposeth and saith: That he is Record Clerk of The Wichita Eagle, a daily newspaper published in the City of Wichita, County of Sedgwick, State of Kansas, and having a general paid circulation on a daily basis in said County, which said newspaper has been continuously and uninterruptedly published in said County for more than one year prior to the first publication of the notice hereinafter mentioned, and which said newspaper has been entered as second class mail matter at the United States Post Office in Wichita, Kansas, and which said newspaper is not a trade, religious or fraternal publication and that a notice of a true copy is hereto attached was published in the regular and entire Morning issue of said The Wichita Eagle for 1 issues, that the first publication of said notice was

made as aforesaid on the 16th of

June A.D. 2012, with

subsequent publications being made on the following dates:

**LEGAL PUBLICATION**  
PUBLISHED IN THE WICHITA EAGLE  
JUNE 16, 2012 (3191000)  
**LEGAL NOTICE**  
You, and each of you, are hereby notified that Ritchie Exploration, Inc. has filed an application to commence the commingling of production from the Lansing, Kansas City, and Johnson sources of supply for the #1 Joseph 30CD well located approx. E/2 SE SW of Section 30, T3S, 31W, Gove County, Kansas.  
Any persons who object to or protest this application shall be required to file their objections or protests with the Conservation Division of the State Corporation Commission of the State of Kansas within fifteen (15) days from the date of the publication. These protests shall be filed pursuant to Commission regulations and must state specific reasons why the grant of the application may cause waste, violate correlative rights or pollute the natural resources of the state of Kansas.  
If no protests are received, this application may be granted through a summary proceeding. If valid protests are received, this matter will be set for hearing.  
All persons interested or concerned shall take notice of the foregoing and shall govern themselves accordingly.  
RITCHIE EXPLORATION, INC.  
P.O. Box 783188  
Wichita, KS 67278-3188  
(316) 691-9500

And affiant further says that he has personal knowledge of the statements above set forth and that they are true.

*Mark Fletchall*

Subscribed and sworn to before me this

18th day of June, 2012

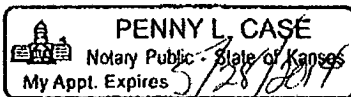

*Penny L. Case*  
Notary Public Sedgwick County, Kansas

Printer's Fee : \$91.60

**AFFIDAVIT OF PUBLICATION**

State of Kansas,  
Gove County, ss:

Roxanne Broeckelman,  
being first duly sworn, deposes and  
says: That she is  
co-publisher of

**Gove County Advocate**, a weekly  
newspaper printed in the State of  
Kansas, and published in and of  
general circulation in Gove County,  
Kansas, with a general paid  
circulation on a weekly basis in  
Gove County, Kansas, and that said  
newspaper is not a trade, religious  
or fraternal publication.

Said newspaper is a weekly  
published at least 50 times a year;  
and has been so published  
continuously and uninterruptedly in  
said county and state for a period of  
more than five years prior to the first  
publication of said notice; and has  
been admitted at the post office in  
Quinter in said county as periodical  
class mail matter.

That the attached notice is a true  
copy thereof and was published in  
the regular and entire issue of said  
newspaper for one  
consecutive week(s), the first  
publication thereof being made as  
aforesaid on the 20th day  
of June, 2012,  
with subsequent publications being  
made on the following dates:

\_\_\_\_\_, \_\_\_\_\_  
\_\_\_\_\_, \_\_\_\_\_  
\_\_\_\_\_, \_\_\_\_\_  
\_\_\_\_\_, \_\_\_\_\_  
\_\_\_\_\_, \_\_\_\_\_  
\_\_\_\_\_, \_\_\_\_\_

Printer's Fee ..... \$ 19.25  
Additional Copies .... \$ \_\_\_\_\_  
Affidavit Fees ..... \$ 2.00  
Total Publication Fees \$ 21.25

*Roxanne Broeckelman*

Subscribed and sworn to before me  
this 20th day of  
June, 2012

*Linda L. Zerr*  
Notary Public

My commission expires:  
January 8, 2013

**LEGAL ADVERTISING**  
(Published in the Gove County Advocate,  
Quinter, KS, Wed., June 20, 2012 - 1)

**LEGAL NOTICE**

You, and each of you, are hereby notified  
that Ritchie Exploration, Inc. has filed an appli-  
cation to commence the commingling of pro-  
duction from the Lansing-Kansas City and  
Johnson sources of supply for the #1 Joseph  
30CD well located approx. E/2 SE SW of  
Section 30-13S-31W, Gove County, Kansas.

Any persons who object to or protest this  
application shall be required to file their objec-  
tions or protests with the Conservation Division  
of the State Corporation Commission of the  
State of Kansas within fifteen (15) days from  
the date of the publication. These protests  
shall be filed pursuant to Commission regula-  
tions and must state specific reasons why the  
grant of the application may cause waste, vio-  
late correlative rights or pollute the natural  
resources of the state of Kansas.

If no protests are received, this application  
may be granted through a summary proceed-  
ing. If valid protests are received, this matter  
will be set for hearing.

All persons interested or concerned shall  
take notice of the foregoing and shall govern  
themselves accordingly.

**RITCHIE EXPLORATION, INC.**  
P.O. Box 783188  
Wichita, KS 67278-3188  
(316) 691-9500

**LINDA L. ZERR**  
NOTARY PUBLIC  
STATE OF KANSAS  
My Appt. Exp. 1-8-2013

Conservation Division  
Finney State Office Building  
130 S. Market, Rm. 2078  
Wichita, KS 67202-3802



Phone: 316-337-6200  
Fax: 316-337-6211  
<http://kcc.ks.gov/>

Mark Sievers, Chairman  
Ward Loyd, Commissioner  
Thomas E. Wright, Commissioner

Sam Brownback, Governor

July 9, 2012

John Niernberger  
Ritchie Exploration, Inc.  
P.O. Box 783188  
Wichita, KS 67278-3188

RE: Approved Commingling CO061215  
Joseph 30CD 1 Sec.30-T13S-R31W, Gove County  
API No. 15-063-21836-00-00

Dear Mr. Niernberger:

Your Application for Commingling (ACO-4) for the above described well has been reviewed and approved by the Kansas Corporation Commission (KCC) per K.A.R. 82-3-123. Notice was examined and found to be proper per K.A.R. 82-3-135a. No protest had been filed within the 15-day protest period. This application, which was received by the KCC on June 27, 2012, concerns approval to simultaneously produce from the following sources of supply through the same tubing string in the same wellbore:

Source of Supply	Estimated Current Production			Perf Depth
	BOPD	MCFPD	BWPD	
Johnson	16.20	0.00	5.40	4521-4524
LKC/H	10.80	0.00	3.60	4121-4124
Total Estimated Current Production	27.00	0.00	9.00	

Based upon the depth of the Johnson formation perforations, total oil production shall not exceed 200 BOPD and total gas production shall not exceed 50% of the absolute open flow (AOF).

Commingling ID number CO061215 has been assigned to this approved application. Use this number for well completion reports (ACO-1) and other correspondence that may concern this approved commingling.

Sincerely,

Rick Hestermann  
Production Department