

STATE CORPORATION COMMISSION OF KANSAS
OIL & GAS CONSERVATION DIVISION
WELL COMPLETION OR RECOMPLETION FORM
ACO-1 WELL HISTORY
DESCRIPTION OF WELL AND LEASE

5

API NO. 15-051-24,546-0000

County: Ellis 4

NW SW SW Sec. 31 Twp. 11 Rge. 19 East West

990 Ft North from Southeast Corner of Section
4950 Ft West from Southeast Corner of Section
(Note: Locate well in section plat below)

Operator: License # 5663
Name Hess Oil Company
Address P.O. Box 1009
McPherson, KS 67460
City/State/Zip

Lease Name Snider Well # 1

Purchaser

Field Name

Operator Contact Person Bryan Hess
Phone 316-241-4640

Producing Formation

Elevation: Ground 2061 KB 2069

Contractor: License # 4958
Name Mallard JV, Inc.

Wellsite Geologist James C. Hess
Phone 316-263-2243

Designate Type of Completion
 New Well Re-Entry Workover
 Oil SWD Temp Abd
 Gas Inj Delayed Comp.
 Dry Other (Core, Water Supply etc.)

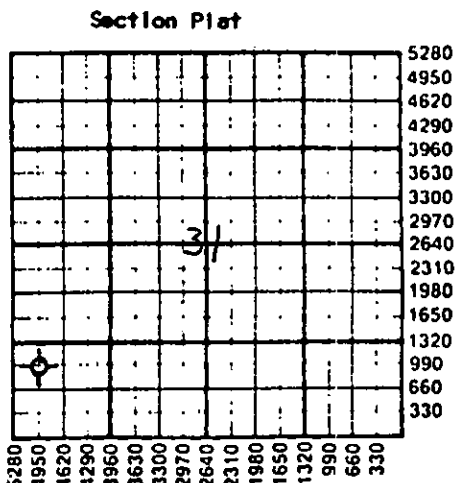

If ONNO: old well info as follows:
Operator
Well Name
Comp. Date Old Total Depth

WATER SUPPLY INFORMATION

Disposition of Produced Water: Disposal
Docket # Repressuring

Questions on this portion of the ACO-1 call:
Water Resources Board (913) 296-3717

Source of Water:
Division of Water Resources Permit #

Groundwater Ft North from Southeast Corner (Well) Ft West from Southeast Corner of Sec Twp Rge East West

Surface Water 1320 Ft North from Southeast Corner (Stream, pond etc.) 4290 Ft West from Southeast Corner Sec 31 Twp 11 Rge 19 East West

Other (explain) (purchased from city, R.W.D. #)

WELL HISTORY
Drilling Method: Mud Rotary Air Rotary Cable
3-8-88 3-12-88 3-12-88
Spud Date Date Reached TD Completion Date
3370' PBDT
Amount of Surface Pipe Set and Cemented at 161 feet
Multiple Stage Cementing Collar Used? Yes No
If yes, show depth set feet
If alternate 2 completion, cement circulated from feet depth to w/SX cmt
Cement Company Name
Invoice #

INSTRUCTIONS: This form shall be completed in triplicate and filed with the Kansas Corporation Commission, 200 Colorado Derby Building, Wichita, Kansas 67202, within 120 days of the spud date of any well. Rule 82-3-130, 82-3-107 and 82-3-106 apply. Information on side two of this form will be held confidential for a period of 12 months if requested in writing and submitted with the form. See rule 82-3-107 for confidentiality in excess of 12 months. One copy of all wireline logs and drillers time log shall be attached with this form. Submit CP-4 form with all plugged wells. Submit CP-111 form with all temporarily abandoned wells.

All requirements of the statutes, rules and regulations promulgated to regulate the oil and gas industry have been fully complied with and the statements herein are complete and correct to the best of my knowledge.

Signature Bryan Hess
Title Bryan Hess, Mgr. Date 3-22-88

Subscribed and sworn to before me this 22nd day of March 1988
Notary Public Don J. Reichenberger
Date Commission Expires 1-15-89

K.C.C. OFFICE USE ONLY
F Letter of Confidentiality Attached
C Wireline Log Received
C Drillers Timelog Received
Distribution
 KCC SWD/Rep NGPA
 Plug Other (Specify)
APR 19 1988
4-19-88
Form ACO-1 (5-86)



APR 19 1988
04-19-88
CONSERVATION DIVISION
Wichita, Kansas

Sec. 31 Twp. 11 Rge. 19

Operator Name Hess Oil Company Lease Name Snider Well # 1

Sec. 31 Twp. 11 Rge. 19 East West County Ellis

WELL LOG

INSTRUCTIONS: Show important tops and base of formations penetrated. Detail all cores. Report all drill stem tests giving interval tested, time tool open and closed, flowing and shut-in pressures, whether shut-in pressure reached static level, hydrostatic pressures, bottom hole temperature, fluid recovery, and flow rates if gas to surface during test. Attach extra sheet if more space is needed. Attach copy of log.

Drill Stem Tests Taken Yes No
 Samples Sent to Geological Survey Yes No
 Cores Taken Yes No

Formation Description
 Log Sample

Name	Top	Bottom
Anhydrite	1441'	1483'
Topeka	3116	
Heebner	3342	
R.T.D.		3370

CASING RECORD <input checked="" type="checkbox"/> New <input type="checkbox"/> Used							
Report all strings set-conductor, surface, intermediate, production, etc.							
Purpose of String	Size Hole Drilled	Size Casing Set (in O.D.)	Weight Lbs/Ft.	Setting Depth	Type of Cement	#Sacks Used	Type and Percent Additives
Surface	12 1/2"	8-5/8"	20	161'	60/40 Buz.	100	2% gel, 3% cc.
PERFORATION RECORD				Acid, Fracture, Shot, Cement Squeeze Record			
Shots Per Foot	Specify Footage of Each Interval Perforated			(Amount and Kind of Material Used)		Depth	
TUBING RECORD				Size	Set At	Packer at	Liner Run <input type="checkbox"/> Yes <input type="checkbox"/> No
Date of First Production		Producing Method <input type="checkbox"/> Flowing <input type="checkbox"/> Pumping <input type="checkbox"/> Gas Lift <input type="checkbox"/> Other (explain).....					
Estimated Production Per 24 Hours	Oil	Gas	Water	Gas-Oil Ratio		Gravity	
	Bbls	MCF	Bbls	CFPB			

METHOD OF COMPLETION

Production Interval

Disposition of gas: Vented Open Hole Perforation
 Sold Other (Specify)
 Used on Lease Dually Completed
 Commingled

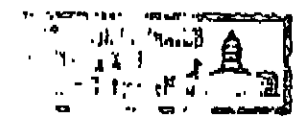

Mallard JV, Inc.
P.O. Box 1009
McPherson, KS 67460

DRILLERS' LOG

OPERATOR: Hess Oil Company P.O. Box 1009 McPherson, KS 67460	WELL: Snider #1 API#: 15-051-24,546 LOCATION: NW SW SW 990 Ft. FSL, 4950 Ft. FEL Sec. 31 Twp. 11 S. Rge. 19 W COUNTY: Ellis
COMMENCED: March 8, 1988	
COMPLETED: March 12, 1988	
TOTAL DEPTH: 3370 Ft.	
ELEVATION: 2061 Ft. G.L. 2069 Ft. K.B.	

<u>FORMATION</u>	<u>FROM</u>	<u>TO</u>
Surface, Shale	0'	910'
Sand	910	1128
Shale	1128	1442
Anhydrite	1442	1483
Shale	1483	1834
Hutchinson Salt	1834	1949
Shale, Lime	1949	3370 R.T.D.

REMARKS

Cut 12 1/2" hole to 162' and ran 5 joints 8-5/8" x 20# x 151.25' surface casing. Set at 160.75' and cemented w/100sx 60/40 Pozmix, 2% gel, 3% cc. Cement did circulate. P.D. @ 11:45 p.m. 3-8-88

Plugged hole w/200 sx 60/40 Pozmix, 6% gel w/2 sx Flocele as follows:

- 25 sx @ 1483'
 - 100 sx @ 710'
 - 40 sx @ 200'
 - 10 sx @ 40'
 - 15 sx R.H. & 10 sx M.H.
- P.D. @ 6:00 p.m. 3-12-88

STATE OF KANSAS)
) SS:
COUNTY OF McPHERSON)

I, BRYAN HESS of MALLARD DRILLING, do hereby certify that this is a true and correct copy of the log of the Snider #1 well as reflected by the files of Mallard Drilling.

Bryan Hess
Bryan Hess, Gen. Mgr.

Subscribed and sworn to before me this 22nd day of March, 1988.

11-15-89
My Commission Expires

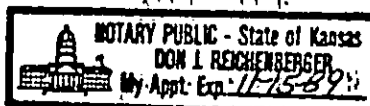

Don I. Reichenberger
Notary Public