

Give All Information Completely  
Make Required Affidavit  
Mail or Deliver Report to:  
Conservation Division  
State Corporation Commission  
211 No. Broadway  
Wichita, Kansas

76  
WELL PLUGGING RECORD

15.051-01490-0000

ELLIS County. Sec. 19 Twp. 11S Rge. 18W (E) (W)

Location as "NE/CNW&SW&" or footage from lines SE NE SW  
Lease Own r. PETROLEUM, INC.  
Lease Name RICHARDS "E" Well No. 1  
Office Address ROUTE 2, GREAT BEND, KANSAS  
Character of Well (completed as Oil, Gas or Dry Hole) DRY HOLE  
Date well completed DECEMBER 11 1962  
Application for plugging filed DECEMBER 11 1962  
Application for plugging approved DECEMBER 11 1962  
Plugging commenced DECEMBER 11 1962  
Plugging completed DECEMBER 11, 1962  
Reason for abandonment of well or producing formation NO PRODUCIBLE FORMATIONS

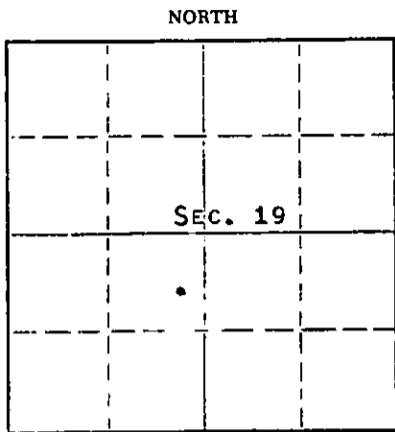

Locate well correctly on above Section Plat

If a producing well is abandoned, date of last production NONE 19    
Was permission obtained from the Conservation Division or its agents before plugging was commenced? YES

Name of Conservation Agent who supervised plugging of this well ELDON PETTY  
Producing formation --- Depth to top --- Bottom --- Total Depth of Well 3307 Feet  
Show depth and thickness of all water, oil and gas formations.

OIL, GAS OR WATER RECORDS

CASING RECORD

FORMATION	CONTENT	FROM	TO	SIZE	PUT IN	PULLED OUT
				8-5/8"	268'	NONE

Describe in detail the manner in which the well was plugged, indicating where the mud fluid was placed and the method or methods used in introducing it into the hole. If cement or other plugs were used, state the character of same and depth placed, from \_\_\_\_\_ feet to \_\_\_\_\_ feet for each plug set.

MUDDED UP WITH HEAVY MUD TO 540', FOLLOWED BY WOODEN PLUG. PLACED 20 SACKS CEMENT THROUGH DRILL PIPE ONTO PLUG. MUDDED UP WITH HEAVY MUD TO 240', FOLLOWED BY WOODEN PLUG. PLACED 20 SACKS CEMENT THROUGH DRILL PIPE ONTO PLUG. MUDDED UP WITH HEAVY MUD TO 40', FOLLOWED BY WOODEN PLUG, 1/4 SACK HULLS AND 10 SACKS CEMENT TO BASE OF WELL CELLAR.

REC'D  
STATE CORPORATION  
JAN 9 1963  
CONSERVATION DIVISION  
WICHITA, KANSAS

(If additional description is necessary, use BACK of this sheet)

Name of Plugging Contractor GARVEY DRILLING COMPANY  
Address ROUTE 2, GREAT BEND, KANSAS

STATE OF KANSAS, COUNTY OF BARTON, ss.  
DON SEARLE (employee of owner) or (~~OWNER~~) of the above-described well, being first duly sworn on oath, says: That I have knowledge of the facts, statements, and matters herein contained and the log of the above-described well as filed and that the same are true and correct. So help me God.

(Signature) Don Searle DON SEARLE, DIST. PROD. SUPT.  
ROUTE 2, GREAT BEND, KANSAS  
(Address)

SUBSCRIBED AND SWORN TO before me this 8TH day of JANUARY, 19 63

APRIL 14, 1963.

My commission expires \_\_\_\_\_

Archib J. Wiles  
Notary Public.

# WELL LOG

15-051-01490-0000

COMPANY PETROLEUM, INCORPORATED

SEC. 19 T. 11S R. 18W

FARM RICHARDS "E" NO. 1

LOC. SE, NE, SW

TOTAL DEPTH 3307'

COUNTY ELLIS CO., KANSAS

COMM. December 5, 1962 COMP. December 11, 1962

CONTRACTOR GARVEY DRILLING COMPANY

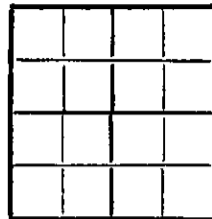

CASING 8-5/8" @ 268' w/175 sax.

ELEVATION 2041' D.F.

PRODUCTION D & A

FIGURES INDICATE BOTTOM OF FORMATIONS

60	Surface clay & post rock
268	Shale
625	Shale & red bed
850	Shale
1022	Sand
1350	Red bed
1396	Anhydrite
1770	Shale
2110	Shale & lime
2220	Lime
2720	Lime & shale
2845	Shale & lime
3155	Lime & shale
3210	Shale & lime
3255	Lime & shale
3307	Shale & lime
3307	T. D.

RECEIVED  
STATE CORPORATION COMMISSION

JAN 9 1963

CONSERVATION DIVISION  
Wichita, Kansas

State of KANSAS }  
County of BARTON } ss

I, VERNE A. MORRIS of GARVEY DRILLING COMPANY

upon oath state the above and foregoing is a true and correct copy of the log of the #1 RICHARDS "E" well.

Subscribed and sworn to before me this 8th day of January 1963

My Commission Expires: April 14, 1963

Verna A. Morris  
Arthur J. Miles  
NOTARY PUBLIC