

STATE OF KANSAS
STATE CORPORATION COMMISSION

All Information Completely
Required Affidavit
For Deliver Report to:
Conservation Division
State Corporation Commission
211 No. Broadway
Wichita, Kansas

WELL PLUGGING RECORD

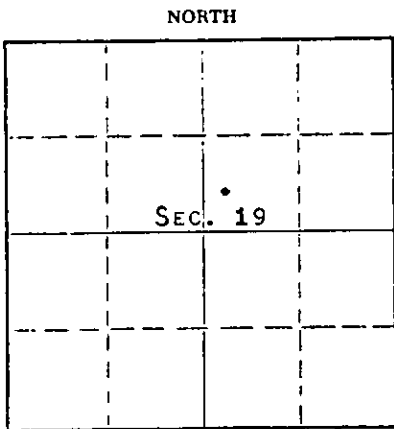

Locate well correctly on above
Section Plat

ELLIS County. Sec. 19 Twp. 11s Rge. 18w (E) (W)
Location as "NE/CNW/SW" or footage from lines NW SW NE
Lease Owner PETROLEUM, INC.
Lease Name RICHARDS "E" Well No. 2
Office Address ROUTE 2, GREAT BEND, KANSAS
Character of Well (completed as Oil, Gas or Dry Hole) DRY HOLE
Date well completed FEBRUARY 19, 1963
Application for plugging filed FEBRUARY 19, 1963
Application for plugging approved FEBRUARY 19, 1963
Plugging commenced FEBRUARY 19, 1963
Plugging completed FEBRUARY 19, 1963
Reason for abandonment of well or producing formation NO
PRODUCIBLE FORMATIONS
If a producing well is abandoned, date of last production NONE 19
Was permission obtained from the Conservation Division or its agents before plugging was commenced? YES

Name of Conservation Agent who supervised plugging of this well ELDON PETTY
Producing formation _____ Depth to top _____ Bottom _____ Total Depth of Well 3555 Feet
Show depth and thickness of all water, oil and gas formations.

OIL, GAS OR WATER RECORDS

CASING RECORD

FORMATION	CONTENT	FROM	TO	SIZE	PUT IN	PULLED OUT
				8-5/8"	256'	NONE

Describe in detail the manner in which the well was plugged, indicating where the mud fluid was placed and the method or methods used in introducing it into the hole. If cement or other plugs were used, state the character of same and depth placed, from _____ feet to _____ feet for each plug set.

FILLED HOLE WITH HEAVY MUD. GLOBE CEMENTING COMPANY SQUEEZED WITH 125 SACKS CEMENT TO BASE OF WELL CELLAR.

STATE CORPORATION COMMISSION

MAR 4 1963

CONSERVATION DIVISION
Wichita, Kansas

(If additional description is necessary, use BACK of this sheet)
Name of Plugging Contractor GARVEY DRILLING COMPANY
Address ROUTE 2, GREAT BEND, KANSAS

STATE OF KANSAS, COUNTY OF BARTON, ss.
DON SEARLE (employee of owner) or (owner or operator) of the above-described well, being first duly sworn on oath, says: That I have knowledge of the facts, statements, and matters herein contained and the log of the above-described well as filed and that the same are true and correct. So help me God.
(Signature) DON SEARLE, DIST. PROD. SUPT.
ROUTE 2, GREAT BEND, KANSAS
(Address)

SUBSCRIBED AND SWORN to before me this 28TH day of FEBRUARY, 1963

My commission expires APRIL 14, 1963

Andrus J. Miles
Notary Public.

WELL LOG

15051-19448-0000

COMPANY Petroleum Inc

SEC. 19 T. 11S R. 18W

FARM Richards

NO. E-2X

LOC. NW-SW-NE

TOTAL DEPTH 3555'

COUNTY Ellis

COMM. 2-10-63

COMP. 2-19-63

CONTRACTOR Garvey Drilling Company

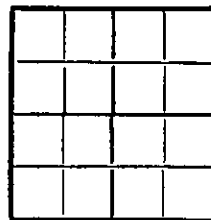

CASING 8 5/8' @ 256' w/200 sx

ELEVATION 1962' D.F.

PRODUCTION D & A

FIGURES INDICATE BOTTOM OF FORMATIONS

180' Surface Clay and Sand
 375' Shale
 450' Sand
 525' Shale
 1272' Red Bed and Sand
 1310' Anhydrite
 1660' Red Bed
 1740' Salt and Shale
 1840' Shale and Shells
 2175' Shale and Lime
 2300' Lime and Shale
 2535' Shale and Lime
 2908' Lime and Shale
 2966' Sand and Shale
 3000' Shale and Sane
 3235' Lime
 3275' Lime and Shale
 3319' Lime
 3395' Lime and Shale
 3490' Lime
 3550' Lime and Chert
 3555' Arbuckle
 3555' RTD

STATE OF KANSAS
STATE GEOLOGICAL SURVEY

MAR 4 1963

CONSERVATION DIV.
Wichita, Kansas

State of Kansas

County of Barton

I, Verne A. Morris of Garvey Drilling Company

upon oath state the above and foregoing is a true and correct copy of the log of the Richards E-2X well.

Subscribed and sworn to before me this 22nd day of February 19 63

My Commission Expires: April 14th, 1963

Verne A. Morris

Arthur J. [Signature]
NOTARY PUBLIC