

Information Completely
Required Affidavit
or Deliver Report to:
Conservation Division
State Corporation Commission
211 No. Broadway
Wichita, Kansas

WELL PLUGGING RECORD

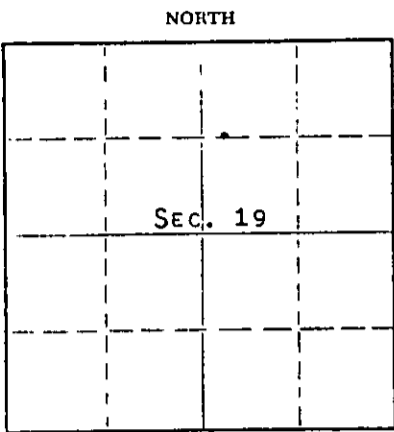

Locate well correctly on above
Section Plat

ELLIS County. Sec. 19 Twp. 11s Rge. 18w (X) (W)
Location as "NE/CNW/SW" or footage from lines C W/2 W/2 NE
Lease Owner PETROLEUM, INC.
Lease Name RICHARDS "E" Well No. 2-ERROR
Office Address ROUTE 2, GREAT BEND, KANSAS
Character of Well (completed as Oil, Gas or Dry Hole) DRY HOLE
Date well completed FEBRUARY 9, 19 63
Application for plugging filed FEBRUARY 9, 19 63
Application for plugging approved FEBRUARY 9, 19 63
Plugging commenced FEBRUARY 9, 19 63
Plugging completed FEBRUARY 9, 19 63
Reason for abandonment of well or producing formation WRONG LOCATION

If a producing well is abandoned, date of last production NONE 19__
Was permission obtained from the Conservation Division or its agents before plugging was commenced? YES

Name of Conservation Agent who supervised plugging of this well ELDON PETTY
Producing formation --- Depth to top --- Bottom --- Total Depth of Well 2038 Feet
Show depth and thickness of all water, oil and gas formations.

OIL, GAS OR WATER RECORDS

CASING RECORD

FORMATION	CONTENT	FROM	TO	SIZE	PUT IN	PULLED OUT
				8-5/8"	257'	NONE

Describe in detail the manner in which the well was plugged, indicating where the mud fluid was placed and the method or methods used in introducing it into the hole. If cement or other plugs were used, state the character of same and depth placed, from ___ feet to ___ feet for each plug set.

MUDDED UP WITH HEAVY MUD TO 540' FOLLOWED BY WOODEN PLUG. PLACED 20 SACKS CEMENT THROUGH DRILL PIPE ONTO PLUG. MUDDED UP WITH HEAVY MUD TO 240' FOLLOWED BY WOODEN PLUG AND 1/4 SACK HULLS. PLACED 10 SACKS CEMENT THROUGH DRILL PIPE ONTO HULLS. MUDDED UP WITH HEAVY MUD TO 40' FOLLOWED BY WOODEN PLUG, 1/4 SACK HULLS AND 10 SACKS CEMENT TO BASE OF WELL CELLAR.

STATE CORPORATION COMMISSION

MAR 4 1963

CONSERVATION DIVISION
Wichita, Kansas

(If additional description is necessary, use BACK of this sheet)
Name of Plugging Contractor GARVEY DRILLING COMPANY
Address ROUTE 2, GREAT BEND, KANSAS

STATE OF KANSAS COUNTY OF BARTON ss.
DON SEARLE (employee of owner) or (~~owner~~) of the above-described well, being first duly sworn on oath, says: That I have knowledge of the facts, statements, and matters herein contained and the log of the above-described well as filed and that the same are true and correct. So help me God. DON SEARLE, DIST. PROD. SUPT.
(Signature) *Don Searle*
ROUTE 2, GREAT BEND, KANSAS
(Address)

SUBSCRIBED AND SWORN TO before me this 28TH day of FEBRUARY, 19 63

My commission expires APRIL 14, 1963

Arthur J. Miles
Notary Public.

WELL LOG

15-051-03750-0000

COMPANY Petroleum Inc

SEC. 19 T. 11S R. 18W

FARM Richards

NO. E-2 (Error)

LOC. NW-SW-NE

TOTAL DEPTH 2038'

COUNTY Ellis

COMM. 2-6-63

COMP. 2-9-63

CONTRACTOR Garvey Drilling Co.

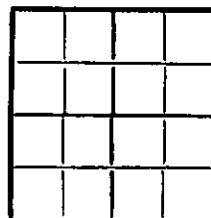

CASING 8 5/8" set @ 257' w/175 sx

ELEVATION 1954' DF

PRODUCTION D & A

FIGURES INDICATE BOTTOM OF FORMATIONS

- 15' Surface Shale
- 40' Sand
- 140' Shale
- 257' Blue Shale
- 745' Shale and Sand
- 1281' Shale and Red Bed
- 1314' Anhydrite
- 1745' Red Bed and Blue Shale
- 1840' Shale and Shells
- 1995' Shale and Lime
- 2038' Lime and Shale
- 2038' RTD

STATE COMMISSION OF CONSERVATION

MAR 4 1963

CONSERVATION DIVISION
Wichita, Kansas

State of Kansas }
County of Barton } ss

I, Verne A. Morris of Garvey Drilling Company

upon oath state the above and foregoing is a true and correct copy of the log of the Richards E-2 (Error) well.

Verne A. Morris

Subscribed and sworn to before me this 26th day of February 19 63

My Commission Expires: April 14th, 1963

Arthur J. Miles
NOTARY PUBLIC