

For KCC Use: Effective Date: 9-16-02
District #: 4
SGA? Yes No

KANSAS CORPORATION COMMISSION
OIL & GAS CONSERVATION DIVISION
NOTICE OF INTENT TO DRILL

Must be approved by KCC five (5) days prior to commencing well

Form C-1
September 1999
Form must be Typed
Form must be Signed
All blanks must be Filled

Expected Spud Date November 01 02
month day year

OPERATOR: License# 30537
Name: VENTURE RESOURCES, INC.
Address: P.O. Box 101234
City/State/Zip: Denver CO 80250
Contact Person: Ron Mackey
Phone: 303-722-2899 Cel 785-623-0328

CONTRACTOR: License# 31548
Name: Discovery Drilling

Well Drilled For:	Well Class:	Type Equipment:
<input checked="" type="checkbox"/> Oil	<input type="checkbox"/> Enh Rec	<input type="checkbox"/> Infield
<input type="checkbox"/> Gas	<input type="checkbox"/> Storage	<input checked="" type="checkbox"/> Pool Ext.
<input type="checkbox"/> OWWO	<input type="checkbox"/> Disposal	<input type="checkbox"/> Wildcat
<input type="checkbox"/> Seismic:	<input type="checkbox"/> # of Holes	<input type="checkbox"/> Other
<input type="checkbox"/> Other:		

If OWWO: old well information as follows:
Operator: NA
Well Name: _____
Original Completion Date: _____ Original Total Depth: _____

Directional, Deviated or Horizontal wellbore? Yes No
If Yes, true vertical depth: NA
Bottom Hole Location: _____
KCC DKT #: _____

Spot AP 70' E of
NE - NE - NE Sec. 14 Twp. 11 S. R. 18 East West
330 feet from 8-1 (N) (circle one) Line of Section
400 feet from (E) (circle one) Line of Section
Is SECTION Regular Irregular?

(Note: Locate well on the Section Plat on reverse side)
County: Ellis
Lease Name: Deane Well #: 1 A
Field Name: Bemis-Shurts
Is this a Prorated / Spaced Field? ? Yes No
Target Formation(s): Arbuckle
Nearest Lease or unit boundary: 330'
Ground Surface Elevation: 1860 est. feet MSL
Water well within one-quarter mile: Yes No
Public water supply well within one mile: Yes No
Depth to bottom of fresh water: 180'
Depth to bottom of usable water: 660'
Surface Pipe by Alternate: 1 2
Length of Surface Pipe Planned to be set: 200'
Length of Conductor Pipe required: NA
Projected Total Depth: 3400'
Formation at Total Depth: Arbuckle
Water Source for Drilling Operations:
Well _____ Farm Pond _____ Other _____
DWR Permit #: NA

(Note: Apply for Permit with DWR)
Will Cores be taken? Yes No
If Yes, proposed zone: _____

AFFIDAVIT

The undersigned hereby affirms that the drilling, completion and eventual plugging of this well will comply with K.S.A. 65-101, et. seq.
It is agreed that the following minimum requirements will be met:

1. Notify the appropriate district office prior to spudding of well;
2. A copy of the approved notice of intent to drill shall be posted on each drilling rig;
3. The minimum amount of surface pipe as specified below shall be set by circulating cement to the top; in all cases surface pipe shall be set through all unconsolidated materials plus a minimum of 20 feet into the underlying formation.
4. If the well is dry hole, an agreement between the operator and the district office on plug length and placement is necessary prior to plugging;
5. The appropriate district office will be notified before well is either plugged or production casing is cemented in;
6. If an ALTERNATE II COMPLETION, production pipe shall be cemented from below any usable water to surface within 120 days of spud date. In all cases, NOTIFY district office prior to any cementing.

I hereby certify that the statements made herein are true and to the best of my knowledge and belief.

Date: 9-9-02 Signature of Operator or Agent: Ron Mackey Title: Vice President/CEO

For KCC Use ONLY
API # 15 - 051-25157-00-00
Conductor pipe required NONE feet
Minimum surface pipe required 200 feet per Alt. 2
Approved by: RJP 9-11-02
This authorization expires: 3-11-03
(This authorization void if drilling not started within 8 months of effective date.)
Spud date: _____ Agent: _____

Remember to:

- File Drill Pit Application (form CDP-1) with Intent to Drill;
- File Completion Form ACO-1 within 120 days of spud date;
- File acreage attribution plat according to field proration orders;
- Notify appropriate district office 48 hours prior to workover or re-entry;
- Submit plugging report (CP-4) after plugging is completed;
- Obtain written approval before disposing or injecting salt water.

14
11
18w

SEP 1 1971
KCC WICHITA

IN ALL CASES PLOT THE INTENDED WELL ON THE PLAT BELOW

Plat of acreage attributable to a well in a prorated or spaced field

If the intended well is in a prorated or spaced field, please fully complete this side of the form. If the intended well is in a prorated or spaced field complete the plat below showing that the well will be properly located in relationship to other wells producing from the common source of supply. Please show all the wells and within 1 mile of the boundaries of the proposed acreage attribution unit for gas wells and within 1/2 mile of the boundaries of the proposed acreage attribution unit for oil wells.

API No. 15 - _____
 Operator: Venture Resources, Inc.
 Lease: Deane
 Well Number: 1-A
 Field: Bemis-Shurts
 Number of Acres attributable to well: 10
 QTR / QTR / QTR of acreage: NE - NE - NE

Location of Well: County: Ellis
330' feet from S (N) (circle one) Line of Section
400' feet from (E) / W (circle one) Line of Section
 Sec. 14 Twp. 11 S. R. 18 East West

Is Section X Regular or _____ Irregular

If Section is irregular, locate well from nearest corner boundary.
 Section corner used: NE NW SE SW

PLAT

(Show location of the well and shade attributable acreage for prorated or spaced wells.)
 (Show footage to the nearest lease or unit boundary line.)

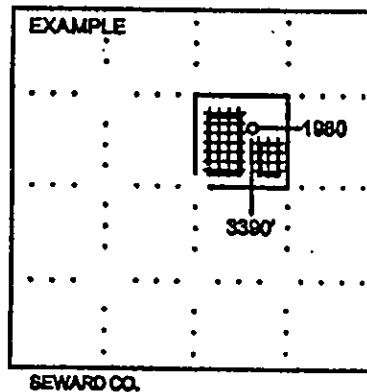
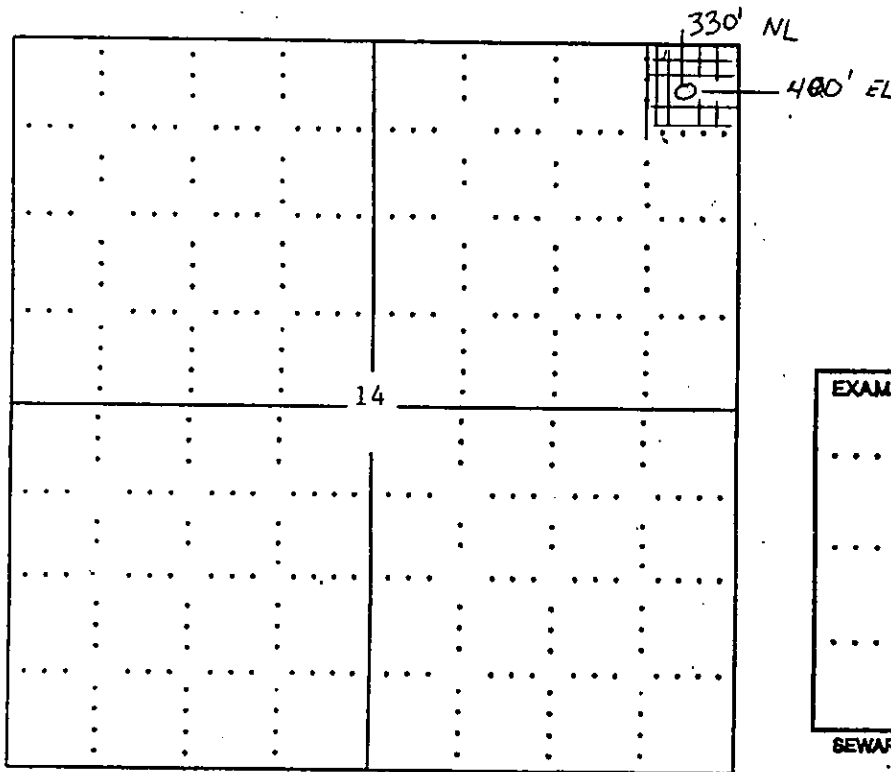

NOTE: In all cases locate the spot of the proposed drilling location.
 ELLIS CO.

In plotting the proposed location of the well, you must show:

1. The manner in which you are using the depicted plat by identifying section lines, i.e. 1 section, 1 section with 8 surrounding sections, 4 sections, etc.
2. The distance of the proposed drilling location from the section's south / north and east / west.
3. The distance to the nearest lease or unit boundary line.
4. If proposed location is located within a prorated or spaced field a certificate of acreage attribution plat must be attached: (CO-7 for oil wells; CG-8 for gas wells).

KANSAS

CORPORATION COMMISSION

Kathleen Sebelius, Governor Brian J. Moline, Chair John Wine, Commissioner Robert E. Krehbiel, Commissioner

REQUEST FOR INFORMATION

RECEIVED

October 02, 2003

OCT 09 2003

Venture Resources, Inc. -- KCC License # 30537
2110 S. Gilpin
PO Box 101234
Denver, CO 30250

KCC WICHITA

RE: API Well No. 15-051-25157-00-00
DEANE 1A
NENENE, 14-11S-18W
ELLIS County, Kansas

Dear Operator:

According to KCC records, the Intent to Drill approved by the KCC Conservation Division on September 11, 2002, for the well listed above, has expired. The KCC has not received a spud call or an ACO-1 Completion Report on this well.

If drilling operations on the well never commenced, please check, sign and date below and return this letter to the KCC Wichita office in the enclosed return envelope.

Well not drilled: Signature *George T. Madley*
Date: 10-07-2003

If the well has been drilled, please submit the required ACO-1 Completion Report with all attachments for this well along with a copy of this letter to the KCC Wichita office.

In either case please provide the requested information within 30 days from the date of this letter. Pursuant to K.A.R. 82-3-128, failure to respond to this letter with the requested information may result in assessment of a monetary penalty of \$100.00. Failure to file the ACO-1 form, if applicable, may result in assessment of a monetary penalty of \$500.00.

We appreciate your cooperation in this matter. If you have any questions, please contact me at (316) 337-6200.

Very truly yours,

David P. Williams

Supervisor
Production Department