

ORIGINAL

SIDE ONE

STATE CORPORATION COMMISSION OF KANSAS
OIL & GAS CONSERVATION DIVISION
WELL COMPLETION FORM
ACO-1 WELL HISTORY
DESCRIPTION OF WELL AND LEASE

API NO. 15- 165-21,516-0000

County Rush

S/2 SE SW Sec. 19 Twp. 16 Rge. 20 East West

Operator: License # 6484

330 Ft. North from Southeast Corner of Section

Name: Anderson Energy, Inc.

3300 Ft. West from Southeast Corner of Section
(NOTE: Locate well in section plat below.)

Address 200 E. First St., Suite 414

Wichita, KS 67202

Lease Name Fletcher Well # 1

City/State/Zip _____

Field Name Davenport North

Purchaser: N/A

Producing Formation D&A

Operator Contact Person: William L. Anderson

Elevation: Ground 2216' KB 2221'

Phone (316) 265-7929

Total Depth 4181' PBST _____

Contractor: Name: White & Ellis Drilling, Inc.

License: 5420

Wellsite Geologist: Chris Peters

Designate Type of Completion
 New Well Re-Entry Workover

Oil SWD Temp. Abd.

Gas Inj Delayed Comp.

Dry Other (Core, Water Supply, etc.)

If OAWO: old well info as follows:

Operator: _____

Well Name: _____

Comp. Date _____ Old Total Depth _____

Drilling Method:
 Mud Rotary Air Rotary Cable

5/10/90 5/16/90 5/16/90

Spud Date Date Reached TD Completion Date

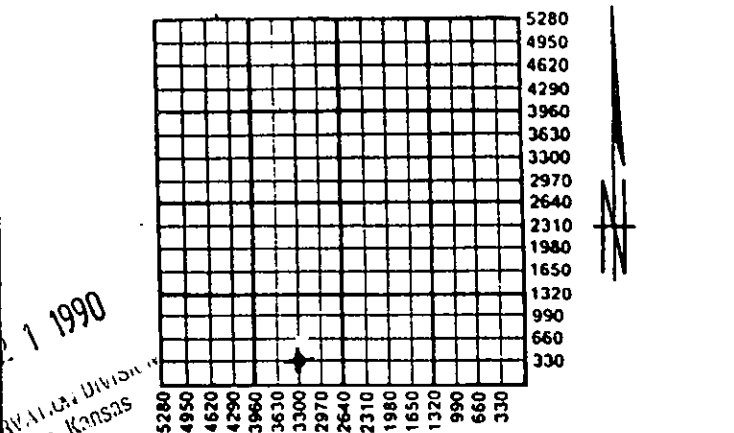

MAY 1 1990
CONSERVATION DIVISION
Wichita, Kansas

Amount of Surface Pipe Set and Cemented at 286' Feet

Multiple Stage Cementing Collar Used? Yes No

If yes, show depth set _____ Feet

If Alternate II completion, cement circulated from N/A

feet depth to _____ w/ _____ SX cmt.

INSTRUCTIONS: This form shall be completed in triplicate and filed with the Kansas Corporation Commission, 200 Colorado Derby Building, Wichita, Kansas 67202, within 120 days of the spud date of any well. Rule 82-3-130, 82-3-107 and 82-3-106 apply. Information on side two of this form will be held confidential for a period of 12 months if requested in writing and submitted with the form. See rule 82-3-107 for confidentiality in excess of 12 months. One copy of all wireline logs and drillers time log shall be attached with this form. ALL CEMENTING TICKETS MUST BE ATTACHED. Submit CP-4 form with all plugged wells. Submit CP-111 form with all temporarily abandoned wells. Any recompletion, workover or conversion of a well requires filing of ACO-2 within 120 days from commencement date of such work.

All requirements of the statutes, rules and regulations promulgated to regulate the oil and gas industry have been fully complied with and the statements herein are complete and correct to the best of my knowledge.

Signature William L. Anderson

Title Secretary-Treasurer Date 5/17/90

Subscribed and sworn to before me this 17th day of May, 1990.

Notary Public Wilma E. Clark

WILMA E. CLARK
Notary Public
STATE OF KANSAS
My Appt. Exp. Aug. 5, 1992

K.C.C. OFFICE USE ONLY

Letter of Confidentiality Attached

Wireline Log Received

Drillers Timelog Received

Distribution

KCC SMD/Rep NGPA

KGS Plug Other (Specify)

P1 X

SIDE TWO

Operator Name Anderson Energy, Inc. Lease Name Fletcher Well # 1

Sec. 19 Twp. 16 Rge. 20 East West
 County Rush

INSTRUCTIONS: Show important tops and base of formations penetrated. Detail all cores. Report all drill stem tests giving interval tested, time tool open and closed, flowing and shut-in pressures, whether shut-in pressure reached static level, hydrostatic pressures, bottom hole temperature, fluid recovery, and flow rates if gas to surface during test. Attach extra sheet if more space is needed. Attach copy of log.

Drill Stem Tests Taken <input checked="" type="checkbox"/> Yes <input type="checkbox"/> No (Attach Additional Sheets.) Samples Sent to Geological Survey <input checked="" type="checkbox"/> Yes <input type="checkbox"/> No Cores Taken <input type="checkbox"/> Yes <input checked="" type="checkbox"/> No Electric Log Run <input checked="" type="checkbox"/> Yes <input type="checkbox"/> No (Submit Copy.) DST #1: <u>4056-4078</u> (Pawnee Sand) DST #2: <u>4054-4108</u> <u>40 (30) 20</u> (Cherokee Sand) Flush both openings 20 (30) 10 (30) No blow 2nd open; out with tool. Rec. 245' watery mud Rec. 5' mud & 300' water All pressures 31# IFP 85-180# FFP 265-280# ISIP 755# FSIP 755#	<table border="1" style="width:100%; border-collapse: collapse;"> <tr> <th colspan="3">Formation Description</th> </tr> <tr> <td></td> <td align="center"><input checked="" type="checkbox"/> Log</td> <td align="center"><input type="checkbox"/> Sample</td> </tr> <tr> <th>Name</th> <th>Top</th> <th>Bottom</th> </tr> <tr> <td>Anhydrite</td> <td></td> <td>1496 (+725)</td> </tr> <tr> <td>B/Anhydrite</td> <td></td> <td>1530 (+691)</td> </tr> <tr> <td>Heebner</td> <td></td> <td>3604 (-1383)</td> </tr> <tr> <td>Toronto</td> <td></td> <td>3625 (-1404)</td> </tr> <tr> <td>Lansing</td> <td></td> <td>3649 (-1428)</td> </tr> <tr> <td>BKC</td> <td></td> <td>3916 (-1695)</td> </tr> <tr> <td>Pawnee</td> <td></td> <td>3990 (-1769)</td> </tr> <tr> <td>Labette Shale</td> <td></td> <td>4055 (-1834)</td> </tr> <tr> <td>Ft. Scott</td> <td></td> <td>4077 (-1856)</td> </tr> <tr> <td>Reworked Miss.</td> <td></td> <td>4168 (-1947)</td> </tr> <tr> <td>TD</td> <td></td> <td>4181 (-1960)</td> </tr> </table>	Formation Description				<input checked="" type="checkbox"/> Log	<input type="checkbox"/> Sample	Name	Top	Bottom	Anhydrite		1496 (+725)	B/Anhydrite		1530 (+691)	Heebner		3604 (-1383)	Toronto		3625 (-1404)	Lansing		3649 (-1428)	BKC		3916 (-1695)	Pawnee		3990 (-1769)	Labette Shale		4055 (-1834)	Ft. Scott		4077 (-1856)	Reworked Miss.		4168 (-1947)	TD		4181 (-1960)
Formation Description																																											
	<input checked="" type="checkbox"/> Log	<input type="checkbox"/> Sample																																									
Name	Top	Bottom																																									
Anhydrite		1496 (+725)																																									
B/Anhydrite		1530 (+691)																																									
Heebner		3604 (-1383)																																									
Toronto		3625 (-1404)																																									
Lansing		3649 (-1428)																																									
BKC		3916 (-1695)																																									
Pawnee		3990 (-1769)																																									
Labette Shale		4055 (-1834)																																									
Ft. Scott		4077 (-1856)																																									
Reworked Miss.		4168 (-1947)																																									
TD		4181 (-1960)																																									

CASING RECORD New Used
 Report all strings set-conductor, surface, intermediate, production, etc.

Purpose of String	Size Hole Drilled	Size Casing Set (In O.D.)	Weight Lbs./Ft.	Setting Depth	Type of Cement	# Sacks Used	Type and Percent Additives
surface	12-1/4"	8-5/8"	20#	286'	60/40 Poz.	160	2% gel, 3% c.c.

Shots Per Foot	Specify Footage of Each Interval Perforated	Acid, Fracture, Shot, Cement Squeeze Record (Amount and Kind of Material Used)	Depth

TUBING RECORD Size _____ Set At _____ Packer At _____ Liner Run Yes No

Date of First Production	Producing Method <input type="checkbox"/> Flowing <input type="checkbox"/> Pumping <input type="checkbox"/> Gas Lift <input type="checkbox"/> Other (Explain)		
Estimated Production Per 24 Hours	Oil Bbls.	Gas Mcf	Water Bbls.
			Gas-Oil Ratio
			Gravity

Disposition of Gas: Vented Sold Used on Lease (If vented, submit ACO-18.)

METHOD OF COMPLETION

Open Hole Perforation Dually Completed Commingled

Other (Specify) _____

Production Interval _____