

15-165-00282-0000

STATE OF KANSAS CORPORATION COMMISSION

WELL PLUGGING RECORD

Give All Information Completely Make Required Affidavit Mail or Deliver Report to: Conservation Division State Corporation Commission 212 North Market, Insurance Bldg. Wichita, Kansas

Rush County. Sec. 35 Twp. 16S Rge. (E) 19W Location as "NE/CNW&SW" or footage from lines SE SE SW Lease Owner John O. Farmer, Inc. Lease Name Herrman "B" Well No. 1 Office Address 370 W. Wichita, Russell, Kansas Character of Well (completed as Oil, Gas or Dry Hole) Dry Date well completed Application for plugging filed 12/9 19 61 Application for plugging approved 12/9 19 61 Plugging commenced 12/9 19 61 Plugging completed 12/9 19 61 Reason for abandonment of well or producing formation Dry

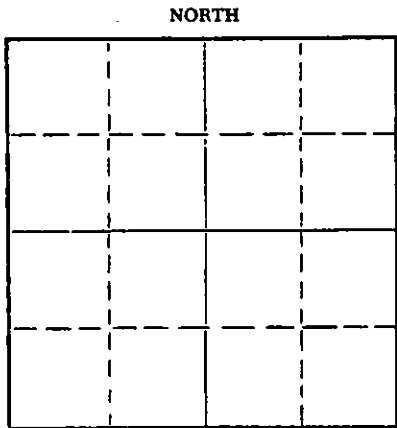

If a producing well is abandoned, date of last production 19 Was permission obtained from the Conservation Division or its agents before plugging was commenced? Yes

Name of Conservation Agent who supervised plugging of this well Eldon Petty Producing formation Depth to top Bottom Total Depth of Well 3809 Feet Show depth and thickness of all water, oil and gas formations.

OIL, GAS OR WATER RECORDS

CASING RECORD

Table with 7 columns: FORMATION, CONTENT, FROM, TO, SIZE, PUT IN, PULLED OUT. The table is currently empty.

Describe in detail the manner in which the well was plugged, indicating where the mud fluid was placed and the method or methods used in introducing it into the hole. If cement or other plugs were used, state the character of same and depth placed, from feet to feet for each plug set.

First Plug at 480' with 20 sacks cement. Second Plug at 200' with 20 sacks cement Third Plug at 35' with 10 sacks cement.

RECEIVED STATE CORPORATION COMMISSION DEC 14 1961 12-14-61 CON DIVISION

(If additional description is necessary, use BACK of this sheet) Name of Plugging Contractor John O. Farmer, Inc. Address P. O. Box 352, Russell, Kansas

STATE OF Kansas COUNTY OF Russell ss. John O. Farmer (employee of owner) or (owner or operator) of the above-described well, being first duly sworn on oath, says: That I have knowledge of the facts, statements, and matters herein contained and the log of the above-described well as filed and that the same are true and correct. So help me God.

(Signature) John O. Farmer President 370 W. Wichita, Russell, Kansas (Address)

SUBSCRIBED AND SWORN TO before me this 11th day of December, 19 61

My commission expires 5/18/64 Dorothy Ratts Notary Public.

OPERATOR John O. Farmer, Inc.

FORMATION RECORD

ADDRESS P. O. Box 352, Russell, Kansas

Give detailed description and thickness of all formation drilled through, contents of sand, whether dry, water, oil or gas.

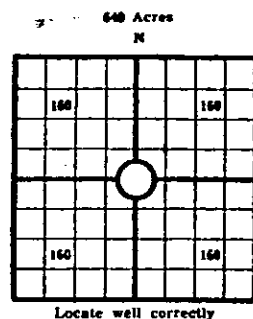

COUNTY Push SEC 35 TWP 16S RGE 19W
 COMPANY OPERATING John O. Farmer, Inc.
 OFFICE ADDRESS 370 W. Wichita, Russell, Kns.
 DRILLING STARTED 11/28 1961 DRILLING FINISHED 12/9, 1961
 DATE OF FIRST PRODUCTION _____ COMPLETED _____
 WELL LOCATED SE $\frac{1}{4}$ SE $\frac{1}{4}$ SW $\frac{1}{4}$ 330, North of South
 Line and 330 ft. East of West Line of Quarter Section
 Elevation (Relative to sea level) DERRICK FLOOR 2084 FT. GROUND,
 CHARACTER OF WELL (Oil, gas or dryhole) Dry

OIL OR GAS SANDS OR ZONES

Name	From	To	Name	From	To
1			4		
2			5		
3			6		

Perforating Record if Any

Shot Record

Formation	From	To	No. of Shots	Formation	From	To	Size of Shot

CASING RECORD

Amount Set							Amount Pulled		Packer Record		
Size	Wt.	Thds.	Make	Ft.	In.	Ft.	In.	Size	Length	Depth Set	Make

Liner Record: Amount _____ Kind _____ Top _____ Bottom _____

CEMENTING AND MUDDING

Size	Amount Set		Sacks Cement	Chemical		Method of Cementing	Amount	Mudding Method	Results (See Note)
	Ft.	In.		Gal.	Make				
8 5/8	162		115						

Note: What method was used to protect sands if outer strings were pulled?

NOTE: Were bottom hole plugs used? _____ If so, state kind, depth set and results obtained _____

TOOLS USED

Rotary Tools were used from 0 feet to 3809 feet. Cable tools were used from _____ feet to _____ feet, and from _____ feet to _____ feet, and from _____ feet to _____ feet.

Type Rig Rotary

INITIAL PRODUCTION TEST

Describe initial test: whether by flow through tubing or casing or by pumping _____

Amount of Oil Production _____ bbls. Size of choke, if any _____ Length of test _____ Water
 Production _____ bbls. Gravity of oil _____ Type of Pump if pump is used, describe _____

Formation	Top	Bottom	Formation	Top	Bottom
Surface	0	162			
Shale	162	525	TOPS: Log		
Shale & Sand	535	675	Huebner	3382	(-1298)
Sand	675	880	Toronto	3402	(-1318)
Shale, Redbed,			Lansing/KC	3428	(-1344)
Shells	880	1050	Marmathon Chert	3733	(-1649)
Shale & Shells	1050	1263	Reagan (Shaley)	3776	(-1692)
Anhydrite	1263	1308	Reagan	3788	(-1704)
Shale & Shells	1308	1690	T. D.	3809	(-1725)
Shale & Salt	1690	1990			
Shale & Lime	1990	2190			
Lime & Shale	2190	2530			
Shale & Lime	2530	3175			
Lime & Shale	3175	3669			
Lime	3669	3715			
Lime & Shale	3715	3809			
T. D.	3809				

RECEIVED
 STATE CORPORATION COMMISSION
 DEC 14 1961
 REGISTRATION DIVISION

I, the undersigned, being first duly sworn upon oath, state that this well record is true, correct and complete according to the records of this office and to the best of my knowledge and belief.

John O. Farmer
 President
 Name and title of representative of company

Subscribed and sworn to before me this 12th day of December, 1961

My Commission expires 5/18/64

Dorothy Dorothy Ratter
 Notary Public.

15-165-00282-0000

RGE, TWP, SEC, COUNTY, WELL NO.