

For KCC Use: 11-19-2012
Effective Date: 1
District # 1
SGA? ☒ Yes ☐ No

KANSAS CORPORATION COMMISSION
OIL & GAS CONSERVATION DIVISION

Form CB-1
March 2010
Form must be Typed
Form must be Signed
All blanks must be Filled

CATHODIC PROTECTION BOREHOLE INTENT

Must be approved by the KCC sixty (60) days prior to commencing well.
Form KSONA-1, Certification of Compliance with the Kansas Surface Owner Notification Act, MUST be submitted with this form.

Expected Spud Date: January 15 2013
month day year

OPERATOR: License# 34040
Name: REGENCY FIELD SERVICE
Address 1: PO BOX 967
Address 2: _____
City: BEAVER State: OK Zip: 73932 + _____
Contact Person: CURTIS PATRICK
Phone: 580-216-0047

CONTRACTOR: License# 32775
Name: MCLEAN'S CP INSTALLATION, INC
Type Drilling Equipment: ☒ Mud Rotary ☐ Cable
☐ Air Rotary ☐ Other

Construction Features

Length of Cathodic Surface (Non-Metallic) Casing
Planned to be set: 20 feet
Length of Conductor pipe (if any): _____ feet
Surface casing borehole size: 17 1/2"-20", 10"-280" inches
Cathodic surface casing size: 10 3/4" inches
Cathodic surface casing centralizers set at depths of: 20'; _____;
_____; _____; _____; _____; _____;
Cathodic surface casing will terminate at:
☐ Above surface ☐ Surface Vault ☒ Below Surface _____
Pitless casing adaptor will be used: ☐ Yes ☒ No Depth _____ feet
Anode installation depths are: 290'; 280'; 270'; 260'; 250';
240'; 230'; 220'; 210'; 200'; 190'; 180'; 170';
160'; 150'

AFFIDAVIT

The undersigned hereby affirms that the drilling, completion and eventual plugging of this well will comply with K.S.A. 55-101 et. seq.

It is agreed that the following minimum requirements will be met:

1. Notify the appropriate District office prior to spudding and again before plugging the well. An agreement between the operator and the District Office on plugs and placement is necessary prior to plugging. In all cases, notify District Office prior to any grouting.
2. Notify appropriate District Office 48 hours prior to workover or re-entry.
3. A copy of the approved notice of intent to drill shall be posted on each drilling rig.
4. The minimum amount of cathodic surface casing as specified below shall be set by grouting to the top when the cathodic surface casing is set.
5. File all required forms: a. File Drill Pit Application (form CDP-1) with Intent to Drill (form CB-1). b. File Certification of Compliance with Kansas Surface Owner Notification Act (form KSONA-1) with Cathodic Protection Borehole Intent (CB-1) c. File Completion Form (ACO-1) within 30 days from spud date.
d. Submit plugging report (CP-4) within 30 days after final plugging is completed.

I hereby certify that the statements made herein are true and to the best of my knowledge and belief.

Date: 07 Nov 2012 Signature of Operator or Agent: [Signature] Title: Operations Manager

For KCC Use ONLY

API # 15 - 119-21330-0000
Conductor pipe required None feet
Minimum Cathodic Surface Casing Required: 20 feet A43
Approved by: Kurt 11-14-2012
This authorization expires: 11-14-2013
(This authorization void if drilling not started within 12 months of approval date.)
Spud date: _____ Agent: _____

If this permit has expired or will not be drilled, check a box below, sign, date and return to the address below.

☐ Permit Expired ☐ Well Not Drilled

Date

Signature of Operator or Agent

KGC16

RECEIVED

NOV 13 2012

KCC WICHITA

4
35
30
E
W

For KCC Use ONLY

API # 15 - 119-21330-0000**IN ALL CASES, PLEASE FULLY COMPLETE THIS SIDE OF THE FORM.**

In all cases, please fully complete this side of the form. Include items 1 through 3 at the bottom of this page.

Operator: REGENCY FIELD SERVICE
 Facility Name: REGENCY
 Borehole Number: 1

Location of Well: County: MEADE
2,904 feet from ☒ N / ☐ S Line of Section
264 feet from ☒ E / ☐ W Line of Section
 Sec. 4 Twp. 35 S. R. 30 ☐ E ☒ W

Is Section: ☒ Regular or ☐ Irregular

If Section is Irregular, locate well from nearest corner boundary.

Section corner used: ☐ NE ☐ NW ☐ SE ☐ SW

PLAT

Show location of the Cathodic Borehole. Show footage to the nearest lease or unit boundary line. Show the predicted locations of lease roads, tank batteries, pipelines and electrical lines, as required by the Kansas Surface Owner Notice Act (House Bill 2032).

You may attach a separate plat if desired.

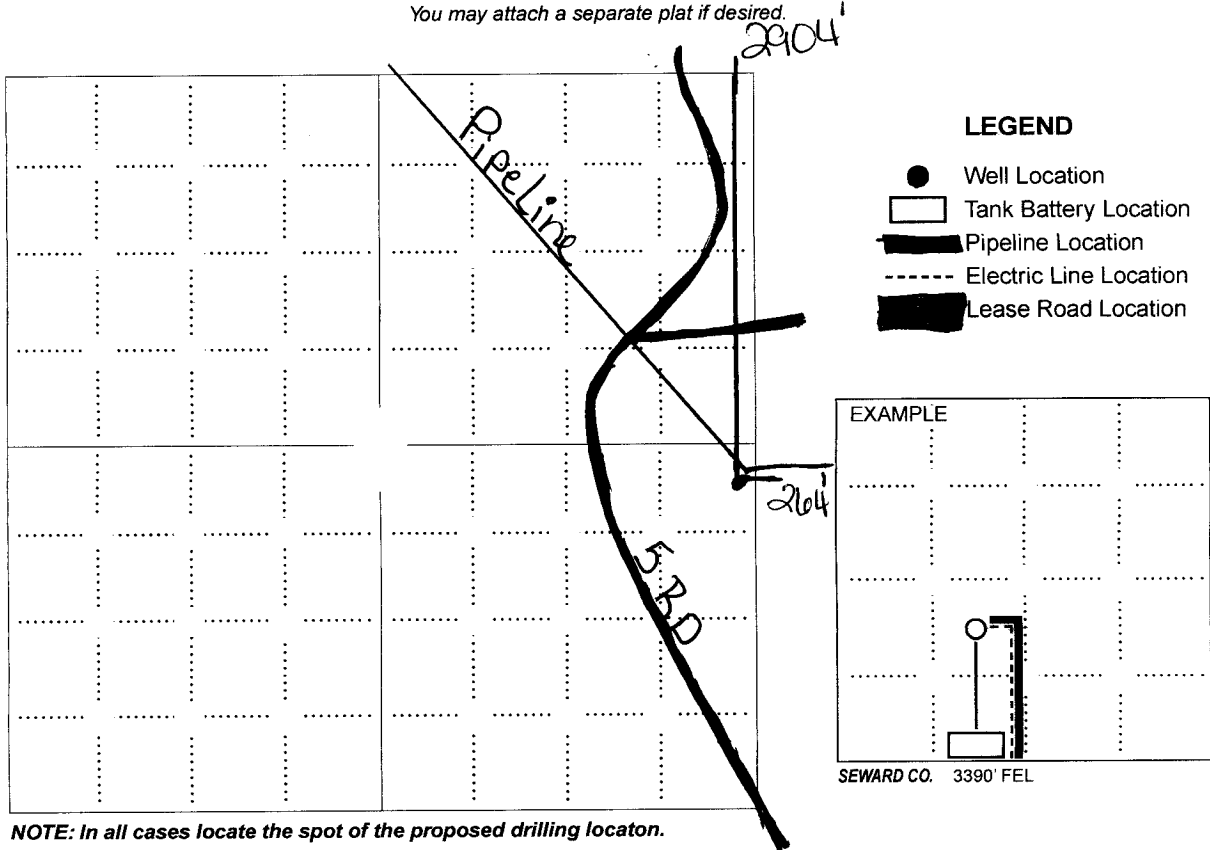

In plotting the proposed location of the well, you must show:

1. The manner in which you are using the depicted plat by identifying section lines, i.e. 1 section, 1 section with 8 surrounding sections, 4 sections, etc.;
2. The distance of the proposed drilling location from the section's south / north and east / west; line.
3. The predicted locations of lease roads, tank batteries, pipelines, and electrical lines.

RECEIVED

NOV 13 2012

KCC WICHITA

KANSAS CORPORATION COMMISSION
OIL & GAS CONSERVATION DIVISION

Form KSONA-1
July 2010
Form Must Be Typed
Form must be Signed
All blanks must be Filled

**CERTIFICATION OF COMPLIANCE WITH THE
KANSAS SURFACE OWNER NOTIFICATION ACT**

15-119-21330-0000

This form must be submitted with all Forms C-1 (Notice of Intent to Drill); CB-1 (Cathodic Protection Borehole Intent); T-1 (Request for Change of Operator Transfer of Injection or Surface Pit Permit); and CP-1 (Well Plugging Application). Any such form submitted without an accompanying Form KSONA-1 will be returned.

Select the corresponding form being filed: ☐ C-1 (Intent) ☒ CB-1 (Cathodic Protection Borehole Intent) ☐ T-1 (Transfer) ☐ CP-1 (Plugging Application)

OPERATOR: License # 34040
Name: REGENCY FIELD SERVICE
Address 1: PO BOX 967
Address 2: _____
City: BEAVER State: OK Zip: 73932 + _____
Contact Person: CURTIS PATRICK
Phone: (580) 216-0047 Fax: (580) 487-3864
Email Address: CURTIS.PATRICK@ENERGYTRANSFER.COM

Well Location:
NE NE SE Sec. 4 Twp. 35 S. R. 30 ☐ East ☒ West
County: MEADE
Lease Name: REGENCY Well #: 1

If filing a Form T-1 for multiple wells on a lease, enter the legal description of the lease below:

Surface Owner Information:

Name: JOHN C. ADAMS
Address 1: 32036 5 RD
Address 2: _____
City: PLAINS State: KS Zip: 67869 + 9101

When filing a Form T-1 involving multiple surface owners, attach an additional sheet listing all of the information to the left for each surface owner. Surface owner information can be found in the records of the register of deeds for the county, and in the real estate property tax records of the county treasurer.

If this form is being submitted with a Form C-1 (Intent) or CB-1 (Cathodic Protection Borehole Intent), you must supply the surface owners and the KCC with a plat showing the predicted locations of lease roads, tank batteries, pipelines, and electrical lines. The locations shown on the plat are preliminary non-binding estimates. The locations may be entered on the Form C-1 plat, Form CB-1 plat, or a separate plat may be submitted.

Select one of the following:

- ☒ I certify that, pursuant to the Kansas Surface Owner Notice Act (House Bill 2032), I have provided the following to the surface owner(s) of the land upon which the subject well is or will be located: 1) a copy of the Form C-1, Form CB-1, Form T-1, or Form CP-1 that I am filing in connection with this form; 2) if the form being filed is a Form C-1 or Form CB-1, the plat(s) required by this form; and 3) my operator name, address, phone number, fax, and email address.
- ☐ I have not provided this information to the surface owner(s). I acknowledge that, because I have not provided this information, the KCC will be required to send this information to the surface owner(s). To mitigate the additional cost of the KCC performing this task, I acknowledge that I am being charged a \$30.00 handling fee, payable to the KCC, which is enclosed with this form.

If choosing the second option, submit payment of the \$30.00 handling fee with this form. If the fee is not received with this form, the KSONA-1 form and the associated Form C-1, Form CB-1, Form T-1, or Form CP-1 will be returned.

I hereby certify that the statements made herein are true and correct to the best of my knowledge and belief.

Date: 07 Nov 2012 Signature of Operator or Agent: [Signature] Title: Operator, manager

RECEIVED

NOV 13 2012

KCC WICHITA

KANSAS CORPORATION COMMISSION
OIL & GAS CONSERVATION DIVISION

Form KSONA-1
July 2010
Form Must Be Typed
Form must be Signed
All blanks must be Filled

**CERTIFICATION OF COMPLIANCE WITH THE
KANSAS SURFACE OWNER NOTIFICATION ACT**

15-119-21330-0000

This form must be submitted with all Forms C-1 (Notice of Intent to Drill); CB-1 (Cathodic Protection Borehole Intent); T-1 (Request for Change of Operator Transfer of Injection or Surface Pit Permit); and CP-1 (Well Plugging Application).
Any such form submitted without an accompanying Form KSONA-1 will be returned.

Select the corresponding form being filed: ☐ C-1 (Intent) ☒ CB-1 (Cathodic Protection Borehole Intent) ☐ T-1 (Transfer) ☐ CP-1 (Plugging Application)

OPERATOR: License # 34040
Name: REGENCY FIELD SERVICE
Address 1: PO BOX 967
Address 2: _____
City: BEAVER State: OK Zip: 73932 + _____
Contact Person: CURTIS PATRICK
Phone: (580) 216-0047 Fax: (580) 487-3864
Email Address: CURTIS.PATRICK@ENERGYTRANSFER.COM

Well Location:
NE NE SE Sec. 4 Twp. 35 S. R. 30 ☐ East ☒ West
County: MEADE
Lease Name: REGENCY Well #: 1

If filing a Form T-1 for multiple wells on a lease, enter the legal description of the lease below:

Surface Owner Information:

Name: CLAY S. ADAMS
Address 1: 73 RR 1
Address 2: _____
City: FORGAN State: OK Zip: 73939 + 9750

When filing a Form T-1 involving multiple surface owners, attach an additional sheet listing all of the information to the left for each surface owner. Surface owner information can be found in the records of the register of deeds for the county, and in the real estate property tax records of the county treasurer.

If this form is being submitted with a Form C-1 (Intent) or CB-1 (Cathodic Protection Borehole Intent), you must supply the surface owners and the KCC with a plat showing the predicted locations of lease roads, tank batteries, pipelines, and electrical lines. The locations shown on the plat are preliminary non-binding estimates. The locations may be entered on the Form C-1 plat, Form CB-1 plat, or a separate plat may be submitted.

Select one of the following:

- ☒ I certify that, pursuant to the Kansas Surface Owner Notice Act (House Bill 2032), I have provided the following to the surface owner(s) of the land upon which the subject well is or will be located: 1) a copy of the Form C-1, Form CB-1, Form T-1, or Form CP-1 that I am filing in connection with this form; 2) if the form being filed is a Form C-1 or Form CB-1, the plat(s) required by this form; and 3) my operator name, address, phone number, fax, and email address.
- ☐ I have not provided this information to the surface owner(s). I acknowledge that, because I have not provided this information, the KCC will be required to send this information to the surface owner(s). To mitigate the additional cost of the KCC performing this task, I acknowledge that I am being charged a \$30.00 handling fee, payable to the KCC, which is enclosed with this form.

If choosing the second option, submit payment of the \$30.00 handling fee with this form. If the fee is not received with this form, the KSONA-1 form and the associated Form C-1, Form CB-1, Form T-1, or Form CP-1 will be returned.

I hereby certify that the statements made herein are true and correct to the best of my knowledge and belief.

Date: 07 Nov 2012 Signature of Operator or Agent: [Signature] Title: Operations Manager

RECEIVED

NOV 13 2012

KCC WICHITA

**KANSAS CORPORATION COMMISSION
OIL & GAS CONSERVATION DIVISION
APPLICATION FOR SURFACE PIT**

Form CDP-1
May 2010
Form must be Typed

Submit in Duplicate

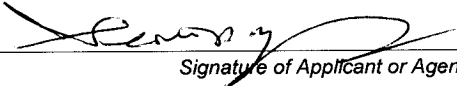
Operator Name: REGENCY FIELD SERVICE		License Number: 34040
Operator Address: PO BOX 967		BEAVER OK 73932
Contact Person: CURTIS PATRICK		Phone Number: 580-216-0047
Lease Name & Well No.: REGENCY 1		Pit Location (QQQQ): NE - NE - SE - Sec. 4 Twp. 35 R. 30 <input type="checkbox"/> East <input checked="" type="checkbox"/> West 2,904 Feet from <input checked="" type="checkbox"/> North / <input type="checkbox"/> South Line of Section 264 Feet from <input checked="" type="checkbox"/> East / <input type="checkbox"/> West Line of Section MEADE County
Type of Pit: <input type="checkbox"/> Emergency Pit <input type="checkbox"/> Burn Pit <input type="checkbox"/> Settling Pit <input checked="" type="checkbox"/> Drilling Pit <input type="checkbox"/> Workover Pit <input type="checkbox"/> Haul-Off Pit <small>(If WP Supply API No. or Year Drilled)</small>	Pit is: <input checked="" type="checkbox"/> Proposed <input type="checkbox"/> Existing If Existing, date constructed: _____ Pit capacity: _____ (bbls)	
Is the pit located in a Sensitive Ground Water Area? <input checked="" type="checkbox"/> Yes <input checked="" type="checkbox"/> No		Chloride concentration: _____ mg/l <small>(For Emergency Pits and Settling Pits only)</small>
Is the bottom below ground level? <input checked="" type="checkbox"/> Yes <input type="checkbox"/> No	Artificial Liner? <input checked="" type="checkbox"/> Yes <input type="checkbox"/> No	How is the pit lined if a plastic liner is not used?
Pit dimensions (all but working pits): 15 Length (feet) 6 Width (feet) <input type="checkbox"/> N/A: Steel Pits Depth from ground level to deepest point: 6 (feet) <input type="checkbox"/> No Pit		
If the pit is lined give a brief description of the liner material, thickness and installation procedure. 6M BLACK PLASTIC LINER LAYED IN PIT AND EDGES ARE SECURED TO PIT		Describe procedures for periodic maintenance and determining liner integrity, including any special monitoring. PIT WILL ONLY BE USED FOR A 2-3 DAY PERIOD, AND THEN THE PIT WILL BE BACKFILLED.
Distance to nearest water well within one-mile of pit: _____ feet Depth of water well _____ feet		Depth to shallowest fresh water _____ feet. Source of information: <input type="checkbox"/> measured <input type="checkbox"/> well owner <input type="checkbox"/> electric log <input type="checkbox"/> KDWR
Emergency, Settling and Burn Pits ONLY: Producing Formation: _____ Number of producing wells on lease: _____ Barrels of fluid produced daily: _____ Does the slope from the tank battery allow all spilled fluids to flow into the pit? <input type="checkbox"/> Yes <input type="checkbox"/> No		Drilling, Workover and Haul-Off Pits ONLY: Type of material utilized in drilling/workover: _____ Number of working pits to be utilized: _____ Abandonment procedure: _____ Drill pits must be closed within 365 days of spud date.
I hereby certify that the above statements are true and correct to the best of my knowledge and belief. <div style="display: flex; justify-content: space-between;"><div><u>07 Nov 2012</u> Date</div><div> Signature of Applicant or Agent</div></div>		

15-119-21330-0047

RECEIVED

NOV 13 2012

KCC WICHITA

KCC OFFICE USE ONLY			
		<input type="checkbox"/> Liner	<input type="checkbox"/> Steel Pit
		<input type="checkbox"/> RFAC	<input type="checkbox"/> RFAS
Date Received: <u>11-14-12</u>	Permit Number: _____	Permit Date: <u>11-14-12</u>	Lease Inspection: <input type="checkbox"/> Yes <input checked="" type="checkbox"/> No

Mail to: KCC - Conservation Division, 130 S. Market - Room 2078, Wichita, Kansas 67202