

STATE CORPORATION COMMISSION OF KANSAS  
OIL & GAS CONSERVATION DIVISION  
WELL COMPLETION OR RECOMPLETION FORM  
ACO-1 WELL HISTORY  
DESCRIPTION OF WELL AND LEASE

API NO. 15-135-23,348-0000  
County Ness  
40' N of S/2 NE NW Sec 17 Twp 18 Rge 24 East XX West

Operator: License # 5663  
Name Hess Oil Company  
Address P.O. Box 1009  
City/State/Zip McPherson, KS 67460

4330 Ft North from Southeast Corner of Section  
3300 Ft West from Southeast Corner of Section  
(Note: Locate well in section plat below)

Purchaser

Lease Name Rufenacht Well # 1

Operator Contact Person Bryan Hess  
Phone 316-241-4640

Field Name

Producing Formation

Elevation: Ground 2321' KB 2329'

Contractor: License # 4958  
Name Mallard JV Inc

Wellsite Geologist James C. Hess  
Phone 316-263-2243

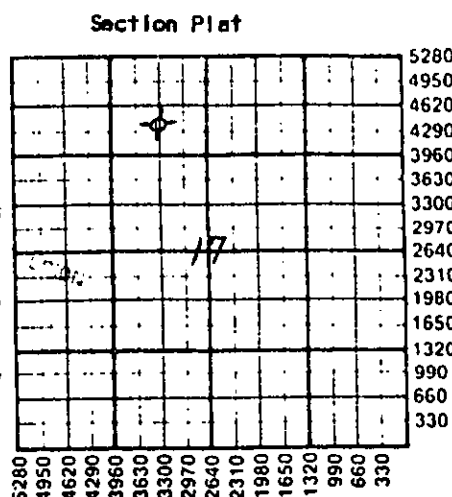

STATE RECEIVED  
7-13-89  
JUL 13 1989  
COMMERCIAL  
WICHITA, KANS.

Designate Type of Completion  
X New Well Re-Entry Workover  
Oil SWD Temp Abd  
Gas Inj Delayed Comp.  
X Dry Other (Core, Water Supply etc.)

If ONWO: old well info as follows:  
Operator  
Well Name  
Comp. Date Old Total Depth

WATER SUPPLY INFORMATION

Disposition of Produced Water: Disposal  
Docket # Repressuring

WELL HISTORY

Drilling Method:  
X Mud Rotary Air Rotary Cable  
5-29-89 6-5-89 6-5-89  
Spud Date Date Reached TD Completion Date  
4380' PBDT  
Total Depth

Questions on this portion of the ACO-1 call:  
Water Resources Board (913) 296-3717  
Source of Water:  
Division of Water Resources Permit #  
Groundwater Ft North from Southeast Corner (Well) Ft West from Southeast Corner of Sec Twp Rge East West  
X Surface Water Ft North from Southeast Corner (Stream, pond etc) Ft West from Southeast Corner NE/4 Sec 31 Twp 17 Rge 24 East XX West  
Other (explain) (purchased from city, R.W.D. #)

Amount of Surface Pipe Set and Cemented at 212 feet  
Multiple Stage Cementing Collar Used? Yes No  
If yes, show depth set feet  
If alternate 2 completion, cement circulated from feet depth to w/ SX cmt  
Cement Company Name  
Invoice # A1-D 280

INSTRUCTIONS: This form shall be completed in triplicate and filed with the Kansas Corporation Commission, 200 Colorado Derby Building, Wichita, Kansas 67202, within 120 days of the spud date of any well. Rule 82-3-130, 82-3-107 and 82-3-106 apply. Information on side two of this form will be held confidential for a period of 12 months if requested in writing and submitted with the form. See rule 82-3-107 for confidentiality in excess of 12 months. One copy of all wireline logs and drillers time log shall be attached with this form. Submit CP-4 form with all plugged wells. Submit CP-111 form with all temporarily abandoned wells.

All requirements of the statutes, rules and regulations promulgated to regulate the oil and gas industry have been fully complied with and the statements herein are complete and correct to the best of my knowledge.

Signature Bryan Hess  
Title Manager Date 7-12-89

Subscribed and sworn to before me this 12th day of July 1989  
Notary Public  
Date Commission Expires 11-15-89

K.C.C. OFFICE USE ONLY  
F Letter of Confidentiality Attached  
C Wireline Log Received  
C Drillers Timelog Received  
Distribution  
KCC SWD/Rep NGPA  
KGS Plug Other  
(Specify)

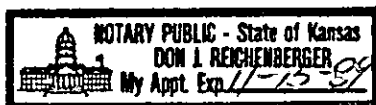

Sec 17 Twp 18 Rge 24

Operator Name Hess Oil Company Lease Name Rufenacht Well # 1

Sec. 17 Twp. 18 Rge. 24 East West County Ness

WELL LOG

INSTRUCTIONS: Show important tops and base of formations penetrated. Detail all cores. Report all drill stem tests giving interval tested, time tool open and closed, flowing and shut-in pressures, whether shut-in pressure reached static level, hydrostatic pressures, bottom hole temperature, fluid recovery, and flow rates if gas to surface during test. Attach extra sheet if more space is needed. Attach copy of log.

Drill Stem Tests Taken  Yes  No  
 Samples Sent to Geological Survey  Yes  No  
 Cores Taken  Yes  No

Formation Description  
 Log  Sample

DST #1: 4255' - 4345'. 30-30-45-0.  
 Recovered 40' water cut mud (88% mud, 12% salt water). Pressures: IH 2213, FH 2181, IF 85-87, FF 89-89, ISIP 189, FSIP none.

Name	Top	Bottom
Anhydrite	1614	(+715)
B/Anhydrite	1647	(+682)
Heebner	3699	(-1370)
Lansing	3740	(-1411)
Stark Shale	4023	(-1694)
B/KC	4074	(-1745)
Pawnee	4166	(-1837)
Fort Scott	4245	(-1916)
Cherokee Shale	4271	(-1942)
Cherokee Sand	4333	(-2004)
Miss. Dolomite	4372	(-2043)
R.T.D.	4380	(-2051)

CASING RECORD <input type="checkbox"/> New <input checked="" type="checkbox"/> Used Report all strings set-conductor, surface, intermediate, production, etc.							
Purpose of String	Size Hole Drilled	Size Casing Set (in O.D.)	Weight Lbs/Ft.	Setting Depth	Type of Cement	#Sacks Used	Type and Percent Additives
Surface	12 1/4"	8-5/8"	20#	212'	60/40Poz	140	3%cc 2%gel
PERFORATION RECORD				Acid, Fracture, Shot, Cement Squeeze Record			
Shots Per Foot	Specify Footage of Each Interval Perforated			(Amount and Kind of Material Used)		Depth	
TUBING RECORD				Size	Set At	Packer at	Liner Run <input type="checkbox"/> Yes <input type="checkbox"/> No
Date of First Production	Producing Method <input type="checkbox"/> Flowing <input type="checkbox"/> Pumping <input type="checkbox"/> Gas Lift <input type="checkbox"/> Other (explain).....						
Estimated Production Per 24 Hours	Oil	Gas	Water	Gas-Oil Ratio	Gravity		
	Bbls	MCF	Bbls	CFPB			

METHOD OF COMPLETION

Production Interval

Disposition of gas:  Vented  Open Hole  Perforation  
 Sold  Other (Specify) .....  
 Used on Lease  Dually Completed .....  
 Commingled

MALLARD JV, INC.  
P.O. BOX 1009  
McPHERSON, KS 67460

DRILLERS' LOG

OPERATOR: Hess Oil Company  
P.O. Box 1009  
McPherson, KS 67460

WELL: Rufenacht #1

API#: 15-135-23,348 -0000

COMMENCED: May 29, 1989

LOCATION: 40' N of S/2 NE NW

COMPLETED: June 5, 1989

4330 Ft. FSL, 3300 Ft. FEL

TOTAL DEPTH: 4380 Ft.

SEC. 17 TWP. 18 S RGE. 24 W

ELEVATION: 2321 Ft. G.L.

COUNTY: Ness

2329 Ft. K.B.

\*\*\*\*\*

REMARKS

Cut 12 1/4" hole to 215' and ran 5 joints 8-5/8" x 20# x 203' surface casing.  
Set at 212' and cemented with 140 sacks 60/40 Pozmix, 3% cc, 2% gel. P.D.  
@ 10:40 p.m. 5-29-89.

Drilled 7-7/8" hole to 4380' R.T.D. cherokee sand, and ran 1 DST.

Plugged hole with 215 sacks 60/40 Pozmix, 6% gel as follows:

- 50 sx @ 1650'
- 80 sx @ 900'
- 50 sx @ 240'
- 10 sx @ 40' w/wood plug
- 15 sx R.H., 10 sx M.H
- P.D. @ 12:30 p.m. 6-5-89.

RECEIVED  
STATE OF KANSAS COMMISSION  
JUN 13 1989  
CC. ...  
...  
...  
...  
...

\*\*\*\*\*

STATE OF KANSAS )  
COUNTY OF MCPHERSON ) SS:

I, BRYAN HESS of MALLARD JV, INC. hereby certify that this is a true and correct copy of the log of the Rufenacht #1 well as reflected by the files of Mallard JV, Inc.

*Bryan Hess*  
BRYAN HESS, General Mgr.

Subscribed and sworn to before me this 13th day of June, 1989.

11-15-89  
My Appt. Exp

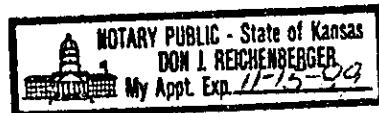

*Don J. Reichenberger*  
NOTARY PUBLIC