

STATE OF KANSAS
STATE CORPORATION COMMISSION

Form CP-4

Give All Information Completely
Make Required Affidavit
Mail or Deliver Report to:
Conservation Division
State Corporation Commission
P. O. Box 17027
Wichita, Kansas 67217
NORTH

WELL PLUGGING RECORD

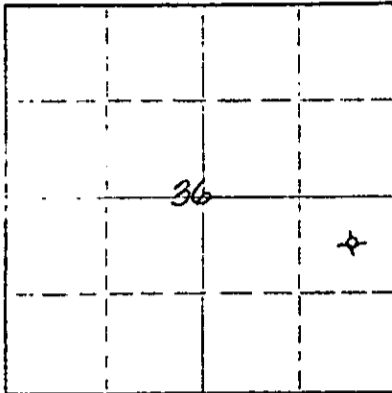

Locate well correctly on above
Section Plat

Ness County, Sec. 36 Twp. 20S Rge. 23 (E) (W)
Location as "NE/CNWSW" or footage from lines 100' NE C NE SE
Lease Owner Mack Oil Co.
Lease Name Bailey Well No. 1
Office Address 812 Union Center Bldg., Wichita, KS 67202
Character of Well (completed as Oil, Gas or Dry Hole) Dry hole
Date well completed 4-9-75 19__
Application for plugging filed 4-8-75 19__
Application for plugging approved 4-8-75 19__
Plugging commenced 4-8-75 19__
Plugging completed 4-9-75 19__
Reason for abandonment of well or producing formation Commercial quantities of oil not found.
If a producing well is abandoned, date of last production _____ 19__
Was permission obtained from the Conservation Division or its agents before plugging was commenced? yes

Name of Conservation Agent who supervised plugging of this well _____
Producing formation _____ Depth to top _____ Bottom _____ Total Depth of Well 4501 Feet
Show depth and thickness of all water, oil and gas formations.

OIL, GAS OR WATER RECORDS

CASING RECORD

FORMATION	CONTENT	FROM	TO	SIZE	PUT IN	PULLED OUT
				8-5/8"	362'	

Describe in detail the manner in which the well was plugged, indicating where the mud fluid was placed and the method or methods used in introducing it into the hole. If cement or other plugs were used, state the character of same and depth placed, from _____ feet to _____ feet for each plug set.

1st plug @ 500' w/50 sx-50/50 pos, 2% gel
2nd plug @ 240' w/25 sx
3rd plug @ 40' w/10 sx & bridge

RECEIVED
STATE CORPORATION COMMISSION
APR 17 1975
CONSERVATION DIVISION
WICHITA, KANSAS

(If additional description is necessary, use BACK of this sheet)

Name of Plugging Contractor Rains & Williamson Oil Co., Inc.
Address 435 Page Court, 220 W. Douglas, Wichita, KS 67202

STATE OF Kansas COUNTY OF Sedgwick, ss.
Wilson Rains, President (employer or owner) or (owner or operator) of the above-described well, being first duly sworn on oath, says: That I have knowledge of the facts, statements, and matters herein contained and the log of the above-described well as filed and that the same are true and correct. So help me God.

(Signature) Wilson Rains Wilson Rains
435 Page Court, 220 W. Douglas, Wichita, KS 67202
(Address)

Subscribed and sworn to before me this 10th day of April 1975
Juanita M. Green Notary Public.
My commission expires October 4, 1975

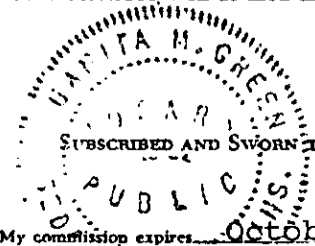

15-135-20781-0000

WELL LOG

COMPANY Mack Oil Co.

SEC. 36 T. 20S R. 23W

100' NE LOC. C NE SE

FARM Bailey

NO. 1

RIG. NO. 7

TOTAL DEPTH 4501'

COMM. 3-29-75

COMP. 4-9-75

COUNTY Ness
KANSAS

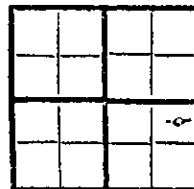

CONTRACTOR Rains & Williamson Oil Co., Inc.

CASINO
20
15
12
13

10
8 - 5/8" @ 362' w/275 sx common, 2% gel ELEVATION 2228 KB
6 3% cc
5
PRODUCTION D&A

FIGURES INDICATE BOTTOM OF FORMATIONS

Post Rock	56
Shale	821
Lime	835
Shale & Sand	950
Sand	1150
Shale	1456
Anhydrite	1488
Shale	1646
Shale & Lime	2040
Shale	2405
Shale & Lime	3605
Lime & Shale	3735
Lime	4501
<u>Rotary Total Depth</u>	<u>4501</u>

State of Kansas)
County of Sedgwick) ss:

I, Wilson Rains, President of the Rains & Williamson Oil Company, Inc.

upon oath state that the above and foregoing is a true and correct copy of the log of the Bailey #1 well.

Wilson Rains
Wilson Rains

Subscribed and sworn to before me this 10th day of April 1975

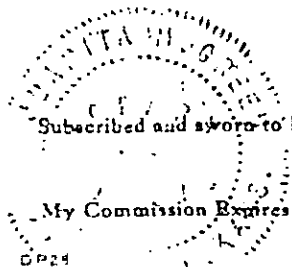

My Commission Expires: October 4, 1975

Juanita M. Green
NOTARY PUBLIC
Juanita M. Green.