

STATE CORPORATION COMMISSION OF KANSAS  
OIL & GAS CONSERVATION DIVISION  
WELL COMPLETION OR RECOMPLETION FORM  
ACO-1 WELL HISTORY  
DESCRIPTION OF WELL AND LEASE

5

API NO. 15-101-21,457-0000  
County Lane  
NE NE SW 22 16 30 West

Operator: License # 9482  
Name National Petr. Reserves Inc.  
Address 260 N. Rock Rd., Ste. 215  
Wichita, KS. 67206  
City/State/Zip

2310 Ft North from Southeast Corner of Section  
2970 Ft West from Southeast Corner of Section  
(Note: Locate well in section plat below)

Purchaser

Lease Name K. Cramer Well # 1  
Field Name O' Cramer

Operator Contact Person Ted C. Bredehoff  
Phone (316) 681-3515

Producing Formation  
Elevation: Ground 2755' KB 2760

Contractor: License # 5864  
Name Lobo Drilling Co.

Wellsite Geologist Dan Deboer  
Phone 316-682-5610

Designate Type of Completion  
x New Well Re-Entry Workover  
Oil SWD Temp Abd  
Gas Inj Delayed Comp.  
x Dry Other (Core, Water Supply etc.)  
If ONWO: old well info as follows:  
Operator  
Well Name  
Comp. Date Old Total Depth

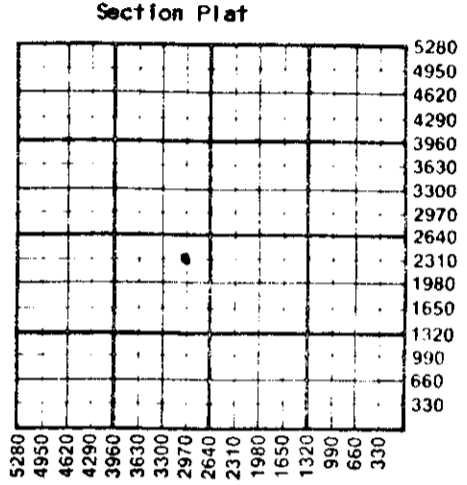

WATER SUPPLY INFORMATION  
Disposition of Produced Water: Disposal  
Docket # Repressuring

WELL HISTORY  
Drilling Method:  
x Mud Rotary Air Rotary Cable  
5-8-88 5-15-88 5-15-88  
Spud Date Date Reached TD Completion Date  
4490' Total Depth PBTD  
Amount of Surface Pipe Set and Cemented at 283 feet  
Multiple Stage Cementing Collar Used? Yes No  
If yes, show depth set feet  
If alternate 2 completion, cement circulated from feet depth to w/ SX cmt  
Cement Company Name  
Invoice #

Questions on this portion of the ACO-1 call:  
Water Resources Board (913) 296-3717  
Source of Water: Drilled well  
Division of Water Resources Permit # T88-237  
Groundwater Ft North from Southeast Corner (Well) Ft West from Southeast Corner of Sec 22 Twp 26 Rge 30 East X West 300' E of NE NE SW  
Surface Water Ft North from Southeast Corner (Stream, pond etc) Ft West from Southeast Corner Sec Twp Rge East West  
Other (explain)  
(purchased from city, R.W.D. #)

INSTRUCTIONS: This form shall be completed in triplicate and filed with the Kansas Corporation Commission, 200 Colorado Derby Building, Wichita, Kansas 67202, within 120 days of the spud date of any well. Rule 82-3-130, 82-3-107 and 82-3-106 apply. Information on side two of this form will be held confidential for a period of 12 months if requested in writing and submitted with the form. See rule 82-3-107 for confidentiality in excess of 12 months. One copy of all wireline logs and drillers time log shall be attached with this form. Submit CP-4 form with all plugged wells. Submit CP-111 form with all temporarily abandoned wells.

All requirements of the statutes, rules and regulations promulgated to regulate the oil and gas industry have been fully complied with and the statements herein are complete and correct to the best of my knowledge.

Signature [Signature]  
Title Pres/Treas Date 6/16/88  
Subscribed and sworn to before me this 16th day of June 1988  
Notary Public Susan E. Bredehoff  
Date Commission Expires 5-13-89

K.C.C. OFFICE USE ONLY  
F Letter of Confidentiality Attached  
C Wireline Log Received  
C Drillers Timelog Received  
Distribution  
KCC SWD/Rep NGPA  
KGS [ ] Plug Other (Specify)  
6-24-88  
JUN 24 1988  
6-24-88 X

SUSAN E. BREDEHOFF  
NOTARY PUBLIC  
STATE OF KANSAS  
My App. Exp. 5-13-89

Sec. 82 Twp. 26 Rge. 30 W

Operator Name ..... National Petroleum Reserves, Inc. Lease Name ..... K. Cramer Well # ..... 1

Sec. .... 22 Twp. .... 16 Rge. .... 30 East West County ..... Lane

WELL LOG

INSTRUCTIONS: Show important tops and base of formations penetrated. Detail all cores. Report all drill stem tests giving interval tested, time tool open and closed, flowing and shut-in pressures, whether shut-in pressure reached static level, hydrostatic pressures, bottom hole temperature, fluid recovery, and flow rates if gas to surface during test. Attach extra sheet if more space is needed. Attach copy of log.

Drill Stem Tests Taken [X] Yes [ ] No
Samples Sent to Geological Survey [X] Yes [ ] No
Cores Taken [ ] Yes [X] No

Formation Description
[ ] Log [X] Sample

Lansing/Kansas City, H zone, (4038-47); limestone tan-cream, moderately indurated, microcrystalline, non-argillaceous, occasional fossils, poor-fair interfossil porosity; rare show free oil tray.
DST #1 (4018-4050); LKC H zone; 30-45-45-60; 1st open: strong blow off bottom bucket 15 min; 2nd open: strong blow bottom bucket 18 min; recovery: 744' muddy saltwater; ISIP 1039; FSIP 985; IFP 65-217; FFP 261-359; BHT 119°.
Lansing/Kansas City, j zone, (4096-4106); limestone, cream-tanlight grey, moderately indurated, microcrystalline, non-argillaceous, slightly domomitic, chalky, occasional fossils and ooids, fair-good interfossil-ooid porosity; rare show free oil.
DST #2 (4094-4110); LKC Jzone; 15-10-10-10; 1st open: weak blow to 2 1/2"; 2nd open: weak blow bldg. slightly; recovery: 63' water cut mud w/trace oil; ISIP 944; FSIP 933; IFP 55-55; FFP 87-87; BHT 119°.

Table with columns: Name, Top, Bottom. Rows include Stone corral, Base/Stone corr., Topeka, Heebner, Toronto, Lansing, Stark, B/Kansas City, Marmaton, Pawnee, Ft. Scott, Cherokee, Johnson zone, Mississippian.

Johnson zone (4452-62) limestone, tan-cream light grey, well indurated, microcrystalline, non-argillaceous, slightly chalky, occasional fossils, very rare free oil/cup; no show tray.

CASING RECORD [ ] New [ ] Used

Report all strings set-conductor, surface, intermediate, production, etc.

Table with columns: Purpose of String, Size Hole Drilled, Size Casing Set (in O.D.), Weight Lbs/Ft., Setting Depth, Type of Cement, #Sacks Used, Type and Percent Additives. Row 1: Surface Pipe, 12 1/4", 8 5/8", 23#, 283, 60/40 Poz, 160, 2% gel, 3% C.C.

PERFORATION RECORD

Acid, Fracture, Shot, Cement Squeeze Record

Table with columns: Shots Per Foot, Specify Footage of Each Interval Perforated, (Amount and Kind of Material Used), Depth.

TUBING RECORD

Size Set At Packer at Liner Run [ ] Yes [ ] No

Date of First Production Producing Method [ ] Flowing [ ] Pumping [ ] Gas Lift [ ] Other (explain).....

Table with columns: Oil, Gas, Water, Gas-Oil Ratio, Gravity. Row 1: Estimated Production Per 24 Hours, Bbl's, MCF, Bbl's, CFPB.

METHOD OF COMPLETION

Production Interval

Disposition of gas: [ ] Vented [ ] Sold [ ] Used on Lease [ ] Open Hole [ ] Perforation [ ] Other (Specify) ..... [ ] Dually Completed [ ] Commingled