

STATE CORPORATION COMMISSION OF KANSAS
OIL & GAS CONSERVATION DIVISION
WELL COMPLETION OR RECOMPLETION FORM
ACO-1 WELL HISTORY
DESCRIPTION OF WELL AND LEASE

API NO. 15-109-20,482-0000

County Logan FROM CONFIDENTIAL

E 1/2 SE 1/4 14 Twp 11 Rge 33 East West

1320 Ft North from Southeast Corner of Section
660 Ft West from Southeast Corner of Section
(Note: Locate well in section plat below)

Lease Name Ahrens Well # 1 "Z"

Field Name

Producing Formation

Elevation: Ground 3112 KB 3119

Section Plat

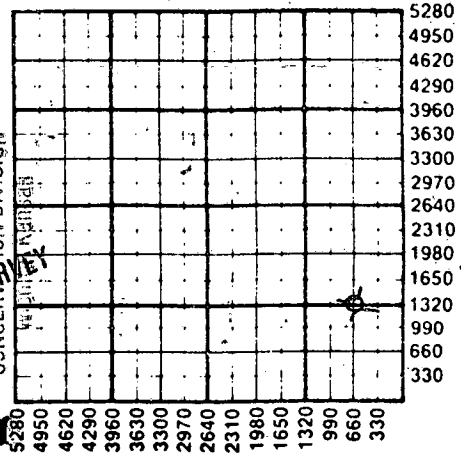

KANSAS GEOLOGICAL SURVEY
WICHITA BRANCH
NOTICE TO THE PUBLIC
APR 25 1990
26 1990

ALT. II
D: A

WATER SUPPLY INFORMATION

Disposition of Produced Water: Disposal
Docket # Repressuring

Questions on this portion of the ACO-1 call:

Water Resources Board (913) 296-3717

Source of Water:
Division of Water Resources Permit #

Groundwater Ft North from Southeast Corner
(Well) Ft West from Southeast Corner of
Sec Twp Rge East West

Surface Water Ft North from Southeast Corner
(Stream, pond etc) Ft West from Southeast Corner
Sec Twp Rge East West

Other (explain)
(purchased from city, R.W.D. #)

Operator: License # 8541
Name Petex, Inc
Address 1111 S. Glenstone, #1-104
Springfield, MO 65804
City/State/Zip

Purchaser

Operator Contact Person Larry Childress
Phone (417) 862-2177

Contractor: License # 5104
Name Blue Goose Drilling

Wellsite Geologist Tom Funk
Phone (316) 263-1102

Designate Type of Completion
 New Well Re-Entry Workover

Oil SWD Temp Abd
 Gas Inj Delayed Comp.
 Dry Other (Core, Water Supply etc)

If OWWO: old well info as follows:
Operator
Well Name
Comp. Date Old Total Depth

WELL HISTORY

Drilling Method:
 Mud Rotary Air Rotary Cable
1/31/90 2/8/90 2-8-90
Spud Date Date Reached TD Completion Date
4695
Total Depth PBTD

Amount of Surface Pipe Set and Cemented at 265 feet
Multiple Stage Cementing Collar Used? Yes No
If yes, show depth set feet
If alternate 2 completion, cement circulated
from feet depth to w/ SX cmt
Cement Company Name
Invoice #

INSTRUCTIONS: This form shall be completed in triplicate and filed with the Kansas Corporation Commission, 200 Colorado Derby Building, Wichita, Kansas 67202, within 120 days of the spud date of any well. Rule 82-3-130, 82-3-107 and 82-3-106 apply. Information on side two of this form will be held confidential for a period of 12 months if requested in writing and submitted with the form. See rule 82-3-107 for confidentiality in excess of 12 months. One copy of all wireline logs and drillers time log shall be attached with this form. Submit CP-4 form with all plugged wells. Submit CP-111 form with all temporarily abandoned wells.

All requirements of the statutes, rules and regulations promulgated to regulate the oil and gas industry have been fully complied with and the statements herein are complete and correct to the best of my knowledge.

Signature [Signature] President Date 2/23/90

Subscribed and sworn to before me this 23 day of February 1990

Notary Public [Signature]

Date Commission Expires 7/29/91

K.C.C. OFFICE USE ONLY
 Letter of Confidentiality Attached
 Wireline Log Received
 Drillers Timelog Received
Distribution
 KCC SWD/Rep NGPA
 KGS Plug Other
(Specify)

Operator Name **Petex, Inc.** Lease Name **Ahrens** Well # **1 "Z"**

Sec **14** Twp **11** Rge **33** East West County **Logan** **RELEASED**

FEB 28 1991

WELL LOG

INSTRUCTIONS: Show important tops and base of formations penetrated. Detail all cores. Report all drill stem tests giving interval tested, time tool open and closed, flowing and shut-in pressures, whether shut-in pressure reached static level, hydrostatic pressures, bottom hole temperature, fluid recovery, and flow rates if gas to surface during test. Attach extra sheet if more space is needed. Attach copy of log.

FROM CONFIDENTIAL

Drill Stem Tests Taken Yes No
Samples Sent to Geological Survey Yes No
Cores Taken Yes No

Formation Description
 Log Sample

		Name	Top	Bottom
DST#1	4141-4165; 30-45-45-60; Rec: 10' socm 120' thin osm; 20-39, 49-59; [1116-1096]	Anhydrite	2610	+509
		B/anhydrite	2638	+481
DST#2	4260-4296; 45-45-45-45; Rec: 62' mud 29-29, 39-39; [196-157]	Heebner	4028	-909
		Lansing	4067	-948
DST#3	4230-4635; 30-45-45-60; Rec: 248' gip 60' gcm, 126' so&gcm; 59-88, 98-118; [452-423]	Stark	4291	-1172
		Marmaton	4378	-1259
		Pawnee	4486	-1367
DST#4	4569-4635; 30-30-30-30; Rec: 5' mud 19-19, 19-19; [88-39]	Cherokee	4574	-1455
		Johnson Zone	4616	-1497
		Miss	4676	-1557

CASING RECORD New Used

Report all strings set-conductor, surface, intermediate, production, etc.

Purpose of String	Size Hole Drilled	Size Casing Set (in O.D.)	Weight Lbs/Ft.	Setting Depth	Type of Cement	#Sacks Used	Type and Percent Additives
surface	12-1/4	8-5/8	20#	265	60/40poz	80	2%gel 13%cc

PERFORATION RECORD		Acid, Fracture, Shot, Cement Squeeze Record	
Shots Per Foot	Specify Footage of Each Interval Perforated	(Amount and Kind of Material Used)	Depth

TUBING RECORD Size Set At Packer at Liner Run Yes No

Date of First Production Producing Method Flowing Pumping Gas Lift Other (explain).....

Estimated Production Per 24 Hours	Oil Bbls	Gas MCF	Water Bbls	Gas-Oil Ratio	Gravity

METHOD OF COMPLETION

Production Interval

Disposition of gas: Vented Open Hole Perforation
 Sold Other (Specify)
 Used on Lease Dually Completed Commingled

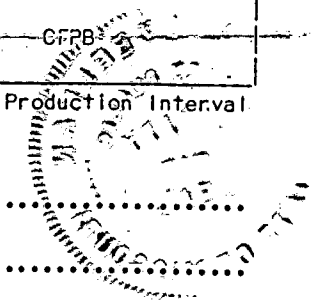

ORIGINAL