

STATE OF KANSAS
STATE CORPORATION COMMISSION
CONSERVATION DIVISION
P. O. BOX 17027
WICHITA, KANSAS 67217

WELL PLUGGING RECORD

Greeley County, Sec. 2 Twp. 20 Rgn. 40W (E) (W)

Location as "NE/CNWSW" or footage from lines E/2 W/2 NE

Lease Owner Hughes Seewald

Lease Name Bursk Well No. 1

Office Address 701 First National Bank Building, Amarillo, Texas

Character of Well (completed as Oil, Gas or Dry Hole) Dry Hole

Date well completed May 26, 19 75

Application for plugging filed May 25, 19 75

Application for plugging approved May 25, 19 75

Plugging commenced May 25, 19 75

Plugging completed May 26, 19 75

Reason for abandonment of well or producing formation Dry Hole

If a producing well is abandoned, date of last production 19

Was permission obtained from the Conservation Division or its agents before plugging was commenced? Yes

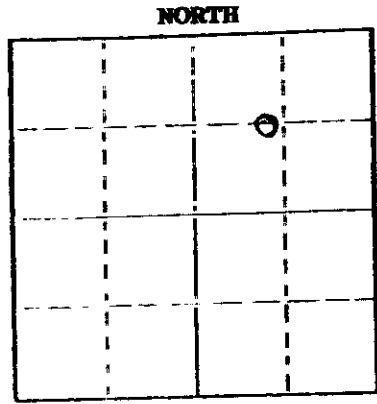

Locate well correctly on above Section Plat

Name of Conservation Agent who supervised plugging of this well Gilbert Balthozan

Producing formation None Depth to top Bottom Total Depth of Well 2887

Show depth and thickness of all water, oil and gas formations.

OIL, GAS OR WATER RECORDS

CASING RECORD

| FORMATION | CONTENT | FROM | TO | SIZE | PUT IN | PULLED OUT |
|-----------|---------|------|------|--------|--------|------------|
| | | 0' | 235' | 8 5/8" | 235 | None |
| | | | | | | |
| | | | | | | |
| | | | | | | |
| | | | | | | |
| | | | | | | |
| | | | | | | |

Describe in detail the manner in which the well was plugged, indicating where the mud fluid was placed and the method or methods used in introducing it into the hole. If cement or other plugs were used, state the character of same and depth placed, from feet to feet for each plug set.

Plugged: 70 sacks @1000, 20 sacks @ 230, 10 sacks @ 40,
Completed: 1:00 PM 5-26-75, By: Dowel

6-9-75

(If additional description is necessary, use BACK of this sheet)

Name of Plugging Contractor DaMac Drilling Company, Inc.
Address Box 1164 Great Bend, Kansas 67530

STATE OF Kansas COUNTY OF Barton, ss.

 (employee of owner) or (owner or operator) of the above-described well, being first duly sworn on oath, says: That I have knowledge of the facts, statements, and matters herein contained and the log of the above-described well as filed and that the same are true and correct. So help me God.

(Signature) Florida Taylor
Box 1164, Great Bend, Kansas 67530
(Address)

SUBSCRIBED AND SWORN TO before me this 3rd day of June 19 75

My commission expires

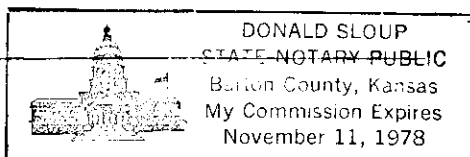

Donald Sloup
Notary Public.

KANSAS DRILLERS LOG

IMPORTANT
 Kans. Geo. Survey requests
 samples on this well.

S. 2 T. 20 R. 40 ^W
 Loc. 1320' FNL & 1650' FEL
 County Greeley

API No. 15 — 071 — 20,075-0000
 County Number

Operator
Hughes Seewald

Address
701 First National Bank Building Amarillo, Texas

Well No. #1 Lease Name Bursk

Footage Location
1320 feet from (N) line 1650 feet from (E) line

Principal Contractor DaMac Drilling Co. Geologist

Spud Date May 23, 1975 Total Depth 2887 P.B.T.D.

Date Completed Oil Purchaser

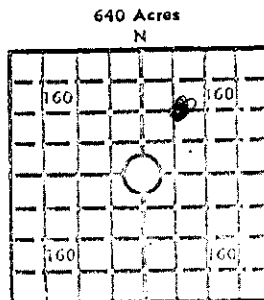

Elev.: Gr. 3569
 DF _____ KB 3577

CASING RECORD

Report of all strings set — surface, intermediate, production, etc.

| Purpose of string | Size hole drilled | Size casing set (in O.D.) | Weight lbs/ft. | Setting depth | Type cement | Sacks | Type and percent additives |
|-------------------|-------------------|---------------------------|----------------|---------------|-------------|-------|----------------------------|
| Surface csg | 12 1/2" | 8 5/8" | 24# | 230 | Class H | 160 | 3% CaCl |
| | | | | | | | |
| | | | | | | | |
| | | | | | | | |

LINER RECORD

PERFORATION RECORD

| Top, ft. | Bottom, ft. | Sacks cement | Shots per ft. | Size & type | Depth interval |
|----------|-------------|--------------|---------------|-------------|----------------|
| none | | | none | | |

TUBING RECORD

| Size | Setting depth | Pecker set at |
|------|---------------|---------------|
| | | |

ACID, FRACTURE, SHOT, CEMENT SQUEEZE RECORD

| Amount and kind of material used | Depth interval treated |
|----------------------------------|------------------------|
| none | |
| | |
| | |

INITIAL PRODUCTION

Date of first production none Producing method (flowing, pumping, gas lift, etc.)

| RATE OF PRODUCTION PER 24 HOURS | Oil | Gas | Water | Gas-oil ratio |
|---------------------------------|-----|-----|-------|---------------|
| | | | | |

Disposition of gas (vented, used on lease or sold) _____ Producing interval (s) _____

INSTRUCTIONS: As provided in KCC Rule 82-2-125, within 90 days after completion of a well, one completed copy of this Drillers Log shall be transmitted to the State Geological Survey of Kansas, 4150 Monroe Street, Wichita, Kansas 67209. Copies of this form are available from the Conservation Division, State Corporation Commission, 3830 So. Meridian (P.O. Box 17027), Wichita, Kansas 66217. Phone AC 316-522-2206. If confidential custody is desired, please note Rule 82-2-125. Drillers Logs will be on open file in the Oil and Gas Division, State Geological Survey of Kansas, Lawrence, Kansas 66044.

| | | |
|-----------------|---------------------|----------|
| Well No. 1 | Lease Name Bursk | Dry hole |
| S 2 T 20 R 40 W | | |

WELL LOG

Show all important zones of porosity and contents thereof; cored intervals, and all drill-stem tests, including depth interval tested, cushion used, time tool open, flowing and shut-in pressures, and recoveries.

SHOW GEOLOGICAL MARKERS, LOGS RUN, OR OTHER DESCRIPTIVE INFORMATION.

| FORMATION DESCRIPTION, CONTENTS, ETC. | TOP | BOTTOM | NAME | DEPTH |
|---------------------------------------|------|--------|------------------------------|--------------|
| No DST No Cores | | | Base Stone Corral Welex: | 2484 2876 |
| Upper Winfield Well D & A | 2845 | 2861 | Gamma Acoustic Caliper | |

USE ADDITIONAL SHEETS, IF NECESSARY, TO COMPLETE WELL RECORD.

| | |
|---------------|--------------------|
| Date Received | <i>[Signature]</i> |
| | Signature |
| | Operator |
| | Title |
| | June 20, 1975 |
| | Date |