

FOR KCC USE:

FORM C-1 7/91

FORM MUST BE TYPED

FORM MUST BE SIGNED

ALL BLANKS MUST BE FILLED

EFFECTIVE DATE: 11-8-97

State of Kansas

DISTRICT # 4

NOTICE OF INTENTION TO DRILL

SEAL Yes X No

Must be approved by the K.C.C. five (5) days prior to commencing well

Expected Spud Date 11 3 97 month day year

Spot NE- NE- SE Sec 1 Twp 11 S, Rg 34 East XX West

OPERATOR: License # 5030 Name: Vess Oil Corporation Address: 8100 E. 22nd Street North, Bldg. 300 City/State/Zip: Wichita, KS 67226 Contact Person: W.R. Horgan Phone: 316-682-1537

2310 feet from South North line of Section 330 feet from East West line of Section IS SECTION XX REGULAR IRREGULAR

CONTRACTOR: License #: 6039 Name: L.D. Drilling, Inc.

(NOTE: Locate well on the Section Plat on Reverse Side)

County: Logan

Lease Name: Thrasher Well #: 1-1

Field Name: Unnamed

Is this a Prorated/Spaced Field? yes X no

Target Formation(s): LKC and Johnson

Nearest lease or unit boundary: 330

Ground Surface Elevation: 3174 feet MSL

Water well within one-quarter mile: yes X no

Public water supply well within one mile: yes X no

Depth to bottom of fresh water: 250

Depth to bottom of usable water: 1720

Surface Pipe by Alternate: 1 X 2

Length of Surface Pipe Planned to be set: 320

Length of Conductor pipe required: 4800

Projected Total Depth: 4800

Formation at Total Depth: Miss

Water Source for Drilling Operations: well farm pond X other

DWR Permit #:

Will Cores Be Taken?: yes no

If yes, proposed zone:

Table with columns: Well Drilled For, Well Class, Type Equipment. Rows include XX Oil, Gas, OWMO, Seismic, # of Holes, Other.

If OWMO, old well information as follows:

Operator: Well Name: Comp. Date: Old Total Depth

Directional, Deviated or Horizontal wellbore? yes XX no

If yes, true vertical depth:

Bottom Hole Location:

AFFIDAVIT

The undersigned hereby affirms that the drilling, completion and eventual plugging of this well will comply with K.S.A. 55-101, et. seq.

It is agreed that the following minimum requirements will be met:

- 1. Notify the appropriate district office prior to spudding of well;
2. A copy of the approved notice of intent to drill shall be posted on each drilling rig;
3. The minimum amount of surface pipe as specified below shall be set by circulating cement to the top;
4. If the well is dry hole, an agreement between the operator and the district office on plug length and placement is necessary prior to plugging;
5. The appropriate district office will be notified before well is either plugged or production casing is cemented in;
6. IF AN ALTERNATE IS COMPLETION, PRODUCTION PIPE SHALL BE CEMENTED FROM BELOW ANY USABLE WATER TO SURFACE WITHIN 120 DAYS OF SPUD DATE.

I hereby certify that the statements made herein are true and to the best of my knowledge and belief.

Date: 10/31/97 Signature of Operator or Agent: W.R. Horgan Title: Operations Manager

FOR KCC USE: API # 15- 109-206620000 Conductor pipe required None feet Minimum surface pipe required 300 feet per Alt. X(2) Approved by: W.R. Horgan 11-3-97 This authorization expires: 5-3-98 (This authorization void if drilling not started within 6 months of effective date.) Spud date: Agent:

REMEMBER TO:

- File Drill Pit Application (form CDP-1) with intent to drill;
- File Completion Form ACO-1 within 120 days of spud date;
- File acreage attribution plat according to field proration orders;
- Notify appropriate district office 48 hours prior to workover or re-entry;
- Submit plugging report (CP-4) after plugging is completed;
- Obtain written approval before disposing or injecting salt water.

Mail to: Conservation Division, 208 Colorado Dorby Building, 202 W. First St., Wichita, Kansas 67202-1286.

Vertical stamp: DISTRICT OFFICE

Vertical stamp: 11 11

IN ALL CASES PLOT THE INTENDED WELL ON THE PLAT BELOW

PLAT OF ACREAGE ATTRIBUTABLE TO A WELL IN A PRORATED OR SPACED FIELD

If the intended well is in a prorated or spaced field, please fully complete this side of the form. If the intended well is in a prorated or spaced field complete the plat below showing that the well will be properly located in relationship to other wells producing from the common source of supply. Please show all the wells within 1 mile of the boundaries of the proposed acreage attribution unit for gas wells and within 1/2 mile of the boundaries of the proposed acreage attribution unit for oil wells.

API NO. 15- \_\_\_\_\_  
 OPERATOR \_\_\_\_\_  
 LEASE \_\_\_\_\_  
 WELL NUMBER \_\_\_\_\_  
 FIELD \_\_\_\_\_

LOCATION OF WELL: COUNTY \_\_\_\_\_  
 \_\_\_\_\_ feet from south/north line of section  
 \_\_\_\_\_ feet from east/west line of section  
 SECTION \_\_\_\_\_ TWP \_\_\_\_\_ RG \_\_\_\_\_

NUMBER OF ACRES ATTRIBUTABLE TO WELL \_\_\_\_\_  
 QTR/QTR/QTR OF ACREAGE \_\_\_\_\_ - \_\_\_\_\_ - \_\_\_\_\_

IS SECTION \_\_\_\_\_ REGULAR or \_\_\_\_\_ IRREGULAR  
IF SECTION IS IRREGULAR, LOCATE WELL FROM NEAREST CORNER BOUNDARY.

Section corner used: \_\_\_\_\_ NE \_\_\_\_\_ NW \_\_\_\_\_ SE \_\_\_\_\_ SW

PLAT

(Show location of the well and shade attributable acreage for prorated or spaced wells.)  
 (Show footage to the nearest lease or unit boundary line.)

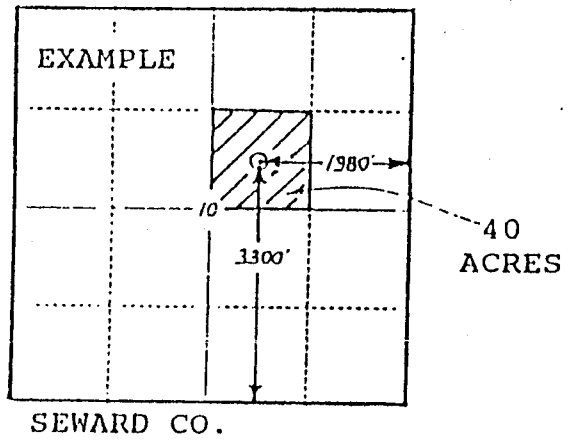
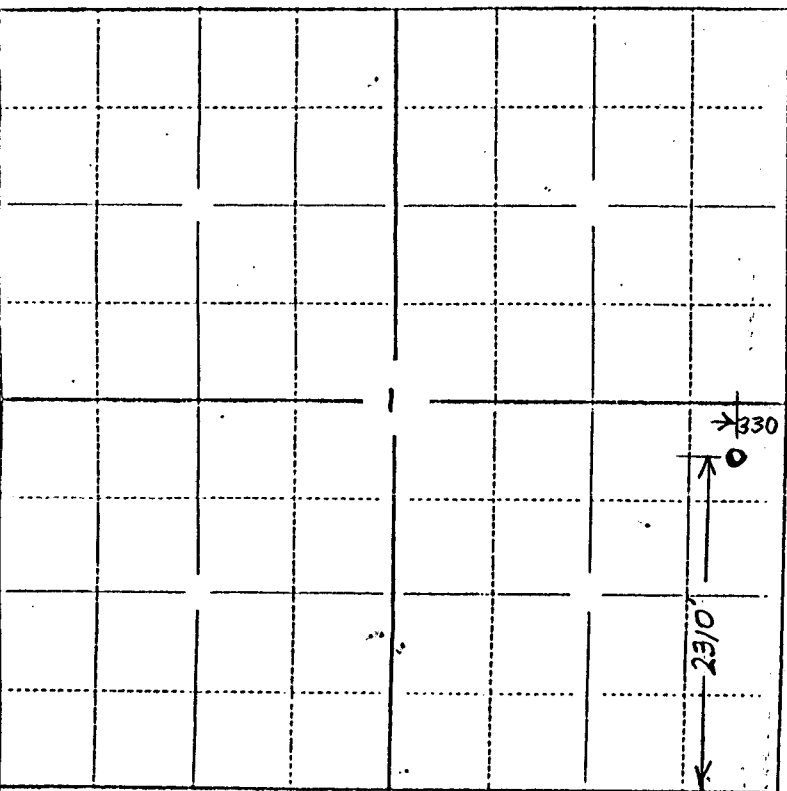

in plotting the proposed location of the well, you must show:

- ) The manner in which you are using the depicted plat by identifying section lines, i.e. 1 section, 1 section with 8 surrounding sections, 4 sections, etc.;
- ) the distance of the proposed drilling location from the section's south/north and east/west lines; and
- ) the distance to the nearest lease or unit boundary line.