

For KCC Use: 10-21-02  
Effective Date: 10-21-02  
District # 4  
SGA?  Yes  No

KANSAS CORPORATION COMMISSION  
OIL & GAS CONSERVATION DIVISION

RECEIVED  
OCT 16 2002  
KCC WICHITA  
Form C-1  
September 1999  
Form must be Typed  
Form must be Signed  
All blanks must be Filled

**NOTICE OF INTENT TO DRILL**  
Must be approved by KCC five (5) days prior to commencing well

Expected Spud Date November 15 2002  
month day year

Spot NW - SW - SW Sec 1 Twp. 11 S. R. 34  East  West  
990' fsl feet from (S) (circle one) Line of Section  
330' fwl feet from (NW) (circle one) Line of Section  
Is SECTION XX Regular  Irregular?

OPERATOR: License# 5003  
Name: McCoy Petroleum Corporation  
Address: P.O. Box 780208  
City/State/Zip: Wichita, KS 67278-0208  
Contact Person: Scott Hampel  
Phone: (316) 636-2737

(Note: Locate well on the Section Plat on reverse side)  
County: Logan  
Lease Name: Thrasher Estate A Well #: 4-1  
Field Name: Monument NW

CONTRACTOR: License# 6039  
Name: L.D. Drilling, Inc.

Is this a Prorated / Spaced Field?  Yes  No  
Target Information(s): Mississippian  
Nearest Lease or unit boundary: 330' fel  
Ground Surface Elevation: approx. 3198' feet MSL

Well Drilled For: Well Class: Type Equipment:  
 Oil  Enh Rec  Infield  Mud Rotary  
 Gas  Storage  Pool Ext.  Air Rotary  
 OWWO  Disposal  Wildcat  Cable  
 Seismic; # of Holes  Other  
 Other

Water well within One-quarter mile:  Yes  No  
Public water supply well within one mile:  Yes  No

If OWWO: old well information as follows:  
Operator: \_\_\_\_\_  
Well Name: \_\_\_\_\_  
Original Completion Date: \_\_\_\_\_ Original Total Depth: \_\_\_\_\_

Depth to bottom of fresh water: 200'  
Depth to bottom of usable water: 1800'  
Surface Pipe by Alternate: 1 XX 2  
Length of Surface Pipe Planned to be set: 250'  
Length of Conductor Pipe required: None  
Projected Total Depth: 4800'  
Producing Formation Target: Mississippian

Directional, Deviated or Horizontal wellbore?  Yes  No  
If Yes, true vertical depth: \_\_\_\_\_  
Bottom Hole Location: \_\_\_\_\_  
KCC DKT #: \_\_\_\_\_

Water Source for Drilling Operations:  
Well \_\_\_\_\_ Farm Pond XX Other \_\_\_\_\_  
DWR Permit #: \_\_\_\_\_  
(Note: Apply for Permit with DWR )  
Will Cores be taken?  Yes  No  
If Yes, proposed zone: \_\_\_\_\_

**AFFIDAVIT**

The undersigned hereby affirms that the drilling, completion and eventual plugging of this well will comply with K.S.A. 55-101, et. seq.  
It is agreed that the following minimum requirements will be met:

1. Notify the appropriate district office **prior** to spudding of well;
2. A copy of the approved notice of intent to drill **shall be** posted on each drilling rig;
3. The minimum amount of surface pipe as specified below **shall be set** by circulating cement to the top; in all cases surface pipe **shall be set** through all unconsolidated materials plus a minimum of 20 feet into the underlying formation.
4. If the well is dry hole, an agreement between the operator and the district office on plug length and placement is necessary **prior to plugging**;
5. The appropriate district office will be notified before well is either plugged or production casing is cemented in;
6. If an ALTERNATE 11 COMPLETION, production pipe shall be cemented from below any usable water to surface within **120 days** of spud date. **In all cases, NOTIFY district office** prior to any cementing.

I hereby certify that the statements made herein are true and to the best of my knowledge and belief

Date: 10/15/02 Signature of Operator or Agent: Scott Hampel Title: Petroleum Engineer

For KCC Use ONLY  
API # 15 - 109.20692.00.00  
Conductor pipe required NONE feet  
Minimum surface pipe required 250 feet per Alt. # (2)  
Approved by: RSP10-16-02  
This authorization expires: 4-16-03  
(This authorization void if drilling not started within 6 months of effective date.)  
Spud date: \_\_\_\_\_ Agent: \_\_\_\_\_

**Remember to -**

- File Drill Pit Application (form CDP-1) with Intent to Drill;
- File Completion Form ACO-1 within 120 days of spud date;
- File acreage attribution plat according to field proration orders;
- Notify appropriate district office 48 hours prior to workover or re-entry;
- Submit plugging report (CP-4) after plugging is completed;
- Obtain written approval before disposing or injecting salt water.

1  
11  
342

**IN ALL CASES PLOT THE INTENDED WELL ON THE PLAT BELOW**

*Plat of acreage attributable to a well in a prorated or spaced field*

*If the intended well is in a prorated or spaced field, please fully complete this side of the form.* If the intended well is in a prorated or spaced field complete the plat below showing that the well will be properly located in relationship to other wells producing from the common source of supply. Please show all the wells and within 1 mile of the boundaries of the proposed acreage attribution unit for gas wells and within 1/2 mile of the boundaries of the proposed acreage attribution unit for oil wells.

API No. 15 - \_\_\_\_\_  
Operator: McCoy Petroleum Corp.  
Lease: Thrasher Estate A  
Well Number: 4-1  
Field: Monument NW  
Number of Acres attributable to well: \_\_\_\_\_  
QTR / QTR / QTR of acreage: NW - SW - SW

Location of Well: County: Logan  
990' FSL feet from S / N (circle one) Line of Section  
330' FWL feet from E / W (circle one) Line of Section  
Sec 1 Twp 11 S. R 34  East  West

Is Section XX Regular or \_\_\_\_\_ Irregular

If Section is Irregular, locate well from nearest corner boundary.  
Section corner used: \_\_\_ NE \_\_\_ NW - SE \_\_\_ SW

**PLAT**

*(Show location of the well and shade attributable acreage for prorated or spaced wells)  
(Show footage to the nearest lease or unit boundary fine.)*

RECEIVED  
OCT 16 2002  
KCC WICHITA

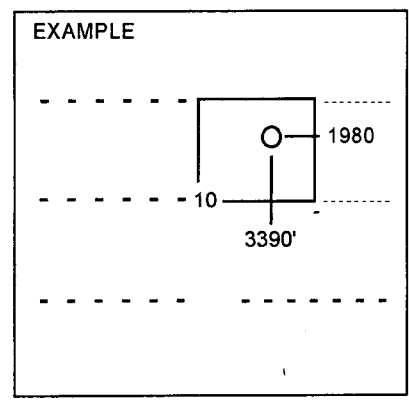
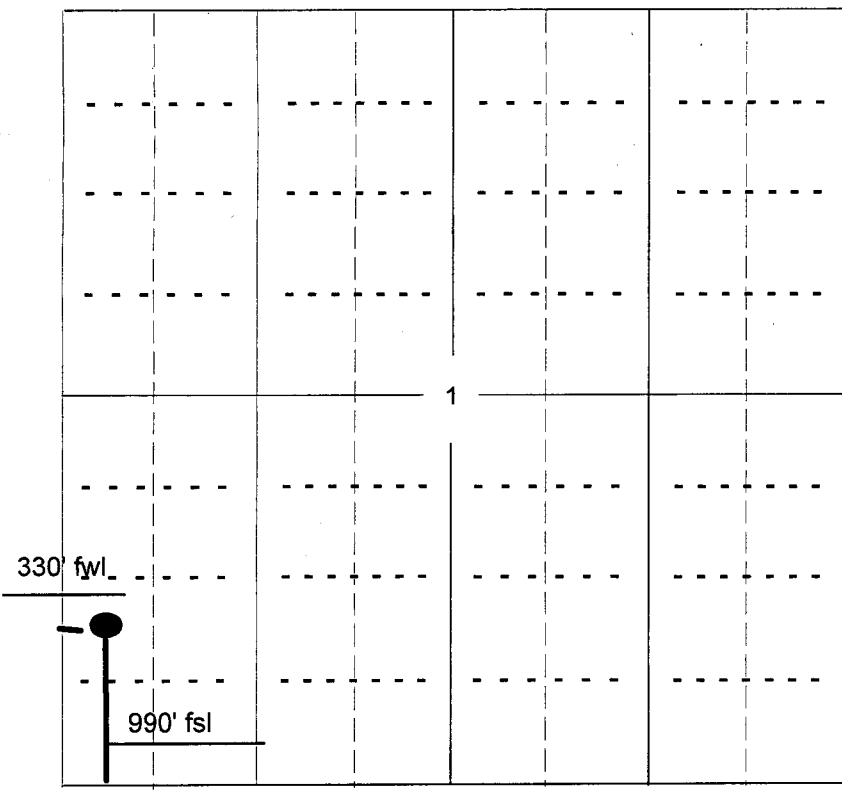

**NOTE., In all cases locate the spot of the proposed drilling location.**

**In plotting the proposed location of the well, you must show.**

1. The manner in which you are using the depicted plat by identifying section lines, i.e. 1 section, 1 section with 8 surrounding sections, 4 sections, etc.
2. The distance of the proposed drilling location from the section's south / north and east / west.
3. The distance to the nearest lease or unit boundary line.
4. If proposed location is located within a prorated or spaced field a certificate of acreage attribution plat must be attached: (CO-7 for oil wells; CG-8 for gas wells).