

FOR KCC USE:

FORM C-1 7/91

EFFECTIVE DATE: 12-11-96

DISTRICT # 4

SEAT Yes No

State of Kansas
NOTICE OF INTENTION TO DRILL

FORM MUST BE TYPED
FORM MUST BE SIGNED
ALL BLANKS MUST BE FILLED

Must be approved by the K.S.C. five (5) days prior to commencing well

Expected Spud Date December 11, 1996
month day year

Spot S/2 SW SW Sec 29 Twp 11 S. Rg 33 East West

OPERATOR: License # 06113
Name: Landmark Energy Expl. Inc./Vess Oil Corp.
Address: 1861 N. Rock Rd., Suite 205
City/State/Zip: Wichita, KS 67206
Contact Person: Jeff Wood
Phone: (316) 683-8080

330 feet from South North line of Section
660 feet from East West line of Section
IS SECTION X REGULAR IRREGULAR?

(NOTE: Locate well on the Section Plat on Reverse Side)
County: Logan
Lease Name: Hubert Well #: 1-29
Field Name: unnamed

CONTRACTOR: License #: 6039
Name: L.D. Drilling, Inc.

Is this a Perforated/Spaced Field? yes X no
Target Formation(s): Lansing

Well Drilled For: Well Class: Type Equipment:
X Oil ... Enh Acc ... Infield X Mud Rotary
Gas ... Storage ... Pool Ext. ... Air Rotary
CWVC ... Disposal X Wildcat ... Cable
Seismic; # of Holes ... Other

Nearest lease or unit boundary: 330'
Ground Surface Elevation: 3132 feet MSL

If CWVC: old well information as follows:
Operator:
Well Name:
Comp. Date: Old Total Depth

Water well within one-quarter mile: yes X no
Public water supply well within one mile: yes X no

Directional, Deviated or Horizontal wellbore? yes X no
If yes, true vertical depth:
Bottom Hole Location:

Depth to bottom of fresh water: 200'
Depth to bottom of usable water: 1700'
Surface Pipe by Alternate: 1 X 2

AFFIDAVIT

The undersigned hereby affirms that the drilling, completion and eventual plugging of this well will comply with K.S.A. 55-101, et. seq.
It is agreed that the following minimum requirements will be met:

- 1. Notify the appropriate district office prior to spudding or well;
- 2. A copy of the approved notice of intent to drill shall be posted on each drilling rig;
- 3. The minimum amount of surface pipe as specified below shall be set by circulating cement to the top; in all cases surface pipe shall be set through all unconsolidated materials plus a minimum of 20 feet into the underlying formation;
- 4. If the well is dry hole, an agreement between the operator and the district office on plug length and placement is necessary prior to plugging;
- 5. The appropriate district office will be notified before well is either plugged or production casing is cemented in;
- 6. IF AN ALTERNATE II COMPLETION, PRODUCTION PIPE SHALL BE CEMENTED FROM EITHER ANY USABLE WATER TO SURFACE WITHIN 120 DAYS OF SPUD DATE. IN ALL CASES, NOTIFY DISTRICT OFFICE PRIOR TO ANY CEMENTING.

I hereby certify that the statements made herein are true and to the best of my knowledge and belief.

Date: 12/5/96 Signature of Operator or Agent: Jeff Wood Title: President

FOR KCC USE:
API # 15- 109-206360000
Conductor pipe required NONE feet
Minimum surface pipe required 250 feet per Alt. X 2
Approved by: JK 12-5-96
This authorization expires: 6-6-97
(This authorization void if drilling not started within 6 months of effective date.)
Spud date: Agent:

REMEMBER TO:

- File Drill Pit Application (form CSP-1) with Intent to Drill;
- File Completion Form ACQ-1 within 120 days of spud date;
- File acreage attribution plat according to field preparation orders;
- Notify appropriate district office 48 hours prior to workover or re-entry;
- Submit plugging report (CP-4) after plugging is completed;
- Obtain written approval before disposing or injecting salt water.

Mail to: Conservation Division, 200 Calorado Derby Building, 202 W. First St., Wichita, Kansas 67202-1236.

29 11 33W
MPS DEC-6 A 11:51
RECEIVED
NOV 15 1996

IN ALL CASES PLOT THE INTENDED WELL ON THE PLAT BELOW

PLAT OF ACREAGE ATTRIBUTABLE TO A WELL IN A PRORATED OR SPACED FIELD

If the intended well is in a prorated or spaced field, please fully complete this side of the form. If the intended well is in a prorated or spaced field complete the plat below showing that the well will be properly located in relationship to other wells producing from the common source of supply. Please show all the wells within 1 mile of the boundaries of the proposed acreage attribution unit for gas wells and within 1/2 mile of the boundaries of the proposed acreage attribution unit for oil wells.

API NO. 15- _____
 OPERATOR _____
 LEASE _____
 WELL NUMBER _____
 FIELD _____

LOCATION OF WELL: COUNTY _____
 _____ feet from south/north line of section
 _____ feet from east/west line of section
 SECTION _____ TWP _____ RG _____

NUMBER OF ACRES ATTRIBUTABLE TO WELL _____
 QTR/QTR/QTR OF ACREAGE _____

IS SECTION _____ REGULAR or _____ IRREGULAR
IF SECTION IS IRREGULAR, LOCATE WELL FROM NEAREST CORNER BOUNDARY.

Section corner used: _____ NE _____ NW _____ SE _____ SW
PLAT

(Show location of the well and shade attributable acreage for prorated or spaced wells.)
 (Show footage to the nearest lease or unit boundary line.)

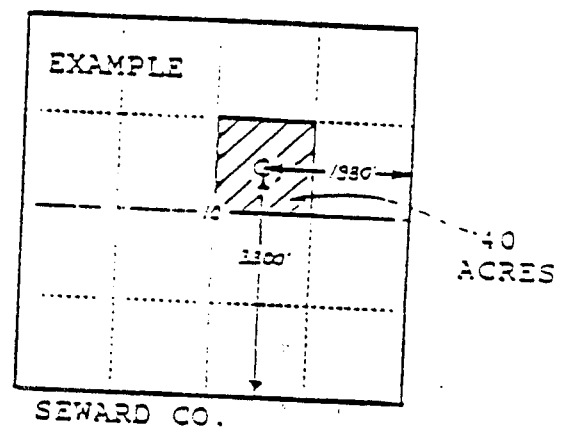
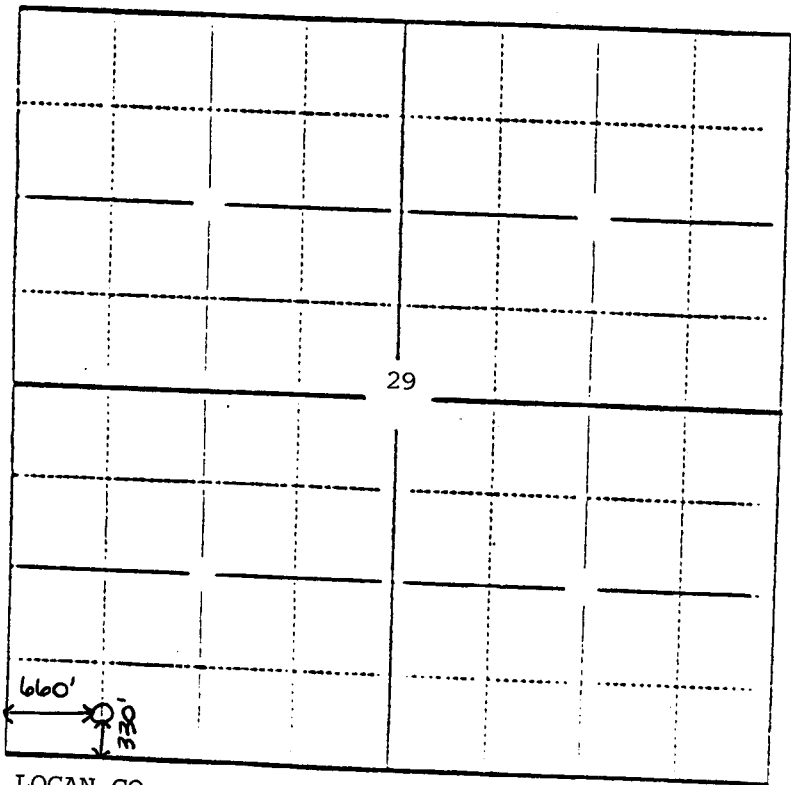

In plotting the proposed location of the well you must show:

- 1) The manner in which you are using the depicted plat by identifying section lines, i.e. 1 section 1 section with 8 surrounding sections, 4 sections, etc.;
- 2) the distance of the proposed drilling location from the section's south/north and east/west lines; and
- 3) the distance to the nearest lease or unit boundary line.