

EFFECTIVE DATE: 1-22-97

State of Kansas

DISTRICT # 4

NOTICE OF INTENTION TO DRILL

SGA? Yes No

Must be approved by the K.C.C. five (5) days prior to commencing well.

Expected Spud Date January 22 1997

Spot SW NE NW Sec 11 Twp 11 S, Rg 33 East West

OPERATOR: License # 5003
McCoy Petroleum Corporation
3017 N. Cypress Street
Wichita, KS 67226-4003
Contact Person: Brent B. Reinhardt
Phone: (316) 636-3727

4290 feet from South North line of Section
3630 feet from East West line of Section
IS SECTION X REGULAR IRREGULAR?

CONTRACTOR: License #: 5658
Sweetman Drilling, Inc.

(NOTE: Locate well on the Section Plat on Reverse Side)
County: Logan
Lease Name: SCHIPPERS "A" Well #: 1-11
Field Name: Wildcat

Well Drilled For: Well Class: Type Equipment:
X Oil ... Enh Rec ... Infield X Mud Rotary
... Gas ... Storage ... Pool Ext. ... Air Rotary
... OWWO ... Disposal X Wildcat ... Cable
... Seismic; ... # of Holes ... Other
... Other

Is this a Prorated/Spaced Field? ... yes X no
Target Formation(s): Mississippi
Nearest lease or unit boundary: 990'
Ground Surface Elevation: 3110' Estm ... feet MSL
Water well within one-quarter mile: ... yes X no
Public water supply well within one mile: ... yes X no
Depth to bottom of fresh water: 150' 210'
Depth to bottom of usable water: 220' 1720'
Surface Pipe by Alternate: X 1 X 2
Length of Surface Pipe Planned to be set: 270'
Length of Conductor pipe required: NA

If OWWO: old well information as follows:
Operator:
Well Name:
Comp. Date: Old Total Depth

Projected Total Depth: 4750'
Formation at Total Depth: Miss
Water Source for Drilling Operations:
X well ... farm pond ... other
Permit to be applied for by Contractor.
Will Cores Be Taken?: ... yes X no
If yes, proposed zone:

Directional, Deviated or Horizontal wellbore? ... yes X no
If yes, true vertical depth:
Bottom Hole Location:

AFFIDAVIT

The undersigned hereby affirms that the drilling, completion and eventual plugging of this well will comply with K.S.A. 55-101, et. seq.
It is agreed that the following minimum requirements will be met:

- 1. Notify the appropriate district office prior to spudding of well;
2. A copy of the approved notice of intent to drill shall be posted on each drilling rig;
3. The minimum amount of surface pipe as specified below shall be set by circulating cement to the top; in all cases surface pipe shall be set through all unconsolidated materials plus a minimum of 20 feet into the underlying formation;
4. If the well is dry hole, an agreement between the operator and the district office on plug length and placement is necessary prior to plugging;
5. The appropriate district office will be notified before well is either plugged or production casing is cemented in;
6. IF AN ALTERNATE II COMPLETION, PRODUCTION PIPE SHALL BE CEMENTED FROM BELOW ANY USABLE WATER TO SURFACE WITHIN 120 DAYS OF SPUD DATE. IN ALL CASES, NOTIFY DISTRICT OFFICE PRIOR TO ANY CEMENTING.

I hereby certify that the statements made herein are true and to the best of my knowledge and belief.

Date: 1/15/97 Signature of Operator or Agent: Brent B. Reinhardt Title: Regulatory Geologist

FOR KCC USE:
API # 15- 109-206420000
Conductor pipe required NONE feet
Minimum surface pipe required 260 feet per Alt. X(2)
Approved by: JK 1-17-97
This authorization expires: 7-17-97
(This authorization void if drilling not started within 6 months of effective date.)
Spud date: Agent:

REMEMBER TO:

- File Drill Pit Application (form CDP-1) with Intent to Drill;
- File Completion Form ACO-1 within 120 days of spud date;
- File acreage attribution plat according to field proration orders;
- Notify appropriate district office 48 hours prior to workover or re-entry;
- Submit plugging report (CP-4) after plugging is completed;
- Obtain written approval before disposing or injecting salt water.

11
11
333

IN ALL CASES PLOT THE INTENDED WELL ON THE PLAT BELOW

PLAT OF ACREAGE ATTRIBUTABLE TO A WELL IN A PRORATED OR SPACED FIELD

If the intended well is in a prorated or spaced field, please fully complete this side of the form. If the intended well is in a prorated or spaced field complete the plat below showing that the well will be properly located in relationship to other wells producing from the common source of supply. Please show all the wells within 1 mile of the boundaries of the proposed acreage attribution unit for gas wells and within 1/2 mile of the boundaries of the proposed acreage attribution unit for oil wells.

API NO. 15- _____
 OPERATOR McCoy Petroleum Corporation LOCATION OF WELL: COUNTY Logan
 LEASE SCHIPPERS "A" 4290 feet from south north line of section
 WELL NUMBER 1-11 3630 feet from east west line of section
 FIELD Wildcat SECTION 11 TWP 11s RG 33w

NUMBER OF ACRES ATTRIBUTABLE TO WELL _____ IS SECTION X REGULAR or _____ IRREGULAR
 QTR/QTR/QTR OF ACREAGE _____ IF SECTION IS IRREGULAR, LOCATE WELL FROM NEAREST CORNER BOUNDARY.

Section corner used: _____ NE _____ NW _____ SE _____ SW
PLAT

(Show location of the well and shade attributable acreage for prorated or spaced wells.)
 (Show footage to the nearest lease or unit boundary line.)

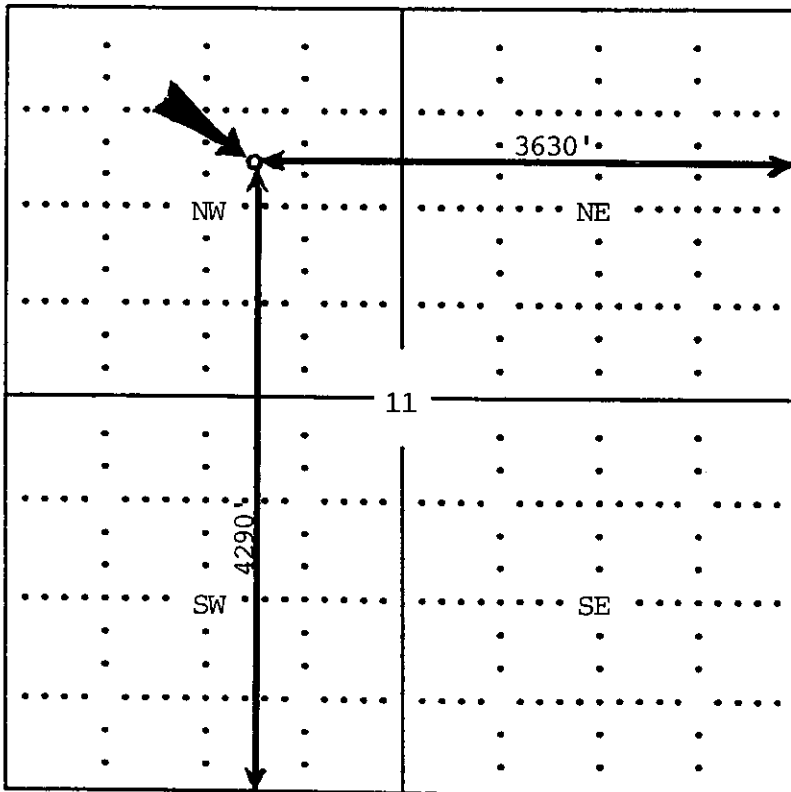

SCHIPPERS "A" #1-11
 SW NE NW
 Sec 11-11s-33w
 Logan County, KS

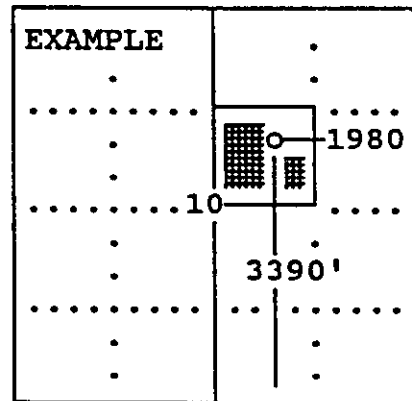

SEWARD CO.

In plotting the proposed location of the well, you must show:

- 1) The manner in which you are using the depicted plat by identifying section lines, i.e. 1 section, 1 section with 8 surrounding sections, 4 sections, etc.;
- 2) the distance of the proposed drilling location from the section's south/north and east/west; and
- 3) the distance to the nearest lease or unit boundary line.