

Must be approved by the K.C.C. five (5) days prior to commencing well

Expected Spud Date 8 month 25 day 91 year

NE. SE SW. Sec 4 Twp 11 Ss, Rg 33 W East West

OPERATOR: License # 5420  
Name: White & Ellis Drilling, Inc.  
Address: P.O. Box 48848  
City/State/Zip: Wichita, KS 67201-8848  
Contact Person: Michael L. Considine  
Phone: 316/263-1102

990' feet from South line of Section  
2970' feet from East line of Section  
(Note: Locate well on Section Plat on Reverse Side)

CONTRACTOR: License #: 5420  
Name: White & Ellis Drilling, Inc.

County: Logan  
Lease Name: Nollette Well #: 2-A  
Field Name: Unnamed Extension  
Is this a Prorated Field? yes X no  
Target Formation(s) W/KC - Cherokee  
Nearest lease or unit boundary: 330'  
Ground Surface Elevation: 3134' (est.) feet MSL  
Domestic well within 330 feet: yes X no  
Municipal well within one mile: yes X no  
Depth to bottom of fresh water: 120'  
Depth to bottom of usable water: 1785'  
Surface Pipe by Alternate: 1 X 2  
Length of Surface Pipe Planned to be set: 360'+  
Length of Conductor pipe required: None  
Projected Total Depth: 4750'  
Formation at Total Depth: Mississippian  
Water Source for Drilling Operations:  
well farm pond X other  
DWR Permit #: \_\_\_\_\_  
Will Cores Be Taken?: yes X no  
If yes, proposed zone: \_\_\_\_\_

Well Drilled For: Well Class: Type Equipment:  
X Oil ... Inj ... Infield X Mud Rotary  
... Gas ... Storage X Pool Ext. ... Air Rotary  
... OWWO ... Disposal ... Wildcat ... Cable  
... Seismic; ... # of Holes

If OWWO: old well information as follows:  
Operator: \_\_\_\_\_  
Well Name: \_\_\_\_\_  
Comp. Date: \_\_\_\_\_ Old Total Depth \_\_\_\_\_

Directional, Deviated or Horizontal wellbore? yes X no  
If yes, total depth location: \_\_\_\_\_

AFFIDAVIT

The undersigned hereby affirms that the drilling, completion and eventual plugging of this well will comply with K.S.A. 55-101, et. seq.

It is agreed that the following minimum requirements will be met:

- 1. The appropriate district office shall be notified before setting surface pipe;
- 2. The minimum amount of surface pipe as specified above shall be set by circulating cement to the top; in all cases surface pipe shall be set through all unconsolidated materials plus a minimum of 20 feet into the underlying formation;
- 3. If the well is dry, a plugging proposal shall be submitted to the district office. An agreement between the operator and the district office on plug length and placement is necessary prior to plugging;
- 4. The appropriate district office will be notified before well is either plugged or production casing is cemented in;
- 5. If an Alternate II completion, production pipe shall be cemented from below any usable water to surface within 120 days of spud date. In all cases, notify district office prior to any cementing.

I hereby certify that the statements made herein are true and to the best of my knowledge and belief.

Date: 8-20-91 Signature of Operator or Agent: Michael L. Considine Title: Secretary-Treasurer

FOR KCC USE:  
API # 15- 109-20,516-0000  
Conductor pipe required None feet  
Minimum surface pipe required 290 feet per Alt. 1(2)  
Approved by: mw 8-21-91  
EFFECTIVE DATE: 8-26-91  
This authorization expires: 2-21-92  
(This authorization void if drilling not started within 6 months of effective date.)  
Spud date: \_\_\_\_\_ Agent: \_\_\_\_\_

RECEIVED  
STATE CORPORATION COMMISSION  
AUG 20 1991  
CONSERVATION DIVISION  
Wichita, Kansas  
4 11 3300

REMEMBER TO:

- File Drill Pit Application (form CDP-1) with Intent to Drill;
- File Completion Form ACO-1 within 120 days of spud date;
- File acreage attribution plat according to field proration orders;
- Notify appropriate district office 48 hours prior to workover or re-entry;
- Submit plugging report (CP-4) after plugging is completed;
- Obtain written approval before disposing or injecting salt water.

**PLAT OF ACREAGE ATTRIBUTABLE TO A WELL**

State Corporation Commission, Conservation Division  
200 Colorado Derby Bldg. Wichita, Kansas 67202

OPERATOR White & Ellis Drlg., Inc. LOCATION OF WELL:  
 LEASE Nollette 990' feet north of SE corner  
 WELL NUMBER #2-A 2970' feet west of SE corner  
 FIELD Unnamed Extension SW/4 Sec. 4 T 11 R 33 EXW  
 COUNTY Logan  
 NO. OF ACRES ATTRIBUTABLE TO WELL 160 IS SECTION X REGULAR IRREGULAR?  
 DESCRIPTION OF ACREAGE SW/4 IF IRREGULAR, LOCATE WELL FROM NEAREST  
 CORNER BOUNDARY.

NOTE: If plat depicted is insufficient for your circumstances, you may attach your own scaled or surveyed plat.

**PLAT**

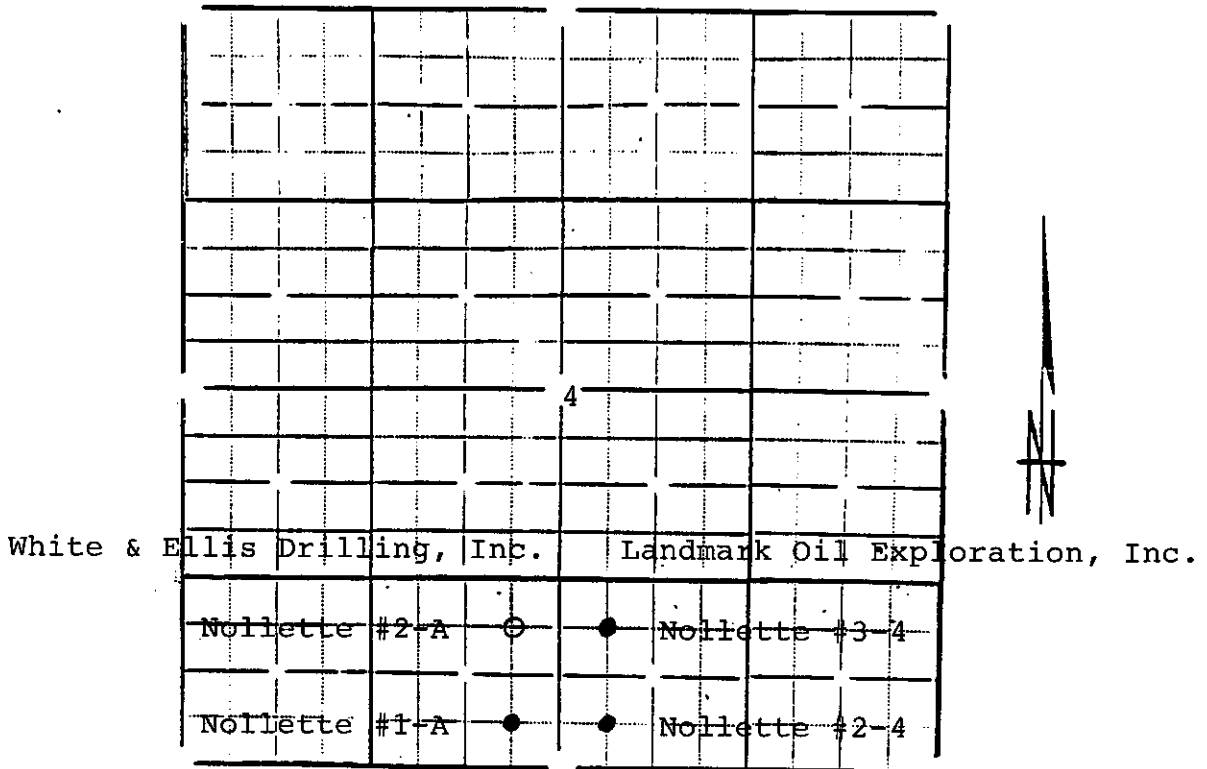

In plotting the proposed location of the well, you must show:

- 1) The manner in which you are using the depicted plat by identifying section lines, i.e. 1 section, 1 section with 8 surrounding partial sections, 4 sections, 16 sections, etc.;
- 2) the well's location relative to the location of other wells producing from the same common source of supply in adjoining drilling units, pursuant to K.A.R. 82-3-108, 82-3-207, 82-3-312, or special orders of the Commission;
- 3) the distance of the proposed drilling location from the section's east and south lines; and
- 4) the distance to the nearest lease or unit boundary line.

I hereby certify that the statements made herein are true and to the best of my knowledge and belief.

Signature of Operator or Agent Michael L. Considine  
 Date 8-20-91 Title Secretary-Treasurer