

FOR KCC USE:

FORM C-1 7/91

FORM MUST BE TYPED

EFFECTIVE DATE: 5-9-92

State of Kansas

FORM MUST BE SIGNED

DISTRICT # 4

NOTICE OF INTENTION TO DRILL

ALL BLANKS MUST BE FILLED

SEA? Yes No

Must be approved by the K.C.C. five (5) days prior to commencing well

Expected Spud Date June 29 1992 month day year

Spot W/2 E/2 SE Sec 4 11-S 33-W East West

OPERATOR: License # 06113 Name: Landmark Oil Exploration, Inc. Address: 250 N. Water, Suite 308 City/State/Zip: Wichita, Kansas 67202 Contact Person: Jeff Wood Phone: (316) 265-8181

1320 feet from South / XXXX line of Section 990 feet from East / XXXX line of Section IS SECTION XX REGULAR IRREGULAR? (NOTE: Locate well on the Section Plat on Reverse Side)

CONTRACTOR: License #: Name: unknown

County: Logan Lease Name: Nollette Well #: #4-4 Field Name: Cook NW

Well Drilled For: Well Class: Type Equipment: XX Oil ... Enh Rec XX Infield XX Mud Rotary ... Gas ... Storage ... Pool Ext. ... Air Rotary ... OWD ... Disposal ... Wildcat ... Cable ... Seismic: ... # of Holes ... Other

Is this a Prorated/Spaced Field? yes XX no Target Formation(s): LKC-Johnson Nearest lease or unit boundary: 330 Ground Surface Elevation: n/a feet MSL

If OWD: old well information as follows: Operator: Well Name: Comp. Date: Old Total Depth

Water well within one-quarter mile: yes XX no Public water supply well within one mile: yes XX no Depth to bottom of fresh water: 200 Depth to bottom of usable water: 1780

Directional, Deviated or Horizontal wellbore? yes XX no

Surface Pipe by Alternate: 1 XX 2 Length of Surface Pipe Planned to be set: 350' Length of Conductor pipe required: n/a Projected Total Depth: 4800'

If yes, true vertical depth:

Formation at Total Depth: Mississippian Water Source for Drilling Operations: well farm pond XX other

Bottom Hole Location:

DWR Permit #: Will Cores Be Taken? yes XX no

If yes, proposed zone:

AFFIDAVIT

The undersigned hereby affirms that the drilling, completion and eventual plugging of this well will comply with K.S.A. 55-101, et. seq.

It is agreed that the following minimum requirements will be met:

- 1. Notify the appropriate district office prior to spudding of well;
2. A copy of the approved notice of intent to drill shall be posted on each drilling rig;
3. The minimum amount of surface pipe as specified below shall be set by circulating cement to the top; in all cases surface pipe shall be set through all unconsolidated materials plus a minimum of 20 feet into the underlying formation;
4. If the well is dry hole, an agreement between the operator and the district office on plug length and placement is necessary prior to plugging;
5. The appropriate district office will be notified before well is either plugged or production casing is cemented in;
6. IF AN ALTERNATE II COMPLETION, PRODUCTION PIPE SHALL BE CEMENTED FROM BELOW ANY USABLE WATER TO SURFACE WITHIN 120 DAYS OF SPUD DATE. IN ALL CASES, NOTIFY DISTRICT OFFICE PRIOR TO ANY CEMENTING.

I hereby certify that the statements made herein are true and to the best of my knowledge and belief.

Date: April 23, 1992 Signature of Operator or Agent: Jeffrey R. Wood Title: President

FOR KCC USE: API # 15-109-2053340000 Conductor pipe required None feet Minimum surface pipe required 220 feet per Alt. X @ Approved by: DQ 5-4-92 This authorization expires: 11-4-92 (This authorization void if drilling not started within 6 months of effective date.) Spud date: Agent:

REMEMBER TO:

- File Drill Pit Application (form CDP-1) with Intent to Drill;
- File Completion Form ACO-1 within 120 days of spud date;
- File acreage attribution plat according to field prorator orders;
- Notify appropriate district office 48 hours prior to workover or re-ent;
- Submit plugging report (CP-4) after plugging is completed;
- Obtain written approval before disposing or injecting salt water.

Mail to: Conservation Division, 200 Colorado Derby Building, 202 W. First St., Wichita, Kansas 67202-1286.

RECEIVED APR 29 1992 KANSAS CORPORATION COMMISSION WICHITA, KS 4 11 33

**IN ALL CASES PLOT THE INTENDED WELL ON THE PLAT BELOW**

**PLAT OF ACREAGE ATTRIBUTABLE TO A WELL IN A PRORATED OR SPACED FIELD**

**If the intended well is in a prorated or spaced field, please fully complete this side of the form.** If the intended well is in a prorated or spaced field complete the plat below showing that the well will be properly located in relationship to other wells producing from the common source of supply. Please show all the wells within 1 mile of the boundaries of the proposed acreage attribution unit for gas wells and within 1/2 mile of the boundaries of the proposed acreage attribution unit for oil wells.

API NO. 15- \_\_\_\_\_  
 OPERATOR \_\_\_\_\_  
 LEASE \_\_\_\_\_  
 WELL NUMBER \_\_\_\_\_  
 FIELD \_\_\_\_\_

LOCATION OF WELL: COUNTY \_\_\_\_\_  
 \_\_\_\_\_ feet from south/north line of section  
 \_\_\_\_\_ feet from east/west line of section  
 SECTION \_\_\_\_\_ TWP \_\_\_\_\_ RG \_\_\_\_\_

NUMBER OF ACRES ATTRIBUTABLE TO WELL \_\_\_\_\_  
 QTR/QTR/QTR OF ACREAGE \_\_\_\_\_ - \_\_\_\_\_ - \_\_\_\_\_

IS SECTION \_\_\_\_\_ REGULAR or \_\_\_\_\_ IRREGULAR  
**IF SECTION IS IRREGULAR, LOCATE WELL FROM NEAREST CORNER BOUNDARY.**

Section corner used: \_\_\_\_\_ NE \_\_\_\_\_ NW \_\_\_\_\_ SE \_\_\_\_\_ SW

**PLAT**

(Show location of the well and shade attributable acreage for prorated or spaced wells.)  
 (Show footage to the nearest lease or unit boundary line.)

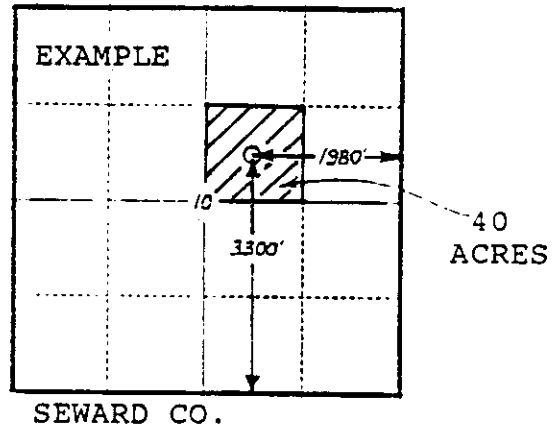
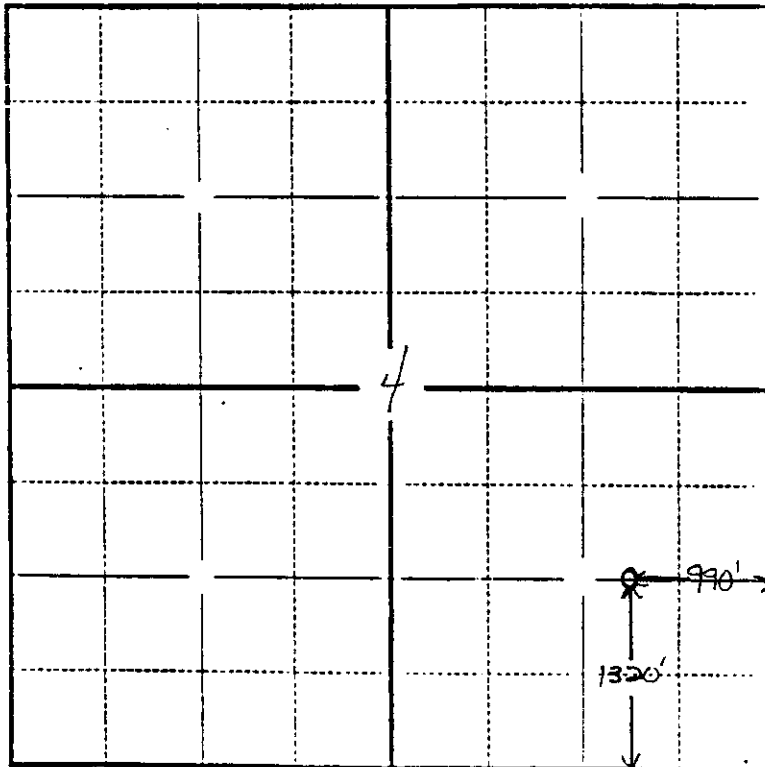

**In plotting the proposed location of the well, you must show:**

- 1) The manner in which you are using the depicted plat by identifying section lines, i.e. 1 section, 1 section with 8 surrounding sections, 4 sections, etc.;
- 2) the distance of the proposed drilling location from the section's south/north and east/west lines; and
- 3) the distance to the nearest lease or unit boundary line.