

EFFECTIVE DATE: 1-29-91

FORM MUST BE TYPED  
FORM C-1 4/90

State of Kansas

FORM MUST BE SIGNED  
ALL BLANKS MUST BE FILLED

NOTICE OF INTENTION TO DRILL

Must be approved by the K.C.C. five (5) days prior to commencing well

Expected Spud Date 1-27-91 ..... month day year  
120'W C N/2 S/2 SW/4 30 Twp 11S S, Rg 19 X East West

OPERATOR: License # 30606  
Name: Murfin Drilling Company, Inc.  
Address: 250 N. Water, Suite 300  
City/State/Zip: Wichita, Ks, 67202  
Contact Person: Scott Robinson  
Phone: 316-267-3241

..... 990 ..... feet from South line of Section  
..... 4080 ..... feet from East line of Section  
(Note: Locate well on Section Plat on Reverse Side)

CONTRACTOR: License #: 30606  
Name: Murfin Drilling Company

County: Ellis  
Lease Name: Allbert Well #: 1-30  
Field Name: Wildcat

Well Drilled For: Well Class: Type Equipment:  
X Oil ... Inj ... Infield X Mud Rotary  
... Gas ... Storage X Pool Ext. ... Air Rotary  
... OWWO ... Disposal ... Wildcat ... Cable  
... Seismic; ... # of Holes

Is this a Prorated Field? ... yes X no  
Target Formation(s): LKC/ARBUCKLE  
Nearest Lease or unit boundary: 330  
Ground Surface Elevation: Est. 2070 feet MSL

If OWWO: old well information as follows:  
Operator: .....  
Well Name: .....  
Comp. Date: ..... Old Total Depth .....

Domestic well within 330 feet: ... yes X no  
Municipal well within one mile: ... yes X no  
Depth to bottom of fresh water: 500'  
Depth to bottom of usable water: 600'

Directional, Deviated or Horizontal wellbore? ... yes X no  
If yes, total depth location: .....

Surface Pipe by Alternate: ... 1 X 2  
Length of Surface Pipe Planned to be set: 250'  
Length of Conductor pipe required: .....  
Projected Total Depth: 3750'

Formation at Total Depth: Arbuckle  
Water Source for Drilling Operations:  
... well X farm pond ... other

DWR Permit #: .....  
Will Cores Be Taken?: ... yes X no  
If yes, proposed zone: .....

AFFIDAVIT

The undersigned hereby affirms that the drilling, completion and eventual plugging of this well will comply with K.S.A. 55-101, et. seq.

It is agreed that the following minimum requirements will be met:

1. The appropriate district office shall be notified before setting surface pipe;
2. The minimum amount of surface pipe as specified above shall be set by circulating cement to the top; in all cases surface pipe shall be set through all unconsolidated materials plus a minimum of 20 feet into the underlying formation;
3. If the well is dry, a plugging proposal shall be submitted to the district office. An agreement between the operator and the district office on plug length and placement is necessary prior to plugging;
4. The appropriate district office will be notified before well is either plugged or production casing is cemented in;
5. If an Alternate II completion, production pipe shall be cemented from below any usable water to surface within 120 days of spud date. In all cases, notify district office prior to any cementing.

I hereby certify that the statements made herein are true and to the best of my knowledge and belief.

Date: 1/22/91 ..... Signature of Operator or Agent: C. Scott Robinson Agent f/Operator

FOR KCC USE:

API # 15- 051-24,722-0000  
 Conductor pipe required None feet  
 Minimum surface pipe required 250 feet per Alt. (2)  
 Approved by: MDW 1-24-91  
 EFFECTIVE DATE: 1-24-91  
 This authorization expires: 7-24-91  
 (This authorization void if drilling not started within 6 months of effective date.)  
 Spud date: \_\_\_\_\_ Agent: \_\_\_\_\_

STATE OF KANSAS  
 1-25-91 JAN 25 1991  
 30  
 1905

REMEMBER TO:

- File Drill Pit Application (form CDP-1) with Intent to Drill;
- File Completion Form ACO-1 within 120 days of spud date;
- File acreage attribution plat according to field proration orders;
- Notify appropriate district office 48 hours prior to workover or re-entry;
- Submit plugging report (CP-4) after plugging is completed;
- Obtain written approval before disposing or injecting salt water.

PLAT OF ACREAGE ATTRIBUTABLE TO A WELL

State Corporation Commission, Conservation Division  
200 Colorado Derby Bldg. Wichita, Kansas 67202

OPERATOR MURFIN DRILLING CO., Inc. LOCATION OF WELL:  
LEASE ALLBERT 990 feet north of SE corner  
WELL NUMBER #1-30 4080 feet west of SE corner  
FIELD Wildcat Sec. 30 T 11S R 19 E/W  
COUNTY Ellis  
NO. OF ACRES ATTRIBUTABLE TO WELL \_\_\_\_\_ IS SECTION X REGULAR \_\_\_\_\_ IRREGULAR?  
DESCRIPTION OF ACREAGE \_\_\_\_\_ IF IRREGULAR, LOCATE WELL FROM NEAREST  
CORNER BOUNDARY.  
N/2 SW/4 and N/2 S/2 SW/4

NOTE: If plat depicted is insufficient for your circumstances, you may attach your own scaled or surveyed plat.

PLAT

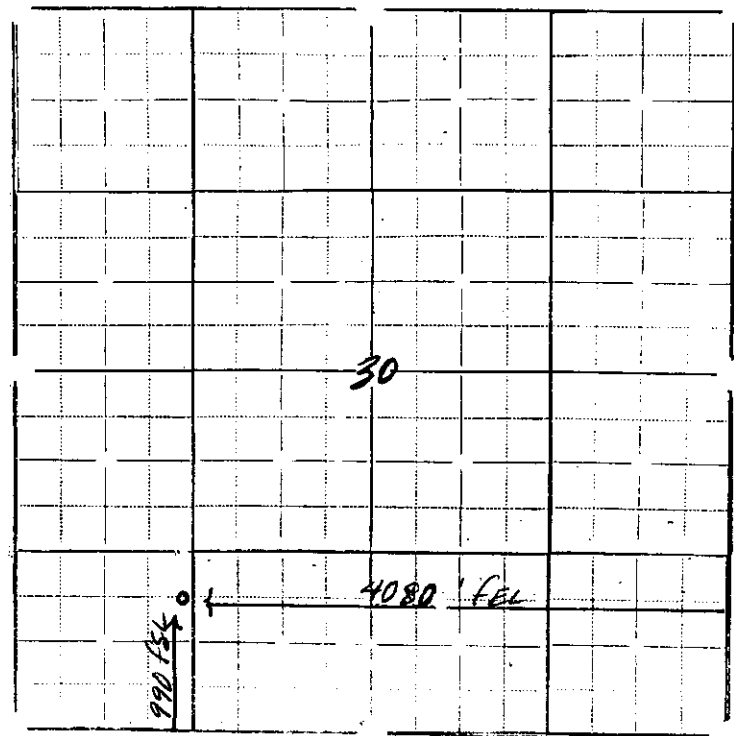

In plotting the proposed location of the well, you must show:

- 1) The manner in which you are using the depicted plat by identifying section lines, i.e. 1 section, 1 section with 8 surrounding partial sections, 4 sections, 16 sections, etc.;
- 2) the well's location relative to the location of other wells producing from the same common source of supply in adjoining drilling units, pursuant to K.A.R. 82-3-108, 82-3-207, 82-3-312, or special orders of the Commission;
- 3) the distance of the proposed drilling location from the section's east and south lines; and
- 4) the distance to the nearest lease or unit boundary line.

I hereby certify that the statements made herein are true and to the best of my knowledge and belief.

Signature of Operator or Agent C. Scott Robinson  
C. Scott Robinson  
Date 1-22-91 Title Geological Manager