

EFFECTIVE DATE: 4-7-92
DISTRICT # 1
SEAT X YES NO

State of Kansas
NOTICE OF INTENTION TO DRILL

FORM MUST BE TYPED
FORM MUST BE SIGNED
ALL BLANKS MUST BE FILLED

Must be approved by the K.C.C. five (5) days prior to commencing well

Expected Spud Date April 3, 1992 ^{APP} Spot SE NW/4 Sec 33 Twp 16. S Rg 19. E East X West
month day year

OPERATOR: License # 5815
Name: C. & R. DRILLING CO.
Address: 410 W. 17th St. Suite 1140
City/State/Zip: Denver, CO 80202
Contact Person: Les. Olson
Phone: 303/623-6144

2780 feet from South ~~XXXX~~ line of Section
3730 feet from East / ~~WEST~~ line of Section

IS SECTION REGULAR IRREGULAR?
(NOTE: Locate well on the Section Plat on Reverse Side)
County: Rush

CONTRACTOR: License #: 5418
Name: ALLEN DRILLING COMPANY

Lease Name: Grabbe Well #: 2
Field Name: UNNAMED

Well Drilled For: Well Class: Type Equipment:
X Oil ... Enh Rec ... Infield X Mud Rotary
... Gas ... Storage X Pool Ext. ... Air Rotary
... OWMO ... Disposal ... Wildcat ... Cable
... Seismic; ... # of Holes ... Other
... Other

Is this a Prorated/Spaced Field? ... yes X no
Target Formation(s): Arbuckle
Nearest lease or unit boundary: 1550

If OWMO: old well information as follows:
Operator: N/A
Well Name:
Comp. Date: Old Total Depth

Ground Surface Elevation: NA feet MSL
Water well within one-quarter mile: ... yes X no
Public water supply well within one mile: ... yes X no

Directional, Deviated or Horizontal wellbore? ... yes X no
If yes, true vertical depth:
Bottom Hole Location:

Depth to bottom of fresh water: 400
Depth to bottom of usable water: 825
Surface Pipe by Alternate: ... 1 X 2
Length of Surface Pipe Planned to be set: 350'

Length of Conductor pipe required: N/A
Projected Total Depth: 3900'
Formation at Total Depth: Arbuckle

Water Source for Drilling Operations:
... well X farm pond other
DWR Permit #:
Will Cores Be Taken? ... yes X no
If yes, proposed zone:

AFFIDAVIT

The undersigned hereby affirms that the drilling, completion and eventual plugging of this well will comply with K.S.A. 55-101, et. seq.
It is agreed that the following minimum requirements will be met:

1. Notify the appropriate district office prior to spudding of well;
2. A copy of the approved notice of intent to drill shall be posted on each drilling rig;
3. The minimum amount of surface pipe as specified below shall be set by circulating cement to the top; in all cases surface pipe shall be set through all unconsolidated materials plus a minimum of 20 feet into the underlying formation;
4. If the well is dry hole, an agreement between the operator and the district office on plug length and placement is necessary prior to plugging;
5. The appropriate district office will be notified before well is either plugged or production casing is cemented in;
6. IF AN ALTERNATE II COMPLETION, PRODUCTION PIPE SHALL BE CEMENTED FROM BELOW ANY USABLE WATER TO SURFACE WITHIN 120 DAYS OF SPUD DATE. IN ALL CASES, NOTIFY DISTRICT OFFICE PRIOR TO ANY CEMENTING.

I hereby certify that the statements made herein are true and to the best of my knowledge and belief.
Date: 3/30/92 Signature of Operator or Agent: John A. Johnson Title: Vice-Pres. Drlg.

FOR KCC USE:
API # 15- 165-21605-0006
Conductor pipe required None feet
Minimum surface pipe required 300 feet per Alt. # (2)
Approved by: MLC 4-2-92
This authorization expires: 10-2-92
(This authorization void if drilling not started within 6 months of effective date.)
Spud date: Agent:

REMEMBER TO:

- File Drill Pit Application (form CDP-1) with Intent to Drill;
- File Completion Form ACO-1 within 120 days of spud date;
- File scrape attribution plat according to field preration orders;
- Notify appropriate district office 48 hours prior to workover or re-entry;
- Submit plugging report (CP-4) after plugging is completed;
- Obtain written approval before disposing or injecting salt water.

Mail to: Conservation Division, 200 Colorado Derby Building, 202 W. First St., Wichita, Kansas 67202-1286.

RECEIVED
KANSAS CORPORATION COMMISSION
MAR 30 1992
CONSERVATION DIVISION
WICHITA, KS
33 16 19W

IN ALL CASES PLOT THE INTENDED WELL ON THE PLAT BELOW

PLAT OF ACREAGE ATTRIBUTABLE TO A WELL IN A PRORATED OR SPACED FIELD

If the intended well is in a prorated or spaced field, please fully complete this side of the form. If the intended well is in a prorated or spaced field complete the plat below showing that the well will be properly located in relationship to other wells producing from the common source of supply. Please show all the wells within 1 mile of the boundaries of the proposed acreage attribution unit for gas wells and within 1/2 mile of the boundaries of the proposed acreage attribution unit for oil wells.

API NO. 15- _____
 OPERATOR C & R Drilling Co. LOCATION OF WELL: COUNTY Rush
 LEASE Grabbe 2780 feet from south/~~north~~ line of section
 WELL NUMBER #2 3730 feet from east/~~west~~ line of section
 FIELD _____ SECTION 33 TWP 16 RG 19

NUMBER OF ACRES ATTRIBUTABLE TO WELL _____ IS SECTION _____ REGULAR or _____ IRREGULAR
 QTR/QTR/QTR OF ACREAGE _____ IF SECTION IS IRREGULAR, LOCATE WELL FROM NEAREST
 CORNER BOUNDARY.

Section corner used: NE NW SE SW
PLAT

(Show location of the well and shade attributable acreage for prorated or spaced wells.)
 (Show footage to the nearest lease or unit boundary line.)

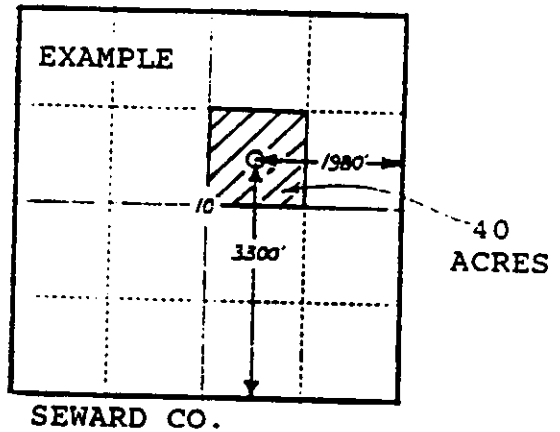
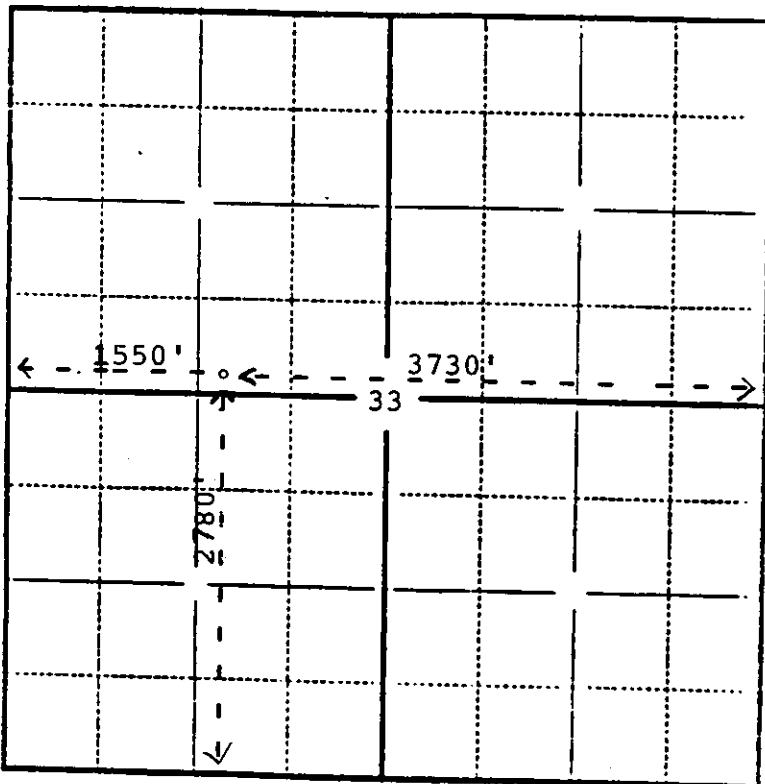

In plotting the proposed location of the well, you must show:

- 1) The manner in which you are using the depicted plat by identifying section lines, i.e. 1 section, 1 section with 8 surrounding sections, 4 sections, etc.;
- 2) the distance of the proposed drilling location from the section's south/north and east/west lines; and
- 3) the distance to the nearest lease or unit boundary line.