

FOR KCC USE:

X Correction

FORM C-1 7/91

FORM MUST BE TYPED

FORM MUST BE SIGNED

ALL BLANKS MUST BE FILLED

EFFECTIVE DATE: *11-27-93*

State of Kansas

DISTRICT # *11*

NOTICE OF INTENTION TO DRILL

SGA? Yes No

Must be approved by the K.C.C. five (5) days prior to commencing well

Expected Spud Date 11 29 1993
month day year

Spot C NW NW Sec 14 Twp 18 S. Rg 26 X East West

OPERATOR: License # 4629
Name: Brito Oil Co./Dunne Oil Co.
Address: 200 E. First, Suite 208
City/State/Zip: Wichita, KS 67202
Contact Person: Raul F. Brito
Phone: 316-263-8787

660 feet from ~~center~~ / North line of Section
660 feet from ~~center~~ / West line of Section
IS SECTION X REGULAR IRREGULAR?

(NOTE: Locate well on the Section Plat on Reverse Side)

CONTRACTOR: License #: 5104
Name: Blue Goose Drilling, Inc.

County: Ness

Lease Name: Lamoree Well #: 1-14

Field Name: WC

Is this a Prorated/Spaced Field? yes X no

Target Formation(s): Marmaton, Mississippi

Nearest lease or unit boundary: 660'

Ground Surface Elevation: NA EST 2005 feet MSL

Water well within one-quarter mile: yes X no

Public water supply well within one mile: yes X no

Depth to bottom of fresh water: 300'

Depth to bottom of usable water: 1080'

Surface Pipe by Alternate: 1 X 2

Length of Surface Pipe Planned to be set: 320

Length of Conductor pipe required: NONE

Projected Total Depth: 4600'

Formation at Total Depth: Mississippi

Water Source for Drilling Operations:

well farm pond X other

DWR Permit #: _____

Will Cores Be Taken?: yes X no

If yes, proposed zone: _____

Well Drilled For: Well Class: Type Equipment:

Oil ... Enh Rec ... Infield Mud Rotary
 Gas ... Storage ... Pool Ext. ... Air Rotary
 OWD ... Disposal Wildcat ... Cable
 Seismic; ... # of Holes ... Other
 Other

12-1-93 con

If OWD: old well information as follows:

Operator: _____

Well Name: _____

Comp. Date: _____ Old Total Depth _____

Directional, Deviated or Horizontal wellbore? yes X no

If yes, true vertical depth: _____

Bottom Hole Location: _____

X Was 320'

AFFIDAVIT

X IS 340 MIN RECEIVED
STATE CORPORATION COMMISSION

The undersigned hereby affirms that the drilling, completion and eventual plugging of this well will comply with K.S.A. 55-101, et. seq.

It is agreed that the following minimum requirements will be met:

NOV 22 1993
11-22-93
CONSERVATION DIVISION
Wichita, Kansas

1. Notify the appropriate district office prior to spudding of well;
2. A copy of the approved notice of intent to drill shall be posted on each drilling rig;
3. The minimum amount of surface pipe as specified below shall be set by circulating cement to the top; in all cases surface pipe shall be set through all unconsolidated materials plus a minimum of 20 feet into the underlying formation;
4. If the well is dry hole, an agreement between the operator and the district office on plug length and placement is necessary prior to plugging;
5. The appropriate district office will be notified before well is either plugged or production casing is cemented in;
6. IF AN ALTERNATE II COMPLETION, PRODUCTION PIPE SHALL BE CEMENTED FROM BELOW ANY USABLE WATER TO SURFACE WITHIN 120 DAYS OF SPUD DATE. IN ALL CASES, NOTIFY DISTRICT OFFICE PRIOR TO ANY CEMENTING.

I hereby certify that the statements made herein are true and to the best of my knowledge and belief.

Date: 11-19-93 Signature of Operator or Agent: _____ Title: President

FOR KCC USE:
 API # 15- 135-23795-0000
 Conductor pipe required NONE feet
 Minimum surface pipe required 320' feet per Alt.
 Approved by: CB 11-22-93
 This authorization expires: 5-22-94
 (This authorization void if drilling not started within 6 months of effective date.)
 Spud date: _____ Agent: _____

REMEMBER TO:

- File Drill Pit Application (form CDP-1) with Intent to Drill;
- File Completion Form ACO-1 within 120 days of spud date;
- File acreage attribution plat according to field proration orders;
- Notify appropriate district office 48 hours prior to workover or re-entry;
- Submit plugging report (CP-4) after plugging is completed;
- Obtain written approval before disposing or injecting salt water.

Mail to: Conservation Division, 200 Colorado Derby Building, 202 W. First St., Wichita, Kansas 67202-1286.

11/18/93

IN ALL CASES PLOT THE INTENDED WELL ON THE PLAT BELOW

PLAT OF ACREAGE ATTRIBUTABLE TO A WELL IN A PRORATED OR SPACED FIELD

If the intended well is in a prorated or spaced field, please fully complete this side of the form. If the intended well is in a prorated or spaced field complete the plat below showing that the well will be properly located in relationship to other wells producing from the common source of supply. Please show all the wells within 1 mile of the boundaries of the proposed acreage attribution unit for gas wells and within 1/2 mile of the boundaries of the proposed acreage attribution unit for oil wells.

API NO. 15-

OPERATOR Brito Oil Company, Inc.
 LEASE Lamoree #1-14
 WELL NUMBER #1-14
 FIELD Wildcat

LOCATION OF WELL: COUNTY Ness
660 feet from south/north line of section
660 feet from east/west line of section
 SECTION 14 TWP 18 RG 26W

NUMBER OF ACRES ATTRIBUTABLE TO WELL 40
 QTR/QTR/QTR OF ACREAGE C - NW - NW

IS SECTION X REGULAR or IRREGULAR
IF SECTION IS IRREGULAR, LOCATE WELL FROM NEAREST CORNER BOUNDARY.

Section corner used: NE NW SE SW

PLAT

(Show location of the well and shade attributable acreage for prorated or spaced wells.)
 (Show footage to the nearest lease or unit boundary line.)

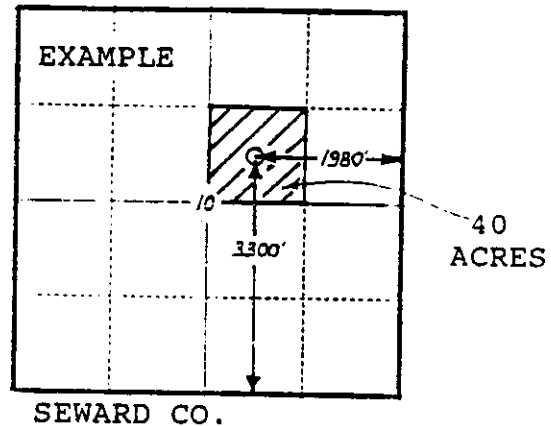
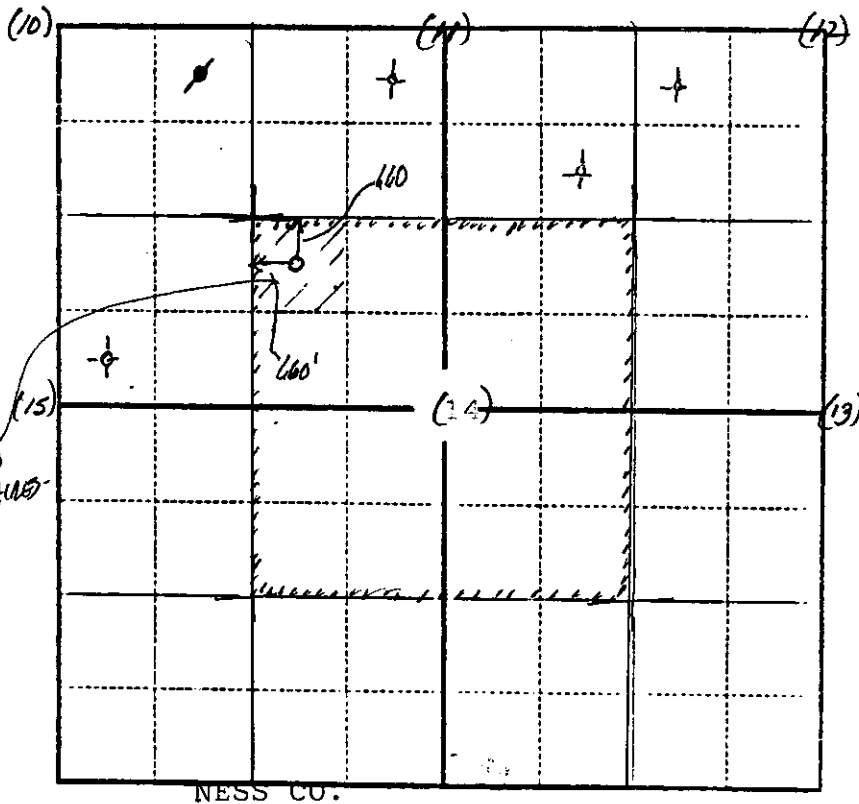

In plotting the proposed location of the well, you must show:

- 1) The manner in which you are using the depicted plat by identifying section lines, i.e. 1 section, 1 section with 8 surrounding sections, 4 sections, etc.;
- 2) the distance of the proposed drilling location from the section's south/north and east/west lines; and
- 3) the distance to the nearest lease or unit boundary line.