

FOR KCC USE:

EFFECTIVE DATE: 12-11-91  
DISTRICT # 1  
SEAL X Yes No

State of Kansas  
NOTICE OF INTENTION TO DRILL

FORM C-1 1/91  
FORM MUST BE TYPED  
FORM MUST BE SIGNED  
ALL BLANKS MUST BE FILLED

Must be approved by the K.C.C. five (5) days prior to commencing well

Expected Spud Date 12/11/1991  
month day year  
Spot SW - SE - NE Sec. 4 Twp. 18 S. Rg. 24 East West

OPERATOR: License # 5011  
Name: Viking Resources, Inc.  
Address: 105 S. Broadway, Suite 1040  
City/State/Zip: Wichita, KS 67202  
Contact Person: James B. Devlin  
Phone: 316-262-2502

3165 feet from South / North line of Section  
795 feet from East / West line of Section  
IS SECTION X REGULAR IRREGULAR

(NOTE: Locate well on the Section Plat on Reverse Side)  
County: Ness  
Lease Name: Potter Well #: 3  
Field Name: Unknown  
Is this a Prorated/Spaced Field? yes X no  
Target Formation(s): Miss  
Nearest lease or unit boundary: 795  
Ground Surface Elevation: 2320 est. feet MSL  
Water well within one-quarter mile: yes X no  
Public water supply well within one mile: yes X no  
Depth to bottom of fresh water: 100  
Depth to bottom of usable water: 1000  
Surface Pipe by Alternate: 1 X 2  
Length of Surface Pipe Planned to be set: 250  
Length of Conductor pipe required: none  
Projected Total Depth: 4400  
Formation at Total Depth: Miss  
Water Source for Drilling Operations:  
... well X farm pond other  
DNR Permit #:   
Will Cores Be Taken? yes X no  
If yes, proposed zone:   
Directional, Deviated or Horizontal wellbore? yes X no  
If yes, true vertical depth:   
Bottom Hole Location:   
AFFIDAVIT

CONTRACTOR: License #: 4958  
Name: Mallard JV, Inc.

Well Drilled For: Well Class: Type Equipment:  
X Oil ... Enh Rec ... Infield X Mud Rotary  
Gas ... Storage ... Pool Ext. ... Air Rotary  
OAWO ... Disposal X Wildcat ... Cable  
Seismic: # of Holes ... Other  
Other  
If OAWO: old well information as follows:  
Operator:  
Well Name:  
Comp. Date: Old Total Depth

The undersigned hereby affirms that the drilling, completion and eventual plugging of this well will comply with K.S.A. 55-101, et. seq.  
It is agreed that the following minimum requirements will be met:

- 1. Notify the appropriate district office prior to spudding of well;
- 2. A copy of the approved notice of intent to drill shall be posted on each drilling rig;
- 3. The minimum amount of surface pipe as specified below shall be set by circulating cement to the top; in all cases surface pipe shall be set through all unconsolidated materials plus a minimum of 20 feet into the underlying formation;
- 4. If the well is dry hole, an agreement between the operator and the district office on plug length and placement is necessary prior to plugging;
- 5. The appropriate district office will be notified before well is either plugged or production casing is cemented in;
- 6. IF AN ALTERNATE IS COMPLETION, PRODUCTION PIPE SHALL BE CEMENTED FROM BELOW ANY USABLE WATER TO SURFACE WITHIN 120 DAYS OF SPUD DATE. IN ALL CASES, NOTIFY DISTRICT OFFICE PRIOR TO ANY CEMENTING.

I hereby certify that the statements made herein are true and to the best of my knowledge and belief.  
Date: 12-3-91 Signature of Operator or Agent: James B. Devlin Title: President

CONTACT DISTRICT OFFICE PRIOR TO SPUDDING FOR APPROVAL  
KCC OFFICE USE ONLY

FOR KCC USE:  
API # 15- 135-23635-00-00  
Conductor pipe required None feet  
Minimum surface pipe required 200 feet per Alt. (2)  
Approved by: MLD 12-6-91  
This authorization expires: 6-6-92  
(This authorization void if drilling not started within 6 months of effective date.)  
Spud date: Agent:

- REMEMBER TO:
- File Drill Pit Application (form CDP-1) with Intent to Drill;
  - File completion Form ACO-1 within 120 days of spud date;
  - File acreage attribution plat according to field prorotation orders;
  - Notify appropriate district office 48 hours prior to workover or re-entry;
  - Submit plugging report (CP-4) after plugging is completed;
  - Obtain written approval before disposing or injecting salt water.
- Mail to: Conservation Division, 208 Colorado Barby Building, 202 W. First St., Wichita, Kansas 67202-1286.

W 4:15pm D  
CT 12-6-91 CT  
MMA

17  
18  
2410

**IN ALL CASES PLOT THE INTENDED WELL ON THE PLAT BELOW**  
**PLAT OF ACREAGE ATTRIBUTABLE TO A WELL IN A PRORATED OR SPACED FIELD**

**If the intended well is in a prorated or spaced field, please fully complete this side of the form.** If the intended well is in a prorated or spaced field complete the plat below showing that the well will be properly located in relationship to other wells producing from the common source of supply. Please show all the wells within 1 mile of the boundaries of the proposed acreage attribution unit for gas wells and within 1/2 mile of the boundaries of the proposed acreage attribution unit for oil wells.

API NO. 15- \_\_\_\_\_  
 OPERATOR \_\_\_\_\_  
 LEASE \_\_\_\_\_  
 WELL NUMBER \_\_\_\_\_  
 FIELD \_\_\_\_\_

LOCATION OF WELL: COUNTY \_\_\_\_\_  
 \_\_\_\_\_ feet from south/north line of section  
 \_\_\_\_\_ feet from east/west line of section  
 SECTION \_\_\_\_\_ TWP \_\_\_\_\_ RG \_\_\_\_\_

NUMBER OF ACRES ATTRIBUTABLE TO WELL \_\_\_\_\_  
 QTR/QTR/QTR OF ACREAGE \_\_\_\_\_

IS SECTION \_\_\_\_\_ REGULAR or \_\_\_\_\_ IRREGULAR  
**IF SECTION IS IRREGULAR, LOCATE WELL FROM NEAREST CORNER BOUNDARY.**

Section corner used: \_\_\_\_\_ NE \_\_\_\_\_ NW \_\_\_\_\_ SE \_\_\_\_\_ SW  
**PLAT**

(Show location of the well and shade attributable acreage for prorated or spaced wells.)  
 (Show footage to the nearest lease or unit boundary line.)

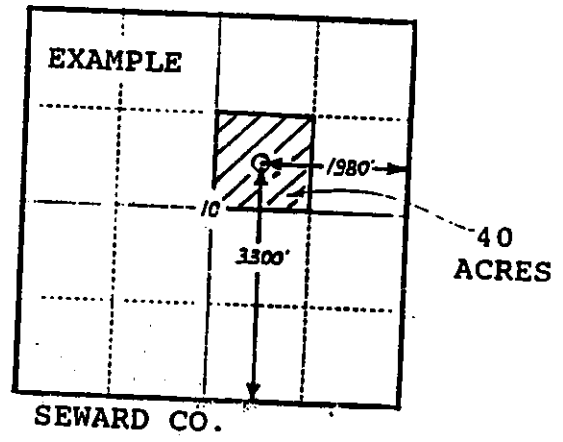
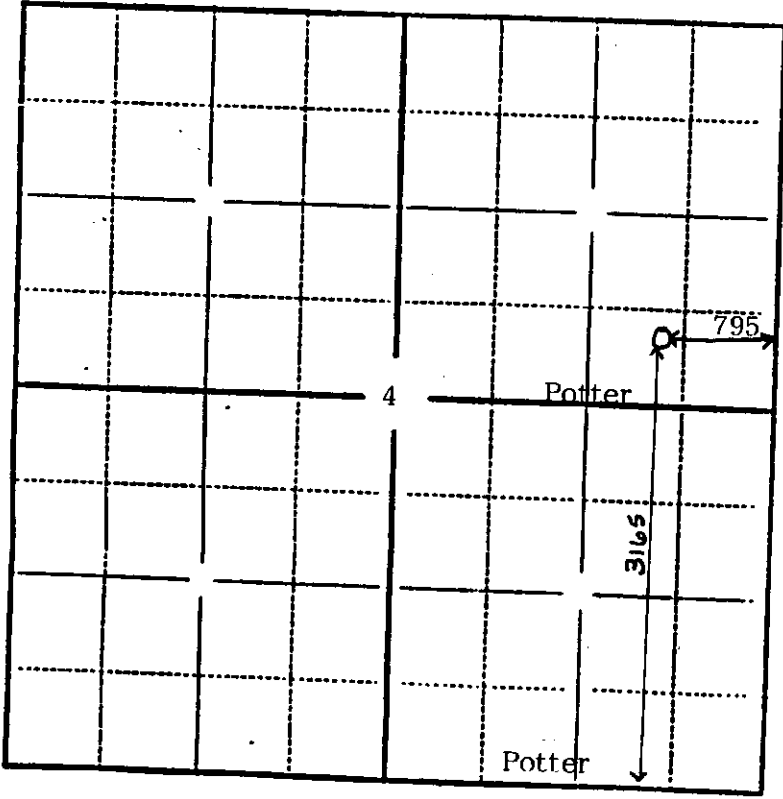

SEWARD CO.  
 CONTACT DISTRICT  
 OFFICE FROM  
 TO SURVIVOR  
 FOR AVALANCH  
 FOR OFFICE ONLY  
 \_\_\_\_\_ W  
 \_\_\_\_\_ TO \_\_\_\_\_ TO

**In plotting the proposed location of the well, you must show:**

- 1) The manner in which you are using the depicted plat by identifying section lines, i.e. 1 section, 1 section with 8 surrounding sections, 4 sections, etc.;
- 2) the distance of the proposed drilling location from the section's south/north and east/west lines; and
- 3) the distance to the nearest lease or unit boundary line.