

EFFECTIVE DATE: 3-27-93
DISTRICT # 1
SEAL Yes No

State of Kansas
NOTICE OF INTENTION TO DRILL

FORM MUST BE TYPED
FORM MUST BE SIGNED
ALL BLANKS MUST BE FILLED

Must be approved by the K.C.C. five (5) days prior to commencing well

Expected Spud Date 5 1 93 ^{Spot} SE NE NW Sec 11 Twp 18 S, Rg 43 East
month day year off X West

OPERATOR: License # 30605
Name: HGB Oil Co., Edwin C. Schuett & Sharp
Address: 1707 S. Jasmine Engineering
City/State/Zip: Denver, CO 80224
Contact Person: Edwin C. Schuett
Phone: 303-825-6005

810' feet from 3825' North line of Section
3150' feet from 3300' East line of Section
IS SECTION REGULAR X IRREGULAR

(NOTE: Locate well on the Section Plat on Reverse Side)
County: Greeley

Lease Name: Brewer Well #: 2
Field Name: Moore Johnson
Is this a Prorated/Spaced Field? X yes no

CONTRACTOR: License #: 8241
Name: Emphasis Oil Operations

Target Formation(s): Morrow

Nearest lease or unit boundary: 510'
Ground Surface Elevation: 3890 estimate feet MSL

Well Drilled For: Well Class: Type Equipment:
X. Oil ... Enh Rec X. Infield X Mud Rotary
... Gas ... Storage ... Pool Ext. ... Air Rotary
... OWD ... Disposal ... Wildcat ... Cable
... Seismic; ... # of Holes ... Other
... Other

Water well within one-quarter mile: no
Public water supply well within one mile: no

Depth to bottom of fresh water: 180'
Depth to bottom of usable water: 1700'

Surface Pipe by Alternate: 1 X 2
Length of Surface Pipe Planned to be set: 350'
Length of Conductor pipe required: none

Projected Total Depth: 5250'
Formation at Total Depth: Lower Morrow

If OWD: old well information as follows:
Operator: _____
Well Name: _____
Comp. Date: _____ Old Total Depth _____

Water Source for Drilling Operations:
X well no farm pond no other

OWR Permit #: _____
Will Cores Be Taken? yes X no
If yes, proposed zone: _____

Directional, Deviated or Horizontal wellbore? yes X no
If yes, true vertical depth: _____
Bottom Hole Location: _____

AFFIDAVIT

The undersigned hereby affirms that the drilling, completion and eventual plugging of this well will comply with K.S.A. 55-101, et. seq.

It is agreed that the following minimum requirements will be met:

1. Notify the appropriate district office prior to spudding of well;
2. A copy of the approved notice of intent to drill shall be posted on each drilling rig;
3. The minimum amount of surface pipe as specified below shall be set by circulating cement to the top; in all cases surface pipe shall be set through all unconsolidated materials plus a minimum of 20 feet into the underlying formation;
4. If the well is dry hole, an agreement between the operator and the district office on plug length and placement is necessary prior to plugging;
5. The appropriate district office will be notified before well is either plugged or production casing is cemented in;
6. IF AN ALTERNATE II COMPLETION, PRODUCTION PIPE SHALL BE CEMENTED FROM BELOW ANY USABLE WATER TO SURFACE WITHIN 120 DAYS OF SPUD DATE. IN ALL CASES, NOTIFY DISTRICT OFFICE PRIOR TO ANY CEMENTING.

I hereby certify that the statements made herein are true and to the best of my knowledge and belief.

Date: March 18, 1993 Signature of Operator or Agent: Edwin C. Schuett Title: Co-Operator

FOR ECC USE:
API # 15- 071-20590-0000
Conductor pipe required None feet
Minimum surface pipe required 350 feet per Alt. X ②
Approved by: CB 3-22-93
This authorization expires: 9-22-93
(This authorization void if drilling not started within 6 months of effective date.)
Spud date: _____ Agent: _____

REMEMBER TO:

- File Drill Pit Application (form CDP-1) with Intent to Drill;
- File Completion Form ACO-1 within 120 days of spud date;
- File acreage attribution plat according to field proration orders;
- Notify appropriate district office 48 hours prior to workover or re-entry;
- Submit plugging report (CP-4) after plugging is completed;
- Obtain written approval before disposing or injecting salt water.

Mail to: Conservation Division, 200 Colorado Derby Building, 202 W. First St., Wichita, Kansas 67202-1286.

RECEIVED
STATE CORPORATION COMMISSION
MAR 22 1993
3-22-93
CONSERVATION DIVISION
Wichita, Kansas

11
18
43

IN ALL CASES PLOT THE INTENDED WELL ON THE PLAT BELOW

PLAT OF ACREAGE ATTRIBUTABLE TO A WELL IN A PRORATED OR SPACED FIELD

If the intended well is in a prorated or spaced field, please fully complete this side of the form. If the intended well is in a prorated or spaced field complete the plat below showing that the well will be properly located in relationship to other wells producing from the common source of supply. Please show all the wells within 1 mile of the boundaries of the proposed acreage attribution unit for gas wells and within 1/2 mile of the boundaries of the proposed acreage attribution unit for oil wells.

API NO. 15- _____
 OPERATOR HGB Oil Co., Edwin C. Schuett & Sharp LOCATION OF WELL: COUNTY Greeley
 LEASE Brewer Engineering 810 feet from south/north line of section
 WELL NUMBER 2 3150 feet from east/west line of section
 FIELD Moore-Johnson SECTION 11 TWP 18S RG 43W

NUMBER OF ACRES ATTRIBUTABLE TO WELL 53.48⁶⁴ IS SECTION _____ REGULAR or x IRREGULAR
 QTR/QTR/QTR OF ACREAGE _____ - N/2 - NW/4 IF SECTION IS IRREGULAR, LOCATE WELL FROM NEAREST CORNER BOUNDARY.

Section corner used: x NE _____ NW _____ SE _____ SW

PLAT

(Show location of the well and shade attributable acreage for prorated or spaced wells.)
 (Show footage to the nearest lease or unit boundary line.)

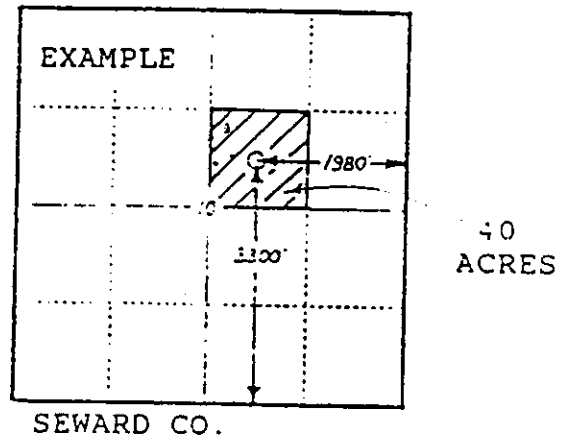
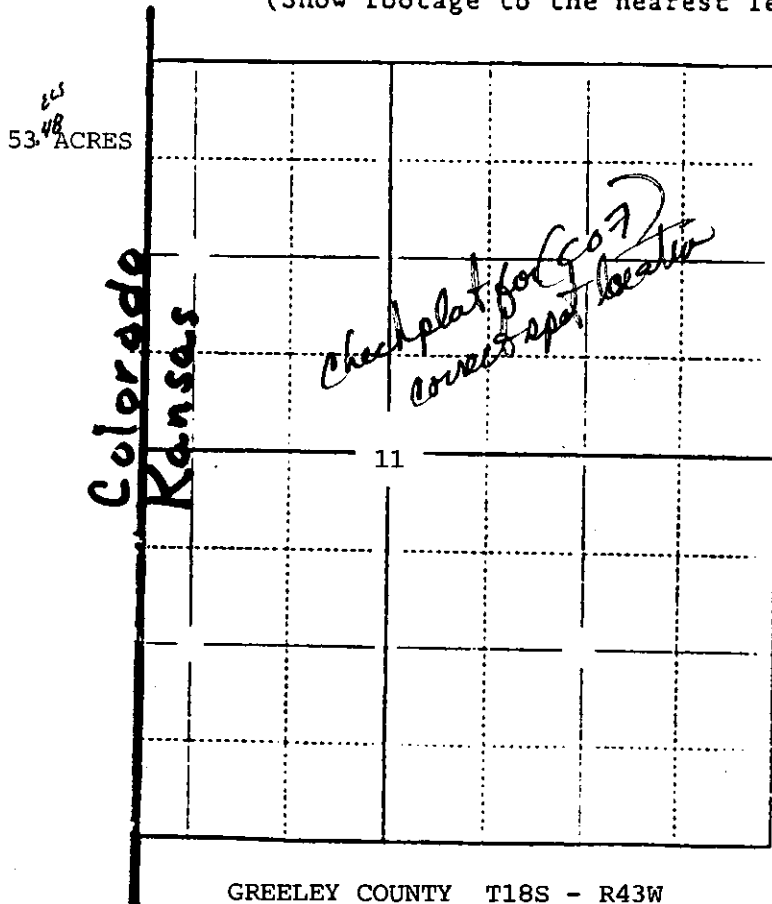

In plotting the proposed location of the well, you must show:

- 1) The manner in which you are using the depicted plat by identifying section lines, i.e. 1 section, 1 section with 8 surrounding sections, 4 sections, etc.;
- 2) the distance of the proposed drilling location from the section's south/north and east/west lines; and
- 3) the distance to the nearest lease or unit boundary line.