

FOR KCC USE:

COR

FORM C-1 7/91
FORM MUST BE TYPED
FORM MUST BE SIGNED
ALL BLANKS MUST BE FILLED

EFFECTIVE DATE: 11-3-92

State of Kansas

DISTRICT # 1

NOTICE OF INTENTION TO DRILL

SGAT... Yes... No

Must be approved by the K.C.C. five (5) days prior to commencing well

Expected Spud Date September 14 1992
month day year

Spot NW SE Sec 11 Twp 18 S. Rg 43 East West

OPERATOR: License # 30819
Name: Duncan Energy Company
Address: 1777 S. Harrison St. P-1
City/State/Zip: Denver, CO 80210
Contact Person: John Battridge
Phone: (303) 759-3303

2042 feet from South ~~XXXX~~ line of Section
2066 feet from East ~~XXXX~~ line of Section
IS SECTION REGULAR X IRREGULARY

CONTRACTOR: License #
Name:

(NOTE: Locate well on the Section Plat on Reverse Side)

County: Greeley
Lease Name: Huddleston Well #: 33-11

Field Name: Moore-Johnson
Is this a Prorated/Spaced Field? X yes ... no

Target Formation(s): Morrow
* Nearest lease or unit boundary: 520' FWL

* Ground Surface Elevation: 3909 feet MSL

Water well within one-quarter mile: ... yes X ... no
Public water supply well within one mile: ... yes X ... no

Depth to bottom of fresh water: 110'
Depth to bottom of usable water: 1700'

Surface Pipe by Alternate: ... 1 X ... 2
Length of Surface Pipe Planned to be set: 200'

Length of Conductor pipe required: None
Projected Total Depth: 5300'

Formation at Total Depth: Morrow
Water Source for Drilling Operations:

... well X ... farm pond ... other
DWR Permit #:

Will Cores Be Taken?: ... yes X ... no
If yes, proposed zone:

Well Drilled For: Well Class: Type Equipment:
X Oil ... Enh Rec ... Infield X Mud Rotary
... Gas ... Storage X Pool Ext. ... Air Rotary
... OWD ... Disposal ... Wildcat ... Cable
... Seismic; ... # of Holes ... Other
... Other

If OWD: old well information as follows:
Operator:
Well Name:
Comp. Date: Old Total Depth

Directional, Deviated or Horizontal wellbore? ... yes X ... no
If yes, true vertical depth:

Bottom Hole Location:
* Was 760' N.S. & 2080' E. 1. NW SW SE
760 N.L.B. & G.S.E. 3888

* Is NW NW SE 2042 f.s.l. & 2066 f.e.
520' N.L.B. & G.S.E. 3909'

AFFIDAVIT

The undersigned hereby affirms that the drilling, completion and eventual plugging of this well will comply with K.S.A. 55-101, et. seq.

It is agreed that the following minimum requirements will be met:

- 1. Notify the appropriate district office prior to spudding of well;
- 2. A copy of the approved notice of intent to drill shall be posted on each drilling rig;
- 3. The minimum amount of surface pipe as specified below shall be set by circulating cement to the top; in all cases surface pipe shall be set through all unconsolidated materials plus a minimum of 20 feet into the underlying formation;
- 4. If the well is dry hole, an agreement between the operator and the district office on plug length and placement is necessary prior to plugging;
- 5. The appropriate district office will be notified before well is either plugged or production casing is cemented in;
- 6. IF AN ALTERNATE II COMPLETION, PRODUCTION PIPE SHALL BE CEMENTED FROM BELOW ANY USABLE WATER TO SURFACE WITHIN 120 DAYS OF SPUD DATE. IN ALL CASES, NOTIFY DISTRICT OFFICE PRIOR TO ANY CEMENTING.

I hereby certify that the statements made herein are true and to the best of my knowledge and belief.

Date: November 19, 1992 Signature of Operator or Agent: *Marie O'Keefe* Title: Sr. Engineering Technician

FOR KCC USE:
API # 15- 071-20575-0000
Conductor pipe required None feet
Minimum surface pipe required 200' feet per Alt. X(2)
Approved by: *C.B. 10-30-92*
This authorization expires: 4-30-93
(This authorization void if drilling not started within 6 months of effective date.)
Spud date: Agent:

11/30/92

NOV 23 1992
11-23-92

REMEMBER TO:

- File Drill Pit Application (form CDP-1) with Intent to Drill;
- File Completion Form ACO-1 within 120 days of spud date;
- File acreage attribution plat according to field proration orders;
- Notify appropriate district office 48 hours prior to workover or re-entry;
- Submit plugging report (CP-4) after plugging is completed;
- Obtain written approval before disposing or injecting salt water.

Mail to: Conservation Division, 200 Colorado Derby Building, 202 W. First St., Wichita, Kansas 67202-1286.

IN ALL CASES PLOT THE INTENDED WELL ON THE PLAT BELOW

PLAT OF ACREAGE ATTRIBUTABLE TO A WELL IN A PRORATED OR SPACED FIELD

If the intended well is in a prorated or spaced field, please fully complete this side of the form. If the intended well is in a prorated or spaced field complete the plat below showing that the well will be properly located in relationship to other wells producing from the common source of supply. Please show all the wells within 1 mile of the boundaries of the proposed acreage attribution unit for gas wells and within 1/2 mile of the boundaries of the proposed acreage attribution unit for oil wells.

API NO. 15- _____
 OPERATOR Duncan Energy Company
 LEASE Huddleston
 WELL NUMBER 33-11
 FIELD Moore Johnson

LOCATION OF WELL: COUNTY Greeley
2042 feet from south ~~1000~~ line of section
2066 feet from east ~~1000~~ line of section
 SECTION 11 TWP 18S RG 43W

NUMBER OF ACRES ATTRIBUTABLE TO WELL 80
 QTR/QTR/QTR OF ACREAGE NW - NW - SE

IS SECTION _____ REGULAR or X IRREGULAR
IF SECTION IS IRREGULAR, LOCATE WELL FROM NEAREST CORNER BOUNDARY.

Section corner used: _____ NE _____ NW X SE _____ SW
PLAT

(Show location of the well and shade attributable acreage for prorated or spaced wells.)
 (Show footage to the nearest lease or unit boundary line.)

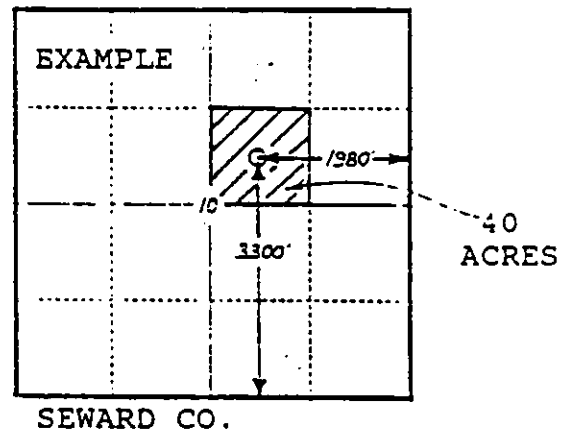
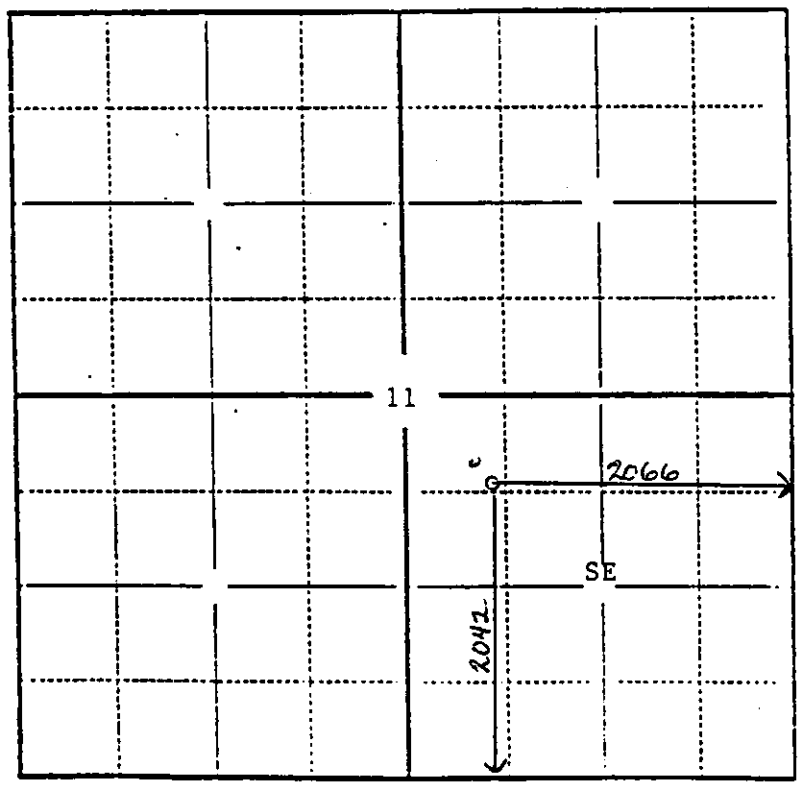

In plotting the proposed location of the well, you must show:

- 1) The manner in which you are using the depicted plat by identifying section lines, i.e. 1 section, 1 section with 8 surrounding sections, 4 sections, etc.;
- 2) the distance of the proposed drilling location from the section's south/north and east/west lines; and
- 3) the distance to the nearest lease or unit boundary line.

EFFECTIVE DATE: 9-16-92

FORM MUST BE TYPED

DISTRICT # 1

State of Kansas
NOTICE OF INTENTION TO DRILL

FORM MUST BE SIGNED

19A7... Yes No

Must be approved by the K.C.C. five (5) days prior to commencing well

ALL BLANKS MUST BE FILLED

Expected Spud Date September 14 1992
month day year

^{Spot} NW NW SE Sec 11 Twp 18S 3, Rg 43 X East West

OPERATOR: License # 30819
Name: Duncan Energy Company
Address: 1777 S. Harrison St.
City/State/Zip: Denver, CO 80210
Contact Person: John Bettridge
Phone: (303)759-3303

~~2100~~ 2080 feet from South ~~XXXXX~~ line of Section
~~2100~~ 2080 feet from East / ~~XXXXX~~ line of Section

IS SECTION _____ REGULAR X IRREGULAR?
(NOTE: Locate well on the Section Plat on Reverse Side)

CONTRACTOR: License #: advise prior to spud date
Name: _____

County: Greeley

Lease Name: Huddleston Well #: 33-11

Field Name: Moore-Johnson

Is this a Prorated/Spaced Field? X Yes ... no

Target Formation(s): Moore-Johnson

Nearest lease or unit boundary: 520' FWL

Ground Surface Elevation: 3909 feet MSL

Water well within one-quarter mile: ... yes X.. no

Public water supply well within one mile: ... yes X.. no

Depth to bottom of fresh water: 110'

Depth to bottom of usable water: 1700'

Surface Pipe by Alternate: ... 1 X 2

Length of Surface Pipe Planned to be set: 200'

Length of Conductor pipe required: None

Projected Total Depth: 5300'

Formation at Total Depth: Lower Morrow

Water Source for Drilling Operations:

... well X farm pond ... other

DWR Permit #: _____

Will Cores Be Taken?: ... yes X.. no

If yes, proposed zone: _____

Well Drilled For:	Well Class:	Type Equipment:
<u>X</u> Oil ... Enh Rec	<u>X</u> Infield	<u>X</u> Mud Rotary
... Gas ... Storage	<u>X</u> Pool Ext.	... Air Rotary
... OWD	... Disposal	... Wildcat
... Seismic; ... # of Holes	... Other	... Cable
... Other		

If OWD: old well information as follows:
Operator: _____
Well Name: _____
Comp. Date: _____ Old Total Depth _____

Directional, Deviated or Horizontal wellbore? ... yes X no
If yes, true vertical depth: _____
Bottom Hole location: _____

AFFIDAVIT

The undersigned hereby affirms that the drilling, completion and eventual plugging of this well will comply with K.S.A. 55-101, et. seq.

It is agreed that the following minimum requirements will be met:

1. Notify the appropriate district office prior to spudding of well;
2. A copy of the approved notice of intent to drill shall be posted on each drilling rig;
3. The minimum amount of surface pipe as specified below shall be set by circulating cement to the top; in all cases surface pipe shall be set through all unconsolidated materials plus a minimum of 20 feet into the underlying formation;
4. If the well is dry hole, an agreement between the operator and the district office on plug length and placement is necessary prior to plugging;
5. The appropriate district office will be notified before well is either plugged or production casing is cemented in;
6. IF AN ALTERNATE IS COMPLETION, PRODUCTION PIPE SHALL BE CEMENTED FROM BELOW ANY USABLE WATER TO SURFACE WITHIN 120 DAYS OF SPUD DATE. IN ALL CASES, NOTIFY DISTRICT OFFICE PRIOR TO ANY CEMENTING.

I hereby certify that the statements made herein are true and to the best of my knowledge and belief.

Date: September 9, 1992 Signature of Operator or Agent: Marie O'Keefe Title: Sr. Engineering Technic

FOR KCC USE:
API # 15- 071-205765-0000
Conductor pipe required None feet
Minimum surface pipe required 200' feet per Alt. X
Approved by: C.B. 9-11-92
This authorization expires: 3-11-92
(This authorization void if drilling not started within 6 months of effective date.)
Spud date: _____ Agent: _____

REMEMBER TO:

- File Drill Pit Application (form CDP-1) with Intent to Drill;
- File Completion Form ACO-1 within 120 days of spud date;
- File acreage attribution plat according to field proration orders;
- Notify appropriate district office 48 hours prior to workover or re-entry;
- Submit plugging report (CP-4) after plugging is completed;
- Obtain written approval before disposing or injecting salt water.

Mail to: Conservation Division, 200 Colorado Derby Building, 202 W. First St., Wichita, Kansas 67202-1256.

RECEIVED
 KANSAS CORPORATION COMMISSION
 SEP 10 1992
 9-11-92
 CONSERVATION DIVISION
 WICHITA, KS
 11 18 43