

FOR KCC USE:

FORM C-1 7/91

EFFECTIVE DATE: 12-31-91

FORM MUST BE TYPED

DISTRICT #

State of Kansas
NOTICE OF INTENTION TO DRILL

FORM MUST BE SIGNED

SCA? Yes No

Must be approved by the K.C.C. five (5) days prior to commencing well

ALL BLANKS MUST BE FILLED

Expected Spud Date January 7, 1991
month day year

Spot NE SE Sec 22 Twp 20 S, Rg 23 East West

OPERATOR: License # 04253
Name: Plains Petroleum Operating Company
Address: P.O. Box 281306
City/State/Zip: Lakewood, CO 80228
Contact Person: Paul R. Brandt
Phone: (303) 969-9325

2300 feet from South ~~North~~ line of Section
720 feet from East ~~West~~ line of Section
IS SECTION REGULAR IRREGULAR?

(NOTE: Locate well on the Section Plat on Reverse Side)
County: Ness
Lease Name: Ralph Reinert Well #: 1
Field Name: Wildcat

CONTRACTOR: License #: *VNNDWA AT THIS TIME*
Name:

Is this a Prorated/Spaced Field? yes no
Target Formation(s): Mississippian Osage
Nearest lease or unit boundary: 340'

Well Drilled For: Well Class: Type Equipment:
 Oil ... Enh Rec ... Infield Mud Rotary
... Gas ... Storage ... Pool Ext. ... Air Rotary
... GWFO ... Disposal Wildcat ... Cable
... Seismic; ... # of Holes ... Other

Ground Surface Elevation: + 2255' feet MSL
Water well within one-quarter mile: yes no
Public water supply well within one mile: yes no

If GWFO: old well information as follows:
Operator:
Well Name:
Comp. Date: Old Total Depth

Depth to bottom of fresh water: 250'
Depth to bottom of usable water: 700'
Surface Pipe by Alternate: 1 2

Directional, Deviated or Horizontal wellbore? yes no
If yes, true vertical depth:
Bottom Hole Location: 720' FEL & 2300' FSL Sec. 22

Length of Surface Pipe Planned to be set: 200'
Length of Conductor pipe required:
Projected Total Depth: 4500'
Formation at Total Depth: Mississippian

Water Source for Drilling Operations:
... well ... farm pond other
DWR Permit #:
Will Cores Be Taken?: yes no

AFFIDAVIT

The undersigned hereby affirms that the drilling, completion and eventual plugging of this well will comply with K.S.A. 55-101, et. seq.
It is agreed that the following minimum requirements will be met:

- 1. Notify the appropriate district office prior to spudding of well;
- 2. A copy of the approved notice of intent to drill shall be posted on each drilling rig;
- 3. The minimum amount of surface pipe as specified below shall be set by circulating cement to the top; in all cases surface pipe shall be set through all unconsolidated materials plus a minimum of 20 feet into the underlying formation;
- 4. If the well is dry hole, an agreement between the operator and the district office on plug length and placement is necessary prior to plugging;
- 5. The appropriate district office will be notified before well is either plugged or production casing is cemented in;
- 6. IF AN ALTERNATE II COMPLETION, PRODUCTION PIPE SHALL BE CEMENTED FROM BELOW ANY USABLE WATER TO SURFACE WITHIN 120 DAYS OF SPUD DATE. IN ALL CASES, NOTIFY DISTRICT OFFICE PRIOR TO ANY CEMENTING.

I hereby certify that the statements made herein are true and to the best of my knowledge and belief.
Date: 12-20-91 Signature of Operator *Paul R. Brandt* Title: District Engineer

FOR KCC USE:
API # 15- 135-23,644-0000
Conductor pipe required None feet
Minimum surface pipe required 200 feet per Alt. 4 (2)
Approved by: mw 12-26-91
This authorization expires: 6-28-92
(This authorization void if drilling not started within 6 months of effective date.)
Spud date: _____ Agent: _____

REMEMBER TO:

- File Drill Pit Application (form CDP-1) with Intent to Drill;
- File Completion Form ACD-1 within 120 days of spud date;
- File acreage attribution plat according to field proration orders;
- Notify appropriate district office 48 hours prior to workover or re-entry;
- Submit plugging report (CP-4) after plugging is completed;
- Obtain written approval before disposing or injecting salt water.

Mail to: Conservation Division, 200 Colorado Derby Building, 202 W. First St., Wichita, Kansas 67202-1286.

DEC 26 1991

22
20
23W

IN ALL CASES PLOT THE INTENDED WELL ON THE PLAT BELOW

PLAT OF ACREAGE ATTRIBUTABLE TO A WELL IN A PRORATED OR SPACED FIELD

If the intended well is in a prorated or spaced field, please fully complete this side of the form. If the intended well is in a prorated or spaced field complete the plat below showing that the well will be properly located in relationship to other wells producing from the common source of supply. Please show all the wells within 1 mile of the boundaries of the proposed acreage attribution unit for gas wells and within 1/2 mile of the boundaries of the proposed acreage attribution unit for oil wells.

API NO. 15- _____
OPERATOR Plains Petroleum Operating Co.
LEASE Ralph Reinert
WELL NUMBER 1
FIELD Wildcat

LOCATION OF WELL: COUNTY Ness
2300 feet from south/north line of section
720 feet from east/west line of section
SECTION 22 TWP 20S RG 23W

NUMBER OF ACRES ATTRIBUTABLE TO WELL _____
QTR/QTR/QTR OF ACREAGE NW - NE - SE

IS SECTION X REGULAR or _____ IRREGULAR
IF SECTION IS IRREGULAR, LOCATE WELL FROM NEAREST CORNER BOUNDARY.

Section corner used: _____ NE _____ NW _____ SE _____ SW

PLAT

(Show location of the well and shade attributable acreage for prorated or spaced wells.)
(Show footage to the nearest lease or unit boundary line.)

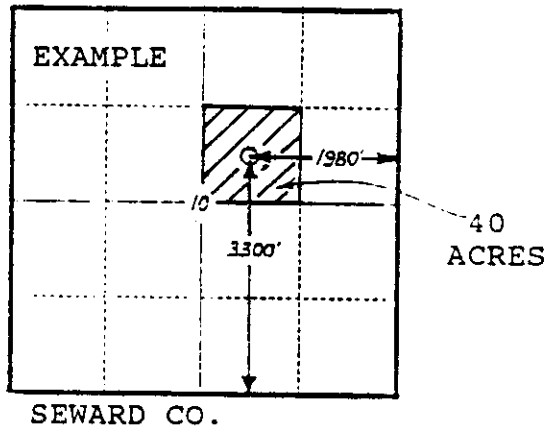
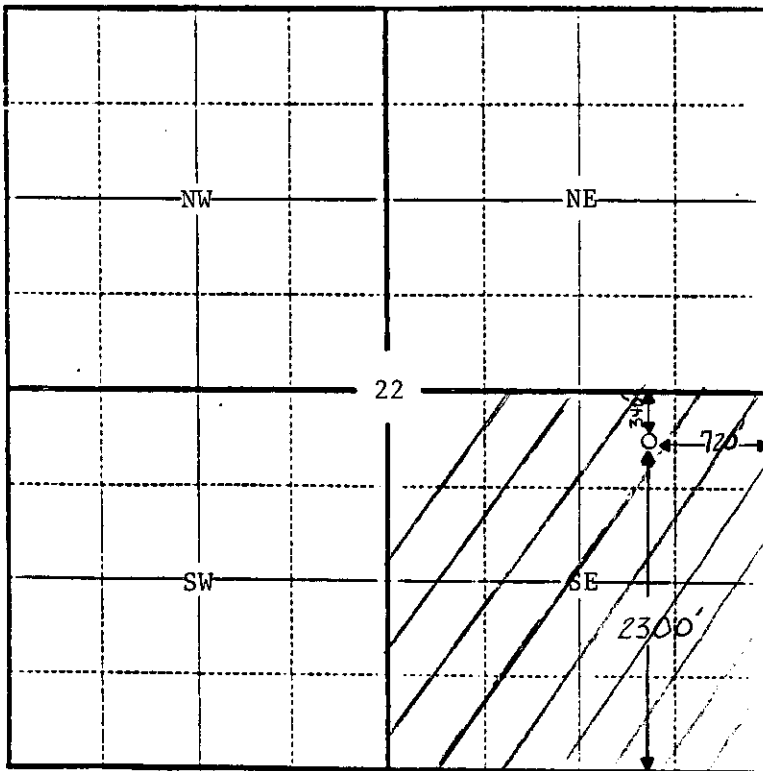

DEC 26 1991

In plotting the proposed location of the well, you must show:

- 1) The manner in which you are using the depicted plat by identifying section lines, i.e. 1 section, 1 section with 8 surrounding sections, 4 sections, etc.;
- 2) the distance of the proposed drilling location from the section's south/north and east/west lines; and
- 3) the distance to the nearest lease or unit boundary line.