

FOR KCC USE:

FORM C-1 7/91

FORM MUST BE TYPED

FORM MUST BE SIGNED

ALL BLANKS MUST BE FILLED

EFFECTIVE DATE: 8-5-97

State of Kansas

DISTRICT #

NOTICE OF INTENTION TO DRILL

SGA? Yes No

Must be approved by the K.C.C. five (5) days prior to commencing well.

Expected Spud Date July 1 1997

Spot 135' N & 115' E OF NE NE SE Sec 13 Twp 20 S, Rg 23 West

OPERATOR: License # 31961 Buried Hills Production Company, Inc. 1000, 112 - 4th Avenue S.W. Calgary, Alberta Canada T2P 0H3 David J. Lapinskie (403) 750-1213

2445 feet from South North line of Section 215 feet from East West line of Section IS SECTION REGULAR X IRREGULAR?

CONTRACTOR: License # 32105 Nabors

(NOTE: Locate well on the Section Plat on Reverse Side) County: Ness Lease Name: Whitley Well #: 2 HZ Field Name: Riverside Is this a Prorated/Spaced Field? yes X no Target Formation(s): Mississippian Nearest lease or unit boundary: 350 Ground Surface Elevation: 2221 feet MSL Water well within one-quarter mile: yes X no Public water supply well within one mile: yes X no Depth to bottom of fresh water: 180 Depth to bottom of usable water: 620 Surface Pipe by Alternate: X 1 2 Length of Surface Pipe Planned to be set: 640 Length of Conductor pipe required: None Projected Total Depth: TVD 4344, MD 6606 Formation at Total Depth: Mississippian Water Source for Drilling Operations: X well farm pond other

Well Drilled For: Well Class: Type Equipment: X Oil Enh Rec Infield X Mud Rotary Gas Storage X Pool Ext. Air Rotary CWOW Disposal Wildcat Cable Seismic; # of Holes Other If CWOW: old well information as follows: Operator: Well Name: Comp. Date: Old Total Depth

Directional, Deviated or Horizontal wellbore? X yes no If yes, true vertical depth: TVD 4344 Bottom Hole Location: 2285' FSL 2280' FWL of Section 18-T20S-R22W

Will Cores Be Taken? yes X no If yes, proposed zone:

DOCKET NO. 194,853-C (C-28,102)

AFFIDAVIT

The undersigned hereby affirms that the drilling, completion and eventual plugging of this well will comply with K.S.A. 55-101, et. seq. It is agreed that the following minimum requirements will be met:

- 1. Notify the appropriate district office prior to spudding of well;
2. A copy of the approved notice of intent to drill shall be posted on each drilling rig;
3. The minimum amount of surface pipe as specified below shall be set by circulating cement to the top; in all cases surface pipe shall be set through all unconsolidated materials plus a minimum of 20 feet into the underlying formation;
4. If the well is dry hole, an agreement between the operator and the district office on plug length and placement is necessary prior to plugging;
5. The appropriate district office will be notified before well is either plugged or production casing is cemented in;
6. IF AN ALTERNATE II COMPLETION, PRODUCTION PIPE SHALL BE CEMENTED FROM BELOW ANY USABLE WATER TO SURFACE WITHIN 120 DAYS OF SPUD DATE. IN ALL CASES, NOTIFY DISTRICT OFFICE PRIOR TO ANY CEMENTING.

I hereby certify that the statements made herein are true and to the best of my knowledge and belief.

Date: 6/26/97 Signature of Operator or Agent: Jeff Kennedy Title: Agent

FOR KCC USE: API # 15- 135-240210100 Conductor pipe required NONE feet Minimum surface pipe required 640 feet per Alt. 1 X Approved by: JK 7-31-97 This authorization expires: 1-31-98 (This authorization void if drilling not started within 6 months of effective date.) Spud date: Agent:

RECEIVED KANSAS CORPORATION COMMISSION JUN 26 1997 CONSERVATION DIVISION WICHITA, KS

- REMEMBER TO: - File Drill Pit Application (form CDP-1) with Intent to Drill; - File Completion Form ACO-1 within 120 days of spud date; - File acreage attribution plat according to field production orders; - Notify appropriate district office 48 hours prior to workover or re-entry; - Submit plugging report (CP-4) after plugging is completed; - Obtain written approval before disposing or injecting salt water.

Mail to: KCC - Conservation Division, 130 S. Market - Room 2078, Wichita, Kansas 67202.

IN ALL CASES PLOT THE INTENDED WELL ON THE PLAT BELOW

PLAT OF ACREAGE ATTRIBUTABLE TO A WELL IN A PRORATED OR SPACED FIELD

If the intended well is in a prorated or spaced field, please fully complete this side of the form. If the intended well is in a prorated or spaced field complete the plat below showing that the well will be properly located in relationship to other wells producing from the common source of supply. Please show all the wells within 1 mile of the boundaries of the proposed acreage attribution unit for gas wells and within 1/2 mile of the boundaries of the proposed acreage attribution unit for oil wells.

API NO. 15- _____
 OPERATOR Buried Hills Production Company Inc. LOCATION OF WELL: COUNTY Ness
 LEASE Whitley 2245 feet from south/north line of section
 WELL NUMBER #2 Hz 215 feet from east/west line of section
 FIELD Riverside SECTION 13 TWP 20S RG 23W

NUMBER OF ACRES ATTRIBUTABLE TO WELL 10 IS SECTION _____ REGULAR or X IRREGULAR
 QTR/QTR/QTR OF ACREAGE N/2 - N/2 - SW **IF SECTION IS IRREGULAR, LOCATE WELL FROM NEAREST**
 of section 18 - T20S - R22W **CORNER BOUNDARY.**

Section corner used: _____ NE _____ NW X SE _____ SW

PLAT

(Show location of the well and shade attributable acreage for prorated or spaced wells.)
 (Show footage to the nearest lease or unit boundary line.)

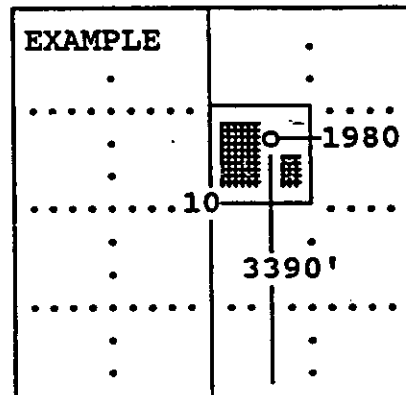
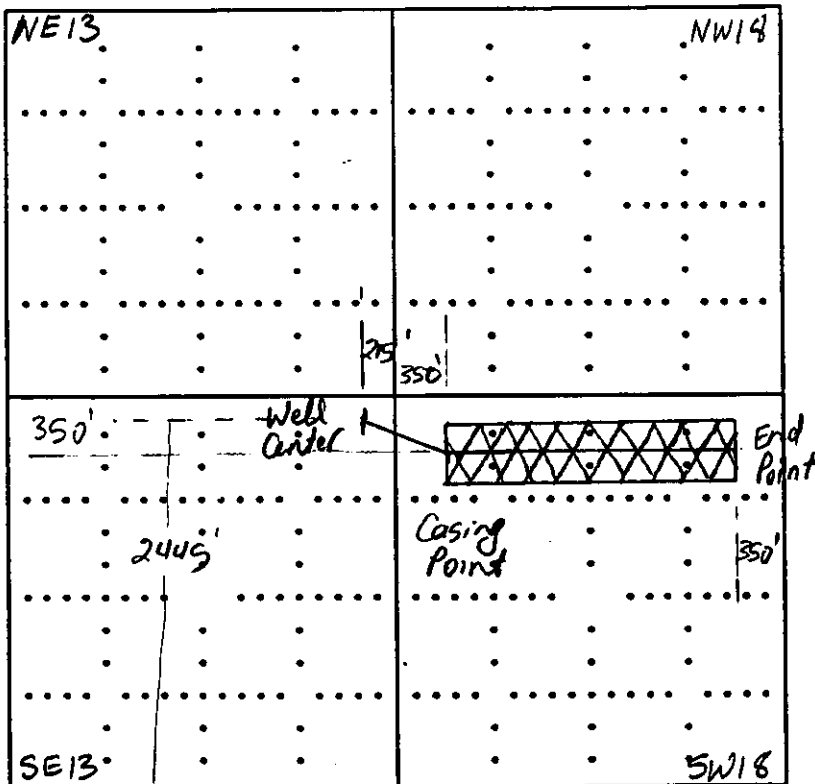

SEWARD CO.

In plotting the proposed location of the well, you must show:

- 1) The manner in which you are using the depicted plat by identifying section lines, i.e. 1 section, 1 section with 8 surrounding sections, 4 sections, etc.;
- 2) the distance of the proposed drilling location from the section's south/north and east/west; and
- 3) the distance to the nearest lease or unit boundary line.