

FOR KCC USE:

1st COR

FORM C-1 7/91
FORM MUST BE TYPED
FORM MUST BE SIGNED
ALL BLANKS MUST BE FILLED

EFFECTIVE DATE: 5-13-97

State of Kansas

DISTRICT # 1
SGA? Yes X No

NOTICE OF INTENTION TO DRILL

Must be approved by the K.C.C. five (5) days prior to commencing well.

Expected Spud Date month day year

* ~~SW~~ ~~NE~~ ~~SE~~ ~~SW~~ Sec 13.. Top 20.. S, Rg 23... East X West

OPERATOR: License # 31961
Name: Buried Hills Production Company, Inc.
Address: 1000, 112 - 4th Avenue S.W.
City/State/Zip: Calgary, Alberta, Canada T2P 0H3
Contact Person: David J. Lapinskie
Phone: (403) 750-1213

2290 feet from South / North line of Section
2250 feet from East / West line of Section
IS SECTION X REGULAR IRREGULAR?

(NOTE: Locate well on the Section Plat on Reverse Side)

* CONTRACTOR: License #: 32105
Name: Nabors

County: Ness

Lease Name: Whitley Well #: 1 Hz

Field Name: Riverside

Is this a Prorated/Spaced Field? yes X no

Target Formation(s): Mississippian

Nearest lease or unit boundary: 330

Ground Surface Elevations: 2271 feet NSL

Water well within one-quarter mile: yes X no

Public water supply well within one mile: yes X no

Depth to bottom of fresh water: 180

Depth to bottom of usable water: 780

Surface Pipe by Alternate: X 1 2

Length of Surface Pipe Planned to be set: 720

Length of Conductor pipe required: None

Projected Total Depth: 4316 TVD

Formation at Total Depth: Mississippian

Water Source for Drilling Operations: X well farm pond other

Will Cores Be Taken?: yes X no

If yes, proposed zone:

IS: Ap. SW-NE-NE-SW ; G.L. ELEV. 2271

Well Drilled For:	Well Class:	Type Equipment:
X.. Oil	... Enh Rec	... Infield X.. Mud Rotary
... Gas	... Storage	X.. Pool Ext. ... Air Rotary
... OAWO	... Disposal	... Wildcat ... Cable
... Seismic;	... # of Holes	... Other
... Other		

Directional, Deviated or Horizontal wellbore? X.. yes ... no
If yes, true vertical depth: 4303
Bottom Hole Location: 2290 FSL, 330 FFL
DKT #194,825-C (C-28,074)

WAS: SW-NE-SW ; CONT: UNKNOWN ; ELEV. G.L 2211

AFFIDAVIT

The undersigned hereby affirms that the drilling, completion and eventual plugging of this well will comply with K.S.A. 55-101, et. seq.

It is agreed that the following minimum requirements will be met:

1. Notify the appropriate district office prior to spudding of well;
2. A copy of the approved notice of intent to drill shall be posted on each drilling rig;
3. The minimum amount of surface pipe as specified below shall be set by circulating cement to the top; in all cases surface pipe shall be set through all unconsolidated materials plus a minimum of 20 feet into the underlying formation;
4. If the well is dry hole, an agreement between the operator and the district office on plug length and placement is necessary prior to plugging;
5. The appropriate district office will be notified before well is either plugged or production casing is cemented in;
6. IF AN ALTERNATE II COMPLETION, PRODUCTION PIPE SHALL BE CEMENTED FROM BELOW ANY USABLE WATER TO SURFACE WITHIN 120 DAYS OF SPUD DATE. IN ALL CASES, NOTIFY DISTRICT OFFICE PRIOR TO ANY CEMENTING.

I hereby certify that the statements made herein are true and to the best of my knowledge and belief.

Date: 6/2/97 Signature of Operator or Agent: Jeff Kennedy Title: Agent

FOR KCC USE:
API # 15- 135-24003-01-00
Conductor pipe required None feet
Minimum surface pipe required 720 feet per Alt. (1) X
Approved by: DPW 6-4-97 / ORIG DPW 5-8-97
This authorization expires: 11-8-97
(This authorization void if drilling not started within 6 months of effective date.)
Spud date: Agent:

- REMEMBER TO:
- File Drill Pit Application (form CDP-1) with Intent to Drill;
 - File Completion Form ACO-1 within 120 days of spud date;
 - File acreage attribution plat according to field proration orders;
 - Notify appropriate district office 48 hours prior to workover or re-entry;
 - Submit plugging report (CP-4) after plugging is completed;
 - Obtain written approval before disposing or injecting salt water.

Mail to: KCC - Conservation Division, 130 S. Market - Room 2078, Wichita, Kansas 67202.

RECEIVED
KANSAS CORPORATION COMMISSION

JUN 03 1997

13
20
23 W

IN ALL CASES PLOT THE INTENDED WELL ON THE PLAT BELOW

PLAT OF ACREAGE ATTRIBUTABLE TO A WELL IN A PRORATED OR SPACED FIELD

If the intended well is in a prorated or spaced field, please fully complete this side of the form. If the intended well is in a prorated or spaced field complete the plat below showing that the well will be properly located in relationship to other wells producing from the common source of supply. Please show all the wells within 1 mile of the boundaries of the proposed acreage attribution unit for gas wells and within 1/2 mile of the boundaries of the proposed acreage attribution unit for oil wells.

API NO. 15-135-24003-01-00
 OPERATOR Buried Hills Production Company Inc. LOCATION OF WELL: COUNTY Ness
 LEASE Whitley _____ feet from south/north line of section
 WELL NUMBER #1 Hz _____ feet from east/west line of section
 FIELD Riverside SECTION 13 TWP 20S RG 23W

NUMBER OF ACRES ATTRIBUTABLE TO WELL 10 IS SECTION X REGULAR or _____ IRREGULAR
 QTR/QTR/QTR OF ACREAGE C - N/2 - SE IF SECTION IS IRREGULAR, LOCATE WELL FROM NEAREST
 of Sec 13, Twp 20S, Rge 23W CORNER BOUNDARY.

Section corner used: _____ NE _____ NW _____ SE _____ SW

PLAT

(Show location of the well and shade attributable acreage for prorated or spaced wells.)
 (Show footage to the nearest lease or unit boundary line.)

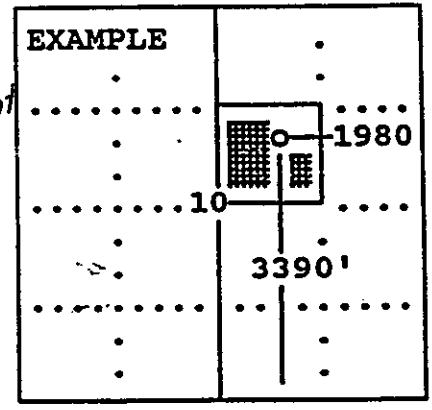
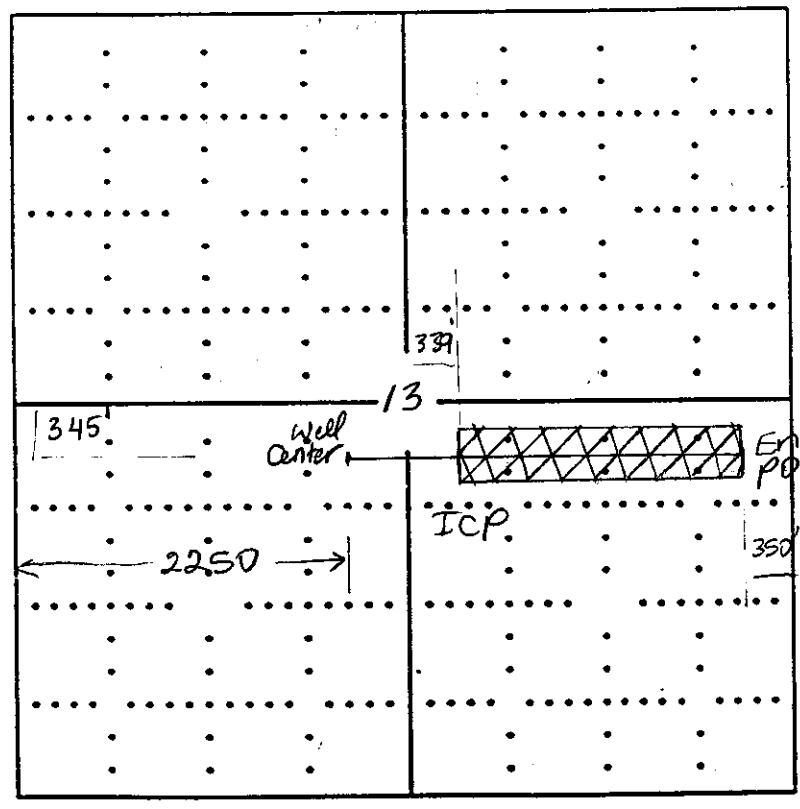

SEWARD CO.

In plotting the proposed location of the well, you must show:

- 1) The manner in which you are using the depicted plat by identifying section lines, i.e. 1 section, 1 section with 8 surrounding sections, 4 sections, etc.;
- 2) the distance of the proposed drilling location from the section's south/north and east/west; and
- 3) the distance to the nearest lease or unit boundary line.