

FOR KCC USE:

FORM C-1 7/91

EFFECTIVE DATE: 1-10-99

FORM MUST BE TYPED

DISTRICT # 1

State of Kansas

FORM MUST BE SIGNED

SSAT... Yes... No

NOTICE OF INTENTION TO DRILL

ALL BLANKS MUST BE FILLED

Must be approved by the K.C.C. five (5) days prior to commencing well

Expected Spud Date 1 25 99 month day year

Spot SW NW Sec 14 Twp 20 S, Rg 40 East West

OPERATOR: License # 7271 Name: Bartling Oil Co. Address: 5910 Courtyard Dr Suite 255 City/State/Zip: Austin, Tx 78731 Contact Person: Tab Bartling Phone: 512-795-9597

1980 feet from South North line of Section 660 feet from East West line of Section IS SECTION X REGULAR IRREGULAR?

CONTRACTOR: License #: ADVISE ON ACO-1 Name: NA

(NOTE: Locate well on the Section Plat on Reverse Side) County: Greeley

Well Drilled For: Well Class: Type Equipment: Oil Enh Rec X Infield X Mud Rotary X Gas Storage Pool Ext Air Rotary OWWO Disposal Wildcat Cable Seismic # of Holes X Other

Lease Name: Spears Well #: 4 Field Name: Bradshaw

If OWWO: old well information as follows: Operator: Well Name: Comp. Date: Old Total Depth

Is this a Prorated/Spaced Field? yes X no Target Formation(s): Upper Winfield

Directional, Deviated or Horizontal wellbore? yes X no If yes, true vertical depth: Bottom Hole Location:

Nearest lease or unit boundary: 660 Ground Surface Elevation: 3573.8 feet MSL

Water well within one-quarter mile: yes X no Public water supply well within one mile: yes X no

Depth to bottom of fresh water: 220 Depth to bottom of usable water: 1200 1400

Surface Pipe by Alternate: 1 X 2 Length of Surface Pipe Planned to be set: 250

Length of Conductor pipe required: None Projected Total Depth: 2950

Formation at Total Depth: Lower Fort Riley Water Source for Drilling Operations: well farm pond X other

DWR Permit #: Will Cores Be Taken? yes X no if yes, proposed zone:

AFFIDAVIT

The undersigned hereby affirms that the drilling, completion and eventual plugging of this well will comply with K.S.A. 55-101, et. seq.

It is agreed that the following minimum requirements will be met:

- 1. Notify the appropriate district office prior to spudding of well;
2. A copy of the approved notice of intent to drill shall be posted on each drilling rig;
3. The minimum amount of surface pipe as specified below shall be set by circulating cement to the top; in all cases surface pipe shall be set through all unconsolidated materials plus a minimum of 20 feet into the underlying formation;
4. If the well is dry hole, an agreement between the operator and the district office on plug length and placement is necessary prior to plugging;
5. The appropriate district office will be notified before well is either plugged or production casing is cemented in;
6. IF AN ALTERNATE II COMPLETION, PRODUCTION PIPE SHALL BE CEMENTED FROM BELOW ANY USABLE WATER TO SURFACE WITHIN 120 DAYS OF SPUD DATE. IN ALL CASES, NOTIFY DISTRICT OFFICE PRIOR TO ANY CEMENTING.

I hereby certify that the statements made herein are true and to the best of my knowledge and belief.

Date: 12-31-98 Signature of Operator or Agent: Terry Maxwell Title: Consultant

FOR KCC USE: API # 15- 071-207020000 Conductor pipe required NONE feet Minimum surface pipe required 240 feet per Alt. X(2) Approved by: JK 1-5-99 This authorization expires: 7-5-99 (This authorization void if drilling not started within 6 months of effective date.) Spud date: Agent:

REMEMBER TO:

- File Drill Pit Application (form CDP-1) with Intent to Drill;
- File Completion Form ACO-1 within 120 days of spud date;
- File acreage attribution plat according to field proration orders;
- Notify appropriate district office 48 hours prior to workover or re-entry;
- Submit plugging report (CP-4) after plugging is completed;
- Obtain written approval before disposing or injecting salt water.

Mail to: Conservation Division, 200 Colorado Derby Building, 202 W. First St., Wichita, Kansas 67202-1286.

RECEIVED STATE OF KANSAS CONSERVATION DIVISION WICHITA, KANSAS JAN - 5 1999 1-5-99

14 20 400

IN ALL CASES PLOT THE INTENDED WELL ON THE PLAT BELOW.

PLAT OF ACREAGE ATTRIBUTABLE TO A WELL IN A PRORATED OR SPACED FIELD

If the intended well is in a prorated or spaced field, please fully complete this side of the form. If the intended well is in a prorated or spaced field complete the plat below showing that the well will be properly located in relationship to other wells producing from the common source of supply. Please show all the wells within 1 mile of the boundaries of the proposed acreage attribution unit for gas wells and within 1/2 mile of the boundaries of the proposed acreage attribution unit for oil wells.

API NO. 15-071-
 OPERATOR Bartling Oil Co.
 LEASE Spears
 WELL NUMBER 4
 FIELD Bradshaw

LOCATION OF WELL: COUNTY Greeley
1980 feet from south(~~north~~) line of section
660 feet from east(~~west~~) line of section
 SECTION 14 TWP 20S RG 40W

NUMBER OF ACRES ATTRIBUTABLE TO WELL 640
 QTR/QTR/QTR OF ACREAGE _____

IS SECTION X REGULAR or _____ IRREGULAR
IF SECTION IS IRREGULAR, LOCATE WELL FROM NEAREST CORNER BOUNDARY.

Section corner used: _____ NE X _____ NW _____ SE _____ SW
PLAT

(Show location of the well and shade attributable acreage for prorated or spaced wells.)
 (Show footage to the nearest lease or unit boundary line.)

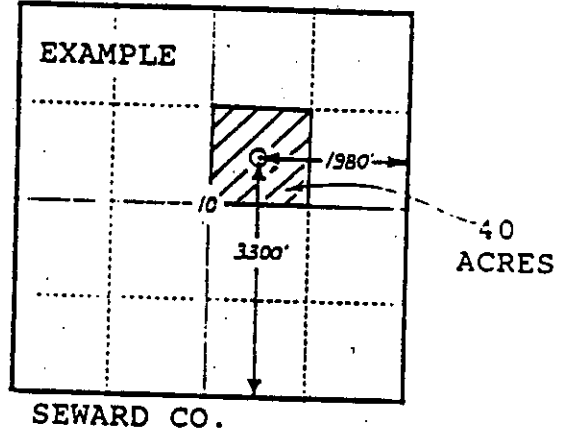
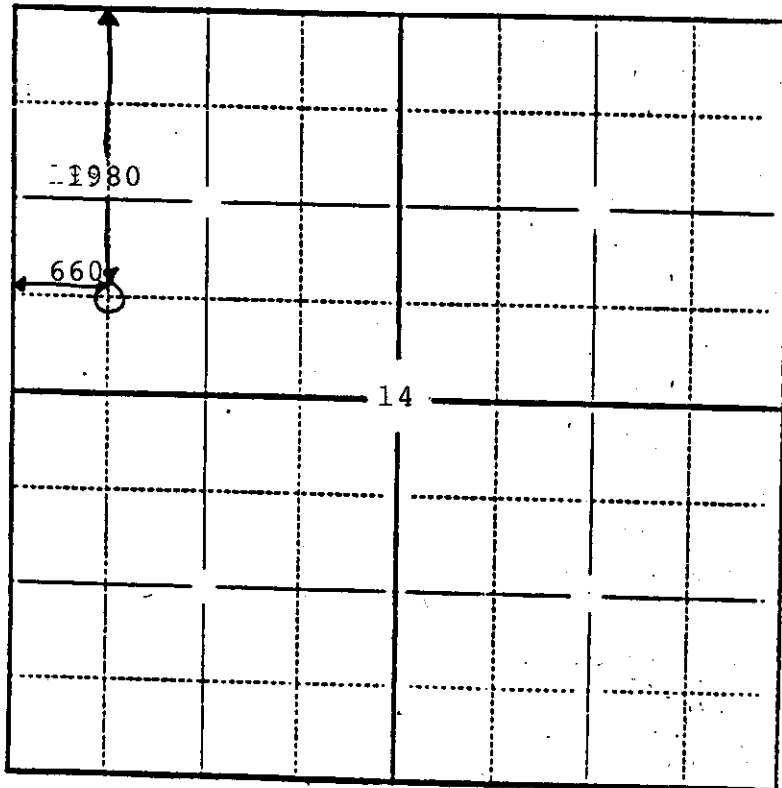

In plotting the proposed location of the well, you must show:

- 1) The manner in which you are using the depicted plat by identifying section lines, i.e. 1 section, 1 section with 8 surrounding sections, 4 sections, etc.;
- 2) the distance of the proposed drilling location from the section's south/north and east/west lines; and
- 3) the distance to the nearest lease or unit boundary line.