

EFFECTIVE DATE: 6-27-98

State of Kansas

DISTRICT # 1

NOTICE OF INTENTION TO DRILL

SGA? Yes  No

Must be approved by the K.C.C. five (5) days prior to commencing well.

Expected Spud Date June 23rd 1998  
month day year

Spot 6-22-98 NW SE Sec 6 Twp 18 S, Rg 31 East  
1980 feet from South / ~~West~~ line of Section  
1980 feet from East / ~~West~~ line of Section

OPERATOR: License # 31251  
Name: WABASH ENERGY CORPORATION  
Address: P.O. Box 595  
City/State/Zip: Lawrenceville, IL 62439  
Contact Person: E. L. Whitmer  
Phone: (618) 945-3365

IS SECTION X REGULAR IRREGULAR?

(NOTE: Locate well on the Section Plat on Reverse Side)

County: Scott

Lease Name: Berning Well #: 1

Field Name: Beckley Ext.

Is this a Prorated/Spaced Field? yes  no

Target Formation(s): Lansing KC

Nearest lease or unit boundary: 660'

Ground Surface Elevation: 2961 feet MSL

Water well within one-quarter mile: yes  no

Public water supply well within one mile: yes  no

Depth to bottom of fresh water: 180'

Depth to bottom of usable water: 1680' / 1480'

Surface Pipe by Alternate: 1  2

Length of Surface Pipe Planned to be set: 200'

Length of Conductor pipe required: None

Projected Total Depth: 4650'

Formation at Total Depth: Mississippian

Water Source for Drilling Operations:

well  farm pond  other

Apply to DPW for Permit.

Will Cores Be Taken? yes  no

If yes, proposed zone: .....

Well Drilled For: Well Class: Type Equipment:  
 Oil ... Enh Rec  Infield  Mud Rotary  
... Gas ... Storage ... Pool Ext. ... Air Rotary  
... OWWO ... Disposal ... Wildcat ... Cable  
... Seismic; ... # of Holes ... Other

If OWWO: old well information as follows:  
Operator: .....  
Well Name: .....  
Comp. Date: ..... Old Total Depth .....

Directional, Deviated or Horizontal wellbore? yes  no

If yes, true vertical depth: .....

Bottom Hole Location: .....

AFFIDAVIT

The undersigned hereby affirms that the drilling, completion and eventual plugging of this well will comply with K.S.A. 55-101, et. seq.

It is agreed that the following minimum requirements will be met:

1. Notify the appropriate district office prior to spudding of well;
2. A copy of the approved notice of intent to drill shall be posted on each drilling rig;
3. The minimum amount of surface pipe as specified below shall be set by circulating cement to the top; in all cases surface pipe shall be set through all unconsolidated materials plus a minimum of 20 feet into the underlying formation;
4. If the well is dry hole, an agreement between the operator and the district office on plug length and placement is necessary prior to plugging;
5. The appropriate district office will be notified before well is either plugged or production casing is cemented in;
6. IF AN ALTERNATE II COMPLETION, PRODUCTION PIPE SHALL BE CEMENTED FROM BELOW ANY USABLE WATER TO SURFACE WITHIN 120 DAYS OF SPUD DATE. IN ALL CASES, NOTIFY DISTRICT OFFICE PRIOR TO ANY CEMENTING.

I hereby certify that the statements made herein are true and to the best of my knowledge and belief.

Date: June 19, 1998 Signature of Operator or Agent: Thomas J. [Signature] Title: Agent

FOR KCC USE:  
 API # 15- 171-20532-0000  
 Conductor pipe required NONE feet  
 Minimum surface pipe required 200 feet per Alt.  (2)  
 Approved by: DPW 6-22-98

---

This authorization expires: 12-22-98  
 (This authorization void if drilling not started within 6 months of effective date.)  
 Spud date: \_\_\_\_\_ Agent: \_\_\_\_\_

REMEMBER TO:

- File Drill Pit Application (form CDP-1) with Intent to Drill;
- File Completion Form ACO-1 within 120 days of spud date;
- File acreage attribution plat according to field proration orders;
- Notify appropriate district office 48 hours prior to workover or re-entry;
- Submit plugging report (CP-4) after plugging is completed;
- Obtain written approval before disposing or injecting salt water.

Mail to: KCC - Conservation Division, 130 S. Market - Room 207B, Wichita, Kansas 67202.

6  
18  
3/13

**IN ALL CASES PLOT THE INTENDED WELL ON THE PLAT BELOW**

**PLAT OF ACREAGE ATTRIBUTABLE TO A WELL IN A PRORATED OR SPACED FIELD**

If the intended well is in a prorated or spaced field, please fully complete this side of the form. If the intended well is in a prorated or spaced field complete the plat below showing that the well will be properly located in relationship to other wells producing from the common source of supply. Please show all the wells within 1 mile of the boundaries of the proposed acreage attribution unit for gas wells and within 1/2 mile of the boundaries of the proposed acreage attribution unit for oil wells.

API NO. 15- \_\_\_\_\_  
 OPERATOR WABASH ENERGY CORPORATION  
 LEASE Berning  
 WELL NUMBER 1  
 FIELD Beckley Ext.

LOCATION OF WELL: COUNTY Scott  
 1980 feet from south ~~XXXX~~ line of section  
 1980 feet from east ~~XXXX~~ line of section  
 SECTION 6 TWP 18s RG 31w

NUMBER OF ACRES ATTRIBUTABLE TO WELL \_\_\_\_\_  
 QTR/QTR/QTR OF ACREAGE \_\_\_\_\_

IS SECTION X REGULAR or \_\_\_\_\_ IRREGULAR  
**IF SECTION IS IRREGULAR, LOCATE WELL FROM NEAREST CORNER BOUNDARY.**

Section corner used: \_\_\_\_\_ NE \_\_\_\_\_ NW \_\_\_\_\_ SE \_\_\_\_\_ SW  
**PLAT**

(Show location of the well and shade attributable acreage for prorated or spaced wells.)  
 (Show footage to the nearest lease or unit boundary line.)

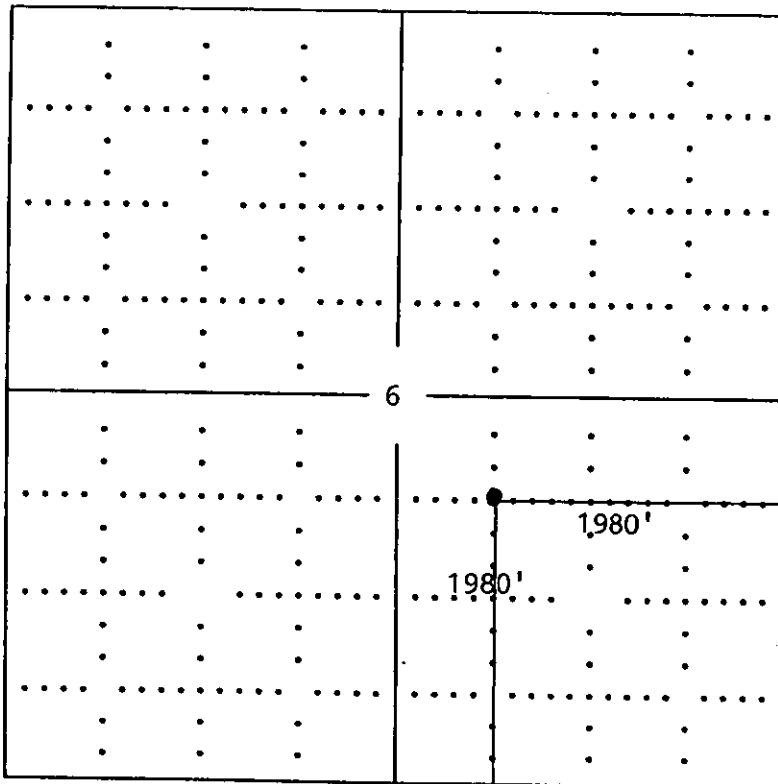

Scott Co.

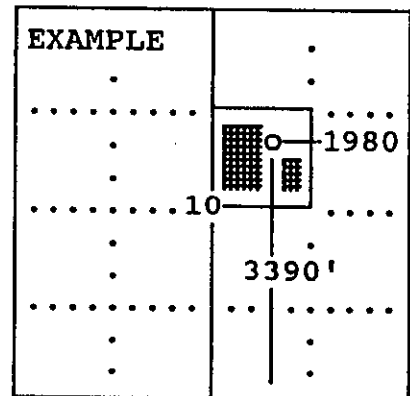

SEWARD CO.

**In plotting the proposed location of the well, you must show:**

- 1) The manner in which you are using the depicted plat by identifying section lines, i.e. 1 section, 1 section with 8 surrounding sections, 4 sections, etc.;
- 2) the distance of the proposed drilling location from the section's south/north and east/west; and
- 3) the distance to the nearest lease or unit boundary line.