

FOR KCC USE:

FORM C-1 7/91

EFFECTIVE DATE: 4-7-93
DISTRICT # 1
SEAT: X Yes... No

State of Kansas
NOTICE OF INTENTION TO DRILL

FORM MUST BE TYPED
FORM MUST BE SIGNED
ALL BLANKS MUST BE FILLED

Must be approved by the K.C.C. five (5) days prior to commencing well

Expected Spud Date 4 5 93 150 Spot
month day year SE of SE SW Sec 15 Twp 18 S. Rg 38 X East West

OPERATOR: License # 5316
Name: Falcon Exploration, Inc.
Address: 155 N. Market, #1010
City/State/Zip: Wichita, KS 67202-1824
Contact Person: Jim Thatcher
Phone: (316) 265-3351

550 feet from South XXXX line of Section
3190 feet from East XXXX line of Section
IS SECTION X REGULAR IRREGULAR?

(NOTE: Locate well on the Section Plat on Reverse Side)

County: Wichita
Lease Name: Oldham Well #: 2
Field Name: Wildcat

Is this a Prorated/Spaced Field? ... yes XX no

CONTRACTOR: License #: 30684
Name: Abercrombie

Target Formation(s): Mississippi

Nearest lease or unit boundary: 330'

Ground Surface Elevation: Est. 3394' feet MSL

Water well within one-quarter mile: ... yes X no

Public water supply well within one mile: ... yes X no

Well Drilled For: Well Class: Type Equipment:
X Oil ... Enh Rec ... Infield X Mud Rotary
... Gas ... Storage ... Pool Ext. ... Air Rotary
... OWD ... Disposal X Wildcat ... Cable
... Seismic; ... # of Holes ... Other
... Other

Depth to bottom of fresh water: 200'

Depth to bottom of usable water: 1480'

Surface Pipe by Alternate: ... 1 X 2

Length of Surface Pipe Planned to be set: (360') 240'

Length of Conductor pipe required: None

Projected Total Depth: 5100'

Formation at Total Depth: Mississippi

Water Source for Drilling Operations:

... well ... farm pond X other

DWR Permit #: _____

Will Cores Be Taken?: ... yes X no

If yes, proposed zone: _____

Directional, Deviated or Horizontal wellbore? ... yes X no

If yes, true vertical depth: _____

Bottom Hole Location: _____

AFFIDAVIT

The undersigned hereby affirms that the drilling, completion and eventual plugging of this well will comply with K.S.A. 55-101, et. seq.

It is agreed that the following minimum requirements will be met:

1. Notify the appropriate district office prior to spudding of well;
2. A copy of the approved notice of intent to drill shall be posted on each drilling rig;
3. The minimum amount of surface pipe as specified below shall be set by circulating cement to the top; in all cases surface pipe shall be set through all unconsolidated materials plus a minimum of 20 feet into the underlying formation;
4. If the well is dry hole, an agreement between the operator and the district office on plug length and placement is necessary prior to plugging;
5. The appropriate district office will be notified before well is either plugged or production casing is cemented in;
6. IF AN ALTERNATE IS COMPLETED, PRODUCTION PIPE SHALL BE CEMENTED FROM BELOW ANY USABLE WATER TO SURFACE WITHIN 120 DAYS OF SPUD DATE. IN ALL CASES, NOTIFY DISTRICT OFFICE PRIOR TO ANY CEMENTING.

I hereby certify that the statements made herein are true and to the best of my knowledge and belief.

Date: 4/2/93 Signature of Operator or Agent: [Signature] Title: _____ Agent

FOR KCC USE:
API # 15- 203-20100-0000
Conductor pipe required stage feet
Minimum surface pipe required 240' feet per Alt. X
Approved by: CB 4-2-93
This authorization expires: 11-2-93
(This authorization void if drilling not started within 6 months of effective date.)
Spud date: _____ Agent: _____

REMEMBER TO:

- File Drill Pit Application (form CDP-1) with Intent to Drill;
- File Completion Form ACO-1 within 120 days of spud date;
- File acreage attribution plat according to field proration orders;
- Notify appropriate district office 48 hours prior to workover or re-entry;
- Submit plugging report (CP-4) after plugging is completed;
- Obtain written approval before disposing or injecting salt water.

Mail to: Conservation Division, 200 Colorado Derby Building, 202 W. First St., Wichita, Kansas 67202-1286.

RECEIVED
KANSAS CORPORATION COMMISSION
APR 02 1993
CONSERVATION DIVISION
WICHITA, KS
15 18 38

IN ALL CASES PLOT THE INTENDED WELL ON THE PLAT BELOW

PLAT OF ACREAGE ATTRIBUTABLE TO A WELL IN A PRORATED OR SPACED FIELD

If the intended well is in a prorated or spaced field, please fully complete this side of the form. If the intended well is in a prorated or spaced field complete the plat below showing that the well will be properly located in relationship to other wells producing from the common source of supply. Please show all the wells within 1 mile of the boundaries of the proposed acreage attribution unit for gas wells and within 1/2 mile of the boundaries of the proposed acreage attribution unit for oil wells.

API NO. 15- _____
OPERATOR Falcon Exploration Inc.
LEASE Oldham
WELL NUMBER 2
FIELD Wildcat

LOCATION OF WELL: COUNTY Wichita
550 feet from south line of section
3190 feet from east line of section
SECTION 15 TWP 18S RG 38W

NUMBER OF ACRES ATTRIBUTABLE TO WELL _____
QTR/QTR/QTR OF ACREAGE _____

IS SECTION _____ REGULAR or _____ IRREGULAR
IF SECTION IS IRREGULAR, LOCATE WELL FROM NEAREST CORNER BOUNDARY.

Section corner used: _____ NE _____ NW _____ SE _____ SW

PLAT

(Show location of the well and shade attributable acreage for prorated or spaced wells.)
(Show footage to the nearest lease or unit boundary line.)

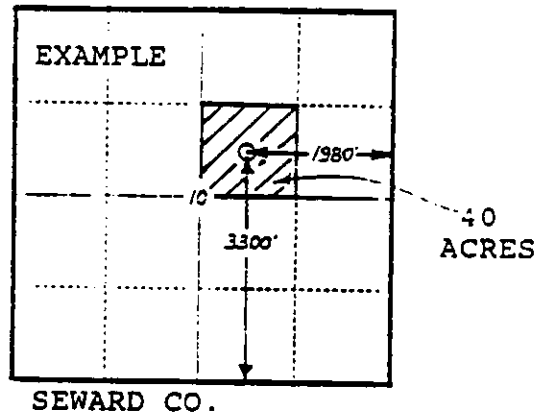
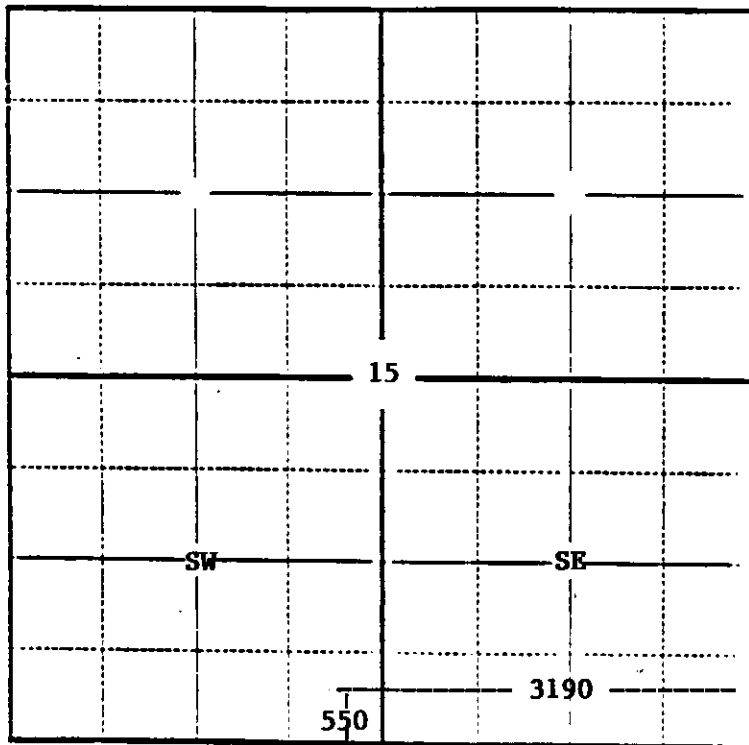

In plotting the proposed location of the well, you must show:

- 1) The manner in which you are using the depicted plat by identifying section lines, i.e. 1 section, 1 section with 8 surrounding sections, 4 sections, etc.;
- 2) the distance of the proposed drilling location from the section's south/north and east/west lines; and
- 3) the distance to the nearest lease or unit boundary line.