

For KCC Use: 9.9.02  
 Effective Date: \_\_\_\_\_  
 District #: 1  
 SGA?  Yes  No

KANSAS CORPORATION COMMISSION  
 OIL & GAS CONSERVATION DIVISION  
**NOTICE OF INTENT TO DRILL**

RECEIVED  
 AUG 27 2002  
 KCC WICHITA

Form C-1  
 September 1999  
 Form must be Typed  
 Form must be Signed  
 All blanks must be Filled

Must be approved by KCC five (5) days prior to commencing well

Expected Spud Date September 16 2002  
month day year

Spot AP NE NW SE NE Sec. 7 Twp. 16 S. R. 30  East  West

OPERATOR: License# 5030  
 Name: Vess Oil Corporation  
 Address: 8100 E. 22nd Street N., Bldg. 300  
 City/State/Zip: Wichita, KS 67226  
 Contact Person: W.R. Horigan  
 Phone: 316-682-1537 X103

1550 feet from S (circle one) Line of Section  
860 feet from E (circle one) Line of Section  
 Is SECTION  Regular  irregular?

(Note: Locate well on the Section Plat on reverse side)

CONTRACTOR: License# 6039  
 Name: L.D. Drilling, Inc.

County: Lane  
 Lease Name: York Well #: 1-7  
 Field Name: N/A

Is this a Prorated / Spaced Field?  Yes  No  
 Target Formation(s): Mississippi

Well Drilled For:  Oil  Gas  OWWO  Seismic;  Other  
 Enh Rec Storage  Disposal  # of Holes  Other  
 Well Class:  Infield  'ool Ext.  Wildcat  Other  
 Type Equipment:  Mud Rotary  Air Rotary  Cable

Nearest Lease or unit boundary: 860

Ground Surface Elevation: 2720 feet MSL

Water well within one-quarter mile: -YES  Yes  No

Public water supply well within one mile:  Yes  No

Depth to bottom of fresh water: 180

Depth to bottom of usable water: 1300

Surface Pipe by Alternate: 1 X 2

Length of Surface Pipe Planned to be set: 240'

Length of Conductor Pipe required: NONE

Projected Total Depth: 4500'

Formation at Total Depth: Mississippi

Water Source for Drilling Operations: Well  Farm Pond  Other

DWR Permit #: \_\_\_\_\_

(Note: Apply for Permit with DWR )

Will Cores be taken?  Yes  No

If Yes, proposed zone: \_\_\_\_\_

If OWWO: old well information as follows:

Operator: \_\_\_\_\_

Well Name: \_\_\_\_\_

Original Completion Date: \_\_\_\_\_ Original Total Depth: \_\_\_\_\_

Directional, Deviated or Horizontal wellbore?  Yes  No

If Yes, true vertical depth: \_\_\_\_\_

Bottom Hole Location: \_\_\_\_\_

KCC DKT #: \_\_\_\_\_

**AFFIDAVIT**

The undersigned hereby affirms that the drilling, completion and eventual plugging of this well will comply with K.S.A. 55-101, et. seq.

It is agreed that the following minimum requirements will be met:

1. Notify the appropriate district office *prior* to spudding of well;
2. A copy of the approved notice of intent to drill *shall be posted* on each drilling rig;
3. The minimum amount of surface pipe as specified below *shall be set* by circulating cement to the top; in all cases surface pipe *shall be set* through all unconsolidated materials plus a minimum of 20 feet into the underlying formation.
4. If the well is dry hole, an agreement between the operator and the district office on plug length and placement is *necessary prior to plugging*;
5. The appropriate district office will be notified before well is either plugged or production casing is cemented in;
6. If an ALTERNATE II COMPLETION, production pipe shall be cemented from below any usable water to surface within **120 days** of spud date. *In all cases, NOTIFY district office* prior to any cementing.

I hereby certify that the statements made herein are true and to the best of my knowledge and belief.

Date: 8/26/02 Signature of Operator or Agent: WR Horigan Title: Vice President-Operations

**For KCC Use ONLY**  
 API # 15 - 101-21802-00-00  
 Conductor pipe required NONE feet  
 Minimum surface pipe required 200 feet per Alt. → ②  
 Approved by: RJP 9-4-02  
 This authorization expires: 3-4-03  
 (This authorization void if drilling not started within 6 months of effective date.)  
 Spud date: \_\_\_\_\_ Agent: \_\_\_\_\_

**Remember to:**

- File Drill Pit Application (form CDP-1) with Intent to Drill;
- File Completion Form ACO-1 within 120 days of spud date;
- File acreage attribution plat according to field proration orders;
- Notify appropriate district office 48 hours prior to workover or re-entry;
- Submit plugging report (CP-4) after plugging is completed;
- Obtain written approval before disposing or injecting salt water.

7  
16  
30W

RECEIVED  
AUG 27 2002  
KCC WICHITA

**IN ALL CASES PLOT THE INTENDED WELL ON THE PLAT BELOW**

*Plat of acreage attributable to a well in a prorated or spaced field*

*If the intended well is in a prorated or spaced field, please fully complete this side of the form.* If the intended well is in a prorated or spaced field complete the plat below showing that the well will be properly located in relationship to other wells producing from the common source of supply. Please show all the wells and within 1 mile of the boundaries of the proposed acreage attribution unit for gas wells and within 1/2 mile of the boundaries of the proposed acreage attribution unit for oil wells.

API No. 15 - \_\_\_\_\_  
Operator: \_\_\_\_\_  
Lease: \_\_\_\_\_  
Well Number: \_\_\_\_\_  
Field: \_\_\_\_\_  
Number of Acres attributable to well: \_\_\_\_\_  
QTR / QTR / QTR of acreage: \_\_\_\_\_ - \_\_\_\_\_ - \_\_\_\_\_

Location of Well: County: \_\_\_\_\_  
\_\_\_\_\_ feet from S / N (circle one) Line of Section  
\_\_\_\_\_ feet from E / W (circle one) Line of Section  
Sec. \_\_\_\_\_ Twp. \_\_\_\_\_ S. R. \_\_\_\_\_  East  West  
Is Section \_\_\_\_\_ Regular or \_\_\_\_\_ Irregular  
**If Section is Irregular, locate well from nearest corner boundary.**  
Section corner used: \_\_\_ NE \_\_\_ NW \_\_\_ SE \_\_\_ SW

**PLAT**

*(Show location of the well and shade attributable acreage for prorated or spaced wells.)  
(Show footage to the nearest lease or unit boundary line.)*

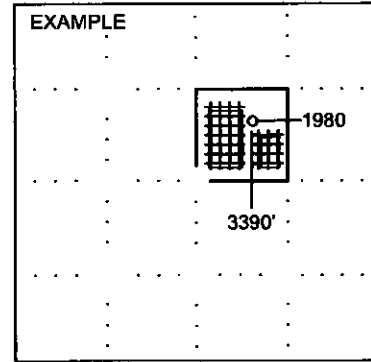
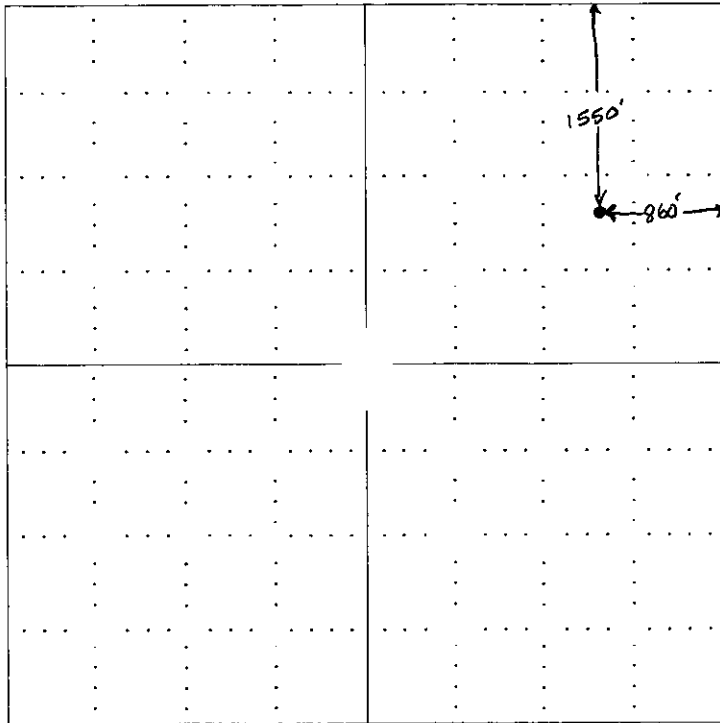

SEWARD CO.

**NOTE: In all cases locate the spot of the proposed drilling locaton.**

**In plotting the proposed location of the well, you must show:**

1. The manner in which you are using the depicted plat by identifying section lines, i.e. 1 section, 1 section with 8 surrounding sections, 4 sections, etc.
2. The distance of the proposed drilling location from the section's south / north and east / west.
3. The distance to the nearest lease or unit boundary line.
4. If proposed location is located within a prorated or spaced field a certificate of acreage attribution plat must be attached: (C0-7 for oil wells; CG-8 for gas wells).