

FOR KCC USE:

EFFECTIVE DATE: 11-5-95

DISTRICT # 1

SEAT, Yes, No

State of Kansas
NOTICE OF INTENTION TO DRILL

Must be approved by the K.C.C. five (5) days prior to commencing well

FORM C-1 7/91
FORM MUST BE TYPED
FORM MUST BE SIGNED
ALL BLANKS MUST BE FILLED

Expected Spud Date: October 31, 1995
month day year

Spot: C SW NE Sec. 3 Twp. 16S Rg. 18W East West

OPERATOR: License # 31741
Name: LIBOC, INC.
Address: 3300 S. Parker Road - Suite 206
City/State/Zip: Aurora, Colorado 80014
Contact Person: Denny Furst
Phone: 303/671-6737

3300 feet from South / ~~XXXX~~ line of Section 1980
1980 feet from East / ~~XXXX~~ line of Section
IS SECTION X REGULAR IRREGULAR

(NOTE: Locate well on the Section Plat on Reverse Side)
County: Rush
Lease Name: Herl Trust Well #: 2
Field Name: _____
Is this a Pretested/Spaced Field? yes X no
Target Formation(s): Top, Arb.
Nearest lease or unit boundary: 1980'
Ground Surface Elevation: 2010 EST. feet MSL
Water well within one-quarter mile: yes X no
Public water supply well within one mile: yes X no
Depth to bottom of fresh water: 180'
Depth to bottom of usable water: 460'
Surface Pipe by Alternator: X 1 2
Length of Surface Pipe Planned to be set: 1165'
Length of Conductor pipe required: N/A
Projected Total Depth: 3615'
Formation at Total Depth: Granite
Water Source for Drilling Operations:
... well ... farm pond X other
DWR Permit #: _____
Will Cores Be Taken? yes X no
If yes, proposed zone: _____

CONTRACTOR: License # 5929
Name: DUKE DRILLING CO., INC.

Well Drilled For: Well Class: Type Equipment:
X Oil ... Enh Rec X Infield X Mud Rotary
... Gas ... Storage ... Pool Ext. ... Air Rotary
... OWD ... Disposal ... Wildcat ... Cable
... Solamc; ... # of Holes ... Other
... Other
If OWD: old well information as follows:
Operator: _____
Well Name: _____
Comp. Date: _____ Old Total Depth _____

Directional, Deviated or Horizontal wellbore? yes X no
If yes, true vertical depth: _____
Bottom Hole Location: _____

AFFIDAVIT

The undersigned hereby affirms that the drilling, completion and eventual plugging of this well will comply with K.S.A. 55-101, et. seq.
It is agreed that the following minimum requirements will be met:

RECEIVED
KANSAS CORPORATION COMMISSION

OCT 26 1995

1. Notify the appropriate district office prior to spudding of well;
2. A copy of the approved notice of intent to drill shall be posted on each drilling rig;
3. The minimum amount of surface pipe as specified below shall be set by circulating cement to the top. In all cases surface pipe shall be set through all unconsolidated materials plus a minimum of 20 feet into the underlying formation;
4. If the well is dry hole, an agreement between the operator and the district office on plug length and placement is necessary prior to plugging;
5. The appropriate district office will be notified before well is either plugged or production casing is cemented in;
6. IF AN ALTERNATE IS COMPLETION, PRODUCTION PIPE SHALL BE CEMENTED FROM BELOW ANY USABLE WATER TO SURFACE WITHIN 122 DAYS OF SPUD DATE. IN ALL CASES, NOTIFY DISTRICT OFFICE PRIOR TO ANY CEMENTING.

CONSERVATION DIVISION
WARRANTY

I hereby certify that the statements made herein are true and to the best of my knowledge and belief.
Date: 10/26/95 Signature of Operator or Agent: Denny Furst Title: _____ Agent

FOR KCC USE:
API # 15- 165-216850000
Conductor pipe required NONE feet
Minimum surface pipe required 480 feet per Alt. ① X
Approved by: JK 10-31-95
This authorization expires: 4-30-96
(This authorization void if drilling not started within 6 months of effective date.)
Spud date: _____ Agent: _____

REMEMBER TO:

- File Drill Pit Application (form CDP-1) with Intent to Drill;
- File Completion Form ACO-1 within 120 days of spud date;
- File acreage attribution plat according to field proration orders;
- Notify appropriate district office 48 hours prior to workover or re-entry;
- Submit plugging report (CP-4) after plugging is completed;
- Obtain written approval before disposing or injecting salt water.

Mail to: Conservation Division, 200 Colorado Derby Building, 202 W. First St., Wichita, Kansas 67202-1286.

3
16
1023

IN ALL CASES PLOT THE INTENDED WELL ON THE PLAT BELOW

PLAT OF ACREAGE ATTRIBUTABLE TO A WELL IN A PRORATED OR SPACED FIELD

If the intended well is in a prorated or spaced field, please fully complete this side of the form. If the intended well is in a prorated or spaced field complete the plat below showing that the well will be properly located in relationship to other wells producing from the common source of supply. Please show all the wells within 1 mile of the boundaries of the proposed acreage attribution unit for gas wells and within 1/2 mile of the boundaries of the proposed acreage attribution unit for oil wells.

API NO. 15- _____
 OPERATOR _____
 LEASE _____
 WELL NUMBER _____
 FIELD _____

LOCATION OF WELL: COUNTY _____
 _____ feet from south/north line of section
 _____ feet from east/west line of section
 SECTION _____ TWP _____ RG _____

NUMBER OF ACRES ATTRIBUTABLE TO WELL _____
 QTR/QTR/QTR OF ACREAGE _____ - _____ - _____

IS SECTION _____ REGULAR or _____ IRREGULAR
IF SECTION IS IRREGULAR, LOCATE WELL FROM NEAREST CORNER BOUNDARY.

Section corner used: _____ NE _____ NW _____ SE _____ SW

PLAT

(Show location of the well and shade attributable acreage for prorated or spaced wells.)
 (Show footage to the nearest lease or unit boundary line.)

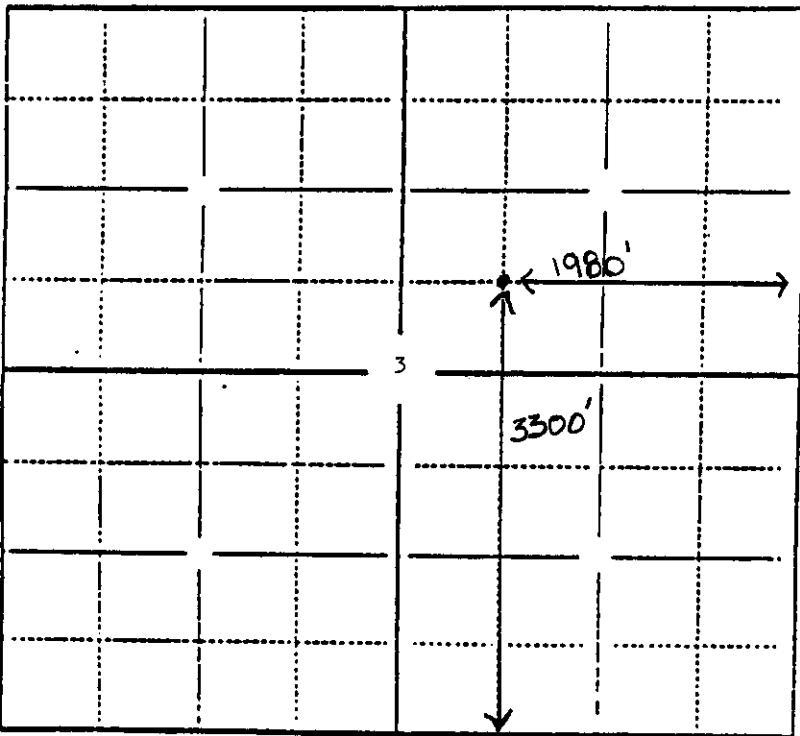

RUSH COUNTY

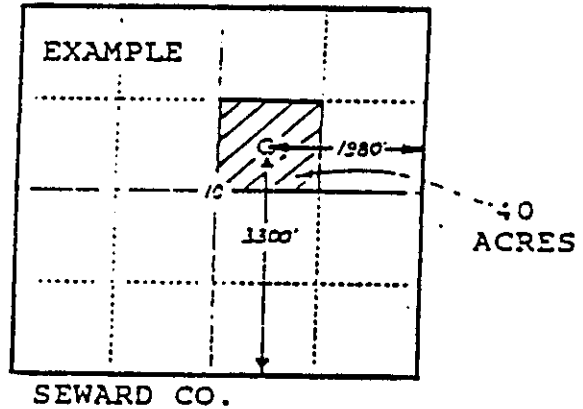

In plotting the proposed location of the well, you must show:

- 1) The manner in which you are using the depicted plat by identifying section lines, i.e. 1 section, 1 section with 8 surrounding sections, 4 sections, etc.;
- 2) the distance of the proposed drilling location from the section's south/north and east/west lines; and
- 3) the distance to the nearest lease or unit boundary line.