

EFFECTIVE DATE: 4-19-92

State of Kansas

FORM MUST BE TYPED

DISTRICT # 1

## NOTICE OF INTENTION TO DRILL

FORM MUST BE SIGNED

SEA? Yes ☒ No

ALL BLANKS MUST BE FILLED

Must be approved by the K.C.C. five (5) days prior to commencing well

Expected Spud Date 4 23 92  
month day yearSpot NE NW NW Sec 23 Twp 16 S Rg 30 X East West ☒OPERATOR: License # 5316  
Name: Falcon Exploration Inc.  
Address: 125 N. Market, Suite 1075  
City/State/Zip: Wichita, KS 67202  
Contact Person: Jim Thatcher  
Phone: (316) 265-33514950 feet from South North line of Section  
4290 feet from East West line of Section  
IS SECTION X REGULAR IRREGULAR(NOTE: Locate well on the Section Plat on Reverse Side)  
County: LaneLease Name: Bentley Well #: 1  
Field Name: wildcatIs this a Prorated/Spaced Field? yes X noTarget Formation(s): MississippiNearest lease or unit boundary: 330Ground Surface Elevation: 2805 feet MSLWater well within one-quarter mile: yes X noPublic water supply well within one mile: yes X noDepth to bottom of fresh water: 170Depth to bottom of usable water: 1200Surface Pipe by Alternate: 1 X 2Length of Surface Pipe Planned to be set: 320Length of Conductor pipe required: noneProjected Total Depth: 4600Formation at Total Depth: Mississippi

Water Source for Drilling Operations:

well farm pond X otherDWR Permit #:                     Will Cores Be Taken?: yes X noIf yes, proposed zone:                     Well Drilled For: Well Class: Type Equipment:  
X Oil Enh Rec Infield X Mud Rotary  
Gas Storage Pool Ext. Air Rotary  
OWHO Disposal X Wildcat Cable  
Seismic # of Holes Other  
Other

If OWHO: old well information as follows:

Operator:                     Well Name:                     Comp. Date:                      Old Total Depth                     Directional, Deviated or Horizontal wellbore? yes X noIf yes, true vertical depth:                     Bottom Hole Location:                     

## AFFIDAVIT

The undersigned hereby affirms that the drilling, completion and eventual plugging of this well will comply with K.S.A. 55-101, et. seq.

It is agreed that the following minimum requirements will be met:

1. Notify the appropriate district office prior to spudding of well;
2. A copy of the approved notice of intent to drill shall be posted on each drilling rig;
3. The minimum amount of surface pipe as specified below shall be set by circulating cement to the top; in all cases surface pipe shall be set through all unconsolidated materials plus a minimum of 20 feet into the underlying formation;
4. If the well is dry hole, an agreement between the operator and the district office on plug length and placement is necessary prior to plugging;
5. The appropriate district office will be notified before well is either plugged or production casing is cemented in;
6. IF AN ALTERNATE II COMPLETION, PRODUCTION PIPE SHALL BE CEMENTED FROM BELOW ANY USABLE WATER TO SURFACE WITHIN 120 DAYS OF SPUD DATE. IN ALL CASES, NOTIFY DISTRICT OFFICE PRIOR TO ANY CEMENTING.

I hereby certify that the statements made herein are true and to the best of my knowledge and belief.

Date: 4/13/92 Signature of Operator or Agent: Jim Thatcher Title: AGENT

FOR KCC USE:

API # 15- 101-21,621-0000Conductor pipe required None feetMinimum surface pipe required 200 feet per Alt. # 2Approved by: mw 4-14-92This authorization expires: 10-14-92

(This authorization void if drilling not started within 6 months of effective date.)

Spud date:                      Agent:                     

## REMEMBER TO:

- File Drill Pit Application (form CDP-1) with Intent to Drill;
- File Completion Form ACO-1 within 120 days of spud date;
- File acreage attribution plat according to field prorotation orders;
- Notify appropriate district office 48 hours prior to workover or re-entry;
- Submit plugging report (CP-4) after plugging is completed;
- Obtain written approval before disposing or injecting salt water.

Mail to: Conservation Division, 200 Colorado Derby Building, 202 W. First St., Wichita, Kansas 67202-1286.

RECEIVED  
APR 13 1992  
STATE CORPORATION COMMISSIONER  
Wichita, Kansas

IN ALL CASES PLOT THE INTENDED WELL ON THE PLAT BELOW

PLAT OF ACREAGE ATTRIBUTABLE TO A WELL IN A PRORATED OR SPACED FIELD

If the intended well is in a prorated or spaced field, please fully complete this side of the form. If the intended well is in a prorated or spaced field complete the plat below showing that the well will be properly located in relationship to other wells producing from the common source of supply. Please show all the wells within 1 mile of the boundaries of the proposed acreage attribution unit for gas wells and within 1/2 mile of the boundaries of the proposed acreage attribution unit for oil wells.

API NO. 15- \_\_\_\_\_

OPERATOR Falcon Exploration Inc.

LEASE Bentley

WELL NUMBER 1

FIELD wildcat

LOCATION OF WELL: COUNTY \_\_\_\_\_ Lane \_\_\_\_\_

4950 feet from south/north line of section

4290 feet from east/west line of section

SECTION 23 TWP 16S RG 30W

NUMBER OF ACRES ATTRIBUTABLE TO WELL \_\_\_\_\_

QTR/QTR/QTR OF ACREAGE \_\_\_\_\_

IS SECTION X REGULAR or \_\_\_\_\_ IRREGULAR

IF SECTION IS IRREGULAR, LOCATE WELL FROM NEAREST CORNER BOUNDARY.

Section corner used: \_\_\_\_\_ NE \_\_\_\_\_ NW \_\_\_\_\_ SE \_\_\_\_\_ SW

PLAT

(Show location of the well and shade attributable acreage for prorated or spaced wells.)

(Show footage to the nearest lease or unit boundary line.)

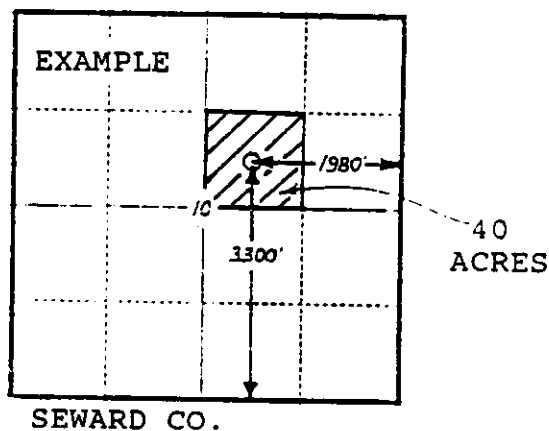
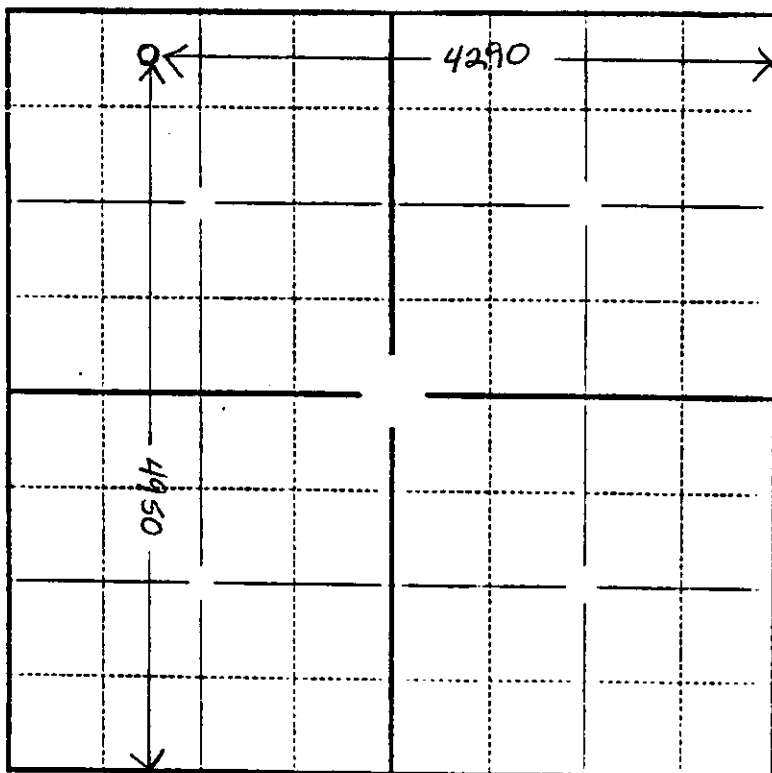

In plotting the proposed location of the well, you must show:

- 1) The manner in which you are using the depicted plat by identifying section lines, i.e. 1 section, 1 section with 8 surrounding sections, 4 sections, etc.;
- 2) the distance of the proposed drilling location from the section's south/north and east/west lines; and
- 3) the distance to the nearest lease or unit boundary line.