

FOR KCC USE:

FORM C-1 7/91

EFFECTIVE DATE: 10-23-91  
DISTRICT # 1  
SSA? Yes X No

State of Kansas  
NOTICE OF INTENTION TO DRILL

FORM MUST BE TYPED  
FORM MUST BE SIGNED  
ALL BLANKS MUST BE FILLED

Must be approved by the K.C.C. five (5) days prior to commencing well

Expected Spud Date .....  
month day year

Spot ..... East  
C... NE NE Sec .34 Twp .20 S, Rg .25 X West ✓  
150' south

OPERATOR: License # ..... 5652  
Name: Mustang Oil & Gas Corp.  
Address: P.O. Box 1609  
City/State/Zip: Great Bend, KS 67530  
Contact Person: Stan Brady  
Phone: 1-316-792-7323

4470... feet from South North line of Section  
660... feet from East West line of Section  
IS SECTION X REGULAR IRREGULAR

(NOTE: Locate well on the Section Plat on Reverse Side)

County: Ness  
Lease Name: Eehrenbach Well #: 4-34  
Field Name: Almquist

CONTRACTOR: License #: UNKNOWN AT THIS TIME  
Name:

Is this a Prorated/Spaced Field? ... yes X no  
Target Formation(s): Mississippi  
Nearest lease or unit boundary: 660

Well Drilled For: Well Class: Type Equipment:  
X Oil ... Enh Rec X Infield X Mud Rotary ✓  
Gas ... Storage ... Pool Ext. ... Air Rotary  
OHW ... Disposal ... Wildcat ... Cable  
Seismic; ... # of Holes ... Other  
Other

Ground Surface Elevation: NA feet MSL  
Water well within one-quarter mile: ... yes X no  
Public water supply well within one mile: ... yes X no

If OAWD: old well information as follows:  
Operator:  
Well Name:  
Comp. Date: Old Total Depth

Depth to bottom of fresh water: 330  
Depth to bottom of usable water: 790  
Surface Pipe by Alternate: X 1 ... 2

Directional, Deviated or Horizontal wellbore? ... yes X no  
If yes, true vertical depth:  
Bottom Hole Location:

Length of Surface Pipe Planned to be set: -0- 750  
Length of Conductor pipe required:  
Projected Total Depth: 4550  
Formation at Total Depth: Mississippi

Water Source for Drilling Operations:  
X well ... farm pond ... other

DVR Permit #:  
Will Cores Be Taken?: ... yes X no  
If yes, proposed zone:

AFFIDAVIT

The undersigned hereby affirms that the drilling, completion and eventual plugging of this well will comply with K.S.A. 55-101, et. seq.

It is agreed that the following minimum requirements will be met:

1. Notify the appropriate district office prior to spudding of well;
2. A copy of the approved notice of intent to drill shall be posted on each drilling rig;
3. The minimum amount of surface pipe as specified below shall be set by circulating cement to the top; in all cases surface pipe shall be set through all unconsolidated materials plus a minimum of 20 feet into the underlying formation;
4. If the well is dry hole, an agreement between the operator and the district office on plug length and placement is necessary prior to plugging;
5. The appropriate district office will be notified before well is either plugged or production casing is cemented in;
6. IF AN ALTERNATE II COMPLETION, PRODUCTION PIPE SHALL BE CEMENTED FROM BELOW ANY USABLE WATER TO SURFACE WITHIN 120 DAYS OF SPUD DATE. IN ALL CASES, NOTIFY DISTRICT OFFICE PRIOR TO ANY CEMENTING.

I hereby certify that the statements made herein are true and to the best of my knowledge and belief.

Date: 10-17-91 Signature of Operator or Agent: Bill C. Romig Title: Chief Geologist

WALK IN

FOR KCC USE:  
API # 15- 135-23,618-0000  
Conductor pipe required NB feet  
Minimum surface pipe required 250 feet per Alt. ①  
Approved by: ARL 10-18-91  
This authorization expires: 4-18-92  
(This authorization void if drilling not started within 6 months of effective date.)  
Spud date: \_\_\_\_\_ Agent: \_\_\_\_\_

RECEIVED  
KANSAS CORPORATION COMMISSION  
OCT 18 1991  
CONSERVATION DIVISION  
WICHITA, KS

34 20 250

REMEMBER TO:

- File Drill Pit Application (form CDP-1) with Intent to Drill;
- File Completion Form ACO-1 within 120 days of spud date;
- File acreage attribution plat according to field proration orders;
- Notify appropriate district office 48 hours prior to workover or re-entry;
- Submit plugging report (CP-4) after plugging is completed;
- Obtain written approval before disposing or injecting salt water.

Mail to: Conservation Division, 200 Colorado Derby Building, 202 W. First St., Wichita, Kansas 67202-1286.

**IN ALL CASES PLOT THE INTENDED WELL ON THE PLAT BELOW**

**PLAT OF ACREAGE ATTRIBUTABLE TO A WELL IN A PRORATED OR SPACED FIELD**

If the intended well is in a prorated or spaced field, please fully complete this side of the form. If the intended well is in a prorated or spaced field complete the plat below showing that the well will be properly located in relationship to other wells producing from the common source of supply. Please show all the wells within 1 mile of the boundaries of the proposed acreage attribution unit for gas wells and within 1/2 mile of the boundaries of the proposed acreage attribution unit for oil wells.

API NO. 15- \_\_\_\_\_  
 OPERATOR Mustang Oil & Gas Corp.  
 LEASE Fehrenbach  
 WELL NUMBER 4-34  
 FIELD Almquist

LOCATION OF WELL: COUNTY Ness  
4470 feet from south/north line of section  
660 feet from east/west line of section  
 SECTION 34 TWP 20 RG 25W

NUMBER OF ACRES ATTRIBUTABLE TO WELL 40  
 QTR/QTR/QTR OF ACREAGE C - NE - NE

IS SECTION X REGULAR or IRREGULAR  
**IF SECTION IS IRREGULAR, LOCATE WELL FROM NEAREST CORNER BOUNDARY.**

Section corner used: NE NW SE SW

**PLAT**

(Show location of the well and shade attributable acreage for prorated or spaced wells.)  
 (Show footage to the nearest lease or unit boundary line.)

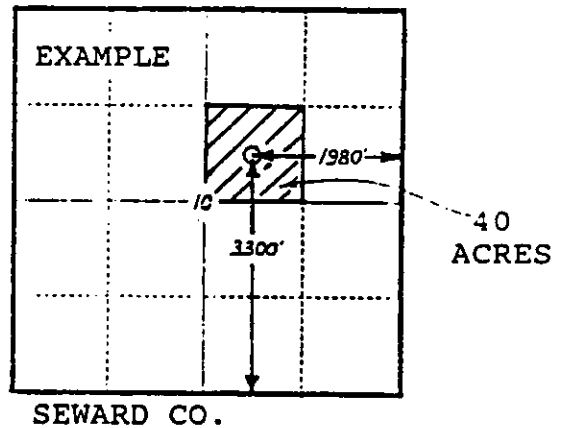
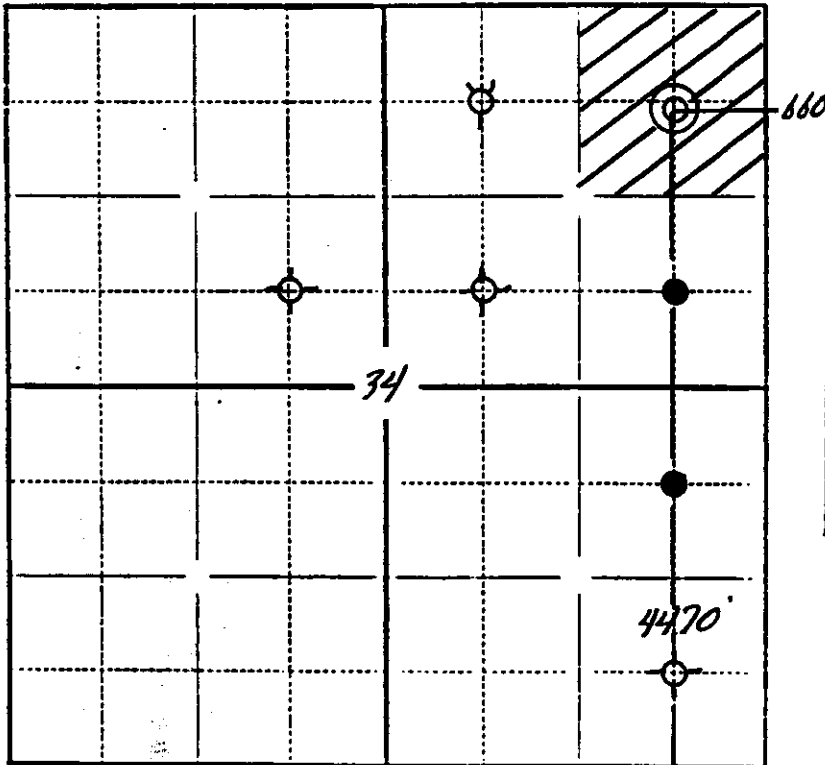

**In plotting the proposed location of the well, you must show:**

- 1) The manner in which you are using the depicted plat by identifying section lines, i.e. 1 section, 1 section with 8 surrounding sections, 4 sections, etc.;
- 2) the distance of the proposed drilling location from the section's south/north and east/west lines; and
- 3) the distance to the nearest lease or unit boundary line.

M  
A  
W  
S  
I