

\* NEW FORMS SUBMITTED IN LIEU OF INCOMPT. FORM (CP-1 ONLY) D.2

KANSAS CORPORATION COMMISSION OIL & GAS CONSERVATION DIVISION  
**WELL PLUGGING APPLICATION**  
Form KSONA-1, Certification of Compliance with the Kansas Surface Owner Notification Act, -MUST be submitted with this form.

Form CP-1 March 2010  
This Form must be Typed  
Form must be Signed  
All blanks must be Filled

OPERATOR: License #: 32846  
Name: Premier Oil & Exploration, Inc.  
Address 1: 1100 Airport Road  
Address 2: \_\_\_\_\_  
City: Hutchinson State: KS Zip: 67501 + \_\_\_\_\_  
Contact Person: Kevin Bowen  
Phone: (620) 727-0172

API No. 15 - 113-20653-00-00  
If pre 1967, supply original completion date: 1979  
Spot Description: SE SE SW NW  
SE SE SW NW Sec. 24 Twp. 21 S. R. 2  East  West  
2,940 Feet from  North /  South Line of Section  
4,035 Feet from  East /  West Line of Section  
Footages Calculated from Nearest Outside Section Corner:  
 NE  NW  SE  SW  
County: McPherson  
Lease Name: Stucky Well #: 1

Check One:  Oil Well  Gas Well  OG  D&A  Cathodic  Water Supply Well  Other: \_\_\_\_\_  
 SWD Permit # \_\_\_\_\_  ENHR Permit # \_\_\_\_\_  Gas Storage Permit # \_\_\_\_\_  
Conductor Casing Size: NA Set at: \_\_\_\_\_ Cemented with: \_\_\_\_\_ Sacks  
Surface Casing Size: 8 5/8" Set at: 128' Cemented with: 100 Sacks  
Production Casing Size: 4 1/2" Set at: 2988' Cemented with: 75 Sacks

List (ALL) Perforations and Bridge Plug Sets:  
**Perforated from 2988' to 2998', open hole**

Elevation: 1497 ( G.L. /  K.B.) T.D.: 2998 PBTD: \_\_\_\_\_ Anhydrite Depth: \_\_\_\_\_  
(Stone Corral Formation)

Condition of Well:  Good  Poor  Junk in Hole  Casing Leak at: \_\_\_\_\_  
(Interval)

Proposed Method of Plugging (attach a separate page if additional space is needed):

**In accordance with the KCC**

Is Well Log attached to this application?  Yes  No Is ACO-1 filed?  Yes  No  
If ACO-1 not filed, explain why:

RECEIVED  
DEC 26 2012  
KCC WICHITA

Plugging of this Well will be done in accordance with K.S.A. 55-101 et. seq. and the Rules and Regulations of the State Corporation Commission

Company Representative authorized to supervise plugging operations: Ralph Bowen  
Address: 1100 Airport Road City: Hutchinson State: KS Zip: 67501 + \_\_\_\_\_  
Phone: (620) 200-3505  
Plugging Contractor License #: 31529 Name: Mike's Testing & Salvage, Inc.  
Address 1: P.O. Box 467 Address 2: \_\_\_\_\_  
City: Chase State: KS Zip: 67524 + 0467  
Phone: (620) 938-2943

Proposed Date of Plugging (if known): By 1/15/2013

Payment of the Plugging Fee (K.A.R. 82-3-118) will be guaranteed by Operator or Agent

Date: 12/21/2012 Authorized Operator / Agent: \_\_\_\_\_  
(Signature)

KANSAS CORPORATION COMMISSION  
OIL & GAS CONSERVATION DIVISION

Form KSONA-1  
July 2010  
Form Must Be Typed  
Form must be Signed  
All blanks must be Filled

**CERTIFICATION OF COMPLIANCE WITH THE  
KANSAS SURFACE OWNER NOTIFICATION ACT**

*This form must be submitted with all Forms C-1 (Notice of Intent to Drill); CB-1 (Cathodic Protection Borehole Intent); T-1 (Request for Change of Operator Transfer of Injection or Surface Pit Permit); and CP-1 (Well Plugging Application). Any such form submitted without an accompanying Form KSONA-1 will be returned.*

Select the corresponding form being filed:  C-1 (Intent)  CB-1 (Cathodic Protection Borehole Intent)  T-1 (Transfer)  CP-1 (Plugging Application)

OPERATOR: License # 32846  
Name: Premier Oil & Exploration, Inc.  
Address 1: 1100 Airport Road  
Address 2: \_\_\_\_\_  
City: Hutchinson State: KS Zip: 67501 + \_\_\_\_\_  
Contact Person: Kevin Bowen  
Phone: (620) 727-0172 Fax: (620) 662-1903  
Email Address: kb@airport.kscoxmail.com

Well Location:  
SE SE SW NW Sec. 24 Twp. 21 S. R. 2  East  West  
County: McPherson  
Lease Name: Stucky Well #: 1

*If filing a Form T-1 for multiple wells on a lease, enter the legal description of the lease below:*

**Surface Owner Information:**

Name: Russel Stucky  
Address 1: 2275 Cherokee RD  
Address 2: \_\_\_\_\_  
City: Moundridge State: KS Zip: 67107 + \_\_\_\_\_

*When filing a Form T-1 involving multiple surface owners, attach an additional sheet listing all of the information to the left for each surface owner. Surface owner information can be found in the records of the register of deeds for the county, and in the real estate property tax records of the county treasurer.*

*If this form is being submitted with a Form C-1 (Intent) or CB-1 (Cathodic Protection Borehole Intent), you must supply the surface owners and the KCC with a plat showing the predicted locations of lease roads, tank batteries, pipelines, and electrical lines. The locations shown on the plat are preliminary non-binding estimates. The locations may be entered on the Form C-1 plat, Form CB-1 plat, or a separate plat may be submitted.*

**Select one of the following:**

- I certify that, pursuant to the Kansas Surface Owner Notice Act (House Bill 2032), I have provided the following to the surface owner(s) of the land upon which the subject well is or will be located: 1) a copy of the Form C-1, Form CB-1, Form T-1, or Form CP-1 that I am filing in connection with this form; 2) if the form being filed is a Form C-1 or Form CB-1, the plat(s) required by this form; and 3) my operator name, address, phone number, fax, and email address.
- I have not provided this information to the surface owner(s). I acknowledge that, because I have not provided this information, the KCC will be required to send this information to the surface owner(s). To mitigate the additional cost of the KCC performing this task, I acknowledge that I am being charged a \$30.00 handling fee, payable to the KCC, which is enclosed with this form.

*If choosing the second option, submit payment of the \$30.00 handling fee with this form. If the fee is not received with this form, the KSONA-1 form and the associated Form C-1, Form CB-1, Form T-1, or Form CP-1 will be returned.*

I hereby certify that the statements made herein are true and correct to the best of my knowledge and belief.

Date: 12/21/2012 Signature of Operator or Agent: [Signature] Title: President

# Kansas Oil and Gas

Kansas Geological Survey

Statewide View | Zoom to Location | Filter Wells | Label Wells | Download Wells | Print to PDF | Clear Highlight | Help

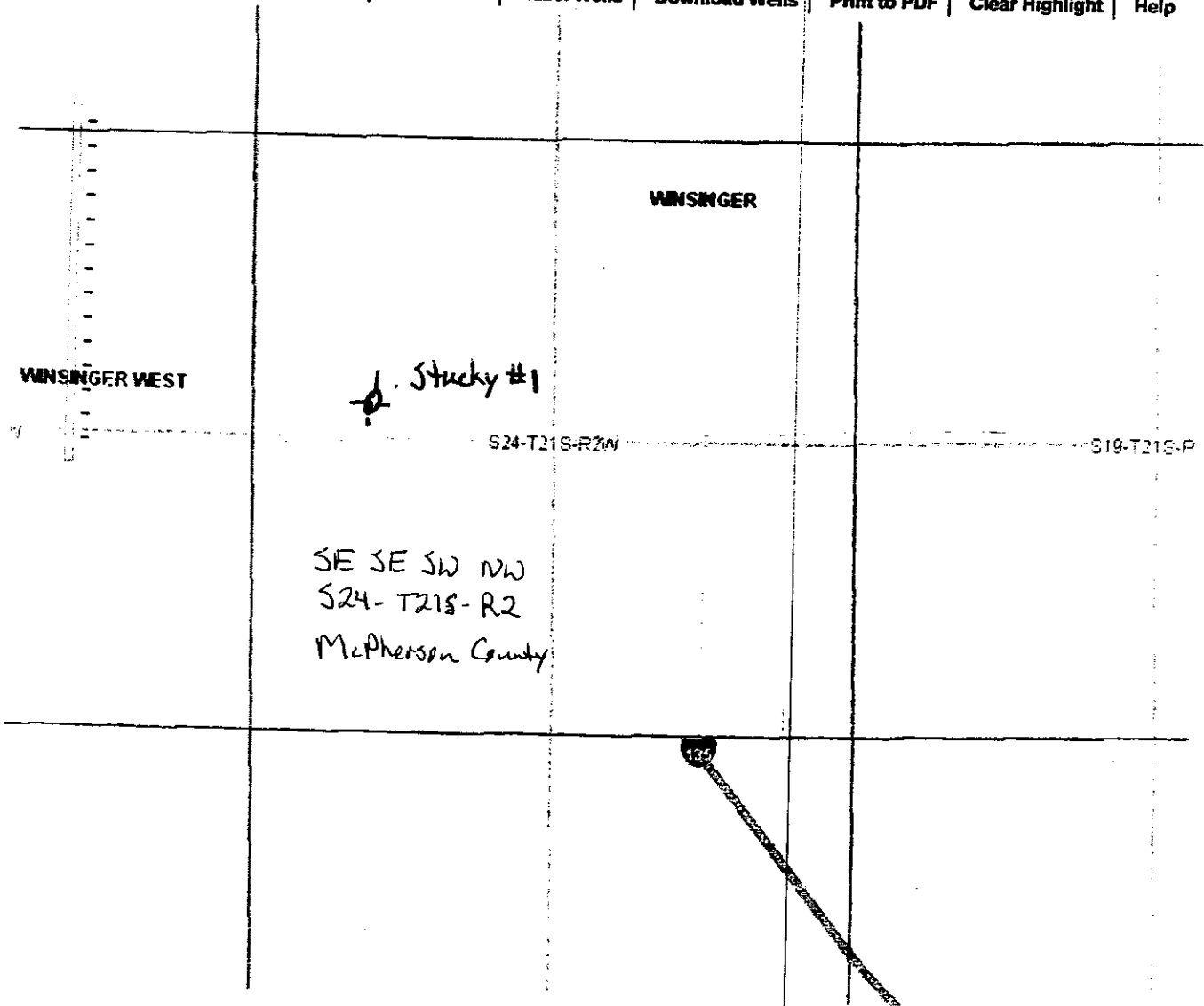

\* Proposed well plugging location

RECEIVED  
DEC 13 2012  
KCC WICHITA

RECEIVED  
DEC 26 2012  
KCC WICHITA

*FUE CC*

Conservation Division  
Finney State Office Building  
130 S. Market, Rm. 2078  
Wichita, KS 67202-3802



Phone: 316-337-6200  
Fax: 316-337-6211  
<http://kcc.ks.gov/>

Mark Sievers, Chairman  
Thomas E. Wright, Commissioner  
Shari Feist Albrecht, Commissioner

Sam Brownback, Governor

December 14, 2012

**Premier Oil & Exploration, Inc.**  
**1100 Airport Road**  
**Hutchinson, KS 67501**

<b>RE:</b>	<b>CP-1 and KSONA-1 forms for 2 wells</b>	
	<b>Lease Name: KOEHN 1</b>	<b>13-21S-2W McPHERSON CTY</b>
	<b>API No.: 15-113-01386-0002</b>	
	<b>Lease Name: STUCKY 1</b>	<b>24-21S-2W McPHERSON CTY</b>
	<b>API No.: 15-113-20653-0000</b>	

Dear Operator:

The enclosed **Well Plugging Application forms (CP-1 and KSONA-1)**, received December 13, 2012, are incomplete because they are *copies that have just been re-dated* rather than original forms. Plugging applications cannot be processed for the above-referenced wells without the following corrective actions:

**ORIGINAL CP-1 and KSONA-1 forms must be submitted.** We cannot accept copies that have simply been re-dated. **Blank CP-1 and KSONA-1 forms for both wells** are attached for your use.

Please make all of the above-referenced corrections and **then return both ORIGINAL forms, along with a copy of this letter, to my attention by December 28, 2012.** If you have any questions, please contact me directly at (316) 337-6108.

Sincerely,

Marjorie (Maggie) Marcotte  
Production department

Encls.

KANSAS CORPORATION COMMISSION  
OIL & GAS CONSERVATION DIVISION

WELL PLUGGING APPLICATION

Form KSONA-1, Certification of Compliance with the Kansas Surface Owner Notification Act  
MUST be submitted with this form.

\* FORMS ARE COPIES  
OR CP-1/KSONA-1 FORM  
REC'D IN MARCH  
2012. RETD  
TO OPER.  
Form CP-1  
March 2010  
Form must be Typed  
Form must be Signed  
All blanks must be Filled  
W/ATR. DTD.  
12/14/12

OPERATOR: License #: 32846  
Name: Premier Oil & Exploration, Inc.  
Address 1: 1100 Airport Road  
Address 2: \_\_\_\_\_  
City: Hutchinson State: KS Zip: 67501 + \_\_\_\_\_  
Contact Person: Kevin L. Bowen  
Phone: (620) 727-0172

API No. 15 - 113-20653-00-00  
If pre 1967, supply original completion date: 1979  
Spot Description: SE SE SW NW  
SE SE SW NW Sec. 24 Twp. 21 S. R. 2  East  West  
2,940 Feet from  North /  South Line of Section  
4,035 Feet from  East /  West Line of Section  
Footages Calculated from Nearest Outside Section Corner:  
 NE  NW  SE  SW  
County: MCPerson  
Lease Name: Stucky Well #: 1

Check One:  Oil Well  Gas Well  OG  D&A  Cathodic  Water Supply Well  Other: \_\_\_\_\_  
 SWD Permit #: \_\_\_\_\_  ENHR Permit #: \_\_\_\_\_  Gas Storage Permit #: \_\_\_\_\_  
Conductor Casing Size: NA Set at: \_\_\_\_\_ Cemented with: \_\_\_\_\_ Sacks  
Surface Casing Size: 8 5/8" Set at: 128' Cemented with: 100 Sacks  
Production Casing Size: 4 1/2" Set at: 2988' Cemented with: 75 Sacks

List (ALL) Perforations and Bridge Plug Sets:  
**Perforated from 2988' to 2998', open hole**

Elevation: 1497 ( G.L. /  K.B.) T.D.: 2998 PBTD: \_\_\_\_\_ Anhydrite Depth: \_\_\_\_\_

(Stone Corral Formation)

Condition of Well:  Good  Poor  Junk in Hole  Casing Leak at: \_\_\_\_\_  
(Interval)

Proposed Method of Plugging (attach a separate page if additional space is needed):

**In accordance with the Kansas Corporation Commission**

Is Well Log attached to this application?  Yes  No Is ACO-1 filed?  Yes  No

If ACO-1 not filed, explain why:

Plugging of this Well will be done in accordance with K.S.A. 55-101 et. seq. and the Rules and Regulations of the State Corporation Commission

Company Representative authorized to supervise plugging operations: Ralph Bowen  
Address: 1100 Airport Road City: Hutchinson State: KS Zip: 67501 + \_\_\_\_\_  
Phone: (620) 200-3505

Plugging Contractor License #: 31529 Name: Mike's Testing & Salvage, Inc.  
Address 1: P.O. Box 467 Address 2: \_\_\_\_\_  
City: Chase State: KS Zip: 67524 + 0467  
Phone: (620) 938-2943

Proposed Date of Plugging (if known): NA

Payment of the Plugging Fee (K.A.R. 82-3-118) will be guaranteed by Operator or Agent  
Date: 12/11/2012 Authorized Operator / Agent: [Signature]

(Signature)

RECEIVED  
DEC 13 2012  
KCC WICHITA

KANSAS CORPORATION COMMISSION  
OIL & GAS CONSERVATION DIVISION

*COPY - NOT ORIGINAL*  
*RET'D TO OPER*  
*LR. 2TD.*  
*12/14/12*  
Form KSONA-1  
July 2010  
Form Must Be Typed  
Form must be Signed  
All blanks must be Filled

**CERTIFICATION OF COMPLIANCE WITH THE  
KANSAS SURFACE OWNER NOTIFICATION ACT**

*This form must be submitted with all Forms C-1 (Notice of Intent to Drill); CB-1 (Cathodic Protection Borehole Intent); T-1 (Request for Change of Operator Transfer of Injection or Surface Pit Permit); and CP-1 (Well Plugging Application). Any such form submitted without an accompanying Form KSONA-1 will be returned.*

*WJ*

Select the corresponding form being filed:  C-1 (Intent)  CB-1 (Cathodic Protection Borehole Intent)  T-1 (Transfer)  CP-1 (Plugging Application)

OPERATOR: License # 32846  
Name: Premier Oil & Exploration, Inc.  
Address 1: 1100 Airport Road  
Address 2: \_\_\_\_\_  
City: Hutchinson State: KS Zip: 67501 + \_\_\_\_\_  
Contact Person: Kevin Bowen  
Phone: (620) 727-0172 Fax: (620) 662-1903  
Email Address: kb@airport.kscoxmail.com

Well Location:  
SE SE SW NW Sec. 24 Twp. 21 S. R. 2  East  West  
County: MCPherson  
Lease Name: Stucky Well #: 1

*If filing a Form T-1 for multiple wells on a lease, enter the legal description of the lease below:*

**Surface Owner Information:**

Name: Russell Stucky  
Address 1: 2275 Cherokee Rd  
Address 2: \_\_\_\_\_  
City: Moundridge State: KS Zip: 67107 + \_\_\_\_\_

*When filing a Form T-1 involving multiple surface owners, attach an additional sheet listing all of the information to the left for each surface owner. Surface owner information can be found in the records of the register of deeds for the county, and in the real estate property tax records of the county treasurer.*

*If this form is being submitted with a Form C-1 (Intent) or CB-1 (Cathodic Protection Borehole Intent), you must supply the surface owners and the KCC with a plat showing the predicted locations of lease roads, tank batteries, pipelines, and electrical lines. The locations shown on the plat are preliminary non-binding estimates. The locations may be entered on the Form C-1 plat, Form CB-1 plat, or a separate plat may be submitted.*

**Select one of the following:**

I certify that, pursuant to the Kansas Surface Owner Notice Act (House Bill 2032), I have provided the following to the surface owner(s) of the land upon which the subject well is or will be located: 1) a copy of the Form C-1, Form CB-1, Form T-1, or Form CP-1 that I am filing in connection with this form; 2) if the form being filed is a Form C-1 or Form CB-1, the plat(s) required by this form; and 3) my operator name, address, phone number, fax, and email address.

I have not provided this information to the surface owner(s). I acknowledge that, because I have not provided this information, the KCC will be required to send this information to the surface owner(s). To mitigate the additional cost of the KCC performing this task, I acknowledge that I am being charged a \$30.00 handling fee, payable to the KCC, which is enclosed with this form.

*If choosing the second option, submit payment of the \$30.00 handling fee with this form. If the fee is not received with this form, the KSONA-1 form and the associated Form C-1, Form CB-1, Form T-1, or Form CP-1 will be returned.*

I hereby certify that the statements made herein are true and correct to the best of my knowledge and belief.

Date: 12/14/2012 Signature of Operator or Agent: [Signature] Title: President

RECEIVED

DEC 13 2012

KCC WICHITA



Mark Sievers, Chairman  
Thomas E. Wright, Commissioner  
Shari Feist Albrecht, Commissioner

Corporation Commission

Sam Brownback, Governor

**NOTICE OF RECEIPT OF WELL PLUGGING APPLICATION (CP-1)**

PREMIER OIL & EXPLORATION INC  
1100 AIRPORT RD  
HUTCHINSON, KS 67501-1916

December 31, 2012

Re: STUCKY #1  
API 15-113-20653-00-00  
24-21S-2W, 2940 FSL 4035 FEL  
MCPHERSON COUNTY, KANSAS

Dear Operator:

This letter is to notify you that the Conservation Division has received your plugging proposal, form CP-1, for the above well and has reviewed the proposal for completeness. The central office will now forward your CP-1 to the district office listed below for review of the proposed plugging method. **Please contact the district office for approval of your proposed plugging method at least five (5) days before plugging the well, pursuant to K.A.R. 82-3-113(b). If a workover pit will be used during the plugging of the well it must be permitted. A CDP-1 form must be filed and approved prior to the use of the pit in accordance with K.A.R. 82-3-600.**

The Conservation Division's review of form CP-1, either in the central or district office, does not include an inquiry into well ownership or the filing operator's legal right to plug the well. This notice in no way constitutes authorization to plug the above well by persons not having legal rights of ownership or interest in the well.

**This notice is void after June 29, 2013. The CP-1 filing does not bring the above well into compliance with K.A.R. 82-3-111 with regard to the Commission's temporary abandonment requirements.**

Sincerely,

Steve Bond  
Production Department Supervisor

District: #2  
3450 N. Rock Road, Suite 601  
Wichita, KS 67226  
(316) 630-4000