

STATE OF KANSAS
STATE CORPORATION COMMISSION
200 Colorado Derby Building
Wichita, Kansas 67202

WELL PLUGGING RECORD
K.A.R.-82-3-117

API NUMBER 15-101-20,382 -0000

LEASE NAME Cartmill

WELL NUMBER 2

TYPE OR PRINT
NOTICE: Fill out completely
and return to Cons. Div.
office within 30 days.

1650 Ft. from S Section Line

3630 Ft. from E Section Line

SEC. 27 TWP. 17 RGE. 28 (X) or (W)

COUNTY Lane

Date Well Completed 5-13-79

Plugging Commenced 8-21-92

Plugging Completed 8-21-92

LEASE OPERATOR A. L. Abercrombie, Inc.

ADDRESS Rt. #1 Box 56, Great Bend, Ks.

PHONE#(316) 793-8186 OPERATORS LICENSE NO. 5393

Character of Well WSW

(Oil, Gas, D&A, SWD, Input, Water Supply Well)

The plugging proposal was approved on June 30, 1992 (date)

by David P. Williams (KCC District Agent's Name).

Is ACO-1 filed? Yes If not, is well log attached? Yes

Producing Formation Sand & Shale Depth to Top 1725 Bottom 1800 T.D. 2076

Show depth and thickness of all water, oil and gas formations.

OIL, GAS OR WATER RECORDS

CASING RECORD

Formation	Content	From	To	Size	Put In	Pulled out
Sand	Water	1725	1800	8 5/8	329	None
				5 1/2	2074	None

Describe in detail the manner in which the well was plugged, indicating where the mud fluid was placed and the method or methods used in introducing it into the hole. If cement or other plugs were used, state the character of same and depth placed, from feet to feet each set.

Pump 400 sacks hulls - 175 sacks 60/40 Poz 6% Gel with 400# Hulls

Plugged from 2076 to surface with 400# standing completed @ 12:15 PM 8-21-92

State Plugger Dan Goodrow

(If additional description is necessary, use BACK of this form.)

Name of Plugging Contractor A. L. Abercrombie, Inc. License No. 5393

Address Rt. #1 Box 56, Great Bend, Ks. 67530

NAME OF PARTY RESPONSIBLE FOR PLUGGING FEES: A. L. Abercrombie, Inc.

STATE OF Kansas COUNTY OF Barton, ss.

E. L. Abercrombie (Employee of Operator) or (Operator) of above-described well, being first duly sworn on oath, says: That I have knowledge of the facts, statements, and matters herein contained and the log of the above-described well as filed that the same are true and correct, so help me God.

(Signature) E. L. Abercrombie

(Address) Rt. #1 Box 56, Great Bend, Ks. 67530



SUBSCRIBED AND SWORN TO before me this 18th day of September 1992

Susan M. Evers
Notary Public

My Commission Expires: 7-29-96

RECEIVED 92
STATE CORPORATION COMMISSION
SEP 25 1992
9-23-92
CONSERVATION DIVISION CP-4
Wichita, Kansas 67202
R03000005-88

KANSAS DRILLERS LOG

S. 27 T. 17S R. 28W E
 W
 Loc. Approx. SW NE SW
 County Lane

API No. 15 — 101 — 20,382-0000
 County Number

Operator
A. L. Abercrombie, Inc.

Address
801 Union Center, Wichita, Kansas 67202

Well No. #2 SWD Lease Name Cartmill

Footage Location
1650' feet from ~~XX~~ (S) line 1650' feet from ~~XX~~ (W) line

Principal Contractor Abercrombie Drilling, Inc Geologist --

Spud Date May 11, 1979 Total Depth 2076' P.B.T.D.

Date Completed May 13, 1979 Oil Purchaser

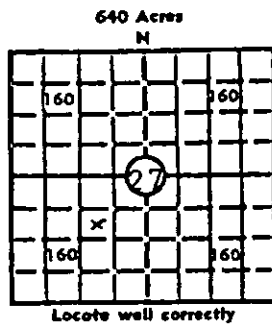

Elev.: Gr _____
 DF _____ KB _____

CASING RECORD

Report of all strings set — surface, intermediate, production, etc.

Purpose of string	Size hole drilled	Size casing set (in O.D.)	Weight lbs/ft.	Setting depth	Type cement	Sacks	Type and percent additives
Surface	12 3/4"	8-5/8"	28#	329'	common	185	3% Ca.Cl. 2% gel.
Casing	7-7/8"	5 3/8"	14#	2074'	50/50 posmix	450	4% gel. 12 1/2# gilsinite per sack

LINER RECORD

PERFORATION RECORD

Top, ft.	Bottom, ft.	Socks cement	Shots per ft.	Size & type	Depth interval
			2		1725' - 1800'

TUBING RECORD

Size	Setting depth	Packer set at
2" VIP	1665'	1665'

ACID, FRACTURE, SHOT, CEMENT SQUEEZE RECORD

Amount and kind of material used	Depth interval treated

INITIAL PRODUCTION

Date of first production _____ Producing method (flowing, pumping, gas lift, etc.) _____

RATE OF PRODUCTION PER 24 HOURS
 Oil _____ Gas _____ Water: _____ Gas-oil ratio _____
 bbls. MCF bbls.

Disposition of gas (vented, used on lease or sold) _____ Producing interval (s) _____
 Injection rate 40 bls. per hour

INSTRUCTIONS: As provided in KCC Rule 82-2-125, within 90 days after completion of a well, one completed copy of this Drillers Log shall be transmitted to the State Geological Survey of Kansas, 4150 Monroe Street, Wichita, Kansas 67209. Copies of this form are available from the Conservation Division, State Corporation Commission, 3830 So. Meridian (P.O. Box 17027), Wichita, Kansas 66217. Phone AC 316-522-2206. If confidentiality is desired, please note Rule 82-2-125. Drillers Logs will be on open file in the Oil and Gas Division, State Geological Survey of Kansas, Lawrence, Kansas 66044.

RECEIVED
 STATE CORPORATION COMMISSION
 JUN 5 0 1992

Operator
A. L. Abercrombie, Inc.

DESIGNATE TYPE OF COMP.: OIL, GAS,
DRY HOLE, SWDW, ETC.:

Well No. 2 Lease Name Cartmill SWDW

S 27 T 17 S R 28 W E W

WELL LOG
Show all important zones of porosity and contents thereof; cored intervals, and all drill-stem tests, including depth interval tested, cushion used, time tool open, flowing and shut-in pressures, and recoveries.

SHOW GEOLOGICAL MARKERS, LOGS RUN,
OR OTHER DESCRIPTIVE INFORMATION.

FORMATION DESCRIPTION, CONTENTS, ETC.	TOP	BOTTOM	NAME	DEPTH
Surface clay and shale and sand	0	332		
Sand and shale	332	1950		
Shale	1950	2061		
Anhydrite	2061	2076		
Rotary Total Depth		2076		

USE ADDITIONAL SHEETS, IF NECESSARY, TO COMPLETE WELL RECORD.

Date Received

Jack L. Partridge
Signature

Jack L. Partridge, Asst. Sec.-Treas.
Title

May 23, 1979
Date