

STATE OF KANSAS
STATE CORPORATION COMMISSION
200 Colorado Derby Building
Wichita, Kansas 67202

WELL PLUGGING RECORD
K.A.R.-82-3-117

API NUMBER 15-033-20331 ~~0000~~

LEASE NAME Haas

TYPE OR PRINT
NOTICE: Fill out completely
and return to Cons. Div.
office within 30 days.

WELL NUMBER 1

660 Ft. from S Section Line

660 Ft. from E Section Line

SEC. 19 TWP. 34 RGE. 17 ~~W34N~~(W)

COUNTY Commanche

LEASE OPERATOR JHL Energy

ADDRESS 1428 S. Lee Crest, Wichita, KS

PHONE#(316) 722-4563 OPERATORS LICENSE NO. 30313

Date Well Completed _____

Character of Well good

Plugging Commenced 2-13-98

(Oil, Gas, D&A, SWD, Input, Water Supply Well)

Plugging Completed 2-19-98

The plugging proposal was approved on 2-19-98 (date)

by Steve Middleton (KCC District Agent's Name).

Is ACO-1 filed? yes If not, is well log attached? yes

Producing Formation Miss Depth to Top 5238 Bottom 5254 T.D. 5276

Show depth and thickness of all water, oil and gas formations.

OIL, GAS OR WATER RECORDS

CASING RECORD

Formation	Content	From	To	Size	Put In	Pulled out
				8 5/8	472	None
				4 1/2	5276	43450

Describe in detail the manner in which the well was plugged, indicating where the mud fluid was placed and the method or methods used in introducing it into the hole. If cement or other plug were used, state the character of same and depth placed, from ___ feet to ___ feet each set. Lay down rods and tubing, sand well back to 5140, dump 45sx portland cement with dump bailor stretch and cut pipe at 3450, lay down casing, Allied pump 300 hulls, 10 jel, 50 cement, 10 jel, 100 hulls, 8 5/8 wiper plug, 150 cement, 60/40 6% jel

(If additional description is necessary, use BACK of this form.)

Name of Plugging Contractor Clarke Corporation License No. 5105

Address P.O. Box 187, Medicine Lodge, KS 67104

NAME OF PARTY RESPONSIBLE FOR PLUGGING FEES: JHL Energy Inc.

STATE OF Kansas COUNTY OF Barber, ss.

Alan Vratil (Employee of Operator) or (Operator)

above-described well, being first duly sworn on oath, says: That I have knowledge of the fact statements, and matters herein contained and the log of the above-described well as filed with the same are true and correct, so help me God.

(Signature) [Signature]

(Address) Medicine Lodge, KS 67104

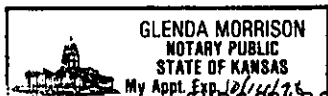

SUBSCRIBED AND SWORN TO before me this 11 day of March, 1998

[Signature]
Notary Public

My Commission Expires: 10/14/98

03-12-98 RCAP

IMPORTANT
Kans. Geo. Survey request
samples on this well.

KANSAS DRILLERS LOG

API No. 15 — 033 — 20,331
County Number

S. 19 T. 34S R. 17 W
Loc. C NE NE
County **COMANCHE**

Operator
George R. Jones

Address
Suite 1310, 125 N. Market, Wichita, KS 67202

Well No. _____ Lease Name
Haas

Footage Location
660 feet from (N) 24th line **660** feet from (E) 26th line

Principal Contractor
Gabbert-Jones, Inc. Geologist
George A. McCaleb

Spud Date
December 16, 1979 Total Depth
5850' P.B.T.D.
5276'

Date Completed
January 19, 1980 Oil Purchaser
shut in gas well

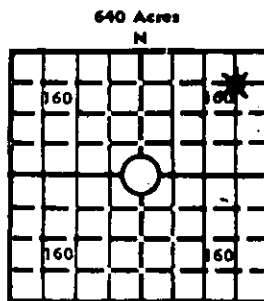

Locate well correctly
Elev.: Gr. **1849'**
1852' **1854'**
DF KB

CASING RECORD

Report of all strings set — surface, intermediate, production, etc.

Purpose of string	Size hole drilled	Size casing set (in O.D.)	Weight lbs/ft.	Setting depth	Type cement	Socks	Type and percent additives
Surface	12½"	8-5/8"	24#	472'	Regular Posmix	160	2% gel, 3% CC
				Basket @ 218' - 170'; Baffle Plate @ 140'	Regular Posmix	165	2% gel, 3% CC
Production	7-7/8"	4½"	10.5#	5345'	Regular Posmix	150	18% Salt 3/4 x 1% CER-2

LINER RECORD

(Preflushed w/20 bbls salt flush)
PERFORATION RECORD

Top, ft.	Bottom, ft.	Socks cement	Shots per ft.	Size & type	Depth interval
none			2		5238' - 5245'
TUBING RECORD			2		5250' - 5254'
Size	Setting depth	Pecker set at			
2-3/8"	5238'				

ACID, FRACTURE, SHOT, CEMENT SQUEEZE RECORD

Amount and kind of material used	Depth interval treated
2000 gal. MOD 202 nitro and acid	5238' - 5245'
DEC 29 1997	5250' - 5254'
CONSERVATION DIVISION WICHITA, KS	

INITIAL PRODUCTION

Date of first production
shut in Producing method (flowing, pumping, gas lift, etc.)
flowing

RATE OF PRODUCTION PER 24 HOURS
Oil **1 BOPD** Gas **4.0 Test** Water **10 BOPD** Gas-oil ratio
bbls. **indicated open** MCF **617,000/1** CFPB

Disposition of gas (vented, used on lease or sold)
shut in flow **2375 MCFD** Producing interval(s)
5238-5254

INSTRUCTIONS: As provided in KCC Rule 82-2-125, within 90 days after completion of a well, one completed copy of this Drillers Log shall be transmitted to the State Geological Survey of Kansas, 4150 Monroe Street, Wichita, Kansas 67209. Copies of this form are available from the Conservation Division, State Corporation Commission, 3830 So. Meridian (P.O. Box 17027), Wichita, Kansas 67217. Phone AC 316-522-2206. If confidential custody is desired, please note Rule 82-2-125. Drillers Logs will be on open file in the Oil and Gas Division, State Geological Survey of Kansas, Lawrence, Kansas 66044.

Operator

GEORGE R. JONES

DESIGNATE TYPE OF COMP.: OIL, GAS, DRY HOLE, SWDW, ETC.:

Gas

Well No.

1

Lease Name

HAAS

S 19 T 34S R 17 W

WELL LOG

Show all important zones of porosity and contents thereof; cored intervals, and all drill-stem tests, including depth interval tested, cushion used, time tool open, flowing and shut-in pressures, and recoveries.

SHOW GEOLOGICAL MARKERS, LOGS RUN, OR OTHER DESCRIPTIVE INFORMATION.

K.B. 1854'

FORMATION DESCRIPTION, CONTENTS, ETC.

TOP

BOTTOM

NAME

DEPTH

DST #1 5092' - 5165':
45" 45" 45" 60"
strong blow throughout test
rec. 1400' gas in pipe
135' GCM
355' muddy water
ifp 89# - 226#
icip 1828#
ffp 226# - 307#
fcip #1828
temp. 119°

Heebner 4281 (-2427)
Douglas 4349 (-2495)
L KC 4490 (-2636)
B/KC 5019 (-3165)
Marmaton 5059 (-3205)
Pawnee 5097 (-3243)
Ft. Scott 5127 (-3273)
Cherokee 5136 (-3282)
Miss. 5229 (-3375)
Viola 5795 (-3941)
LTD 5847 (-3993)

DST #2 5234' - 5310'
30" 45" 60" 60"
GTS 2"
1st opening gauged 577 MCF 10"
512 MCF 20"
485 MCF 30"

2nd opening gauged 577 MCF 10"
512 MCF 20"
499 MCF 40"
485 MCF 45"

stabilized at 485 MCF

Rec. 240' GCM; 360' GC muddy water
ifp 210# - 210#
icip 1892#
ffp 210# - 226#
fcip 1844#
temp. 118°

RECEIVED
KANSAS CORPORATION COMMISSION

DEC 29 1997

CONSERVATION DIVISION
WICHITA, KS

USE ADDITIONAL SHEETS, IF NECESSARY, TO COMPLETE WELL RECORD.

Date Received

Operator

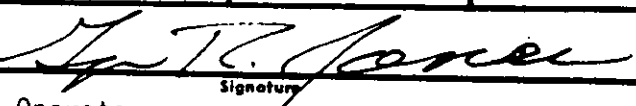

Signature

April 9, 1980

Title

Date

STATE KANSAS 4-3-76 MAP NO. _____ S-T-R 19-34S-17W WF
 OPER GEORGE R JONES SPOT C NE NE INIT _____
125 N MARKET WICHITA KS CO COMANCHE WF
 WELL 1 HAAS ELEV 1854 KB FIN _____
 CONTR GABBERT-JONES
 FIELD WC-UNNAMED-DISCOVERY

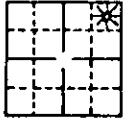

IP 4 PT CAOF 2443 MCFGPD, MISS 5238-54
API 15-033-20331 FR 12-17-79

SPUD 12-16-79, 8 5/8" @ 472 w/160 + 165
 DST 1 (PAW/F S/CHER) 5092-5165, op45, si45, op45,
 si45, 1400'GIP, Rec 135'GCM, 355'MCW, ISIP 1828,
 FP 89-~~266~~226-307, FSIP 1828, BHT 119
 DST 2 (MISS) 5234-5310, op30, si45, op60, si60, GTS/
 2", F 577 MCFG/10", decr F 485 MCFG/30", 2nd Op:
 F 577 MCFG/10", decr F 499 MCFG/40", Rec 240'GCM,
 360'G & MCW, ISIP 1892, FP 210-210/210-226, FSIP
 1844

RTD 5850, 4 1/2" @ 5345 w/150
 Perf (MISS) 9/5250-54, 14/5238-45, F 2,443 MCFG,
 Nat, SICP 1674, SITP 1670

4 PT CAOF 2,443 MCFGPD, MISS 5238-54 OA
COMPLETED 4-4-80

KB LOG TOPS:
 HEEBNER 4281 - 2427
 DOUGLAS 4349 - 2495
 LANSING KANSAS CITY 4490 - 2636
 B/KANSAS CITY 5019 - 3165
 MARMATON 5059 - 3205
 PAWNEE 5097 - 3243
 FORT SCOTT 5127 - 3273
 CHEROKEE 5136 - 3282
 MISS 5229 - 3375
 VIOLA 5795 - 3941
 LTD 5847 - 3993

Petroleum Information Corporation
 A Subsidiary of A. C. Nielsen Company

©Copyrighted 1980 Reproduction Prohibited

(CON'D)

MISS - UNNAMED FIELD - DISCOVERY

RTD 5850 - 3996
 TD IN MISS

4-3-76

COMP ISSUED 4-15-80

RECEIVED
 KANSAS CORPORATION COMMISSION

DEC 29 1997

CONSERVATION DIVISION
 WICHITA, KS

15-033-20331

DATA SHEET FOR LOG ANALYSIS											
COMPANY <u>Geo. R. Jones</u>						DATE <u>1-9-80</u>					
WELL <u>HAAS #1</u>			COUNTY <u>Comanche</u>			BY <u>GASKILL - S. MAYERS</u>					
Sec <u>19</u> Twp <u>34</u> Rge <u>17</u>											
DEPTH	ϕ_N	D_D	S_{og}	D_g	V_m	n/m	R_w	R_T	ϕ	S_w	REMARKS
4806- 10	10	2.60		2.71		2.0/ 2.0	.055	25	9.5	46	R.C.
5098- 5100	10	2.67				2.0/ 2.0	.055	22	7	68	PAWNEE
5100- 02	8	2.67						25	6	75	
02- 04	9	2.63						30	7.5	55	
04- 06	9.5	2.55						25	9.5	47	
5220- 32	4	2.64	1			2.0/ 2.0	.05	110	4	52	Miss.
32- 34	5	2.61	9					90	5.5	43	
34- 36	6	2.59	9					115	6.5	32	
36- 38	8.5	2.54	9					60	9.5	31	
38- 40	11	2.54						100	10.5	21	
40- 42	13	2.52	9					100	12	18	
42-											

RECEIVED
KANSAS CORPORATION COMMISSION

DEC 29 1997

CONSERVATION DIVISION
WICHITA, KS

Petro-Log

Compensated Density

COMPANY GEORGE R. JONES

15-033-20331

WELL HAAS #1

FIELD _____

COUNTY COMANCHE STATE KANSAS

Location C-NE/4-NE/4
 Sec. 19 Twp. 34S Rge. 17W

Other Services:
RAG

Permanent Datum: GROUND LEVEL Elev. 1849
 Log Measured From K.B., 5 Ft. Above Perm. Datum
 Drilling Measured From KELLY BUSHING

Elev.: K.B. 1854
D.F. 1852
G.L. 1849

		RECEIVED			
		KANSAS CORPORATION COMMISSION			
Date	1/9/80	DEC 29 1997			
Run No.	ONE	CONSERVATION DIVISION			
Depth—Driller	5850	WICHITA, KS			
Depth—Logger	5845				
Btm. Log Inter.	5844				
Top Log Inter.	4200				
Casing—Driller	8 5/8 @ 475				
Casing—Logger					
Bit Size	7 7/8				
Type Fluid in Hole	STARCH				
Dens. Visc.	9.3 43				
pH Fluid Loss	10.0 16.4 ml				
Source of Sample	FLOWLINE				
R ₁ @ Meas. Temp.	.36 @ 66 °F	@ °F	@ °F	@ °F	@ °F
R ₂ @ Meas. Temp.	.27 @ 66 °F	@ °F	@ °F	@ °F	@ °F
R ₃ @ Meas. Temp.	.54 @ 66 °F	@ °F	@ °F	@ °F	@ °F
Source: R ₁ R ₂ R ₃	CHARTS	@ °F	@ °F	@ °F	@ °F
R ₄ @ BHT	.179 @ 133 °F	@ °F	@ °F	@ °F	@ °F
Time Since Circ.	6 HOURS	@ °F	@ °F	@ °F	@ °F
Max. Rec. Temp.	133 °F	@ °F	@ °F	@ °F	@ °F
Equip. Location	H-3 GB	@ °F	@ °F	@ °F	@ °F
Recorded By	S. MAYERS AND GASKILL	@ °F	@ °F	@ °F	@ °F
Witnessed By	MR. MC CALEB	@ °F	@ °F	@ °F	@ °F

Netro-Log

Correlation Log

RECEIVED

KANSAS CORPORATION COMMISSION

COMPANY GEO. R. JONES

15-083-20331

DEC 29 1997

WELL HABS #1

CONSERVATION DIVISION
WICHITA KS

FIELD

COUNTY COMANCHE

STATE KANSAS

Location L-NE1/4-NE1/4

Other Services:

PERF.

Sec. 19 Twp. 34S Rge. 17E

Permanent Datum: Ground Level Elev. 1349
Log Measured From K.B. Ft. Above Perm. Datum
Drilling Measured From K.B.

Elev.: K.B. 1554
D.F. 1812
G.L. 1549

Date	<u>1-27-50</u>		
Run No.	<u>ONE</u>		
Depth-Driller	<u>5276</u>		
Depth-Logger	<u>5276</u>		
Run Log Inter.	<u>5275</u>		
Top Log Inter.	<u>5275</u>		
Casing-Driller	<u>10 1/2 4" @ 5845</u>		
Casing-Logger			
Bit Size	<u>7 7/8</u>		
Type Fluid in Hole	<u>WATER</u>		
Dens.	Visc.		
pH	Fluid Loss	ml	ml
Source of Sample			
R ₁ @ Meas. Temp.			
R ₂ @ Meas. Temp.			
R ₃ @ Meas. Temp.			
Source: Reat	Reat		
R ₁ @ BHT			
Time Since Circ.			
Max. Ret. Temp.			
Equip. Location	<u>H-6 G8</u>		
Recorded By	<u>CURT PABLEY</u>		
Witnessed By	<u>GEO. R. JONES</u>		

Petru-Log

Radiation Guard Log

COMPANY GEORGE R. JONES

15-033-2033/

WELL HAAS #1

FIELD _____

COUNTY COMANCHE

STATE KANSAS

Location C-NE/4-NE/4

Other Services:

CDL

Sec. 19 Twp. 34S Rge. 17W

Permanent Datum: GROUND LEVEL Elev. 1849
 Log Measured From K.B. 5 Ft. Above Perm. Datum
 Drilling Measured From KELLY BUSHING

Elev.: K.B. 1854
D.F. 1852
G.L. 1849

Date		1/9/80		RECEIVED KANSAS CORPORATION COMMISSION			
Run No.	ONE						
Depth-Driller	5850						
Depth-Logger	5847						
Btm. Log Inter.	5846						
Top Log Inter.	SURF.						
Casing-Driller	8 5/8 @ 475						
Casing-Logger							
Bit Size	7 7/8						
Type Fluid in Hole	STARCH						
Dens.	9.3	43					
pH	10.0	16.4 ml		ml		ml	ml
Source of Sample	FLOWLINE						
R ₁ @ Meas. Temp.	.36	@ 66°F	@ °F	@ °F	@ °F	@ °F	@ °F
R ₂ @ Meas. Temp.	.27	@ 66°F	@ °F	@ °F	@ °F	@ °F	@ °F
R ₃ @ Meas. Temp.	.54	@ 66°F	@ °F	@ °F	@ °F	@ °F	@ °F
Source: R ₁ R ₂ R ₃	CHARTS						
R ₁ @ BHT	.179	@ 133°F	@ °F	@ °F	@ °F	@ °F	@ °F
Time Since Circ.	3 HOURS						
Max. Rec. Temp.	133°F						
Equip. Location	H-3	GB					
Recorded By	S. MAYERS AND GASKILL						
Witnessed By	MR. MC CALBERT						