

FOR KCC USE:

FORM C-1 7/91

EFFECTIVE DATE: 11-4-91

API # 15-101-21,605-0000

FORM MUST BE TYPED

DISTRICT # 1

State of Kansas

FORM MUST BE SIGNED

SEAT... Yes No

CORRECTION NOTICE OF INTENTION TO DRILL CORRECTION *

ALL BLANKS MUST BE FILLED

Must be approved by the K.C.C. five (5) days prior to commencing well

* Spot

Expected Spud Date November 15, 1991
month day year

N/2 .. SE .. SW .. Sec 3 .. Twp 19 .. S, Rg 29 .. East
 West

OPERATOR: License # 6484
Name: Anderson Energy, Inc.
Address: 200 E. First St., Suite 414
City/State/Zip: Wichita, KS 67202
Contact Person: William L. Anderson
Phone: (316) 265-7929

990 feet from South / North Line of Section
1980 feet from East / West line of Section

IS SECTION REGULAR IRREGULAR?
(NOTE: Locate well on the Section Plat on Reverse Side)

CONTRACTOR: License #: 5420
Name: White & Ellis Drilling, Inc.

County: Lane
Lease Name: McWhirter Well #: T
Field Name: McWhirter

Well Drilled For: Well Class: Type Equipment:
 Oil Enh Rec Infield Mud Rotary
 Gas Storage Pool Ext. Air Rotary
 OWO Disposal Wildcat Cable
 Seismic: # of Holes Other

Is this a Prorated/Spaced Field? yes no
Target Formation(s): Lansing-KC

If OWO: old well information as follows:
Operator: _____
Well Name: _____
Comp. Date: _____ Old Total Depth _____

Nearest lease or unit boundary: 990'
Ground Surface Elevation: 2819' est. feet MSL
Water well within one-quarter mile: yes no

Directional, Deviated or Horizontal wellbore? yes no
If yes, true vertical depth: _____
Bottom Hole Location: _____

Public water supply well within one mile: yes no
Depth to bottom of fresh water: 100'
Depth to bottom of usable water: 1370'

WAS: NW SE SW; 1650 FWL

AFFIDAVIT 15; N/2 SE SW; 1980 FWL

The undersigned hereby affirms that the drilling, completion and eventual plugging of this well will comply with K.S.A. 55-101, et. seq.
It is agreed that the following minimum requirements will be met:

Surface Pipe by Alternate: 1 2
Length of Surface Pipe Planned to be set: 200'
Length of Conductor pipe required: N/A

1. Notify the appropriate district office prior to spudding of well;
2. A copy of the approved notice of intent to drill shall be posted on each drilling rig;
3. The minimum amount of surface pipe as specified below shall be set by circulating cement to the top; in all cases surface pipe shall be set through all unconsolidated materials plus a minimum of 20 feet into the underlying formation;
4. If the well is dry hole, an agreement between the operator and the district office on plug length and placement is necessary prior to plugging;
5. The appropriate district office will be notified before well is either plugged or production casing is cemented in;
6. IF AN ALTERNATE II COMPLETION, PRODUCTION PIPE SHALL BE CEMENTED FROM BELOW ANY USABLE WATER TO SURFACE WITHIN 120 DAYS OF SPUD DATE. IN ALL CASES, NOTIFY DISTRICT OFFICE PRIOR TO ANY CEMENTING.

I hereby certify that the statements made herein are true and to the best of my knowledge and belief.
Date: 11/7/91 Signature of Operator or Agent: William L. Anderson Title: Secy-Treas.

Projected Total Depth: 4650'
Formation at Total Depth: Mississippian
Water Source for Drilling Operations:
 well farm pond other

DWR Permit #: _____
Will Cores Be Taken? yes no
If yes, proposed zone: _____

FOR KCC USE:
API # 15- 101-21,605-0000
Conductor pipe required None feet
Minimum surface pipe required 200 feet per Alt. 2
Approved by: WLA 11-15-91; 10-30-91/eng
This authorization expires: 4-30-92
(This authorization void if drilling not started within 6 months of effective date.)
Spud date: _____ Agent: _____

RECEIVED
STATE CORPORATION COMMISSION
11-8-91
NOV 8 1991
CONSERVATION DIVISION
Wichita, Kansas

REMEMBER TO:

- File Drill Pit Application (form CDP-1) with Intent to Drill;
- File Completion Form ACO-1 within 120 days of spud date;
- File acreage attribution plat according to field proration orders;
- Notify appropriate district office 48 hours prior to workover or re-entry;
- Submit plugging report (CP-4) after plugging is completed;
- Obtain written approval before disposing or injecting salt water.

Mail to: Conservation Division, 200 Colorado Derby Building, 202 W. First St., Wichita, Kansas 67202-1286.

3
19
MBP

IN ALL CASES PLOT THE INTENDED WELL ON THE PLAT BELOW.

PLAT OF ACREAGE ATTRIBUTABLE TO A WELL IN A PRORATED OR SPACED FIELD

If the intended well is in a prorated or spaced field, please fully complete this side of the form. If the intended well is in a prorated or spaced field complete the plat below showing that the well will be properly located in relationship to other wells producing from the common source of supply. Please show all the wells within 1 mile of the boundaries of the proposed acreage attribution unit for gas wells and within 1/2 mile of the boundaries of the proposed acreage attribution unit for oil wells.

API NO. 15- _____
 OPERATOR _____
 LEASE _____
 WELL NUMBER _____
 FIELD _____

LOCATION OF WELL: COUNTY _____
 _____ feet from south/north line of section
 _____ feet from east/west line of section
 SECTION _____ TWP _____ RG _____

NUMBER OF ACRES ATTRIBUTABLE TO WELL _____
 QTR/QTR/QTR OF ACREAGE _____

IS SECTION _____ REGULAR or _____ IRREGULAR
IF SECTION IS IRREGULAR, LOCATE WELL FROM NEAREST CORNER BOUNDARY.

Section corner used: _____ NE _____ NW _____ SE _____ SW

PLAT

(Show location of the well and shade attributable acreage for prorated or spaced wells.)
 (Show footage to the nearest lease or unit boundary line.)

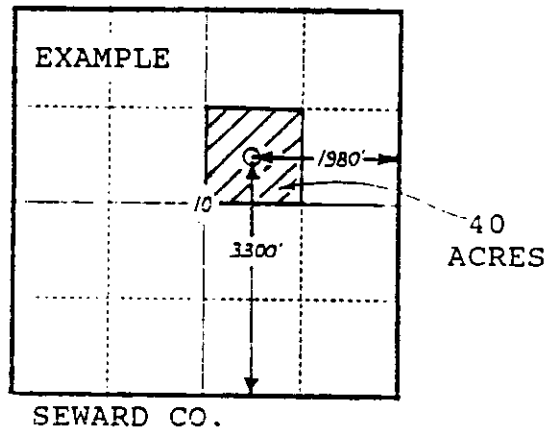
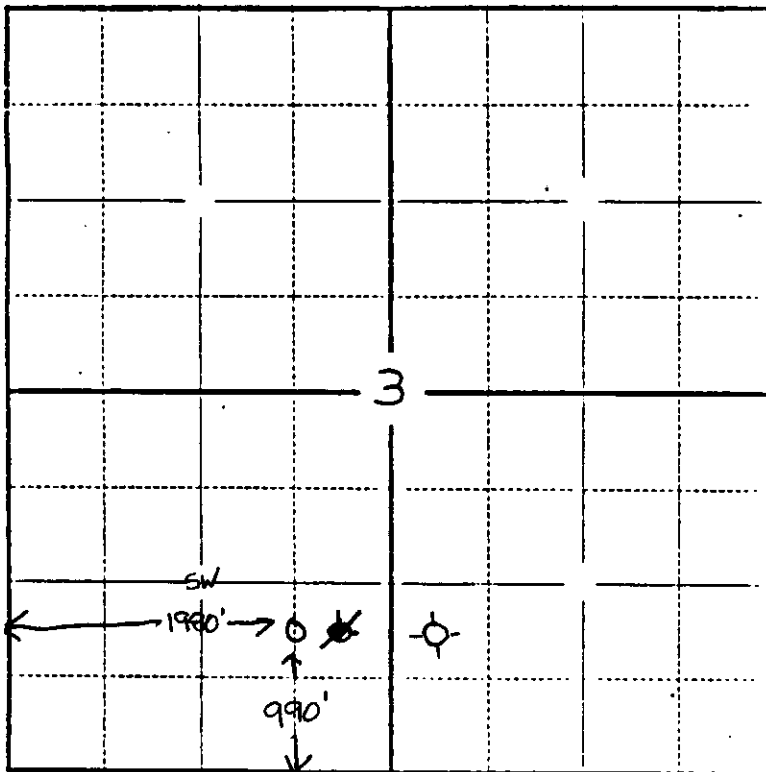

In plotting the proposed location of the well, you must show:

- 1) The manner in which you are using the depicted plat by identifying section lines, i.e. 1 section, 1 section with 8 surrounding sections, 4 sections, etc.;
- 2) the distance of the proposed drilling location from the section's south/north and east/west lines; and
- 3) the distance to the nearest lease or unit boundary line.