

15491-00553-0000

STATE OF KANSAS
STATE CORPORATION COMMISSION

Form CP-4

Give All Information Completely
Make Required Affidavit
Mail or Deliver Report to:
Conservation Division
State Corporation Commission
212 No. Market
Wichita, Kansas 67202

WELL PLUGGING RECORD

SUMNER County, Sec. 8 Twp. 30s Rge. 1 (E) (XW)

Location as "NE/CNW/SE" or footage from lines SW SE SE

Lease Owner PETROLEUM, INC.,

Lease Name FORNEY Well No. 1

Office Address R.R. #2, GREAT BEND, KANSAS

Character of Well (completed as Oil, Gas or Dry Hole) OIL & CONVERTED TO DISPOSAL

Date well completed FEB. 20 1959

Application for plugging filed FEB. 28 1973

Application for plugging approved MARCH 1 1973

Plugging commenced APRIL 16 1973

Plugging completed APRIL 19 1973

Reason for abandonment of well or producing formation DEPLETION OF PRODUCING ZONE

If a producing well is abandoned, date of last production DECEMBER 19 71

Was permission obtained from the Conservation Division or its agents before plugging was commenced? YES

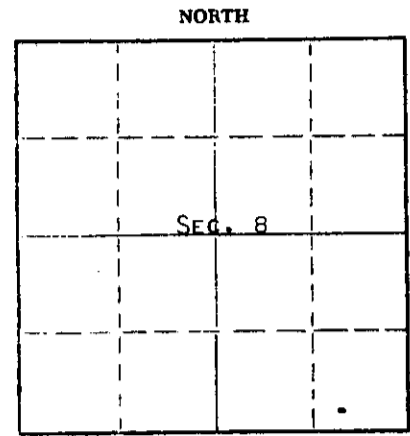

Locate well correctly on above Section Plat

Name of Conservation Agent who supervised plugging of this well EUGENE GRAHAM

Producing formation _____ Depth to top _____ Bottom _____ Total Depth of Well 3779 Feet

Show depth and thickness of all water, oil and gas formations.

OIL, GAS OR WATER RECORDS

CASING RECORD

FORMATION	CONTENT	FROM	TO	SIZE	PUT IN	PULLED OUT
				8-5/8"	206'	NONE
				5-1/2"	3776'	2315'

Describe in detail the manner in which the well was plugged, indicating where the mud fluid was placed and the method or methods used in introducing it into the hole. If cement or other plugs were used, state the character of same and depth placed, from _____ feet to _____ feet for each plug set.

PLUGGED BACK TD @ 3640', DUMPED 40 FT. OF SAND AND 5 SACKS CEMENT.
HALLIBURTON SQUEEZED WELL WITH 25 SACKS CEMENT, 3 SACKS GEL AND 10
SACKS CEMENT TO BASE OF WELL CELLAR

RECEIVED
STATE CORPORATION COMMISSION
APR 25 1973
CONSERVATION DIVISION
Wichita, Kansas

(If additional description is necessary, use BACK of this sheet)

Name of Plugging Contractor ROCKHOLD ENGINEERING, INC.,

Address BOX 698, GREAT BEND, KANSAS

STATE OF KANSAS, COUNTY OF BARTON, ss.

MONTE CHADD (employee of owner) or (owner/operator) of the above-described

well, being first duly sworn on oath, says: That I have knowledge of the facts, statements, and matters herein contained and the log of the above-described well is filed and that the same are true and correct. So help me God. MONTE CHADD, DIST. PROD. SUPT.

(Signature) Monte Chadd

R.R. #2, GREAT BEND, KANSAS (Address)

Subscribed and sworn to before me this 23 day of APRIL, 1973

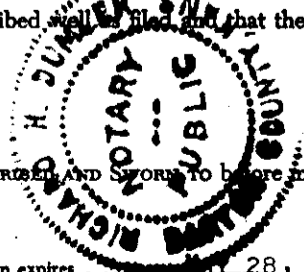

My commission expires 28, 1973

Richard H. Dumber
Notary Public.

WELL LOG

15-191-00553-0900

COMPANY **PETROLEUM, INCORPORATED**

SEC. 8 T. 30S. 1E

FARM **FORNEY**

NO. 1

LOC. **SW, SESE**

TOTAL DEPTH **3779'**

COUNTY **SUMNER CO., KANSAS**

COMM. **January 19, 1959**

COMP. **February 5, 1959**

CONTRACTOR **GARVEY DRILLING COMPANY**

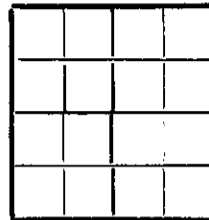

CASING **8 5/8" @ 200' W/250 sax.
5 1/2" @ 3776' W/75 sax.**

ELEVATION **1245' DF**

PRODUCTION **Simpson**

FIGURES INDICATE BOTTOM OF FORMATIONS

75	Surface soil & sand
165	Shale & gyp
200	Shale & shells
390	Line
650	Line & shale
840	Line
1085	Line & shale
1460	Shale w/line streaks
1915	Shale
2287	Shale & line
2425	Line & shale
2575	Sand & shale
2835	Shale & line
3182	Line
3345	Line & shale
3350	Chert
3393	Chert & line
3775	Line & shale
3779	Sand
3779	T. D.

RECEIVED
STATE CORPORATION COMMISSION
APR 25 1973
CONSERVATION DIVISION
Wichita, Kansas

State of KANSAS)
County of BARTON) ss:

I, VERNE A. MORRIS of GARVEY DRILLING COMPANY

upon oath state that the above and foregoing is a true and correct copy of the log of the #1 FORNEY well

Subscribed and sworn to before me this 3rd day of MARCH 19 59

My Commission Expires: July 11, 1960

Verne A. Morris
[Signature]
NOTARY PUBLIC