

STATE OF KANSAS  
STATE CORPORATION COMMISSION

15-101-20271-0000

WELL PLUGGING RECORD

Give All Information Completely  
Make Required Affidavit  
Mail or Deliver Report to  
Conservation Division  
State Corporation Comm.  
245 North Water  
Wichita, KS 67202

Lane \_\_\_\_\_ County. Sec. 13 Twp. 19S Rge. 29 E/W  
Location as "NE/CNW/SW" or footage from lines  
150' SE of C NW NE  
Lease Owner A. L. Abercrombie, Inc.  
Lease Name VOSHELL Well No. 2  
Office Address 801 Union Center, Wichita, Kansas 67202  
Character of Well (Completed as Oil, Gas or Dry Hole) \_\_\_\_\_  
Dry Hole

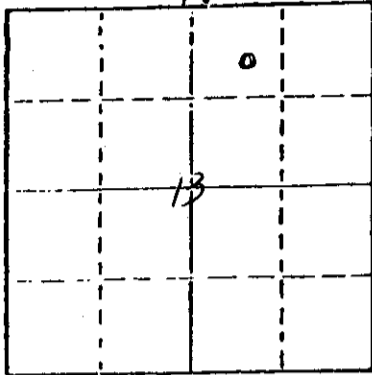

Locate well correctly on above  
Section Plat

Date Well completed Dec. 18, 1977  
Application for plugging filed (verbally) Dec. 18, 1977  
Application for plugging approved (verbally) Dec. 18, 1977  
Plugging commenced Dec. 18, 1977  
Plugging completed Dec. 18, 1977  
Reason for abandonment of well or producing formation \_\_\_\_\_  
No commercial quantity of oil or gas encountered  
If a producing well is abandoned, date of last production \_\_\_\_\_  
19

Was permission obtained from the Conservation Division or  
its agents before plugging was commenced? Yes

Name of Conservation Agent who supervised plugging of this well Leo Massey  
Producing formation \_\_\_\_\_ Depth to top \_\_\_\_\_ Bottom \_\_\_\_\_ Total Depth of Well 4690  
Show depth and thickness of all water, oil and gas formations.

OIL, GAS OR WATER RECORDS

CASING RECORD

| FORMATION | CONTENT | FROM | TO | SIZE | PUT IN | PULLED OUT |
|-----------|---------|------|----|------|--------|------------|
|           |         |      |    |      |        |            |
|           |         |      |    |      |        |            |
|           |         |      |    |      |        |            |
|           |         |      |    |      |        |            |
|           |         |      |    |      |        |            |

Describe in detail the manner in which the well was plugged, indicating where the mud fluid  
was placed and the method or methods used in introducing it into the hold. If cement or other  
plugs were used, state the character of same and depth placed, from \_\_\_\_\_ feet to  
\_\_\_\_\_ feet for each plug set.

RECEIVED  
STATE CORPORATION COMMISSION

JAN 19 1978  
1-19-78  
CONSERVATION DIVISION  
Wichita, Kansas

Set 1st plug at 900' with 70 sacks  
2nd plug at 240' with 20 sacks  
40' solid bridge with 10 sacks  
Plug was down at 11:30 a.m., December 18, 1977

(If additional description is necessary, use BACK of this sheet)

Name of Plugging Contractor Abercrombie Drilling, Inc.

STATE OF Kansas COUNTY OF Sedgwick, ss.

Jack L. Partridge, Ass't. Secretary-Treasurer (employee of owner) or (owner or operator)  
of the above-described well, being first duly sworn on oath, says: That I have knowledge of  
the facts, statements, and matters herein contained and the log of the above-described well  
as filed and that the same are true and correct. So help me God.

(Signature) Jack L. Partridge  
801 Union Center, Wichita, Kansas 67202  
(Address)

SUBSCRIBED AND SWORN TO before me this 18th day of January, 1978

NOTARY PUBLIC  
My commission expires July 21, 1979

Sandra Richman  
Sandra Richman Notary Public.

**KANSAS DRILLERS LOG**

S. 13 T. 19S R. 29 <sup>1</sup>/<sub>4</sub> W

API No. 15 — 101 — 20271-0000  
County Number

Loc. 150' SE of C NW NE

County Lane

Operator  
**A. L. Abercrombie, Inc.**

Address  
**801 Union Center, Wichita, Kansas 67202**

Well No. 2 Lease Name VOSHELL

Footage Location  
feet from (N) (S) line feet from (E) (W) line

Principal Contractor **Abercrombie Drilling, Inc.** Geologist **Orlin Phelps**

Spud Date **December 9, 1977** Total Depth **4690** P.B.T.D.

Date Completed **December 18, 1977** Oil Purchaser **None**

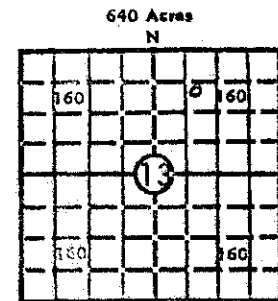

Locate well correctly  
 Elev. Gr. **2803**

DF **2805** KB **2808**

**CASING RECORD**

Report of all strings set — surface, intermediate, production, etc.

| Purpose of string | Size hole drilled | Size casing set (in O.D.) | Weight lbs/ft. | Setting depth | Type cement | Sacks | Type and percent additives |
|-------------------|-------------------|---------------------------|----------------|---------------|-------------|-------|----------------------------|
| Surface           | 12 1/4"           | 8-5/8"                    | 28#            | 244.14'       | Common      | 190   | 2% gel<br>3% CaCl          |
|                   |                   |                           |                |               |             |       |                            |
|                   |                   |                           |                |               |             |       |                            |
|                   |                   |                           |                |               |             |       |                            |

**LINER RECORD**

**PERFORATION RECORD**

| Top, ft. | Bottom, ft. | Sacks cement | Shots per ft. | Size & type | Depth interval |
|----------|-------------|--------------|---------------|-------------|----------------|
|          |             |              |               |             |                |
|          |             |              |               |             |                |
|          |             |              |               |             |                |

**TUBING RECORD**

| Size | Setting depth | Packer set at |
|------|---------------|---------------|
|      |               |               |
|      |               |               |

**ACID, FRACTURE, SHOT, CEMENT SQUEEZE RECORD**

| Amount and kind of material used   | Depth interval treated |
|--|------------------------|
| <p>RECEIVED<br/>                 STATE CORPORATION COMMISSION<br/>                 JAN 19 1978<br/>                 CONSERVATION DIVISION<br/>                 Wichita, Kansas</p> |                        |
|  |                        |

**INITIAL PRODUCTION**

|  |       |   |                       |               |      |
|--|-------|---|-----------------------|---------------|------|
| Date of first production                           |       | Producing method (flowing, pumping, gas lift, etc.) |                       |               |      |
| RATE OF PRODUCTION PER 24 HOURS                    | Oil   | Gas   | Water                 | Gas-oil ratio | CFPB |
|  | bbis. | MCF   | bbis.                 |               |      |
| Disposition of gas (vented, used on lease or sold) |       |   | Producing interval(s) |               |      |

INSTRUCTIONS: As provided in KCC Rule 82-2-125, within 90 days after completion of a well, one completed copy of this Drillers Log shall be transmitted to the State Geological Survey of Kansas, 4150 Monroe Street, Wichita, Kansas 67209. Copies of this form are available from the Conservation Division, State Corporation Commission, 3830 So. Meridian (P.O. Box 17027), Wichita, Kansas 66217. Phone AC 316-522-2206. If confidential custody is desired, please note Rule 82-2-125. Drillers Logs will be on open file in the Oil and Gas Division, State Geological Survey of Kansas, Lawrence, Kansas 66044.

Operator  
A. L. Abercrombie, Inc.

DESIGNATE TYPE OF COMP.: OIL, GAS,  
DRY HOLE, SWDW, ETC.:  
Dry Hole

Well No. 2 Lease Name VOSHELL

s 13 T 19S R 29 <sup>EX</sup> W

**WELL LOG**

Show all important zones of porosity and contents thereof; cored intervals, and all drill-stem tests, including depth interval tested, cushion used, time tool open, flowing and shut-in pressures, and recoveries.

SHOW GEOLOGICAL MARKERS, LOGS RUN, OR OTHER DESCRIPTIVE INFORMATION.

| FORMATION DESCRIPTION, CONTENTS, ETC.  | TOP  | BOTTOM | NAME  | DEPTH  |
|--|------|--------|---|--|
| DST#1 (4083-4099) 30", 60", 90", 60".<br>Recovered 65' oil, 120' water.<br>IFP 32-43, IBHP 991, FFP 65-86, FBHP 938.<br>Temp. 124.                     |      |        | SAMPLE TOPS:  |  |
| DST#2 (4229-4254) 30", 30", 30", 30".<br>Recovered 5' mud with show of oil. Weak<br>blow 25".<br>IFP 11-11, IBHP 54, FFP 11-11, FBHP 43.<br>Temp. 120. |      |        | Anhydrite<br>B/Anhydrite<br>Heebner<br>Toronto<br>Lansing<br>B/KC | 2138 (+ 662)<br>2170 (+ 638)<br>3961 (-1153)<br>3974 (-1166)<br>4001 (-1193)<br>4397 (-1589) |
| DST#3 (4338-4350) 30", 60", 60", 60".<br>Recovered 1993' salt water. No shows.<br>IFP 86-562, IBHP 1195, FFP 626-916,<br>FBHP 1205. Temp. 132.         |      |        | ELECTRIC LOG TOPS:  |  |
| Rock & shale   | 0    | 70     | Anhydrite   | 2138 (+ 670)   |
| Sand & shale   | 70   | 2137   | B/Anhydrite   | 2166 (+ 642)   |
| Anhydrite  | 2137 | 2170   | Heebner   | 3959 (-1151)   |
| Sand & shale   | 2170 | 2551   | Toronto   | 3970 (-1162)   |
| Shale & shells   | 2551 | 3150   | Lansing   | 4000 (-1192)   |
| Shale & lime   | 3150 | 3703   | Stark Shale   | 4290 (-1482)   |
| Lime & shale   | 3703 | 4234   | B/KC  | 4392 (-1584)   |
| Lime   | 4234 | 4318   | Marmaton  | 4415 (-1607)   |
| Lime & shale   | 4318 | 4350   | Pawnee  | 4497 (-1689)   |
| Lime   | 4350 | 4690   | Fort Scott  | 4543 (-1635)   |
| Rotary Total Depth   |      | 4690   | Cher. Shale   | 4567 (-1759)   |
|  |      |        | Mississippi   | 4640 (-1832)   |
|  |      |        | ELTD  | 4690 (-1882)   |
|  |      |        | RTD   | 4690 (-1882)   |

RECEIVED  
STATE CORPORATION COMMISSION  
JAN 19 1978  
CONSERVATION DIVISION  
Wichita, Kansas

USE ADDITIONAL SHEETS, IF NECESSARY, TO COMPLETE WELL RECORD.

Date Received

*Jack L. Partridge*  
Signature  
Jack L. Partridge, Ass't. Secretary-Treasurer  
Title  
January 18, 1978  
Date