

EFFECTIVE DATE: 3-25-2001

State of Kansas

NOTICE OF INTENTION TO DRILL

DISTRICT # 2

Must be approved by the K.C.C. five (5) days prior to commencing well.

SGA? Yes No

Center of
NW - SW - NE - Sec 2 Twp 31S, Rg 7W East
West

Expected Spud Date Jan 26, 2001
month day year

1650 FNL feet from South North line of Section
2310 FEL feet from East / West line of Section
IS SECTION REGULAR IRREGULAR?

OPERATOR: License # 6236
Name: MTM Petroleum, Inc.
Address: P.O. Box 82
City/State/Zip: Spivey KS 67142-0082
Contact Person: Marvin A. Miller
Phone: 316-532-3794

(NOTE: Locate well on the Section Plat on Reverse Side)
County: Harper
Lease Name: Oscar Smith Well #: 3
Field Name: Maple Grove South

CONTRACTOR: License # 5123
Name: Pickrell Drilling Co., Inc.

Is this a Prorated/Spaced Field? yes no
Target Formation(s): Mississippi
Nearest lease or unit boundary: 330'

Well Drilled For: Well Class: Type Equipment:

Ground Surface Elevation: 1587' feet NSI
Water well within one-quarter mile: yes no
Public water supply well within one mile: yes no

- Oil ... Enh Rec Infield Mud Rotary
- Gas ... Storage ... Pool Ext. Air Rotary
- OWWO ... Disposal ... Wildcat Cable
- Seismic; ... # of Holes ... Other
- Other

Depth to bottom of fresh water: 80'
Depth to bottom of usable water: 180'

If OWWO: old well information as follows:

Operator:
Well Name:
Comp. Date: Old Total Depth

Surface Pipe by Alternate: 1 / 2
Length of Surface Pipe Planned to be set: 235
Length of Conductor pipe required: N/A

Projected Total Depth: 4400'
Formation at Total Depth: Mississippi
Water Source for Drilling Operations:
... well farm pond other

Directional, Deviated or Horizontal wellbore? yes no
If yes, true vertical depth:
Bottom Hole Location:

Will Cores Be Taken? yes no
If yes, proposed zone:

AFFIDAVIT

The undersigned hereby affirms that the drilling, completion and eventual plugging of this well will comply with K.S.A. 55-101, et. seq.

It is agreed that the following minimum requirements will be met:

1. Notify the appropriate district office prior to spudding of well;
2. A copy of the approved notice of intent to drill shall be posted on each drilling rig;
3. The minimum amount of surface pipe as specified below shall be set by circulating cement to the top; in all cases surface pipe shall be set through all unconsolidated materials plus a minimum of 20 feet into the underlying formation;
4. If the well is dry hole, an agreement between the operator and the district office on plug length and placement is necessary prior to plugging;
5. The appropriate district office will be notified before well is either plugged or production casing is cemented in;
6. IF AN ALTERNATE IS COMPLETION, PRODUCTION PIPE SHALL BE CEMENTED FROM BELOW ANY USABLE WATER TO SURFACE WITHIN 120 DAYS OF SPUD DATE. IN ALL CASES, NOTIFY DISTRICT OFFICE PRIOR TO ANY CEMENTING.

I hereby certify that the statements made herein are true and to the best of my knowledge and belief.

Date: 1-19-01 Signature of Operator or Agent: Marvin A. Miller Title: Owner/Operator

FOR KCC USE: 077-21394-0000
 API # 15- 077-21394-0000
 Conductor pipe required NONE feet
 Minimum surface pipe required 200 feet per Alt. (1)
 Approved by: JK 3-20-2001
 This authorization expires: 9-20-2001
 (This authorization void if drilling not started within 6 months of effective date.)
 Spud date: _____ Agent: _____

REMEMBER TO:

- File Drill Pit Application (form COP-1) with Intent to Drill;
- File Completion Form ACO-1 within 120 days of spud date;
- File acreage attribution plat according to field proration orders;
- Notify appropriate district office 48 hours prior to workover or re-entry;
- Submit plugging report (CP-4) after plugging is completed;
- Obtain written approval before disposing or injecting salt water.

Mail to: KCC - Conservation Division, 130 S. Market - Room 2078, Wichita, Kansas 67202

RECEIVED
 KANSAS CORPORATION COMMISSION
 JAN 22 2001
 1-22-01
 CONSERVATION DIVISION

IN ALL CASES PLOT THE INTENDED WELL ON THE PLAT BELOW

PLAT OF ACREAGE ATTRIBUTABLE TO A WELL IN A PRORATED OR SPACED FIELD

If the intended well is in a prorated or spaced field, please fully complete this side of the form. If the intended well is in a prorated or spaced field complete the plat below showing that the well will be properly located in relationship to other wells producing from the common source of supply. Please show all the wells within 1 mile of the boundaries of the proposed acreage attribution unit for gas wells and within 1/2 mile of the boundaries of the proposed acreage attribution unit for oil wells.

API NO. 15- _____
 OPERATOR _____ LOCATION OF WELL: COUNTY _____
 LEASE _____ feet from south/north line of section _____
 WELL NUMBER _____ feet from east/west line of section _____
 FIELD _____ SECTION _____ TWP _____ RG _____

NUMBER OF ACRES ATTRIBUTABLE TO WELL _____ IS SECTION _____ REGULAR or _____ IRREGULAR
 QTR/QTR/QTR OF ACREAGE _____ IF SECTION IS IRREGULAR, LOCATE WELL FROM NEAREST
CORNER BOUNDARY.

Section corner used: _____ NE _____ NW _____ SE _____ SW

PLAT

(Show location of the well and shade attributable acreage for prorated or spaced wells.)

(Show footage to the nearest lease or unit boundary line.)

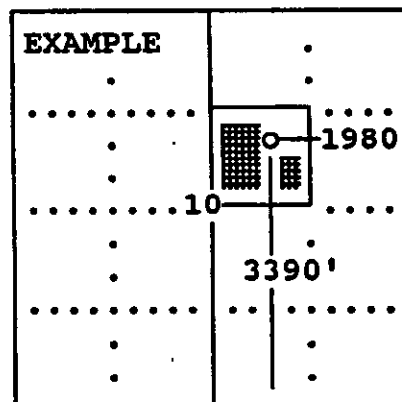
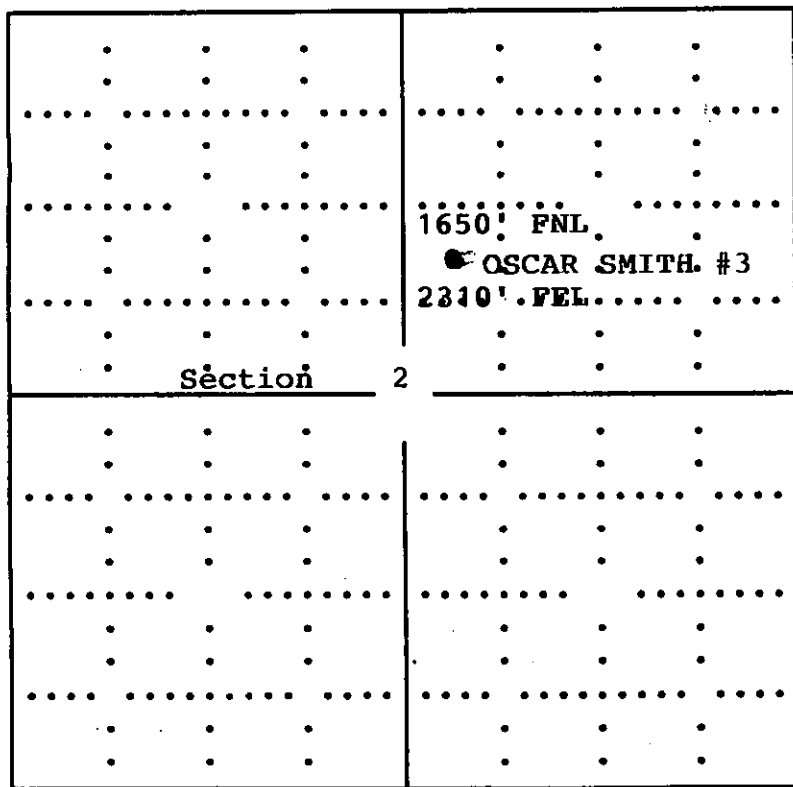

SEWARD CO.

In plotting the proposed location of the well, you must show:

- 1) The manner in which you are using the depicted plat by identifying section lines, i.e. 1 section, 1 section with 8 surrounding sections, 4 sections, etc.;
- 2) the distance of the proposed drilling location from the section's south/north and east/west; and
- 3) the distance to the nearest lease or unit boundary line.