

FOR KCC USE:

FORM C-1 7/91

FORM MUST BE TYPED  
FORM MUST BE SIGNED

ALL BLANKS MUST BE FILLED

EFFECTIVE DATE: 11-10-97  
DISTRICT # 2  
SGA?  YES  NO

State of Kansas  
NOTICE OF INTENTION TO DRILL

Must be approved by the K.C.C. five (5) days prior to commencing well

EXPECTED SPUD DATE November 5, 1997  
month day year

Spot  
@ C NE SW Sec. 19 Twp 31 S R 8 W

OPERATOR: License #: 5428  
Name: Graves Drilling Co., Inc.  
Address: P.O. Box 8250  
City/State/Zip: Wichita, KS 67208  
Contact Person: Fredrick W. Stump  
Phone: (316) 687-2777

1980 feet from South Line of Section  
1880 feet from West Line of Section  
IS SECTION  REGULAR  IRREGULAR?  
(Note: Locate well on the Section Plat on Reverse Side)  
County: HARPER  
Lease Name: JACK WELL #: 1  
Field Name: SPIVEY GRABS  
Is this a Prorated/Spaced Field: Yes  No   
Target Formation(s): Mississippian  
Nearest Lease or Unit Boundary: 660' 540'  
Ground Surface Elevation: 1560' feet MSL  
Water well within one-quarter mile: Yes  No   
Public water supply well within one mile: Yes  No   
Depth to bottom of fresh water: 110'  
Depth to bottom of usable water: 180'  
Surface Pipe by Alternate:  1  2  
Length of Surface Pipe Planned to be set: 225'  
Length of Conductor pipe required: NONE  
Projected Total Depth: 4500'  
Formation at Total Depth: Mississippi  
Water Source for Drilling Operations:  
well farm pond  other  
DWR Permit #: \_\_\_\_\_  
Will Cores Be Taken? Yes  No   
If yes, proposed zone: \_\_\_\_\_

CONTRACTOR: License #: 5929  
Name: Duke Drilling Company

Well Drilled For: Well Class: Type Equipment:  
 Oil  Enh Rec  Infield  Mud Rotary  
 Gas  Storage  Pool Ext.  Air Rotary  
 OWWO  Disposal  Wildcat  Cable  
 Seismic  # of Holes  Other  
 Other

If OWWO: old well information as follows:  
Operator: \_\_\_\_\_  
Well Name: \_\_\_\_\_  
Comp. Date: \_\_\_\_\_ Old Total Depth \_\_\_\_\_

Directional, Deviated or Horizontal wellbore? Yes  No   
if yes, true vertical depth: \_\_\_\_\_  
Bottom Hole Location: \_\_\_\_\_

AFFIDAVIT

The undersigned hereby affirms that the drilling, completion and eventual plugging of this well will comply with K.S.A. 55-101, et. seq.  
It is agreed that the following minimum requirements will be met:

1. Notify the appropriate district office prior to spudding of well.
  2. A copy of the approved notice of intent to drill shall be posted on each drilling rig.
  3. The minimum amount of surface pipe as specified below shall be set by circulating cement to the top: in all cases surface pipe shall be set through all unconsolidated materials plus a minimum of 20 feet into the underlying formation:
  4. If the well is dry hole, an agreement between the operator and the district office on plug length and placement is necessary prior to plugging:
  5. The appropriate district office will be notified before well is either plugged or production casing is cemented in:
  6. IF AN ALTERNATE II COMPLETION. PRODUCTION PIPE SHALL BE CEMENTED FROM BELOW ANY USABLE WATER TO SURFACE WITHIN 120 DAYS OF SPUD DATE. IN ALL CASES, NOTIFY DISTRICT OFFICE PRIOR TO ANY CEMENTING.
- I hereby certify that the statements made herein are true and to the best of my knowledge and belief.

Date: 10-28-97 Signature of Operator or Agent: Fredrick W. Stump

Title: Supt. Mgr.

FOR KCC USE:  
API #15- 077-213430000  
Conductor pipe required NONE feet  
Minimum surface pipe required 200 ft per Alt.   
Approved by: JK 11-5-97  
This authorization expires: 5-5-98  
(This authorization void if drilling not started within 6 months of effective date.)  
Spud date: \_\_\_\_\_ Agent: \_\_\_\_\_

REMEMBER TO:

- File Drill Pit Application (form CDP-1) with Intent to Drill;
  - File Completion Form ACO-1 within 120 days of spud date;
  - File acreage attribution plat according to field proration orders;
  - Submit plugging report (CP-4) after plugging is completed;
  - Obtain written approval before disposing or injecting salt water.
- Mail to: Conservation Division, 130 S. Market, Wichita, KS 67202

19 31 805

**IN ALL CASES PLOT THE INTENDED WELL ON THE PLAT BELOW**

**PLAT OF ACREAGE ATTRIBUTABLE TO A WELL IN A PRORATED OR SPACED FIELD**

**If the intended well is in a prorated or spaced field, please fully complete this side of the form.**

If the intended well is in a prorated or spaced field complete the plat below showing that the well will be properly located in relationship to other wells producing from the common source of supply. Please show all the wells within 1 mile of the boundaries of the proposed acreage attribution unit for gas wells and within 1/2 mile of the boundaries of the proposed acreage attribution unit for oil wells.

API NO. 15 - \_\_\_\_\_  
 OPERATOR Graves Drilling Co., Inc.  
 LEASE JACK  
 WELL NUMBER 1  
 FIELD SPIVEY GRABS

LOCATION OF WELL: COUNTY HARPER  
 1980 feet from South Line of Section  
 1880 feet from West Line of Section  
 Sec. 19 Twp 31 S R 8 W

NUMBER OF ACRES ATTRIBUTABLE TO WELL 40  
 QTR/QTR/QTR OF ACREAGE C NE SW

IS SECTION  REGULAR OR  IRREGULAR  
**IF SECTION IS IRREGULAR, LOCATE WELL FROM NEAREST CORNER BOUNDARY.**  
 SECTION CORNER USED: NE NW SE  SW

**PLAT**

(Show location of the well and shade attributable acreage for prorated or spaced wells.)  
 (Show footage to the nearest lease or unit boundary line.)

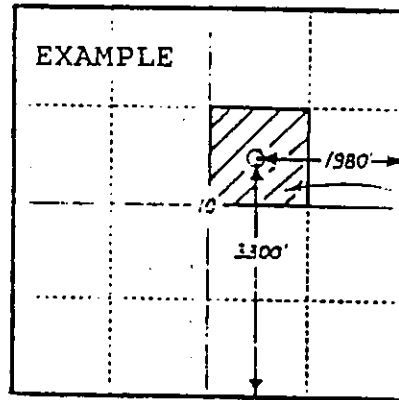
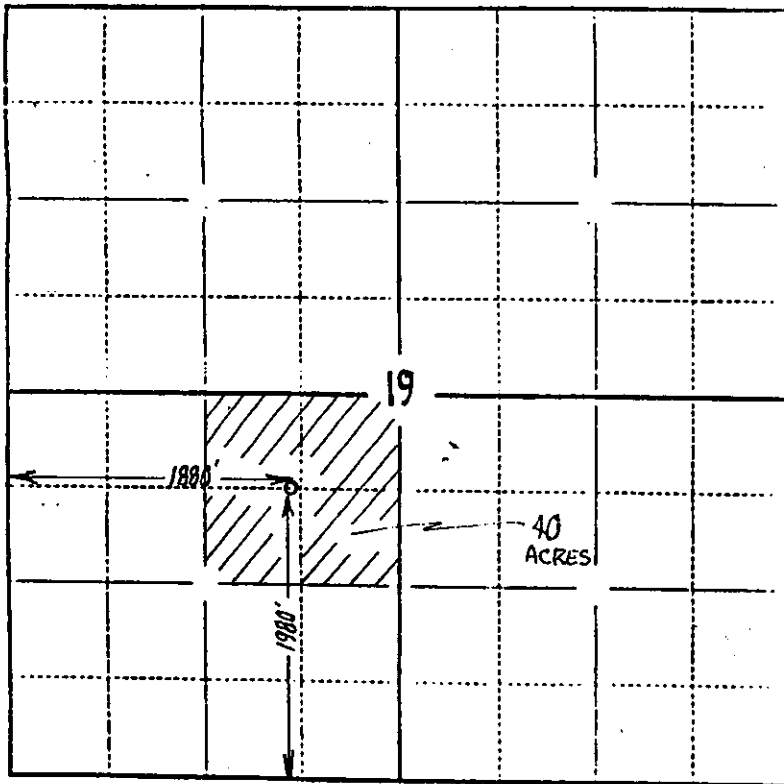

40  
ACRES

SEWARD CO.

**In plotting the proposed location of the well, you must show:**

- 1) The manner in which you are using the depicted plat by identifying section lines, i.e. 1 section, 1 section with 8 surrounding sections, r sections, etc.:
- 2) The distance of the proposed drilling location from the section's south/north and east/west lines; and
- 3) The distance to the nearest lease or unit boundary line.