

FOR KCC USE:

FORM C-1 /191
FORM MUST BE TYPED
FORM MUST BE SIGNED
ALL BLANKS MUST BE FILLED

EFFECTIVE DATE: 7-19-99
DISTRICT # 2
SGA? YES NO

State of Kansas
NOTICE OF INTENTION TO DRILL

Must be approved by the K.C.C. five (5) days prior to commencing well

EXPECTED SPUD DATE July 1, 1999
month day year

Spot
NE SE NW Sec. 19 Twp 31 S R 8 W

OPERATOR: License #: 5428
Name: Graves Drilling Co., Inc.
Address: P.O. Box 8260
City/State/Zip: Wichita, KS 67208
Contact Person: Fredrick W. Stump
Phone: (316) 687-2777

1650 feet from North Line of Section
2310 feet from West Line of Section
IS SECTION x REGULAR IRREGULAR?
(Note: Locate well on the Section Plat on Reverse Side)
County: HARPER
Lease Name: JACK WELL #: 3

CONTRACTOR: License #: 5928
Name: Duke Drilling Company

Field Name: SPIVEY GRABS
Is this a Prorated/Spaced Field: Yes No
Target Formation(s): Mississippian
Nearest Lease or Unit Boundary: 330'
Ground Surface Elevation: est 1580' feet MSL

Well Drilled For: Well Class: Type Equipment:
 Oil Enh Rec Infield Mud Rotary
 Gas Storage Pool Ext. Air Rotary
 OWWO Disposal Wildcat Cable
 Seismic # of Holes Other

Water well within one-quarter mile: Yes No
Public water supply well within one mile: Yes No
Depth to bottom of fresh water: 110'
Depth to bottom of usable water: 180'
Surface Pipe by Alternate: x 1 2
Length of Surface Pipe Planned to be set: 225'
Length of Conductor pipe required: NONE

If OWWO: old well information as follows:
Operator: _____
Well Name: _____
Comp. Date: Old Total Depth

Projected Total Depth: 4500'
Formation at Total Depth: Mississippi
Water Source for Drilling Operations:
well farm pond other

Directional, Deviated or Horizontal wellbore? Yes X No
If yes, true vertical depth: _____
Bottom Hole Location: _____

DWR Permit #: _____
Will Cores Be Taken? Yes No X
If yes, proposed zone: _____

AFFIDAVIT

The undersigned hereby affirms that the drilling, completion and eventual plugging of this well will comply with K.S.A. 55-101, et. seq.
It is agreed that the following minimum requirements will be met:

1. Notify the appropriate district office prior to spudding of well;
 2. A copy of the approved notice of intent to drill shall be posted on each drilling rig;
 3. The minimum amount of surface pipe as specified below shall be set by circulating cement to the top: In all cases surface pipe shall be set through all unconsolidated materials plus a minimum of 20 feet into the underlying formation;
 4. If the well is dry hole, an agreement between the operator and the district office on plug length and placement is necessary prior to plugging;
 5. The appropriate district office will be notified before well is either plugged or production casing is cemented in.
 6. IF AN ALTERNATE II COMPLETION, PRODUCTION PIPE SHALL BE CEMENTED FROM BELOW ANY USABLE WATER TO SURFACE WITHIN 120 DAYS OF SPUD DATE. IN ALL CASES, NOTIFY DISTRICT OFFICE PRIOR TO ANY CEMENTING.
- I hereby certify that the statements made herein are true and to the best of my knowledge and belief.

Date: 7/7/99 Signature of Operator or Agent: [Signature]

Title: Agent

FOR KCC USE:
API #15- 077-21375-00-00
Conductor pipe required NONE feet
Minimum surface pipe required 200 ft per Alt.
Approved by: DPW 7-9-99
This authorization expires: 1-9-2000
(This authorization void if drilling not started within 6 months of effective date.)
Spud date: _____ Agent: _____

REMEMBER TO:

- File Drill Pit Application (form CDP-1) with Intent to Drill;
 - File Completion Form ACO-1 within 120 days of spud date;
 - File acreage attribution plat according to field proration orders;
 - Submit plugging report (CP-4) after plugging is completed;
 - Obtain written approval before disposing or injecting salt water.
- Mail to: Conservation Division, 130 S. Market, Wichita, KS 67202

RECEIVED
KANSAS CORPORATION COMMISSION

JUL 07 1999
7-7-99
CONSERVATION DIVISION
WICHITA, KS

16
31
82

IN ALL CASES PLOT THE INTENDED WELL ON THE PLAT BELOW

PLAT OF ACREAGE ATTRIBUTABLE TO A WELL IN A PRORATED OR SPACED FIELD

If the intended well is in a prorated or spaced field, please fully complete this side of the form. If the intended well is in a prorated or spaced field complete the plat below showing that the well will be properly located in relationship to other wells producing from the common source of supply. Please show all the wells within 1 mile of the boundaries of the proposed acreage attribution unit for gas wells and within 1/2 mile of the boundaries of the proposed acreage attribution unit for oil wells.

API NO. 15- _____
 OPERATOR _____
 LEASE _____
 WELL NUMBER _____
 FIELD _____

LOCATION OF WELL: COUNTY _____
 _____ feet from south/north line of section
 _____ feet from east/west line of section
 SECTION _____ TWP _____ RG _____

NUMBER OF ACRES ATTRIBUTABLE TO WELL _____
 QTR/QTR/QTR OF ACREAGE _____

IS SECTION _____ REGULAR or _____ IRREGULAR
IF SECTION IS IRREGULAR, LOCATE WELL FROM NEAREST CORNER BOUNDARY.

Section corner used: _____ NE _____ NW _____ SE _____ SW

PLAT

(Show location of the well and shade attributable acreage for prorated or spaced wells.)
 (Show footage to the nearest lease or unit boundary line.)

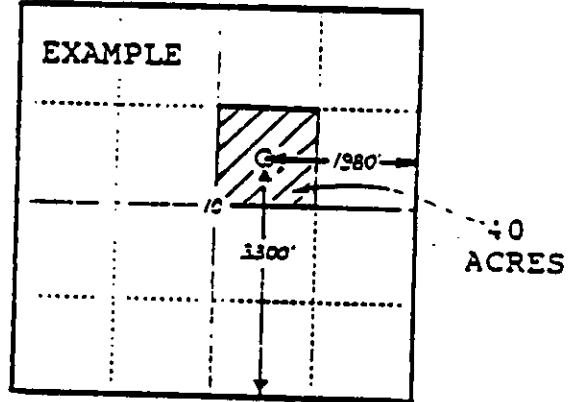
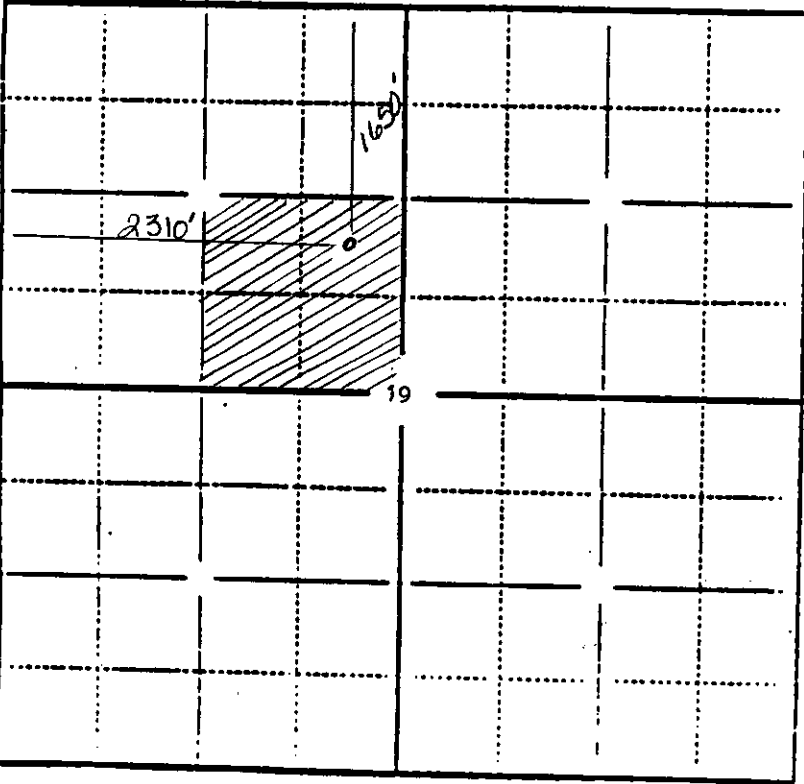

HARPER COUNTY

In plotting the proposed location of the well, you must show:

- 1) The manner in which you are using the depicted plat by identifying section lines, i.e. 1 section, 1 section with 8 surrounding sections, 4 sections, etc.;
- 2) the distance of the proposed drilling location from the section's south/north and east/west lines; and
- 3) the distance to the nearest lease or unit boundary line.