

FOR KCC USE:

X 200' MINIMUM SURFACE CASING FORM C-1 7/91

EFFECTIVE DATE: 6-28-94

FORM MUST BE TYPED

DISTRICT #

State of Kansas  
NOTICE OF INTENTION TO DRILL

FORM MUST BE SIGNED

SSA7... Yes... No

Must be approved by the K.C.C. five (5) days prior to commencing well

ALL BLANKS MUST BE FILLED

Expected Spud Date June 28 1994  
month day year

Sec 8 Twp 17 S, Rg 19 East  
SW NW NE

OPERATOR: License # 30347  
Name: Decab Co.  
Address: Box 609  
City/State/Zip: Hays, KS 67601  
Contact Person: Thomas J. Younger  
Phone: 913-625-4086

4080 feet from South North Line of Section  
2310 feet from East West Line of Section  
IS SECTION X REGULAR IRREGULAR?

CONTRACTOR: License #: 8241  
Name: Emphasis Drilling

(NOTE: Locate well on the Section Plat on Reverse Side)  
County: Rush

Well Drilled For: Well Class: Type Equipment:  
X Oil ... Enh Rec X Infield X Mud Rotary  
... Gas ... Storage ... Pool Ext. ... Air Rotary  
... OWD ... Disposal ... Wildcat ... Cable  
... Seismic; ... # of Holes ... Other  
... Other

Lease Name: Legleiter Well #: 1  
Field Name: Littler  
Is this a Prorated/Spaced Field? yes X no  
Target Formation(s): Arbuckle  
Nearest lease or unit boundary: Littler 1190 ft  
Ground Surface Elevation: 2111 feet MSL

If OWD: old well information as follows:  
Operator:  
Well Name:  
Comp. Date: Old Total Depth

Water well within one-quarter mile: X yes no  
Public water supply well within one mile: yes X no  
Depth to bottom of fresh water: 40 ft 400'  
Depth to bottom of usable water: 49 ft 520'  
Surface Pipe by Alternate: 1 2  
Length of Surface Pipe Planned to be set: 175 200'  
Length of Conductor pipe required: 0 NONE  
Projected Total Depth: 3850  
Formation at Total Depth: Arbuckle  
Water Source for Drilling Operations:  
... well X farm pond other

Directional, Deviated or Horizontal wellbore? yes X no  
If yes, true vertical depth:  
Bottom Hole Location:

DWR Permit #:   
Will Cores Be Taken? yes X no  
If yes, proposed zone:

AFFIDAVIT

The undersigned hereby affirms that the drilling, completion and eventual plugging of this well will comply with K.S.A. 55-101, et. seq.

It is agreed that the following minimum requirements will be met:

RECEIVED  
STATE CORPORATION COMMISSION  
6-23-94  
JUN 23 1994  
CONSERVATION DIVISION  
Wichita, Kansas

1. Notify the appropriate district office prior to spudding of well;
2. A copy of the approved notice of intent to drill shall be posted on each drilling rig;
3. The minimum amount of surface pipe as specified below shall be set by circulating cement to the top; in all cases surface pipe shall be set through all unconsolidated materials plus a minimum of 20 feet into the unconsolidated formation;
4. If the well is dry hole, an agreement between the operator and the district office on pipe length and placement is necessary prior to plugging;
5. The appropriate district office will be notified before well is either plugged or production casing is cemented in;
6. IF AN ALTERNATE II COMPLETION, PRODUCTION PIPE SHALL BE CEMENTED FROM BELOW ANY USABLE WATER TO SURFACE WITHIN 120 DAYS OF SPUD DATE. IN ALL CASES, NOTIFY DISTRICT OFFICE PRIOR TO ANY CEMENTING.

I hereby certify that the statements made herein are true and to the best of my knowledge and belief.

Date: 6-21-94 Signature of Operator or Agent: Thomas J. Younger Title: operator

FOR KCC USE: 165 21659-0000  
 API # 15-  
 Conductor pipe required NONE feet  
 Minimum surface pipe required 200' feet per Alt. X(2)  
 Approved by: CB 6-23-94  
 This authorization expires: 12-23-94  
 (This authorization void if drilling not started within 6 months of effective date.)  
 Spud date: Agent:

REMEMBER TO:

- File Drill Pit Application (form CDP-1) with Intent to Drill;
- File Completion Form ACO-1 within 120 days of spud date;
- File acreage attribution plat according to field proration orders;
- Notify appropriate district office 48 hours prior to workover or re-entry;
- Submit plugging report (CP-4) after plugging is completed;
- Obtain written approval before disposing or injecting salt water.

Mail to: Conservation Division, 209 Colorado Derby Building, 202 W. First St., Wichita, Kansas 67202-1286.

8  
17  
19

IN ALL CASES PLOT THE INTENDED WELL ON THE PLAT BELOW

**PLAT OF ACREAGE ATTRIBUTABLE TO A WELL IN A PRORATED OR SPACED FIELD**

If the intended well is in a prorated or spaced field, please fully complete this side of the form. If the intended well is in a prorated or spaced field complete the plat below showing that the well will be properly located in relationship to other wells producing from the common source of supply. Please show all the wells within 1 mile of the boundaries of the proposed acreage attribution unit for gas wells and within 1/2 mile of the boundaries of the proposed acreage attribution unit for oil wells.

API NO. 15- \_\_\_\_\_  
 OPERATOR Decab Co.  
 LEASE Legleiter  
 WELL NUMBER #1  
 FIELD Littler

LOCATION OF WELL: COUNTY Rush  
4080 feet from south north line of section  
2310 feet from east west line of section  
 SECTION 8 TWP 17 RG 19

NUMBER OF ACRES ATTRIBUTABLE TO WELL \_\_\_\_\_  
 QTR/QTR/QTR OF ACREAGE NE/4

IS SECTION X REGULAR or \_\_\_\_\_ IRREGULAR  
IF SECTION IS IRREGULAR, LOCATE WELL FROM NEAREST CORNER BOUNDARY.

Section corner used: X NE \_\_\_\_\_ NW \_\_\_\_\_ SE \_\_\_\_\_ SW

**PLAT**

(Show location of the well and shade attributable acreage for prorated or spaced wells.)  
 (Show footage to the nearest lease or unit boundary line.)

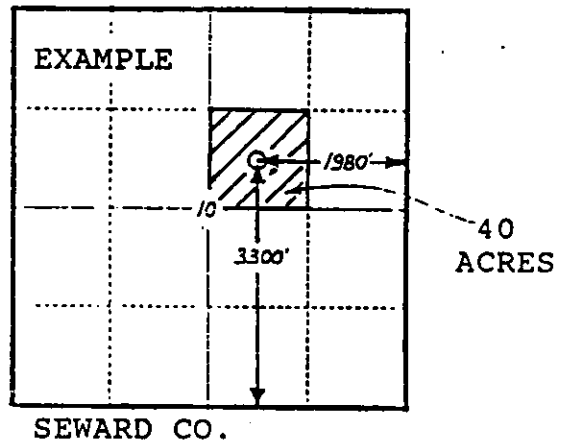
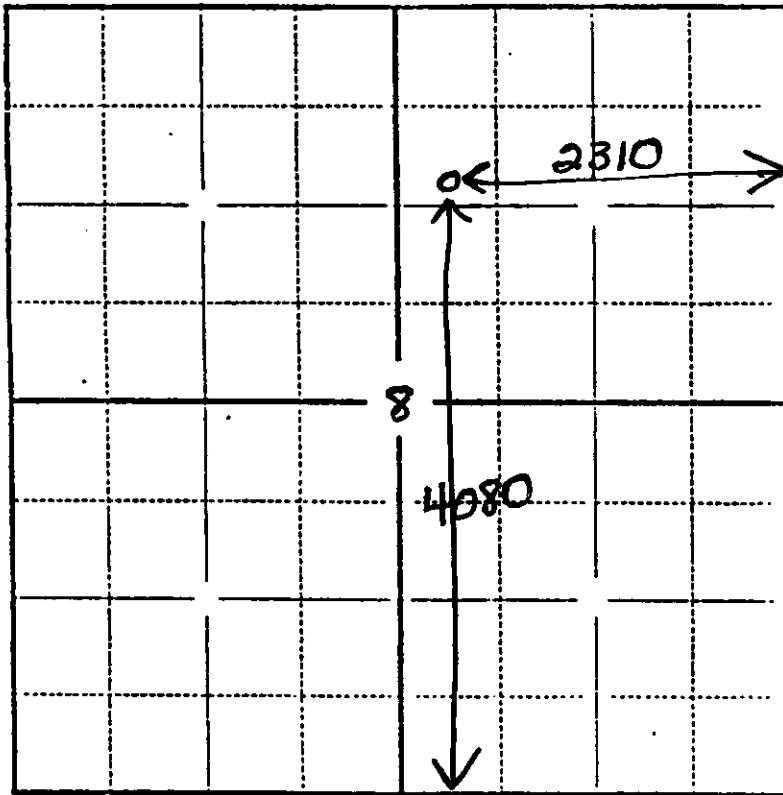

In plotting the proposed location of the well, you must show:

- 1) The manner in which you are using the depicted plat by identifying section lines, i.e. 1 section, 1 section with 8 surrounding sections, 4 sections, etc.;
- 2) the distance of the proposed drilling location from the section's south/north and east/west lines; and
- 3) the distance to the nearest lease or unit boundary line.