

FOR KCC USE:

FORM C-1 7/91

EFFECTIVE DATE: 8-5-94

DISTRICT # 1

SSA? Yes No

State of Kansas

NOTICE OF INTENTION TO DRILL

FORM MUST BE TYPED

FORM MUST BE SIGNED

ALL BLANKS MUST BE FILLED

Must be approved by the K.C.C. five (5) days prior to commencing well

Expected Spud Date 8 25 94 month day year

Spot NW SW Sec 7 Twp 18 S. Rg 17 East West

OPERATOR: License # 6875 Marmik Oil Company 200 N. Jefferson, Suite 500 El Dorado, AR 71730 Contact Person: Curtis G. Morrill Phone: (501) 862-8546

990 feet from (South) North line of Section 330 feet from East (West) line of Section IS SECTION X REGULAR IRREGULAR?

(NOTE: Locate well on the Section Plat on Reverse Side) County: Rush

Lease Name: Ben Well #: 1

Field Name:

Is this a Prorated/Spaced Field? yes X no

Target Formation(s): Arbuckle

Nearest lease or unit boundary: 330

Ground Surface Elevation: 2060 est. feet MSL

Water well within one-quarter mile: yes X no

Public water supply well within one mile: yes X no

Depth to bottom of fresh water: 250

Depth to bottom of usable water: 480 460

Surface Pipe by Alternate: X 1

Length of Surface Pipe Planned to be set: (1200) 480

Length of Conductor pipe required:

Projected Total Depth: 3950

Formation at Total Depth: Arbuckle

Water Source for Drilling Operations:

? well farm pond X other

DWR Permit #: ?

Will Cores Be Taken? yes no

If yes, proposed zone:

CONTRACTOR: License #: UNKNOWN ADVISE K.C.C.

Well Drilled For: Well Class: Type Equipment: X Oil Enh Rec Infield X Mud Rotary Gas Storage Pool Ext. Air Rotary CWMO Disposal X Wildcat Cable Seismic: # of Holes Other

If CWMO: old well information as follows:

Operator: Well Name: Comp. Date: Old Total Depth

Directional, Deviated or Horizontal wellbore? yes no

If yes, true vertical depth:

Bottom Hole Location:

AFFIDAVIT

The undersigned hereby affirms that the drilling, completion and eventual plugging of this well will comply with K.S.A. 55-101, et. seq.

It is agreed that the following minimum requirements will be met:

- 1. Notify the appropriate district office prior to spudding of well; 2. A copy of the approved notice of intent to drill shall be posted on each drilling rig; 3. The minimum amount of surface pipe as specified below shall be set by circulating cementing the casing in all cases; surface pipe shall be set through all unconsolidated materials plus a minimum of 20 feet into the underlying formation; 4. If the well is dry hole, an agreement between the operator and the district office on plug length and placement is necessary prior to plugging; 5. The appropriate district office will be notified before well is either plugged or production casing is cemented in; 6. IF AN ALTERNATE II COMPLETION, PRODUCTION PIPE SHALL BE CEMENTED FROM BELOW ANY USABLE WATER TO SURFACE WITHIN 120 DAYS OF SPUD DATE. IN ALL CASES, NOTIFY DISTRICT OFFICE PRIOR TO ANY CEMENTING.

I hereby certify that the statements made herein are true and to the best of my knowledge and belief.

Date: 7-28-94 Signature of Operator or Agent: Curtis G. Morrill Title: GEOLOGIST

FOR KCC USE: API # 15- 165-21663-0000 Conductor pipe required 0 feet Minimum surface pipe required 480 feet per Alt. O X Approved by: CB 8-1-94 This authorization expires: 2-1-95 (This authorization void if drilling not started within 6 months of effective date.) Spud date: Agent:

REMEMBER TO:

- File Drill Pit Application (form CDP-1) with Intent to Drill; - File Completion Form ACO-1 within 120 days of spud date; - File acreage attribution plat according to field proration orders; - Notify appropriate district office 48 hours prior to workover or re-entry; - Submit plugging report (CP-4) after plugging is completed; - Obtain written approval before disposing or injecting salt water.

Mail to: Conservation Division, 200 Colorado Derby Building, 202 W. First St., Wichita, Kansas 67202-1286.

RECEIVED STATE COMMISSION AUG 01 1994 8-1-94 CONSERVATION DIVISION

N 18 17

PLAT OF ACREAGE ATTRIBUTABLE TO A WELL IN A PRORATED OR SPACED FIELD

If the intended well is in a prorated or spaced field, please fully complete this side of the form. If the intended well is in a prorated or spaced field complete the plat below showing that the well will be properly located in relationship to other wells producing from the common source of supply. Please show all the wells within 1 mile of the boundaries of the proposed acreage attribution unit for gas wells and within 1/2 mile of the boundaries of the proposed acreage attribution unit for oil wells.

API NO. 15- _____
 OPERATOR Marmik Oil Company
 LEASE Ben
 WELL NUMBER 1
 FIELD _____

LOCATION OF WELL: COUNTY Rush
990 feet from (south/north) line of section
330 feet from east(west) line of section
 SECTION 7 TWP 18 S RG 17 W

NUMBER OF ACRES ATTRIBUTABLE TO WELL 40
 QTR/QTR/QTR OF ACREAGE _____ - SW - SW

IS SECTION X REGULAR or IRREGULAR
IF SECTION IS IRREGULAR, LOCATE WELL FROM NEAREST CORNER BOUNDARY.

Section corner used: _____ NE _____ NW _____ SE X SW
PLAT

(Show location of the well and shade attributable acreage for prorated or spaced wells.)
 (Show footage to the nearest lease or unit boundary line.)

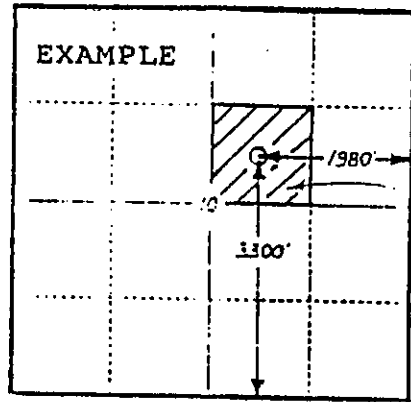
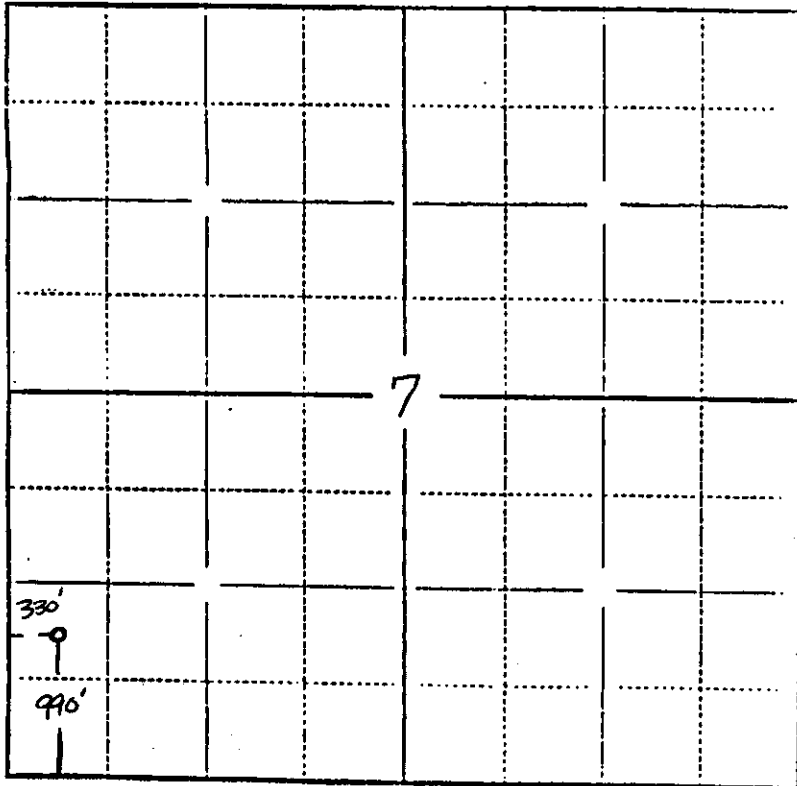

40
ACRES

SEWARD CO.

In plotting the proposed location of the well, you must show:

- 1) The manner in which you are using the depicted plat by identifying section lines, i.e. 1 section, 1 section with 8 surrounding sections, 4 sections, etc.;
- 2) the distance of the proposed drilling location from the section's south/north and east/west lines; and
- 3) the distance to the nearest lease or unit boundary line.