

STATE OF KANSAS  
STATE CORPORATION COMMISSION

Give All Information Completely  
Make Required Affidavit  
Mail or Deliver Report to:  
Conservation Division  
State Corporation Commission  
211 No. Broadway  
Wichita, Kansas

WELL PLUGGING RECORD

NORTH

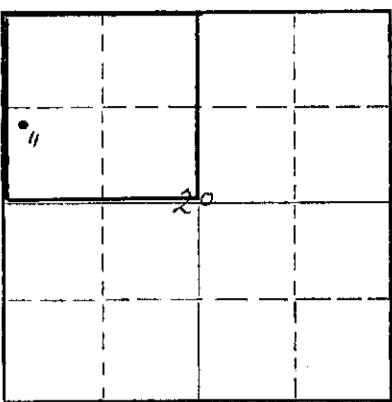

Locate well correctly on above Section Plat

Harper County. Sec. 20 Twp. 31 Rge. 6 (E) 6 (W)  
Location as "NE/CNW/SW" or footage from lines NW/4 SW/4 NW/4  
Lease Owner Skelly Oil Company  
Lease Name A. C. Gish Well No. 11  
Office Address Box 1650, Tulsa, Oklahoma  
Character of Well (completed as Oil, Gas or Dry Hole) Dry Hole  
Date well completed January 11, 19 58  
Application for plugging filed January 13, 19 58  
Application for plugging approved January 14, 19 58  
Plugging commenced January 27, 19 58  
Plugging completed January 30, 19 58  
Reason for abandonment of well or producing formation DRY HOLE

If a producing well is abandoned, date of last production \_\_\_\_\_ 19 \_\_\_\_  
Was permission obtained from the Conservation Division or its agents before plugging was commenced? Yes

Name of Conservation Agent who supervised plugging of this well Mr. J. Lewis Brock  
Producing formation \_\_\_\_\_ Depth to top \_\_\_\_\_ Bottom \_\_\_\_\_ Total Depth of Well 4406 Feet  
Show depth and thickness of all water, oil and gas formations. PB 4186'

OIL, GAS OR WATER RECORDS

CASING RECORD

FORMATION	CONTENT	FROM	TO	SIZE	PUT IN	PULLED OUT
<u>Mississippi Lime</u>	<u>Dry</u>	<u>4337'</u>		<u>8-5/8"</u>	<u>590'6"</u> <u>4388'6"</u>	<u>None</u> <u>3487'</u>

Describe in detail the manner in which the well was plugged, indicating where the mud fluid was placed and the method or methods used in introducing it into the hole. If cement or other plugs were used, state the character of same and depth placed, from \_\_\_\_\_ feet to \_\_\_\_\_ feet for each plug set.

<u>Sand</u>	<u>4186'</u>	<u>to</u>	<u>3880'</u>
<u>5 sacks of cement</u>	<u>3880'</u>	<u>to</u>	<u>3840'</u>
<u>Heavy mud</u>	<u>3840'</u>	<u>to</u>	<u>205'</u>
<u>Crushed rock</u>	<u>205'</u>	<u>to</u>	<u>200'</u>
<u>20 sacks of cement</u>	<u>200'</u>	<u>to</u>	<u>150'</u>
<u>Heavy mud</u>	<u>150'</u>	<u>to</u>	<u>35'</u>
<u>Crushed rock</u>	<u>35'</u>	<u>to</u>	<u>30'</u>
<u>10 sacks of cement</u>	<u>30'</u>	<u>to</u>	<u>6'</u>
<u>Surface soil</u>	<u>6'</u>	<u>to</u>	<u>0'</u>

FILED  
FEB 8 1958  
2-8-58  
CONSERVATION DIVISION

(If additional description is necessary, use BACK of this sheet)

Name of Plugging Contractor Ace Pipe Pulling Company  
Address P. O. Box 304, Great Bend, Kansas

STATE OF Kansas, COUNTY OF Reno, ss.  
H. E. Wamsley (employee of owner) ~~owner~~ of the above-described well, being first duly sworn on oath, says: That I have knowledge of the facts, statements and matters herein contained and the log of the above-described well as filed and that the same are true and correct. So help me God.

(Signature) [Signature]  
Box 391, Hutchinson, Kansas  
(Address)

SUBSCRIBED AND SWORN to before me this 7th day of February, 19 58

My commission expires April 7, 1959  
Josephine L. Johnson Notary Public.

PLUGGING  
FILE SEC 20 T 31 R 64  
BOOK PAGE 76 LINE 2

15-077-10040-0000

# SKELLY OIL COMPANY

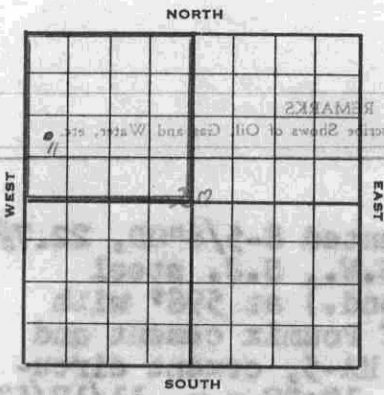

## Well Record

Lease Name and No. A. C. Gish Well No. 1505<sup>RD</sup> Elev. 1497<sup>BF</sup>  
 Lease Description 3/2 Sec. 17 and NW/4 Sec. 20-31S-6W, Harper Co., Kansas (480 Acres)

Location made Nov. 11, 1957 by Ed Krug  
 feet from North line 990 feet from East line NW/4  
 feet from South line 330 feet from West line of Sec. 20

Work com'd 11/14 19 57 Rig comp'd 11/16 19 57 Drlg. com'd 11/16 19 57 Drlg. comp'd 1/8 19 58

Rig Contractor Claude Wentworth Drlg. Co., Inc.

Drilling Contractor Claude Wentworth Drilling Co., Inc., Tulsa, Oklahoma

Rotary Drilling from 0' to 4355' Cable Tool Drilling from 4355' to 4406'

Commenced DRY HOLE 19 57 Initial Prod. before shot or acid \_\_\_\_\_ Bbls.  
 Initial Prod. after shot or acid \_\_\_\_\_ Bbls.

Dry Gas Well Press. \_\_\_\_\_ Volume \_\_\_\_\_ Cu. ft.

Casing Head Gas Pressure \_\_\_\_\_ Volume \_\_\_\_\_ Cu. ft.

Braden Head ( \_\_\_\_\_ Size \_\_\_\_\_ ) Gas Pressure \_\_\_\_\_ Volume \_\_\_\_\_ Cu. ft.

Braden Head ( \_\_\_\_\_ Size \_\_\_\_\_ ) Gas Pressure \_\_\_\_\_ Volume \_\_\_\_\_ Cu. ft.

PRODUCING FORMATION DRY HOLE (Name) Top \_\_\_\_\_ Bottom \_\_\_\_\_ TOTAL DEPTH 4406'

### CASING RECORD

Size	Wt.	Thds.	Where Set	PULLED OUT			LEFT IN			KIND	Cond'n	CEMENTING	
				Jts.	Feet	In.	Jts.	Feet	In.			Sacks Used	Method Employed
8-5/8"	227	57	598'				16	590	6	Arco SW A	A	341	Halliburton
5-1/2"	14	82	4355'	106	3487	0	28	901	6	J55 R2 SS A	A	150	Halliburton
(8-5/8" casing sep. 2 1/2" in collar and 5 1/2" cased to derrick floor)													

Liner Set at \_\_\_\_\_ Length \_\_\_\_\_ Perforated at \_\_\_\_\_

Liner Set at \_\_\_\_\_ Length \_\_\_\_\_ Perforated at \_\_\_\_\_

Packer Set at \_\_\_\_\_ Size and Kind \_\_\_\_\_

Packer Set at \_\_\_\_\_ Size and Kind \_\_\_\_\_

### SHOT OR ACID TREATMENT RECORD

	FIRST	SECOND	THIRD	FOURTH
Date	<u>12/13/57</u>	<u>12/18/57</u>		
Acid Used				
Size Shot	<u>250</u> Gals. Qts.	<u>250</u> Gals. Qts.		
Shot Between	<u>4342</u> Ft. and <u>4348</u> Ft.	<u>4338</u> Ft. and <u>4347</u> Ft.		
Size of Shell				
Put in by (Co.)	<u>Halliburton</u>	<u>Halliburton</u>		
Length anchor				
Distance below Cas'g				
Damage to Casing or Casing Shoulder				

### SIGNIFICANT GEOLOGICAL FORMATIONS

NAME	Top	Bottom	GAS		OIL		REMARKS
			From	To	From	To	
<u>Topeka Line</u>	<u>2809'</u>						
<u>Heebner Shale</u>	<u>3202'</u>						
<u>Kansas City</u>	<u>4051'</u>						
<u>Maraton Line</u>							
<u>Mississippi</u>	<u>4337'</u>						

### CLEANING OUT RECORDS

	DATE COMMENCED	DATE COMPLETED	PROD. BEFORE	PROD. AFTER	REMARKS
1st					See Reverse for other details.
2nd					" " " " "
3rd					" " " " "
4th					" " " " "

### PLUGGING BACK AND DEEPENING RECORDS

	Date Commenced	Date Completed	No. Feet Plugged Back or Deepened	Prod. Before	Prod. After	REMARKS
1st						See Reverse for other details.
2nd						" " " " "
3rd						" " " " "
4th						" " " " "

CONSERVATION DIVISION  
 (See Reverse for Record of Formation)

RECORD OF FORMATIONS

Table with columns: FORMATION, TOP, BOTTOM, REMARKS. Includes entries for 'Surface soil, sand and shale', 'Red bed, shale and shells', 'Shale and shells', 'Lime and shale', 'Sand and shale', 'Lime and shale', 'Chert, partly weathered and tripolitic'.

CASING RECORD

Table with columns: CEMENTING, KIND, LEFT IN, REMARKS. Includes entries for 'Set and cemented 5 1/2" OD, 14#, 88 thd., R-2, J-55, S.S. casing (A cond.) at 4355' with 150 sacks of common cement and 2% Gel. Finished cementing at 9:30 a.m. 12/3/57. Welex Temperature Survey showed top of cement behind 5 1/2" casing at 3480'.

Rigged up cable tools, swabbed and bailed the hole dry to 4310' and 5 1/2" casing tested dry on December 5. Drilled cement plug and cleaned out to 4349'. Loaded hole with 80 barrels of oil, then drilled cement plug and cleaned out to 4355'. Swabbed out oil used in loading hole. Then swabbed through 5 1/2" casing 3 hours.

Table with columns: NAME, TOP, BOTTOM, REMARKS. Includes entries for 'Very light stain', 'White to gray chert', 'Run 2" tubing and set Halliburton HM packer at 4334'. Treated Halliburton Acid-Frac as follows:'. 'ACID-FRAC TREATMENT NO. 1 - Between 4355' and 4365'.

Flowed through 2" tubing 24 hours, 17/64" choke, 38 barrels of oil used in treating, 24 barrels of acid water and 88 barrels of formation water, FIP-180#. On December 10, flowed through 2" tubing 3 hours, 4 1/2 barrels of water with good seum of oil per hour. Loaded hole with 140 barrels of water. Pulled 2" tubing and Halliburton HM packer. Ran 2" tubing and set HM retainer at 4349'. Treated through off open hole from 4355' to 4365' with 75 sacks of cement, various TP-2000#. Pulled 2" tubing and shut down for cement to set.

On December 11, swabbed and bailed the hole dry to top of retainer at 4349' and 5 1/2" casing tested dry. Perforated 5 1/2" casing from 4342' to 4348' with 37 holes by Lane-wells; bailed and tested 13 hours, 5 gallons of water with seum of dead oil per hour. On December 13, bailed and tested 4 hours, 5 gallons of water with seum of dead oil per hour. Treated through 5 1/2" casing with 55 gallons of acid as follows:

Table with columns: NAME, TOP, BOTTOM, REMARKS. Includes entries for 'RECEIVED STATE CORP COMMISSION', 'FEB 8 1958'.

ACID TREATMENT NO. 1 - Between 4343' and 4348' Treatment put in 12/13/57 by Halliburton, using 250 gallons of acid and 115 barrels of oil.

Table with columns: TIME, CP, TP, REMARKS. Entries include 12:07 pm Start acid, 12:10 pm Start flush, 1:14 pm Acid on bottom, 1:36 pm Acid clear, 1:41 pm Treatment completed.

Ran 2" tubing and set Halliburton DM retainer at 4330'. Cemented off perforations from 4342' to 4348' with 75 sacks of common cement, maximum TP-2500#.

On December 17, swabbed and bailed the hole dry to top of cement plug at 4330'. Drilled cement plug and cleaned out to 4345' and 5 1/2" casing tested dry.

Perforated 5 1/2" casing from 4338' to 4343' with 31 holes by Lane-Wells; bailed and tested 8 hours, 1/2 gallon of muddy water and no oil per hour.

ACID TREATMENT NO. 2 - Between 4338' and 4343' Treatment put in 12/16/57 by Halliburton, using 250 gallons of acid and 115 barrels of oil.

Table with columns: TIME, CP, TP, REMARKS. Entries include 12:55 pm Start acid, 1:00 pm Start flush, 1:21 pm Acid on bottom, 2:37 pm Acid clear, 2:47 pm Treatment completed.

Swabbed through 5 1/2" casing 16 hours, 78 barrels of oil used in treating, 6 barrels of acid water and 40 barrels of formation water. On December 19, ran 2" tubing and set DM retainer at 4325'.

Swabbed and bailed hole dry to top of retainer at 4325'. Drilled cement and cleaned out to 4365'. Swabbed through 5 1/2" casing 4 hours, 1/2 barrel of water per hour.

Deepened:

White to gray chert, poor porosity, no stain or saturation

Log table with columns: Depth (4365-4370, 4375-4380), Description (White chert), and Remarks (Swabbed through 5 1/2" casing 12 hours, 1-3/4 barrels of water with scum of oil per hour and show of gas).

White chalky limestone w/ streaks of brown cherty limestone. Fair porosity and saturation. Swabbed through 5 1/2" casing 3 hours, 6 barrels of water with scum of oil and small show gas per hour.

On December 27, ran 2" tubing with Halliburton DM retainer set at 4326'. Cemented off open hole from 4385' to 4355' with 100 sacks of cement, maximum TP-4500#, finished 4:00 p.m. 12/27/57.

Swabbed and bailed hole dry to top of retainer at 4326'. Drilled retainer, cement plug and cleaned out to 4381'. On January 1, 1958, swabbed through 5 1/2" casing 6 hours, 3 1/2 barrels of water with scum of oil.

RECEIVED STATE CORPORATION COMMISSION FEB 8 1958

Vertical stamp: RECEIVED STATE CORPORATION COMMISSION

Ran 2" tubing and set Halliburton DM retainer at 4333'. Cemented off open hole from 4355' to 4385' with 100 sacks of Pozmix cement, maximum TP-5000#, finished 1:30 p.m. 1/2/58. Pulled 2" tubing.

Swabbed and bailed hole dry to top of retainer at 4333'. Drilled retainer, cement plug and cleaned out to 4375'. Swabbed hole down; then swabbed through 5 1/2" casing 3 hours, 1.16 barrels of water, no oil per hour. Drilled cement plug and cleaned out to 4385'. Swabbed hole down, then swabbed through 5 1/2" casing 3 hours, 14 barrels of water with slight scum of oil per hour. Swabbed through 5 1/2" casing 3 hours, 7 barrels of water per hour. Tried to drill deeper and tools started sticking. Reamed hole from 4372' to 4385', and deepened;

White, slightly dolomitic chert 4385' to 4390'. Fair porosity with scattered stain. Swabbed hole down, then swabbed through 5 1/2" casing 3 hours, 14 barrels of water with slight scum of oil per hour.

Tan to brown chert 4390' to 4395'. Fair porosity with good stain. Swabbed hole down, then swabbed through 5 1/2" casing 3 hours, 20 barrels of water with scum of oil per hour.

White chert 4395' to 4406'. Shows no oil or gas. Swabbed hole down, then swabbed and tested 4 hrs, 20 barrels of water with scum of oil per hour.

TOTAL DEPTH 4406'

Ran 2" tubing open end to 4388'. Circulated out sand from 4388' to 4406'. Plugged back with 40 sacks of cement from 4406' to 4186'. Swabbed hole dry and 5 1/2" casing tested dry.

PLUGGED BACK TOTAL DEPTH 4186'. Perforated 5 1/2" casing from 3902' to 3906' with 24 holes by Lane-Wells; swabbed through 5 1/2" casing 18 hours, 32 barrels of water, no oil or gas.

As there were no commercial shows of oil or gas found in drilling to the total depth of 4406', regular authority was granted to plug and abandon the well as follows:

On January 27, 1958, moved in machine of Ace Pipe Pulling Company and plugged the well as follows:

Swabbed through 5 1/2" casing 18 hours, 32 barrels of water, no oil or gas.	3880' to 3880'	
Swabbed through 5 1/2" casing 3 hours, 14 barrels of water, no oil or gas.	3880' to 3840'	
Shot off 5 1/2" casing at 3493' and casing would not pull, shot off at 3461' and pulled 106 joints (3487') of 5 1/2" OD, 14#, 8R, R-2, J-55, S.S. casing (B cond.).	3840' to 205'	
Heavy mud 3 barrels	205' to 200'	
Crushed rock 3 barrels	200' to 150'	
20 sacks of cement	150' to 35'	
Heavy mud 3 barrels	35' to 30'	White chert
Crushed rock 3 barrels	30' to 6'	
10 sacks of cement	6' to 0'	
Surface soil 4 barrels		

Plugged and abandoned January 30, 1958.

SLOPE TEST DATA: Tests were taken at 285', 500', 675', 960', 1250', 1550', 1850', 2200', 2500', 2750', 3065', 3450', 3696' and 3985' with no deviation from vertical noted.

On December 27, ran 2" tubing with Halliburton DM retainer set at 4333'. Cemented off open hole from 4355' to 4385' with 100 sacks of cement, maximum TP-5000#, finished 1:30 p.m. 12/27/57. Pulled 2" tubing.

Swabbed and bailed hole dry to top of retainer at 4333'. Drilled retainer, cement plug and cleaned out to 4375'. Swabbed hole down; then swabbed through 5 1/2" casing 3 hours, 1.16 barrels of water, no oil per hour. Drilled cement plug and cleaned out to 4385'. Swabbed hole down, then swabbed through 5 1/2" casing 3 hours, 14 barrels of water with slight scum of oil per hour.

PLUGGING  
SEC 22 T 31 R 6 W  
BOOK PAGE 76 LINE 2

RECEIVED  
FEB 8 1958  
DIVISION

15-077-10039-0000

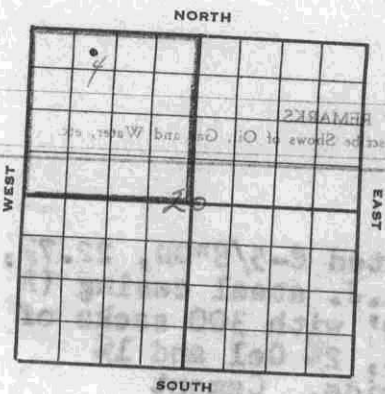

# SKELLY OIL COMPANY

**Well Record**

Lease Name and No. A. C. Gish #50753 Well No. 4 Elevation 1515'

Lease Description S/2 Sec. 17 and NW/4 Sec. 20-31S-6W, Twp. 33S, R. 10E, Harper County, Kansas (480 Acres)

Location made March 18, 19 57 by T. L. Dix

feet from North line \_\_\_\_\_ feet from East line NW/4

feet from South line 990 feet from West line of Sec. 20

Work com'd 3/20 19 57 Rig comp'd 3/26 19 57 Drlg. com'd 3/26 19 57 Drlg. comp'd 4/19 19 57

Rig Contractor Claude Wentworth Drilling Co., Inc.

Drilling Contractor Claude Wentworth Drilling Co., Inc., Tulsa, Oklahoma

Rotary Drilling from 0' to 4770' Cable Tool Drilling from \_\_\_\_\_ to \_\_\_\_\_

Commenced Producing May 8, 19 57 Initial Prod. before shot or acid Swab 3 hrs. 4 80 0 wtr/ Bbls.

Dry Gas Well Press \_\_\_\_\_ Initial Prod. after shot or acid Flowed thru 2" tbg. 3 Bbls.

Casing Head Gas Pressure \_\_\_\_\_ Volume \_\_\_\_\_ Cu. ft.

Braden Head (8-5/8" Size) Gas Pressure \_\_\_\_\_ Volume \_\_\_\_\_ Cu. ft.

Braden Head ( \_\_\_\_\_ Size) Gas Pressure \_\_\_\_\_ Volume \_\_\_\_\_ Cu. ft.

PRODUCING FORMATION Simpson Sand (Name) Top 4714' Bottom 4719' TOTAL DEPTH 4714'

**CASING RECORD**

OD Size	Wt.	Thds.	Where Set	PULLED OUT			LEFT IN			KIND	Cond'n	CEMENTING	
				Jts.	Feet	In.	Jts.	Feet	In.			Sacks Used	Method Employed
8-5/8"	22.7	8	629'				16	622	0	Armco SW	A	300	Halliburton
5-1/2"	14	8	4770'				40	1138	0	J55 R2 SS	A		
5-1/2"	14	8	4770'				116	3642	0	J55 R2 SS	B	200	Halliburton
(8-5/8" casing set 2' in cellar and 5 1/2" cased to derrick floor)													
5 1/2" casing perforations open above PB 10: 4714'-4719' with 30 holes													

Liner Set at \_\_\_\_\_ Length \_\_\_\_\_ Perforated at \_\_\_\_\_

Liner Set at \_\_\_\_\_ Length \_\_\_\_\_ Perforated at \_\_\_\_\_

Packer Set at \_\_\_\_\_ Size and Kind \_\_\_\_\_

Packer Set at \_\_\_\_\_ Size and Kind \_\_\_\_\_

**SHOT OR ACID TREATMENT RECORD**

Date	FIRST		SECOND		THIRD		FOURTH	
	Ft.	Gals. Qts.	Ft.	Gals. Qts.	Ft.	Gals. Qts.	Ft.	Gals. Qts.
4/28/57	4714'		4719'					
Shot Between								
Size of Shell								
Put in by (Co.)	Halliburton							
Length anchor								
Distance below Cas'g	Vis-0-frac							
Damage to Casing or Casing Shoulder								

**SIGNIFICANT GEOLOGICAL FORMATIONS**

NAME	Top	Bottom	GAS		OIL		REMARKS
			From	To	From	To	
Topoka Line	2810'						
Kansas City	3761'						
Harmston Line	4052'						
Mississippi	4338'						
Kinderhook shale	4584'						
Simpson Sand	4713'						

**CLEANING OUT RECORDS**

	DATE COMMENCED	DATE COMPLETED	PROD. BEFORE	PROD. AFTER	REMARKS
1st					
2nd					See Reverse for other details.
3rd					" " " " "
4th					" " " " "

**PLUGGING BACK AND DEEPENING RECORDS**

	Date Commenced	Date Completed	No. Feet Plugged Back or Deepened	Prod. Before	Prod. After	REMARKS
1st						
2nd						See Reverse for other details.
3rd						" " " " "
4th						" " " " "

(See Reverse for Record of Formation)

6000-8001-550-2

# RECORD OF FORMATIONS

FORMATION	TOP	BOTTOM	REMARKS
Surface soil, gravel and red rock	0	700	Set and cemented 8-5/8" OD, 22.7% Armo steel casing (12' long) with 300 sacks of common cement, 2% Gel and 1% calcium chloride. Cement circulated.
Shale and shells	700	700	
Shale	700	895	
Shale, shells and salt	845	1150	
Shale and lime	1150	1685	
Lime	1685	1775	
Lime and shale	1775	3881	
Sand and lime	3881	4342	
Lime and shale	4342	4345	
Gray to buff cherty lime	4345	4347	
Green-gray shale			
Light gray, fresh chert, partly weathered with spotted black stain and white tripolitic chert			

FORMATION	TOP	BOTTOM	REMARKS
Partly weathered and tripolitic chert	4368	4371	Poor porosity, poor medium black stain, small show of oil
Fine green shale	4371	4372	
Partly weathered and tripolitic chert	4372	4375	
Vari-colored shale	4375	4378	
Partly weathered and tripolitic chert with few pieces of light gray finely sacrosic dolomite	4378	4385	

FORMATION	TOP	BOTTOM	REMARKS
Same	4385	4394	Poor to fair porosity, poor to medium spotted stain, fair show of free oil.
White and light gray partly tripolitic chert	4394	4411	Poor porosity, no show of oil. San Halliburton drill stem test No. 3, packer set at 4387', used 24' anchors, open 1 hour, fair blow throughout test, recovered 720' of muddy salt water, IFF-55, FFP-412, BHP-1605 in 20 mins.

FORMATION	TOP	BOTTOM	REMARKS
Lime	4411	4414	
Lime and shale	4414	4713	

FORMATION	TOP	BOTTOM	REMARKS
Cored from 4711' to 4744' - Recovered 11'	4711	4744	Shale, hard dark, greenish gray, sandy at base
Top 2'			
Next 1'			Sand, gray quartzitic, few vertical fractures, few spots bleeding oil, spotted light stain
Next 10'			Sand, dolomitic and slightly sandy, poor porosity, good light stain and odor, few short vertical fractures
Next 6'			Sand, light gray, tight with long vertical fractures

(See Reverse for Record of Formations)

15-077-10039-0000

# SKELLY OIL COMPANY

## CHANGE IN WELL RECORD

Give complete description of all cleaning out, deepening, plugging back and fishing jobs, changes in casing, material lost in hole, etc, not recorded in original well record.

LEASE NAME A. C. Gish WELL NO. 4 DISTRICT Platte  
 SEC. 20 T. 31S R. 6W COUNTY Harper AFE NO. 58246  
 BLOCK \_\_\_\_\_ SURVEY \_\_\_\_\_ STATE Kansas

### TYPE OF WORK PLUG AND ABANDON WELL

Date commenced February 6, 19 65 Date completed February 12, 19 65  
 Deepened from \_\_\_\_\_ to \_\_\_\_\_ Total Depth \_\_\_\_\_  
 Plugged back from 4377' to Surface P.B.T.D. \_\_\_\_\_  
 Cleaned out from \_\_\_\_\_ to \_\_\_\_\_  
 Production before 1 bbls. oil 24 bbls. water 0 cu. ft. gas.  
 Production after \_\_\_\_\_ bbls. oil \_\_\_\_\_ bbls. water \_\_\_\_\_ cu. ft. gas.  
 Tools owned by: Ace Pipe Pulling Company Kind used: Pulling Unit No. days rig time: 4  
 Cost of Job \$ \_\_\_\_\_ Revised Estimated Payout (Mos.) \_\_\_\_\_

### TREATMENT RECORD

DATE	TYPE TREATMENT	INTERVAL TREATED	AMOUNT OF TREATMENT

### CHANGES IN CASING RECORD

STRINGS	SIZE	WHERE SET (Depth)	CEMENTING RECORD		REMARKS
			Sacks Used	Top Cem't. Bh'd. Cas'g.	
Production					
Liner					Top liner;

SIZE	WT.	THDS.	KIND	COND.	LEFT IN				PULLED OUT					
					Jts.	LTM		Jts.	LTM					
						Feet	In.		Feet	In.	Feet	In.		
<u>5-1/2"</u>	<u>14 7/8</u>	<u>8R</u>	<u>J55 R2 SS</u>	<u>C</u>	<u>37</u>	<u>1047</u>	<u>0</u>	<u>1055</u>	<u>0</u>	<u>119</u>	<u>3699</u>	<u>0</u>	<u>3725</u>	<u>0</u>

### PRODUCING FROM

FORMATION \_\_\_\_\_ thru OPEN HOLE PERFORATIONS \_\_\_\_\_ TOP \_\_\_\_\_ BOTTOM \_\_\_\_\_ Total No. Shots \_\_\_\_\_

REMARKS (Give review of work performed and any other comment of interest)

As the well was no longer economical to operate and as there were no further zones which merited testing, regular authority was granted to plug and abandon the well.

February 6, 1965, moved in and rigged up casing pulling machine of Ace Pipe Pulling Company and plugged the well as follows:

Sand 4377' to 4347'  
 5 sacks of cement 4377' to 4307'

Shot 5 1/2" casing at 3707'. Pulled 3725' of 5 1/2" casing.

Mud 4307' to 300'  
 Rock bridge 300' to 290'  
 25 sacks cement 290' to 215'  
 Mud 215' to 40'  
 Rock bridge 40' to 30'  
 10 sacks cement 30' to Base cellar  
 Surface soil Cellar to Surface

Plugged and abandoned February 12, 1965.



SKELLY OIL COMPANY

CHANGE IN WELL RECORD

Give complete description of all cleaning out, deepening, plugging back and fishing jobs, changes in casing, material lost in hole, etc. not recorded in original well record.

LEASE NAME, SEC., T., R., SURVEY, BLOCK, STATE, COUNTY, WELL NO., DISTRICT, AFE NO.

TYPE OF WORK

Date commenced, Date completed, Total depth, Plugged back from, Cleaned out from, Production before, Production after, Tools owned by, Kind used, Revised Estimated Payout (Mos), Cost of job \$.

RECEIVED STATE CORPORATION COMMISSION CONSERVATION DIVISION MAR 4 1963 Wichita, Kansas

TREATMENT RECORD table with columns: DATE, TYPE TREATMENT, INTERVAL TREATED, AMOUNT OF TREATMENT.

CHANGES IN CASING RECORD

Table with columns: STRINGS, SIZE, WHERE SET (Depth), CEMENTING RECORD (Sacks Used, Top Cement Sack), REMARKS, LINEAR, WT, THDS, KIND, COND, LEFT IN, PULLED OUT.

PRODUCING FROM

FORMATION, OPEN HOLE PERFORATIONS, TOP, BOTTOM, Total No. Spots

REMARKS (Give review of work performed and any other comment of interest.)

As the well was no longer economical to operate and as there were no further zones which would justify regular servicing was planned to plug and abandon the well.

February 6, 1963, down in and struck up casing pulling records of the pipe pulling company and plugged the well as follows:

- 2 sacks of cement, 10 sacks cement, 10 sacks cement, 20 sacks cement, 30 sacks cement, 40 sacks cement, 50 sacks cement, 60 sacks cement, 70 sacks cement, 80 sacks cement, 90 sacks cement, 100 sacks cement.

Plugged and abandoned February 13, 1963.