

STATE CORPORATION COMMISSION OF KANSAS
OIL & GAS CONSERVATION DIVISION
WELL COMPLETION OR RECOMPLETION FORM
ACO-1 WELL HISTORY
DESCRIPTION OF WELL AND LEASE

API NO. 15-077,21,155-0000
County Harper
S/2 SE NW Sec 10 Twp 31 Rge 8 East West

Operator: License # 6581
Name Bison Energy Corp
Address 9440 East Boston
City/State/Zip Wichita, KS 67211

2970 Ft North from Southeast Corner of Section
3300 Ft West from Southeast Corner of Section
(Note: Locate well in section plat below)

Purchaser Koch Oil Company
Wichita, KS 67202

Lease Name Muir Well #1B-10
Field Name Squirey - Grabs - Basil
Producing Formation MISSISSIPPI
Elevation: Ground 1657' KB 1665'

Operator Contact Person C. J. Lett, III
Phone 316-689-8393

Contractor: License # 5929
Name Duke Drilling Co., Inc.

Wellsite Geologist Dean Pattison
Phone 316-689-8393

Designate Type of Completion
XX New Well Re-Entry Workover
XX Oil SWD Temp Abd
Gas Inj Delayed Comp.
Dry Other (Core, Water Supply etc.)

If OMWO: old well info as follows:
Operator
Well Name
Comp. Date Old Total Depth

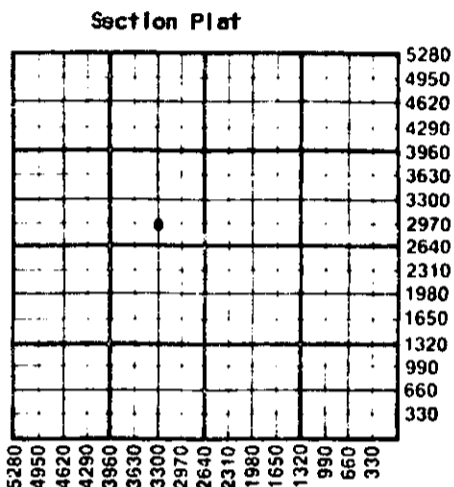

WATER SUPPLY INFORMATION
Disposition of Produced Water: Disposal
Docket # Repressuring

WELL HISTORY
Drilling Method: XX Mud Rotary Air Rotary Cable
7-16-87 7-23-87 8-31-87
Spud Date Date Reached TD Completion Date
4450' Total Depth PBTD
Amount of Surface Pipe Set and Cemented at 231' feet
Multiple Stage Cementing Collar Used? Yes X No
If yes, show depth set
If alternate 2 completion, cement circulated from...feet depth to...w/...SX cmt
Cement Company Name
Invoice #

Questions on this portion of the ACO-1 call:
Water Resources Board (913) 296-3717
Source of Water:
Division of Water Resources Permit #
X Groundwater 1770 Ft North from Southeast Corner (Well) 3300 Ft West from Southeast Corner of Sec 10 Twp 31 Rge 8 East X West
Surface Water...Ft North from Southeast Corner (Stream, pond etc)...Ft West from Southeast Corner Sec Twp Rge East West
Other (explain) (purchased from city, R.W.D. #)

INSTRUCTIONS: This form shall be completed in triplicate and filed with the Kansas Corporation Commission, 200 Colorado Derby Building, Wichita, Kansas 67202, within 120 days of the spud date of any well. Rule 82-3-130, 82-3-107 and 82-3-106 apply. Information on side two of this form will be held confidential for a period of 12 months if requested in writing and submitted with the form. See rule 82-3-107 for confidentiality in excess of 12 months. One copy of all wireline logs and drillers time log shall be attached with this form. Submit CP-4 form with all plugged wells. Submit CP-111 form with all temporarily abandoned wells.

All requirements of the statutes, rules and regulations promulgated to regulate the oil and gas industry have been fully complied with and the statements herein are complete and correct to the best of my knowledge.

Signature C. J. Lett, III
Title President Date 10-22-87

Subscribed and sworn to before me this 23rd day of October 1987.
Notary Public Marilyn Evenson

Date Commission Expires

K.C.C. OFFICE USE ONLY
F Letter of Confidentiality Attached
C Wireline Log Received
C Drillers Time Log Received
Distribution
KCC SWD/Rep NGPA
KCS Plug Other
(Specify)
OCT 27 1987
10-27-87
CONSULT Form ACO-1 (5-86)
Wichita, Kansas

MARILYNN EVENSON
NOTARY PUBLIC
STATE OF KANSAS
7-17-91

Sec. 10 Twp 31 Rge 8 East

SIDE TWO

Operator Name Bison Energy Corp. Lease Name Muir Well # 1B-10

Sec. 10 Twp. 31 Rge. 8 East West County Harper

WELL LOG

INSTRUCTIONS: Show important tops and base of formations penetrated. Detail all cores. Report all drill stem tests giving interval tested, time tool open and closed, flowing and shut-in pressures, whether shut-in pressure reached static level, hydrostatic pressures, bottom hole temperature, fluid recovery, and flow rates if gas to surface during test. Attach extra sheet if more space is needed. Attach copy of log.

Drill Stem Tests Taken Yes No
 Samples Sent to Geological Survey Yes No
 Cores Taken Yes No

Formation Description
 Log Sample

DST #1 4415'-4430', 45-60-45-90
 Recovered 140' sogamy. FP 81-78#.
 SIP 1100-1083#.

Name	Top	Bottom
Indian Cave Sand	2396'	(-731)
Heebner Shale	3416'	(-1751)
Douglas Group	3464'	(-1799)
1st Douglas Sand	3484'	(-1819)
2nd Douglas Sand	3536'	(-1871)
Iatan LS.	3650'	(-1985)
Lansing Group	3659'	(-1994)
Kansas City Group	3907'	(-2242)
Stark Shale	4065'	(-2400)
Hushpuckney Shale	4094'	(-2429)
BKC	4178'	(-2513)
Marmaton	4212'	(-2547)
Pawnee LS.	4276'	(-2611)
Cherokee Group	4314'	(-2649)
Mississippi Chert	4416'	(-2751)

CASING RECORD <input checked="" type="checkbox"/> New <input checked="" type="checkbox"/> Used							
Report all strings set-conductor, surface, intermediate, production, etc.							
Purpose of String	Size Hole Drilled	Size Casing Set (in O.D.)	Weight Lbs/Ft.	Setting Depth	Type of Cement	#Sacks Used	Type and Percent Additives
Surface	12 1/2"	8-5/8"	20#	231'	60/40poz	165	2% gel 3% cc.
Production	7-7/8"	5 1/2"		4448'	Surfill	125	
PERFORATION RECORD				Acid, Fracture, Shot, Cement Squeeze Record			
Shots Per Foot	Specify Footage of Each Interval Perforated			Amount and Kind of Material Used			Depth
4	4417'-4423'			500 gal. MCA			
				40,000 gal. gelled fluid			
				18,000 lbs. sand			
TUBING RECORD		Size	Set At	Packer at	Liner Run	<input type="checkbox"/> Yes <input type="checkbox"/> No	
		2 7/8"					
Date of First Production	Producing Method						
9-7-87	<input type="checkbox"/> Flowing <input checked="" type="checkbox"/> Pumping <input type="checkbox"/> Gas Lift <input type="checkbox"/> Other (explain).....						
Estimated Production Per 24 Hours	Oil	Gas	Water	Gas-Oil Ratio	Gravity		
	40 Bbls	150 MCF	Bbls	CFPB			

METHOD OF COMPLETION

Production Interval

Disposition of gas: Vented Open Hole Perforation
 Sold Other (Specify)
 Used on Lease Dually Completed
 Commingled